

Service Manual

Sandwich Maker

Model No. **NF-GW1WTN**

PGF



⚠ WARNING

This service information is designed for experienced repair technicians only and is not designed for use by the general public. It does not contain warnings or cautions to advise non-technical individuals of potential dangers in attempting to service a product. Products powered by electricity should be serviced or repaired only by experienced professional technicians. Any attempt to service or repair the product or products dealt with in this service information by anyone else could result in serious injury or death.

IMPORTANT SAFETY NOTICE

There are special components used in this equipment which are important for safety. These parts are marked by **⚠** in the Schematic Diagrams, Circuit Board Diagrams, Exploded Views and Replacement Parts List. It is essential that these critical parts should be replaced with manufacturer's specified parts to prevent shock, fire or other hazards. Do not modify the original design without permission of manufacturer.

TABLE OF CONTENTS

	PAGE
1 SPECIFICATIONS-----	2
2 LOCATION OF CONTROLS AND COMPONENTS -----	3
3 OPERATING INSTRUCTIONS-----	4
4 MAINTENANCE-----	6
5 FACTORY SETTING-----	7
6 WIRING CONNECTION DIAGRAM -----	9
7 SCHEMATIC DIAGRAM-----	11
8 REPLACEMENT PARTS-----	12

Panasonic®

© Panasonic Corporation 2011 Unauthorized copying and distribution is a violation of law.

1 SPECIFICATIONS

Power supply	220 / 240V - 50/60Hz
Power consumption	640 - 760W
Dimensions (WxDxH) (approx.)	25.1cm x 24.2cm x 9.9cm
Weight(approx.)	2.1kg
Length of the cord (approx.)	1.0m
Automatic temperature regulator	Thermostat

2 LOCATION OF CONTROLS AND COMPONENTS

Parts Names

- Remove packing materials. Please wipe the plates with a well-wrung cloth before using the appliance for the first time and dry well.

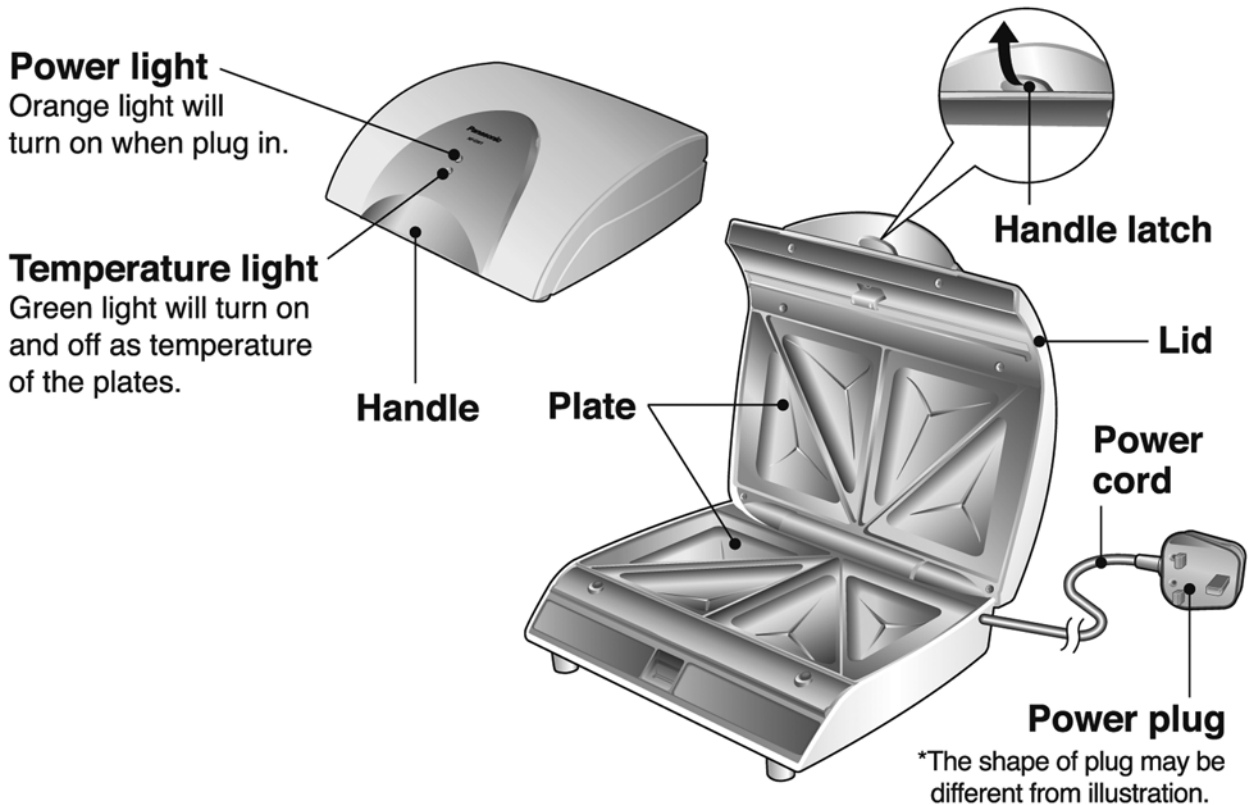

Ingredients

■ Breads

- Select suitable size of bread to fit on the plate. (Approx. 11 cm X 12 cm)
Do not protrude from the frame.
- For golden toasted sandwiches, spread butter or margarine lightly on out side of the breads.

■ Fillings

- The ingredients which contain a lot of liquid are not suitable for filling.
(The liquid may leak out.)
- When using too much cheese or chocolates will overflow and scorch on the plate.
- For large size of ingredients, cut them into small pieces.
- When using raw ingredients such as meat, precook before toasting.



3 OPERATING INSTRUCTIONS

How to Use

1 Prepare the ingredients.

- Cut ingredients for filling.
- Cut crust of the breads off.
- Spread butter or margarine lightly on the outside of the breads. (optional)

2 Preheat the sandwich maker.

- Close the lid and latch it without anything in the sandwich maker then plug in. (The power light (orange) turns on.)



The temperature light (green) will turn on, when preheating is finished.

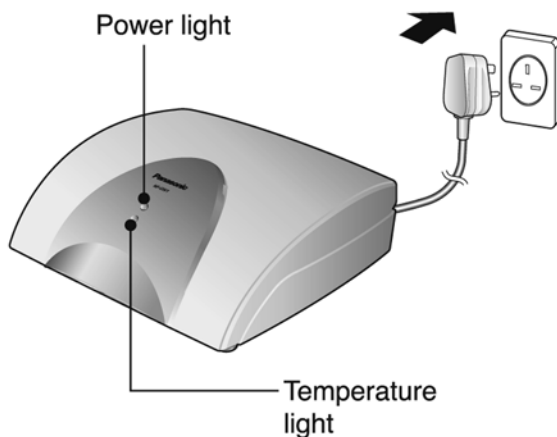

Note

- Do not leave the lid open for long period of time after the sandwich maker is plugged in. (The handle will get hot.)

3 Place breads and other ingredients.

- Unlatch the lid and open it.
- Place the breads and fillings on the bottom plate.

- Place the filling between the unbuttered side of the breads.
- Ensure the fillings are evenly filled in the center. (Make blank space (Approx. 2 cm) at the edges of the breads.)

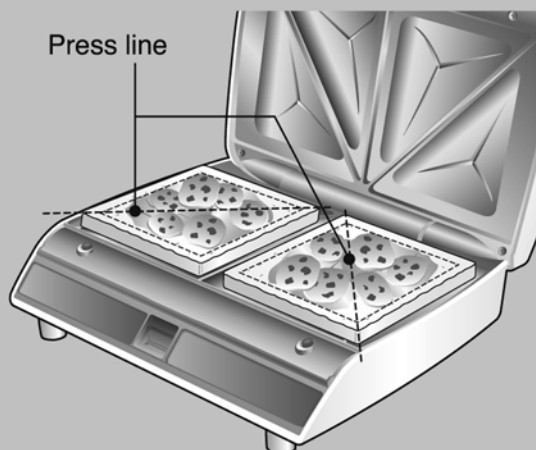

- Do not place the hard fillings or make sandwiches over 4 cm thickness.

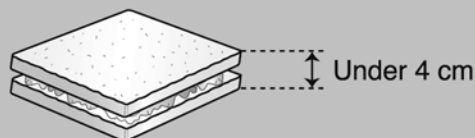

4 Toast sandwiches.

- Hold the handle and close the lid slowly until it latches. Otherwise upper breads may be off the alignment.
- Allow the sandwiches to toast for 3~8 minutes. Adjust toasting time depending on your taste.



- If the lid is difficult to close, you may have added too much fillings used thick fillings or the breads are too thick. Do not force to close the lid.
- Beware of the hot steam which may come out from side or top surface of the sandwich maker.

5 After finish toasting, unplug.

- When toasting is finished, remove the sandwiches carefully.

- Use plastic or wooden utensils. Do not use metal utensils as they will scratch and damage the non-stick plates.

4 MAINTENANCE

How to Clean

- Unplug the power plug and make sure the sandwich maker is cool down completely.

Note

- Do not use benzine, thinner, alcohol, bleach, polishing powder, metal brush or nylon brush, otherwise the surface will be damaged.
- Do not use a dishwasher.

Exterior

Wipe with a well-wrung cloth.

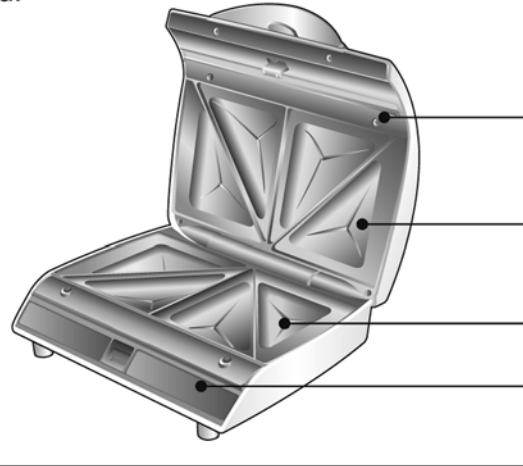

Plates / Interior

Wipe with a well-wrung cloth.

- Do not fill up with water in the plates or wash under the running water.
- Use plastic or wooden utensils if necessary.
Do not use metal utensils as they will scratch and damage the non-stick plates.

5 FACTORY SETTING

5.1. Place of product date code

The product date code is impressed upon the bottom face of the unit.

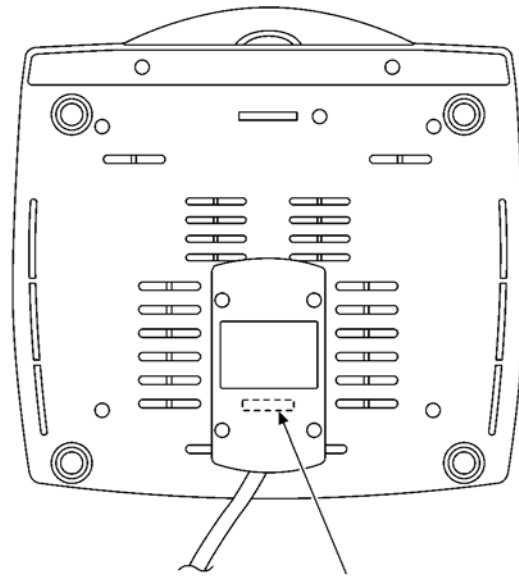

Product date code

ex.

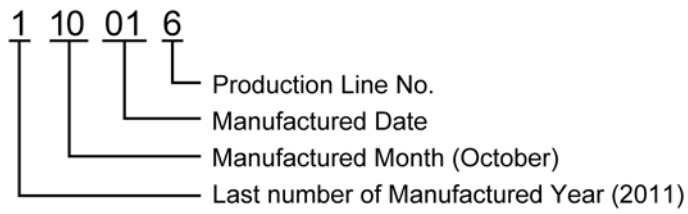

5.2. Packing procedure

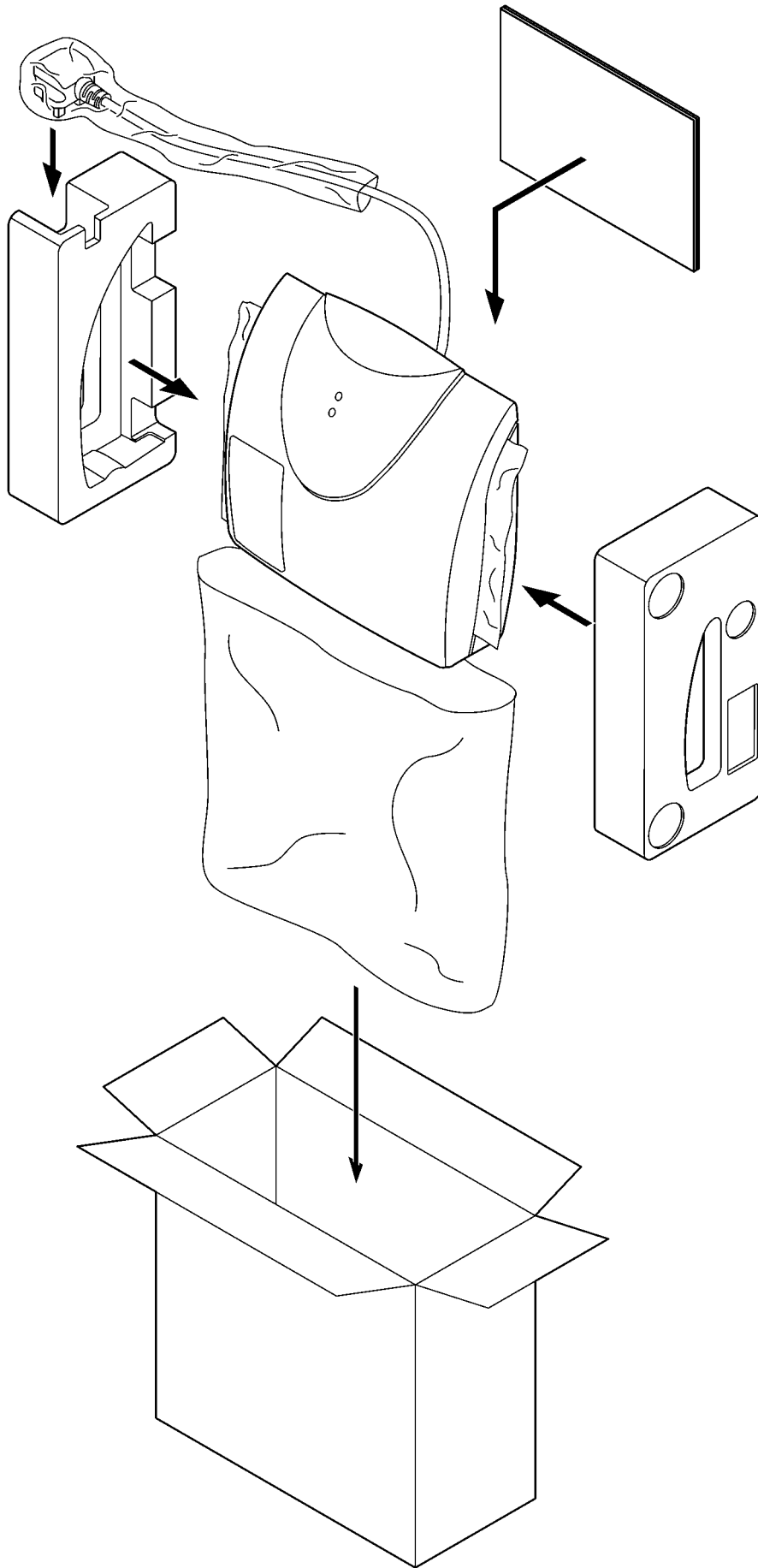

6 WIRING CONNECTION DIAGRAM

6.1. Basic wiring diagram

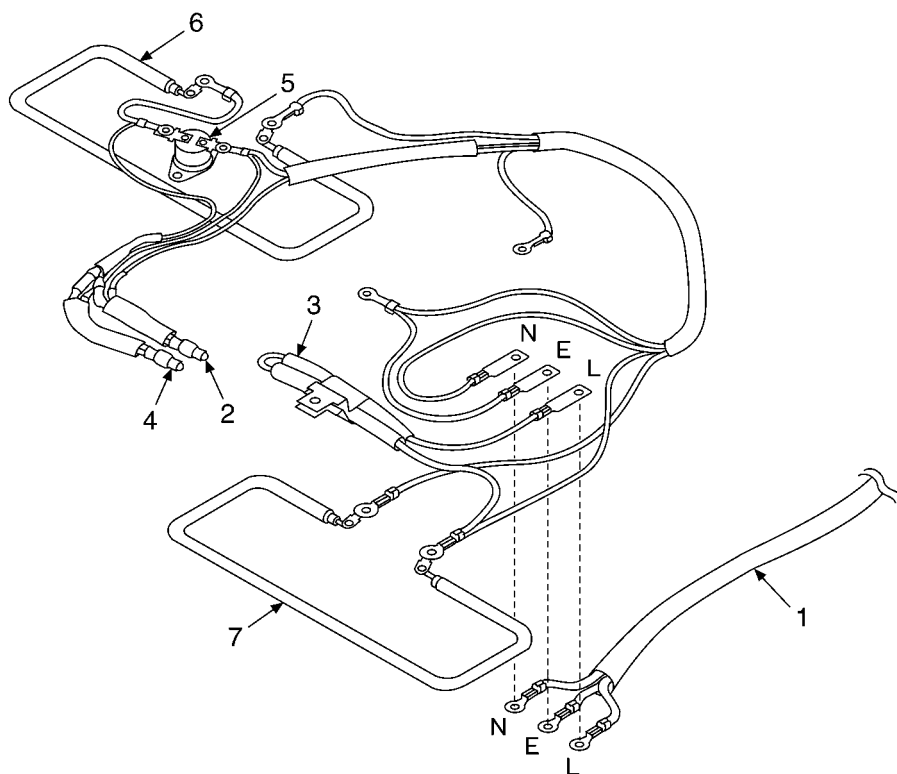

No.	Parts Name
1	Power cord
2	Lamp(Red)
3	Fuse
4	Lamp(Green)
5	Thermostat
6	Upper heater
7	Lower heater

6.2. Wiring diagram

Caution

Make sure that the cables are routed as they were before the repair. Otherwise, the lead wire may touch the end face of parts, resulting in a failure or electric shock.

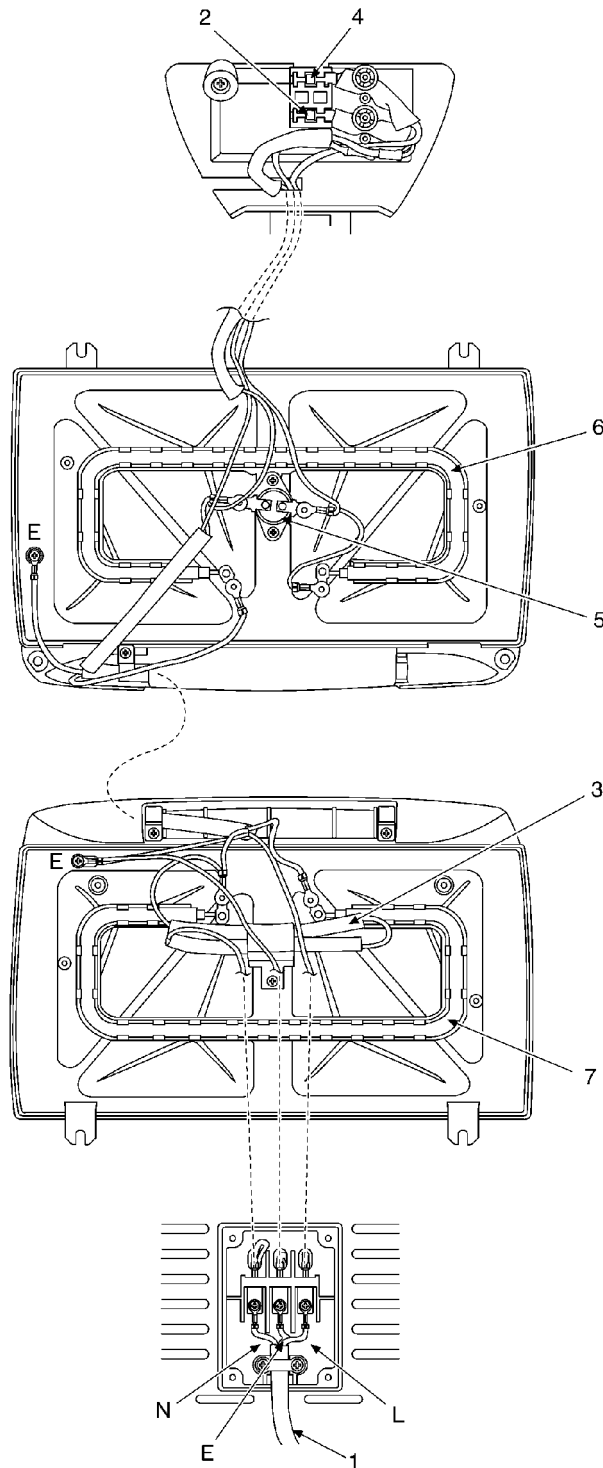

No.	Parts Name
1	Power cord
2	Lamp(Red)
3	Fuse
4	Lamp(Green)
5	Thermostat
6	Upper heater
7	Lower heater

7 SCHEMATIC DIAGRAM

7.1. Circuit diagram

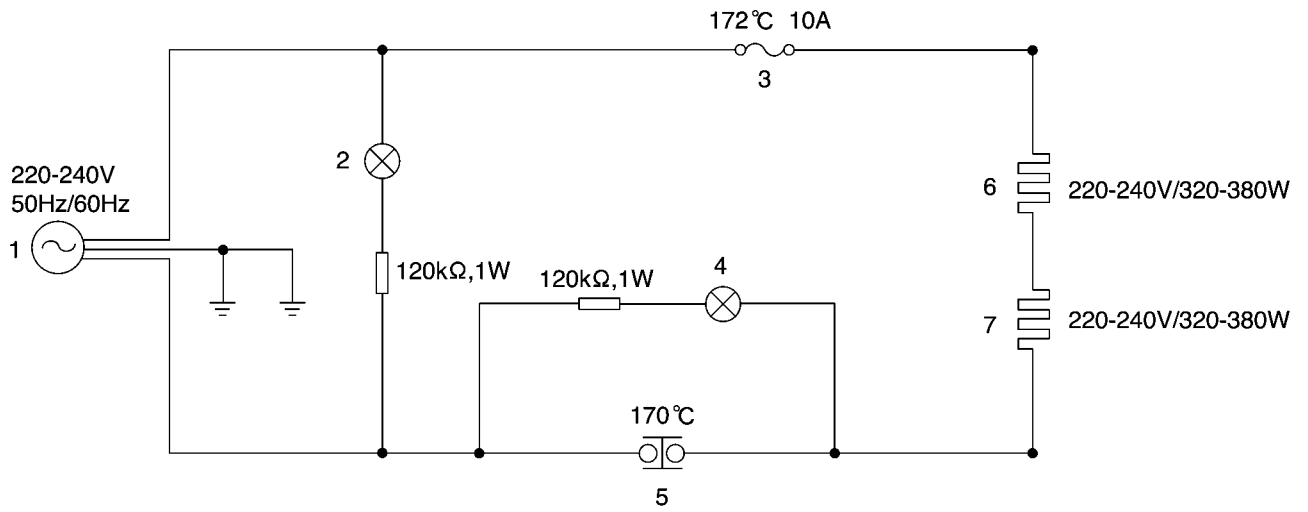

No.	Parts Name
1	Power
2	Lamp(Red)
3	Fuse
4	Lamp(Green)
5	Thermostat
6	Upper heater
7	Lower heater

8 REPLACEMENT PARTS

8.1. Parts List

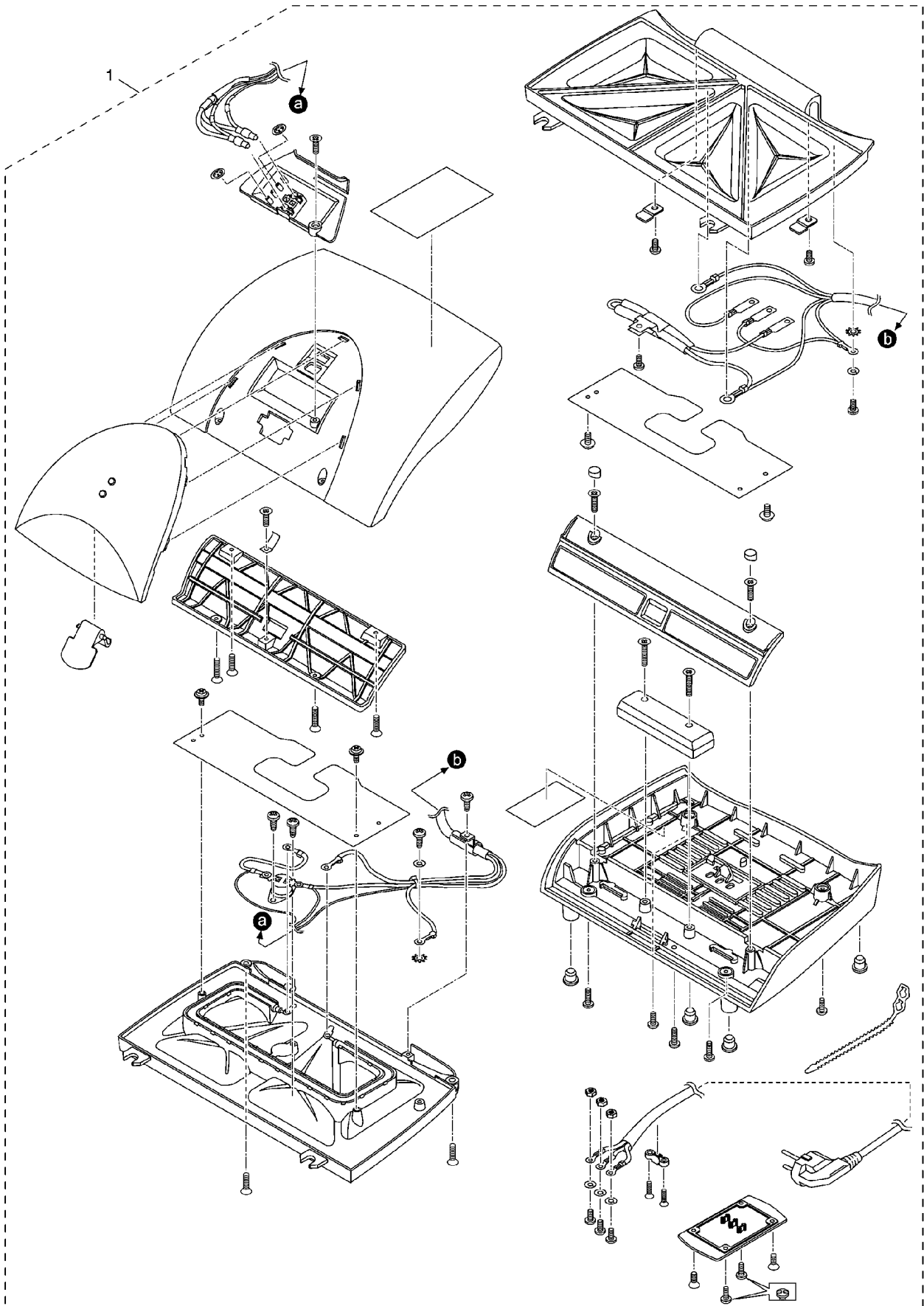

8.2. Replacement Parts List

Safety	Ref. No.	Part No.	Part Name & Description	Quantity	Remarks
⚠	1	AFA00Y18700S	Sandwich Maker Ass'y	1	

Safety	Ref. No.	Part No.	Part Name & Description	Quantity	Remarks
⚠		AFZ50Y187	Operating instruction	1	
		AFZ03Y187	Carton box	1	
		AFZ39Y18700S	Cushion Set	1	