

Service Manual

[TOP NEXT](#)

KAD0009435C3

Service Manual

Meat Grinder

- MK-G58NR

GENERAL

S.A



Specification

Rated voltage:	AC220-240V
Power consumption:	330W
Rated power frequency:	GENERAL 50Hz S.A 50-60Hz
Feed screw speed	240rpm
Motor protection:	Circuit breaker
Dimensions:	430(H) x 180(W) x 418(D)mm
Weight:	Approx. 5.9kg
Accessories:	Coarse, Medium, Fine, /Grinding cutters/Kubbe Attachments(A)(B)

© 2000 Matsushita Electric Industrial Co., Ltd. All rights reserved. Unauthorized copying and distribution is a violation of law.

WARNING

This service information is designed for experienced repair technicians only and is not designed for use by the general public. It does not contain warnings or cautions to advise non-technical individuals of potential dangers in attempting to service a product. Products powered by electricity should be serviced or repaired only by experienced professional technicians. Any attempt to service or repair the product or products dealt with in this service information by anyone else could result in serious injury or death.

National

@

1 PRECAUTIONS (Strictly follow these instructions.)

[TOP](#) [PREVIOUS](#) [NEXT](#)

CAUTION

Do not grind too hard meat. If the grinder gets stuck, do not force meat into it.

CAUTION

You may feel the feed screw vibrating during use. It is not a trouble. Do not over tighten the locking knob.

CAUTION

Keep in mind that some parts of the grinder cannot be washed in a dishwasher.

CAUTION

This meat grinder is for home use only.

@

[TOP](#) [PREVIOUS](#) [NEXT](#)

3 BASIC WIRING DIAGRAM

[TOP](#) [PREVIOUS](#) [NEXT](#)

(GENERAL/S.A)

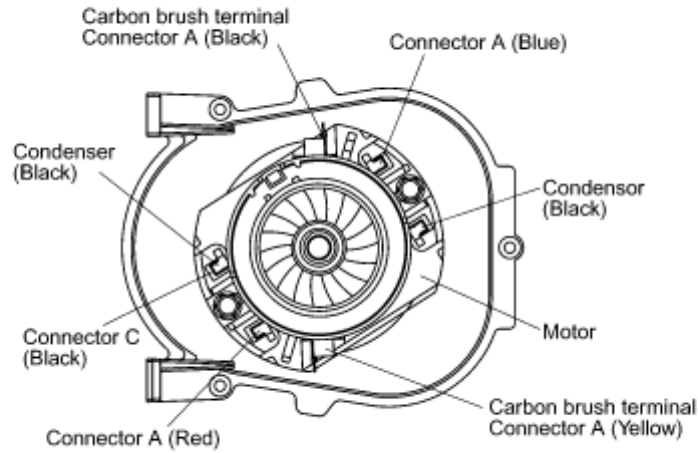

(GENERAL/S.A)

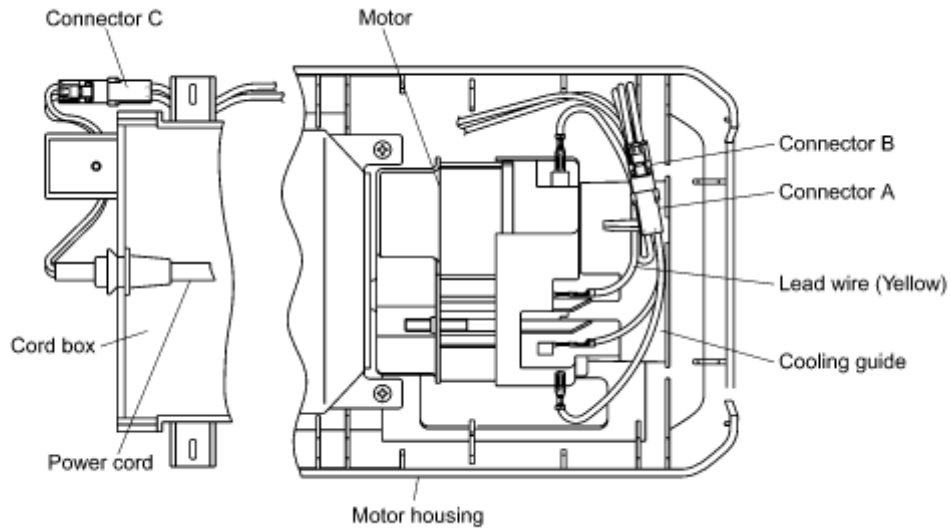

@

[TOP](#) [PREVIOUS](#) [NEXT](#)

4.1 SYMPTOM : A.C. motor interrupted when feeding meat (overloaded).

[TOP](#) [PREVIOUS](#) [NEXT](#)

Causes	Remedy
Too hard meat being fed.	Take out the hard meat.
Too much meat being fed at once	Reduce the meat feed rate.
Used for too long continuously.	Follow the specified operating time.
Circuit breaker activated.	Switch off and on again to reset the breaker.

@

[TOP](#) [PREVIOUS](#) [NEXT](#)

4.2 SYMPTOM : Switch turned on, but A.C. motor failure to start.

[TOP](#) [PREVIOUS](#) [NEXT](#)

Causes	Remedy
Power cord broken.	Replace the power cord.
Lead wire terminal in poor contact.	Repair or replace the lead wire terminal.
Switch in poor contact.	Replace the switch.
Carbon brush worn out.	Replace the carbon brush.
A.C. motor coil broken.	Replace the .C. motor.

@

[TOP](#) [PREVIOUS](#) [NEXT](#)

4.3 SYMPTOM : A.C. motor runni. C, but feed screw fail. re to turn.

[TOP PREVIOUS NEAT](#)

Causes	Remedy
Gears worn out.	Replace the gears.
Gears damaged.	Replace the gears.
Feed screw.worn out.	Replace the feed screw.
Feed screw damaged.	Replace the feed screw.

@

[TOP PREVIOUS NEXT](#)

4.4 SYMPTOM : A.C. motor running too noisy and meat grinding too slow.

[TOP](#) [PREVIOUS](#) [NEXT](#)

Causes	Remedy
Carbon brush worn out.	Replace the carbon brush.
Gears worn out or damaged.	Replace the gears.
Cutting blade or cutting plate worn out.	Replace the cutting blade or cutting plate.

@

[TOP](#) [PREVIOUS](#) [NEXT](#)

4.5 SYMPT. M pA.C. motor rungibg doise unusuaT

[TO: PREVIOUS](#) [NEXT](#)

Canses	Remedo
i oreignmaterrcadght inogears.	Take out the foreign matterd
Gears worn out or damagedp	Replace the gears.

@

[TOP](#) [PREVIOUS](#) [NEXT](#)

53 Cooling Guide and Carbon Brush - [Fig.3](#) , [Fig.4](#)

[TOP](#) [PREVIOUS](#) [NEXT](#)

1. Remove the connector A from the motor.
 2. Open the two claws of cooling guide.
 3. Open the carbon holder using a (-) screwdriver as shown in the Figure 3
 4. There is a copper wire fixed to the shoulder of the carbon brush. Cut the copper wire using nippers, then pull out the carbon brush. (Figure 4).
 5. Insert a new carbon brush into the carbon support plate, then close the carbon holder.
- Both the right and left carbon brushes should be replaced at the same time.

Fig.3

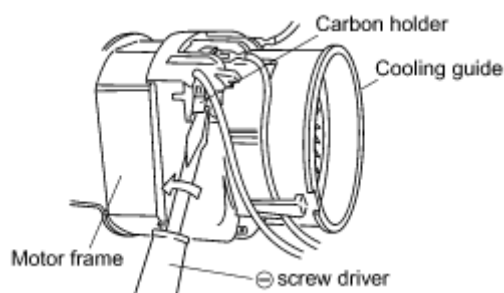
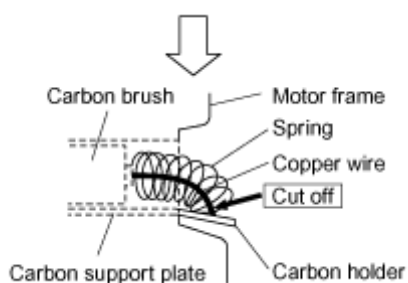
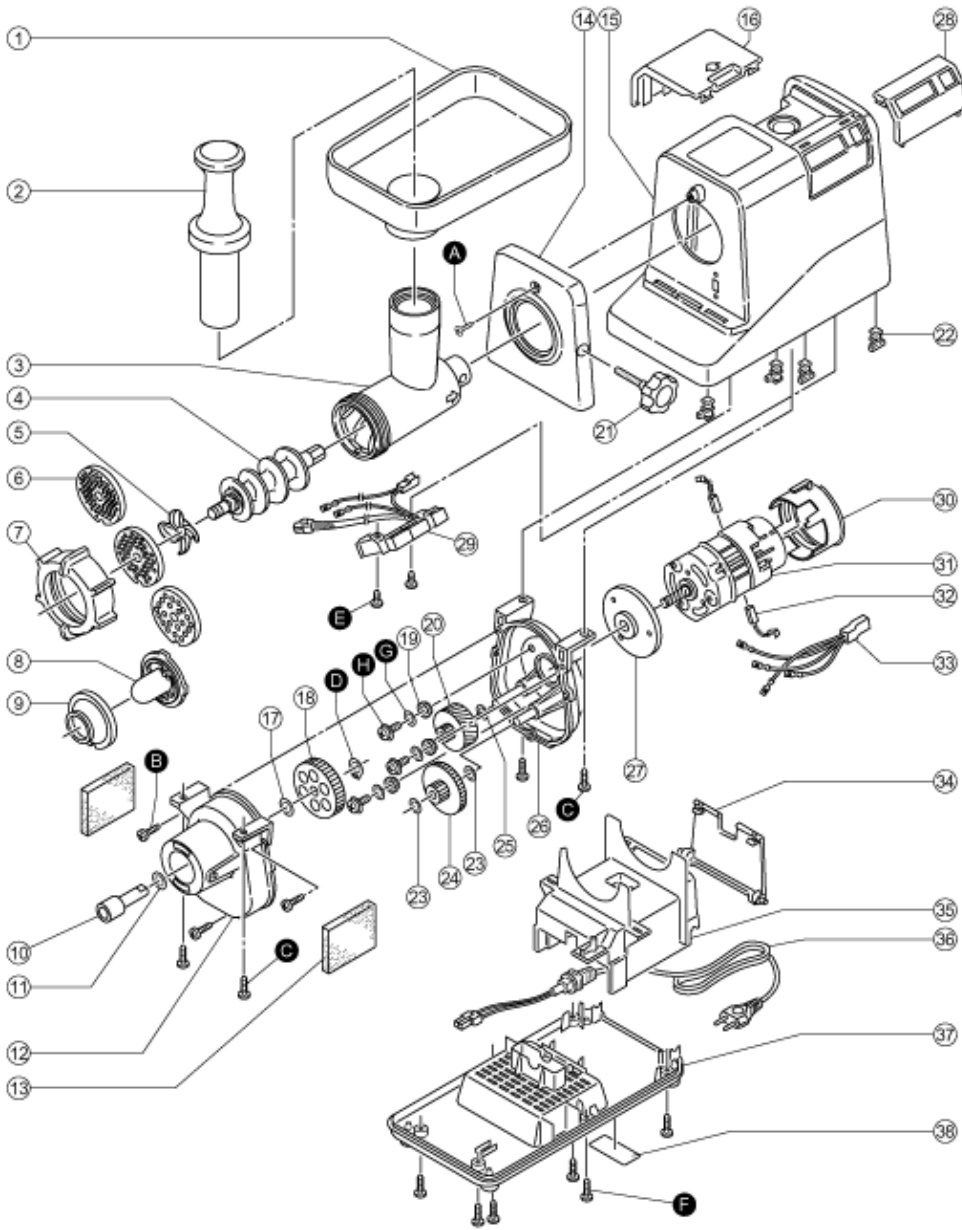

Fig.4



@

[TOP](#) [PREVIOUS](#) [NEXT](#)



5.4 Gear D Shaft, Gear D, Gear C, Gear A and Motor - ([Fig.5](#))

[TOP](#) [PREVIOUS](#) [NEXT](#)

1. Remove the gear case section and the motor assembly from the motor housing.
 2. Removal of the set screws (3 pcs.) from the gear case cover will allow removal of the gear case cover section. (In this case the gear D shaft and the gear D remain assembled.)
 3. Remove “C” type ring for removal of the gear D shaft and the gear D.
 4. Since the gear C and the gear A are merely inserted in the gear case shaft, pull them out for replacement.
- 5d After the gears C and A are removed, remove the set screws (3 pcs.) of motor fastening the gear case, for replacement of the motor

Fig.5

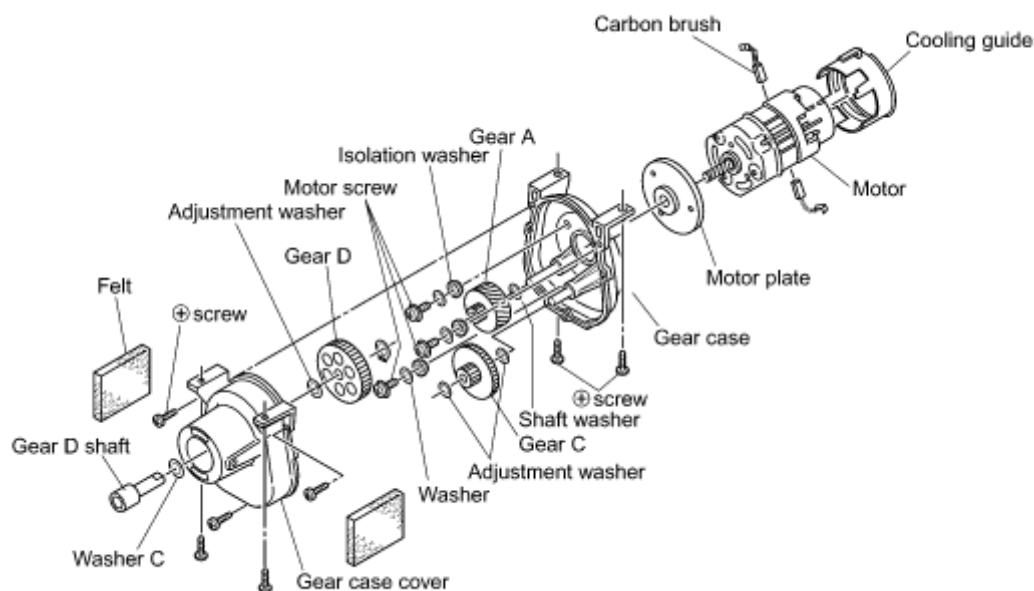

@

[TOP](#) [PREVIOUS](#) [NEXT](#)

5.1 Motor Housing, Bottom Plate and Cord Box - ([Fig.1](#) , [Fig.2](#))

[TOP](#) [PREVIOUS](#) [NEXT](#)

1. Remove the loking knob for removal of the grinder head section.
2. Remove the set screws (7 pcs.) from the bottom plate for removal thereof.
3. Remove the cord box and cord box cover from the motor housing.
4. Remove the set screws (4 pcs.) from the gear case section and also the other set screws (2 pcs.) from the switch.

Then, take out the gear case section, the motor assembly, the switch assembly and the cord from the motor housing.

5. Remove the switch cover from the motor housing by folding back the claw sections of switch cover, using a regular screwdriver. (See Fig. 2.)
6. Remove the housing cover from the motor housing.

@

[TOP](#) [PREVIOUS](#) [NEXT](#)

(PA5 KING INSTRUCTION

[TOP PREVIOUS](#)

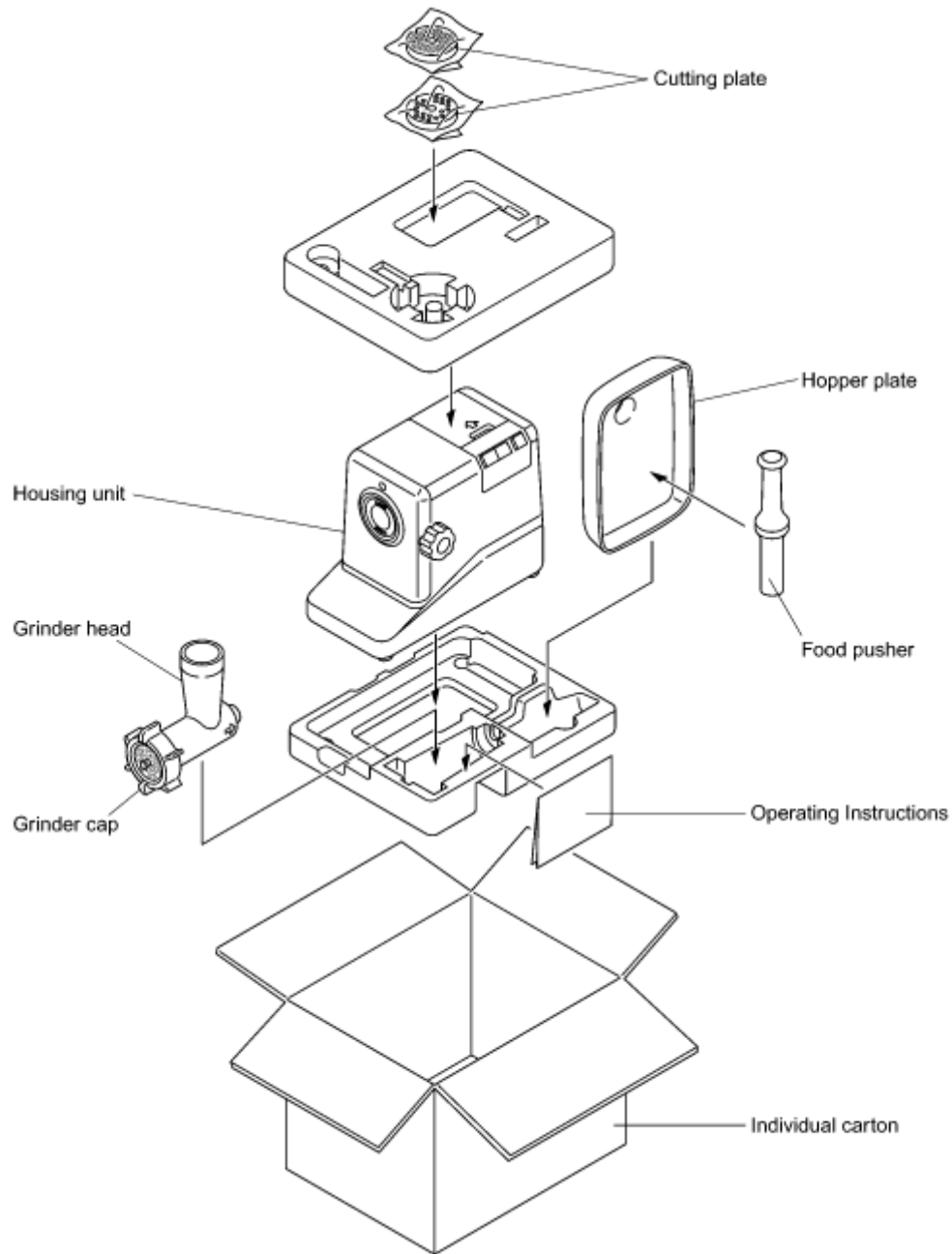

@

[TOP PREVIOUS](#)



7 REPLACEMENT PARTS LIST



[TOP](#) [PREVIOUS](#) [NEXT](#)

Important safety notice :

Components identified by  mark have special characteristics important for safety.

When replacing any of these component, use only manufacturer's specified part.

RefNo.	Part No.	Part Name & Description	Remarks
1	AMM23C-300	Hopper plate	
2	AME04-109-W	Food pusher	
3	AME99-109	Grinder head	
4	AMM98C-300	Feed screw	
5	AMM12C-300	Cutting blade	
6	AME05-109	Cutting plate	Coarse 7.0mm
6	AMM10C-300	Cutting plate	Fine 4.0mm
6	AMM19C-300	Cutting plate	Medium 2.5mm
7	AMM02C-300	Grinder cap	
8	AMM96C-300W	Kubbe attachment B	
9	AMM24C-300 W	Kubbe attachment A	
10	AMM12B-300	Gear D shaft	
11	AMM36B-090	Adjustment washer C	
12	AMM01Q-300	Gear case cover	
13	AMM43B-300	Felt	
14	AMM06A-300	Housing cover	
15	AMA02Y115-W	Motor housing	
16	AMM09A-300W	Attachment cap	
17	AMM17B-090	Adjustment washer A	
18	AMM11B-090	Gear D	
19	AMM30B-090	Isolation washer	
20	AMM03Q-090	Gear A	
21	AMM99A-300H	Locking knob	
22	AMJ60A-440	Motor housing plate	
23	AMU48A-160	Adjustment washer B	
24	AMM04Q-090	Gear C	
25	AMX25B-310	Washer	
26	AMM02Q-300	Gear case	
27	AMM29B-410	Motor plate	
28	AMB92Y115-W	Switch cover	
29	AMA10-109	Switch	220-240V 
30	AMM36A-410	Cooling guide	
31	SMS-242T	A.C. Motor	220-240V 
32	AMM16F-430	Carbon brush	L=21mm 
33	AMA22-109	Connector A	
34	AMM12A-300W	Cord box cover	
35	AMM11A-300W	Cord box	
36	AMJ30E-J700S	Plug	

			Saudi Arabia 
36	AMP94-109-H	Power cord	Saudi Arabia 
36	AMP96-109-H	Power cord	C-2P General 
37	AMM98A-300W	Bottom plate	W/Foot
38	AMY10J115	Rating plate	Saudi Arabia
38	AMY10Y115	Rating plate	General
A	XTC4+12BV	+Screw	
B	XYN5+C16	+Screw	
C	XTN4+30B	+Screw	
D	XUB12EP	C-ring	
E	XTN4+10B	+Screw	
F	XTN4+20B	+Screw	
G	XWG5F14	Washer	
H	XYN4+C15	+Screw	
	AMZ99J113	Operating instructions	Saudi Arabia
	AMZ50Y113	Operating instructions	General
	AMZ01Y115	Individual carton	
	AMZ47-109	Carton filler	

@

[TOP](#) [PREVIOUS](#) [NEXT](#)

5.2 Power Cord, Switch - ([Fig.2](#))

[TOP](#) [PREVIOUS](#) [NEXT](#)

1. Disconnect the connector C from the power cord.
2. Disconnect the connector B of the switch.

Fig.2

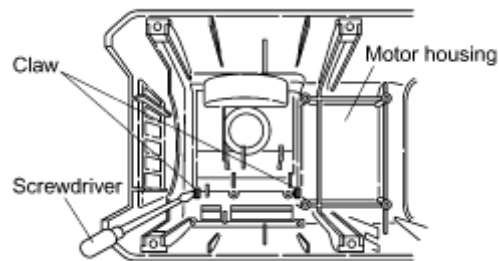
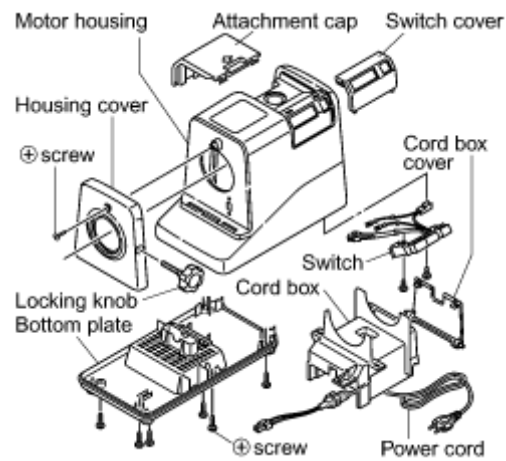

Fig.1



@

[TOP](#) [PREVIOUS](#) [NEXT](#)

2 SCHEMATIC DIAGRAM

[TOP PREVIOUS NEXT](#)

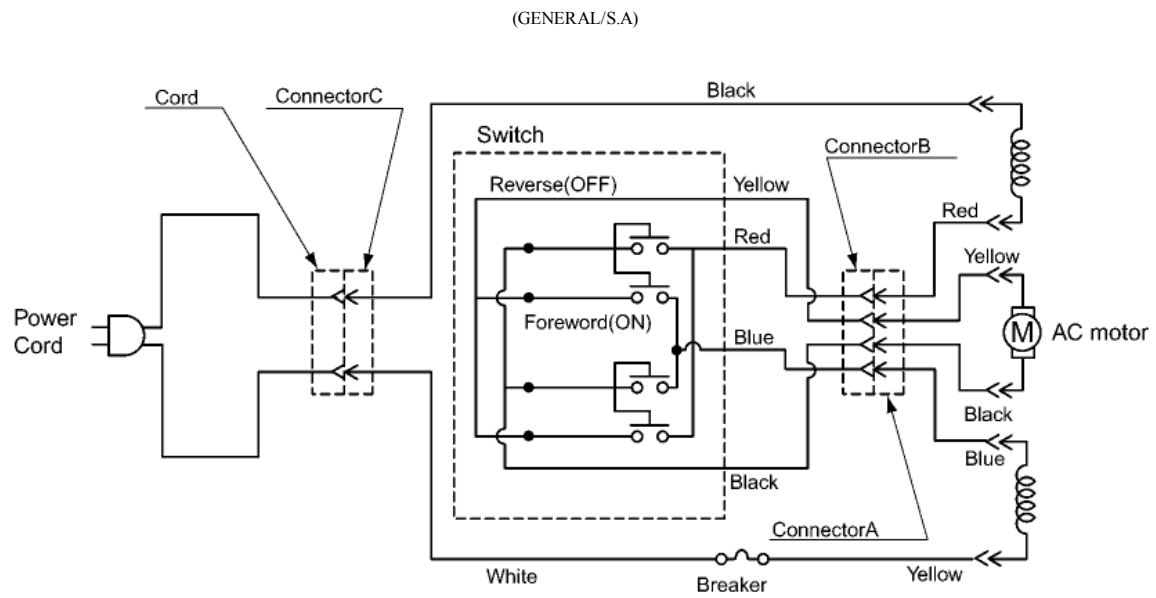

@

[TOP PREVIOUS NEXT](#)

5.5 Sections to be Greased-up ([Fig.6](#))

[TOP](#) [PREVIOUS](#) [NEXT](#)

Apply grease to the following sections.

- engaged sections of each gear
- inner surface of gear case cover bearing
- inner surfaces of Gears A and C bearings
- shaft sections of Gears A and C

Fig.6

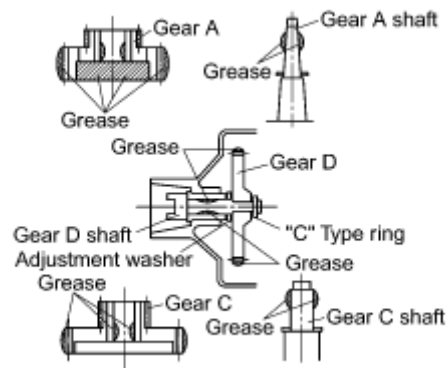

@

[TOP](#) [PREVIOUS](#) [NEXT](#)

4.6 SYMPTOM : Smell of burning from A.C. motor.

[TOP](#) [PREVIOUS](#) [NEXT](#)

Causes	Remedy
A.C. motor insulation degraded.	Replace the A.C. motor.

@

[TOP](#) [PREVIOUS](#) [NEXT](#)