

Panasonic®

ORDER NO. PMMA160834CE

Service Manual

Juicer

Model No. **MJ-H300KSD**
MJ-H300KSQ
MJ-H300KSL
MJ-H300KSN
MJ-H300KSM
MJ-H300KTJ
MJ-H300KTZ
MJ-H300KTK

Destination: Hong Kong

China

Malaysia

Thailand

India

Egypt

Iraq

Jordan

Pakistan

South Africa

PGF

Sudan

Afghanistan

Nigeria

Oman

Saudi Arabia

UAE

Kuwait

Qatar

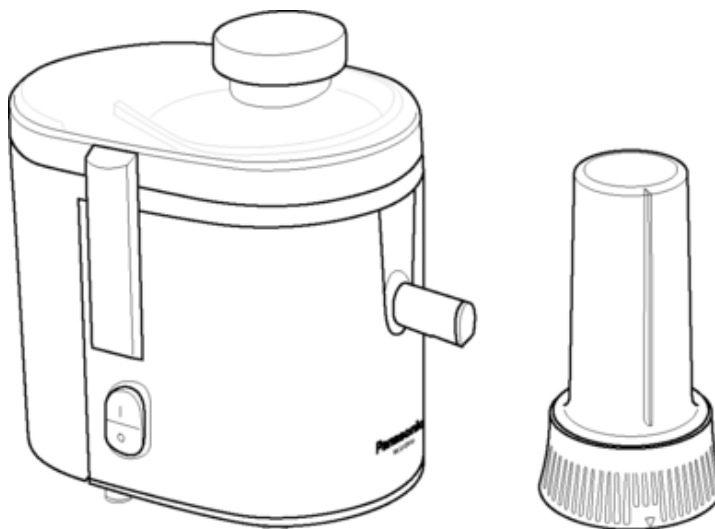

⚠ WARNING

This service information is designed for experienced repair technicians only and is not designed for use by the general public. It does not contain warnings or cautions to advise non-technical individuals of potential dangers in attempting to service a product. Products powered by electricity should be serviced or repaired only by experienced professional technicians. Any attempt to service or repair the product or products dealt with in this service information by anyone else could result in serious injury or death.

IMPORTANT SAFETY NOTICE

There are special components used in this equipment which are important for safety. These parts are marked by ⚠ in the Schematic Diagrams, Circuit Board Diagrams, Exploded Views and Replacement Parts List. It is essential that these critical parts should be replaced with manufacturer's specified parts to prevent shock, fire or other hazards. Do not modify the original design without permission of manufacturer.

© 2016 Panasonic Manufacturing Malaysia Berhad (6100-K). Unauthorized copying and distribution is a violation of law.

1 Specifications

MODEL NO.	MJ-H300	
	Juicer	Blender
Power Supply	220 - 240 V ~ 50 - 60 Hz	
	220 V ~ 50 Hz (China/Qatar)	
Power Consumption	200 - 220 W	
	200 W (China/Qatar)	
Switch	I (ON), O (OFF/RESET)	
Operation Rating	Continuous (Repetition 2 minutes ON then, 2 minutes OFF)	
Dimension (approx.)	210 mm x 294 mm x 293 mm	210 mm x 193 mm x 354 mm
Mass (approx.)	2.9 kg	2.3 kg
Capacity (approx.)	-	500 mL
Cord Length	0.9 m	
Motor Type	AC commutator motor (Class A insulation)	
Motor Protector	Circuit breaker	

2 Schematic Diagram

2.1 EMC

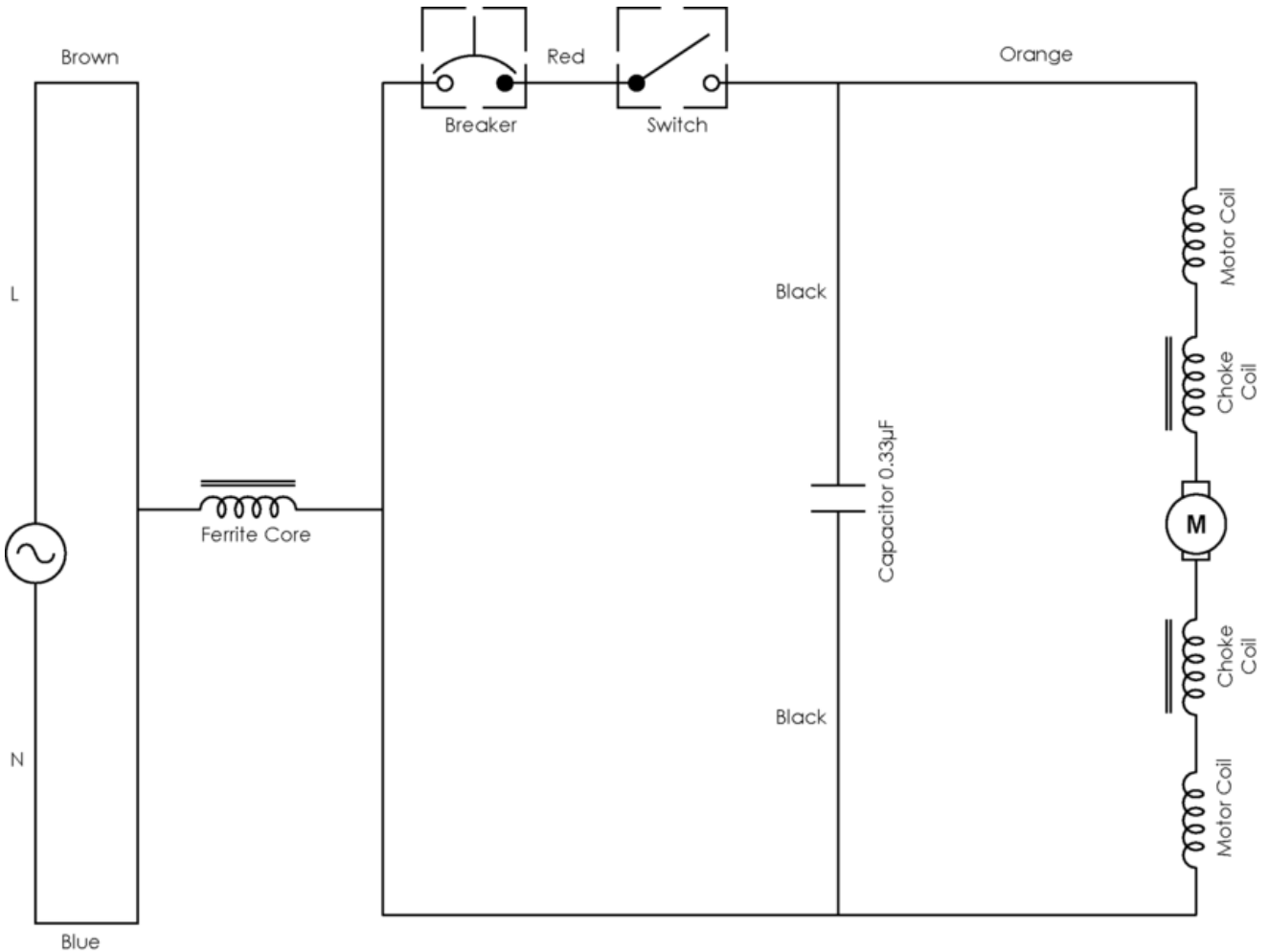

2.2 Non-EMC

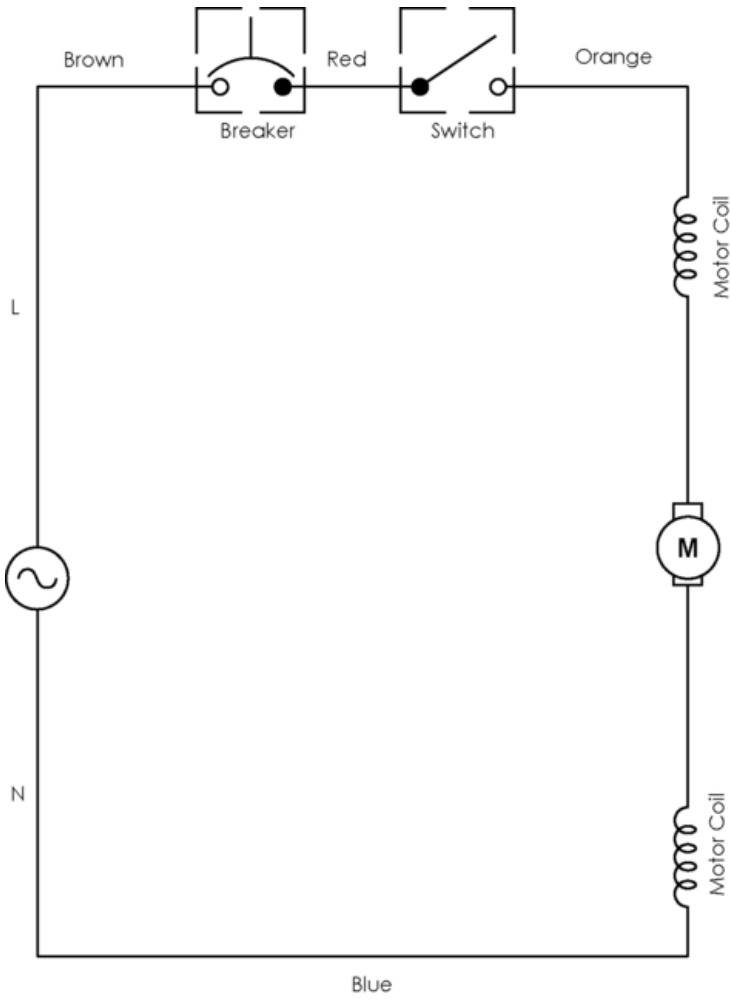

3 Wiring Connection Diagram

3.1 EMC

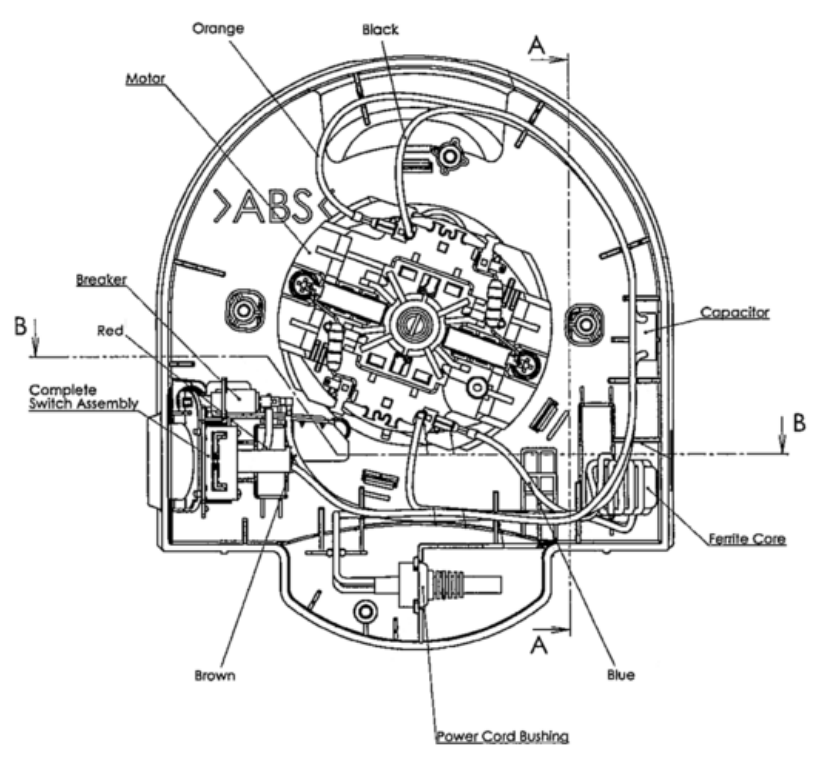
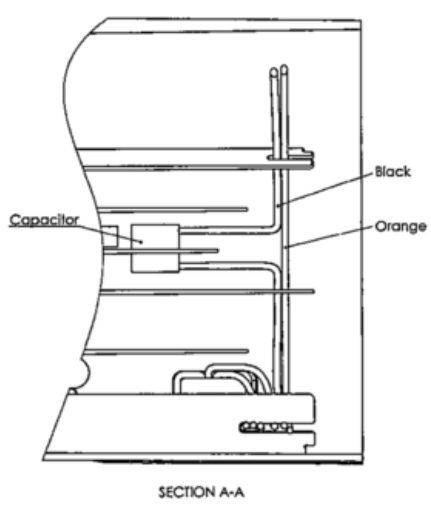
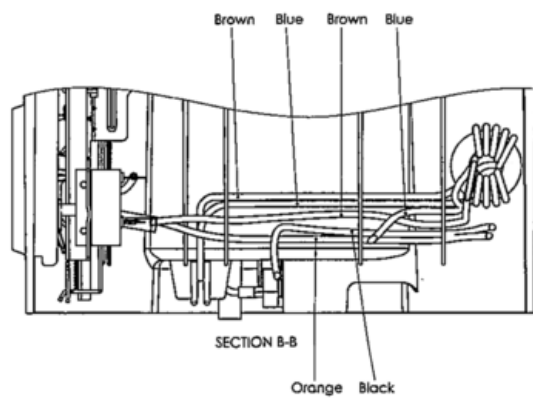

3.2 Non EMC

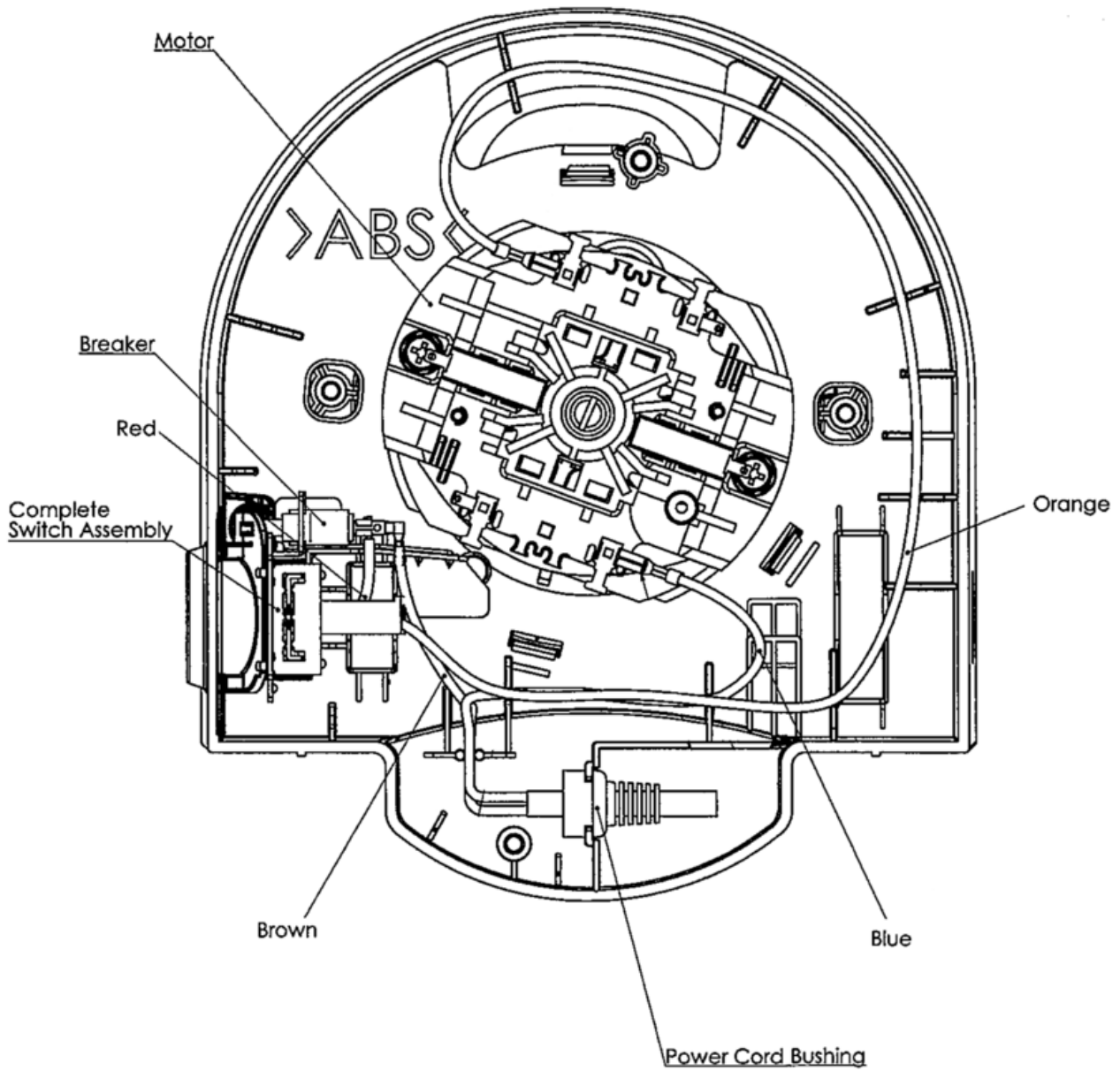

4 Troubleshooting Guide

4.1 The Juicer commons

4.1.1 SYMPTOM: Motor doesn't rotate

Cause	Remedy
Switch malfunction.	Replace the switch.
Cord cut or disconnected.	Replace the cord.

4.1.2 SYMPTOM: Motor "roars" but doesn't rotate. (Turn off the switch immediately)

Cause	Remedy
Motor bearing rushed.	Disassemble and apply oil, or replace the motor.

4.1.3 SYMPTOM: Motor overheats

Cause	Remedy
High voltage.	Adjust it.
Shorted motor.	Replace the motor.
Unloaded operation.	Be sure that something is in the container before operating.
Overload (rotation is impeded by a hard object, or a high viscosity substance in the container).	Refer to Operating Instructions.

4.1.4 SYMPTOM: Unusual odor

Cause	Remedy
Overheating.	Refer to Section 4.1.3. (Motor overheats).
Liquid leaking into motor.	Refer to Section 4.2.7. (Leakage of juice).
Motor absorbing moisture.	Dry the motor or replace it.

4.2 The Juicer

4.2.1 SYMPTOM: Motor "roars" but doesn't rotate. (Turn off the switch immediately)

Cause	Remedy
The spinner is contacting the bottom of inlet.	After removing cutter base, decrease the number of adjustment rings.
Foreign materials are clogged between the spinner and the cutter.	Remove them.
Hard materials or seeds are clogged between the inlet bottom and the cutter.	Remove them.

4.2.2 SYMPTOM: Noise, vibration

Cause	Remedy
Deformation of spinner.	Replace the spinner.

Residue has collected unevenly.	Clean the spinner.
Incompletely fastened clamp.	Fasten it completely or replace it.
The fastening part of the container cover clamp is worn out.	Replace the cover.
Incompletely fastened container unit.	Fasten it completely.
Incorrect placement of the main unit.	Inspect the rubber feet.

4.2.3 SYMPTOM: The spinner is difficult to install and remove

Cause	Remedy
The clutch pin of the cutter base doesn't operate smoothly.	Examine the clutch pin; replace it if necessary.
Foreign materials are clogged between the cutter base and the spinner base.	Remove them.

4.2.4 SYMPTOM: Juice is poorly extracted

Cause	Remedy
Cutter doesn't operate well.	Replace complete spinner.
Spinner is broken.	Replace complete spinner.
Continuous use for a long period.	Remove the residue.
Too large a gap between inlet bottom and cutter blade.	Adjust the gap within the range of 1.0 - 1.4 mm.

4.2.5 SYMPTOM: Juice contains too much residue

Cause	Remedy
Cutter blade is worn out.	Replace the spinner (complete).
Gap between inlet bottom and cutter blade is too large.	Use two or three adjusting washers on the motor shaft.

4.2.6 SYMPTOM: Cutter rubs against inlet bottom

Cause	Remedy
Gear incomplete engaged between cutter base and spinner.	Engage the gear.
Too many adjustment rings on the motor shaft.	Decrease the number of adjustment rings and adjust the gap within the range of 1.0 -1.4 mm.

4.2.7 SYMPTOM: Leakage of juice

Cause	Remedy
Container and/or cover deformed or broken.	Replace the container or cover.
Incorrect clamp fastening.	Examine the clamp; adjusting the fastening force.
Foreign materials are clogged between the container cover and the container.	Clean it and remove them.
Excessive vibration.	Clean it and adjust the spinner balance.

5 Disassembly and Assembly Instructions

5.1 Disassembly of Switch Ass'y

1. Remove the upper part from Motor Housing by open the Clamp as shown.



2. Remove 4 screws from the Bottom Plate.

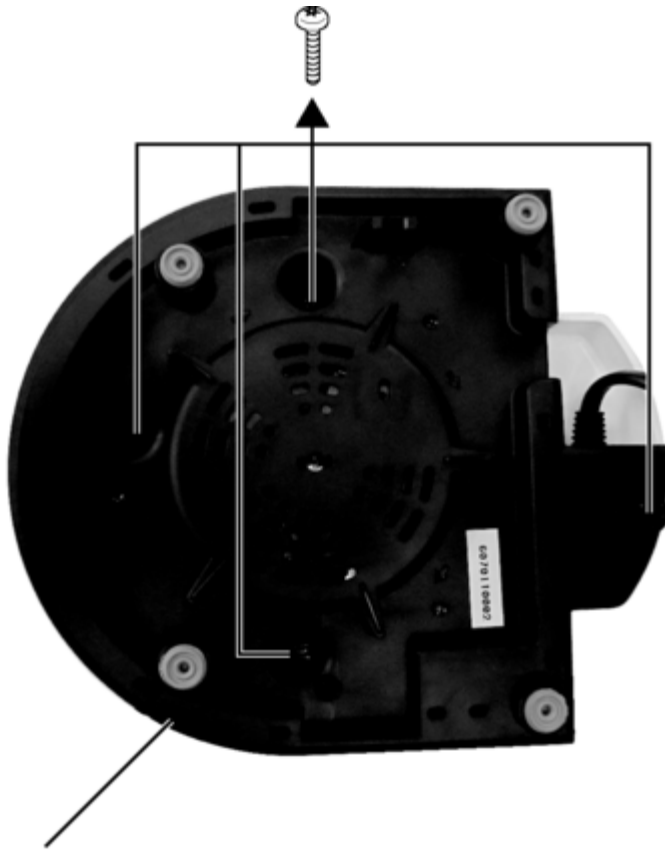

Bottom Plate

3. Remove the Power Cord by disconnect the wiring connectors.

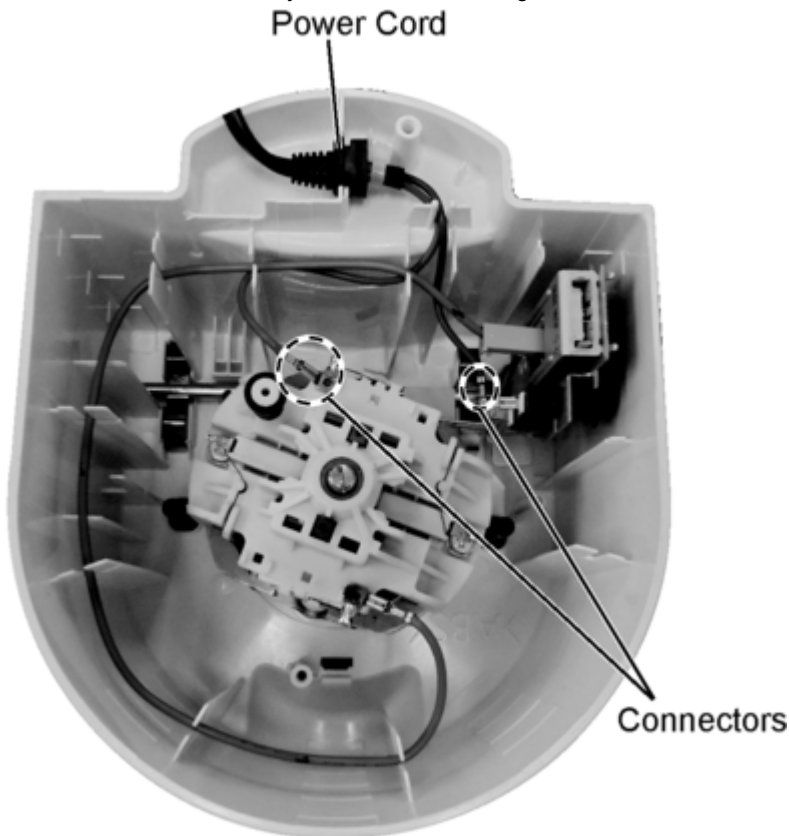

4. Remove the Switch Ass'y by disconnect the wiring connectors and push the it inside.

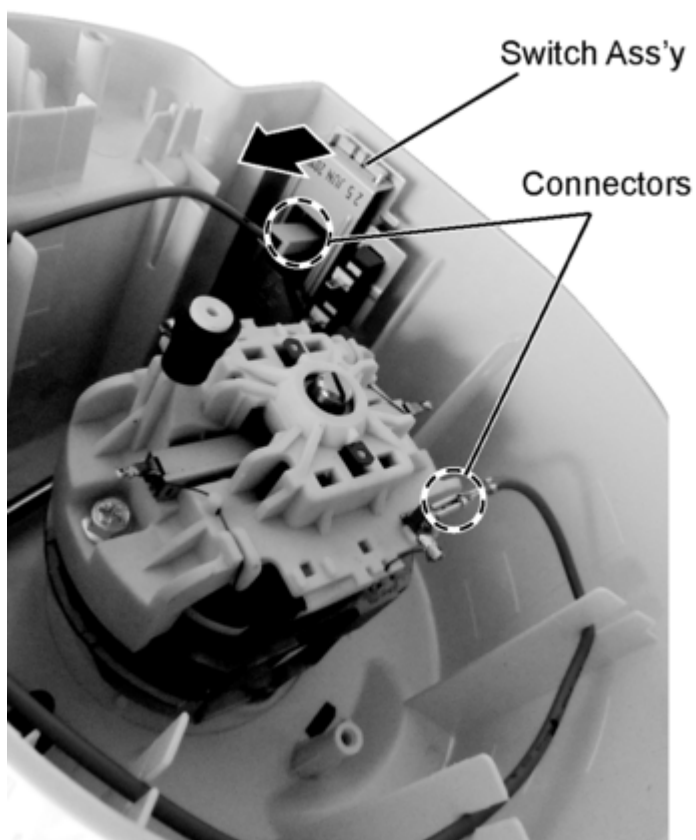

5. Reassembly
To reassemble the unit, reverse the disassembly procedures above.

5.2 Disassembly of Motor Ass'y.

1. Remove the Bottom Plate (as shown in 5.1.).
2. Disconnect all wiring connectors from the Motor Ass'y (as shown in 5.1.).
3. Remove the Safety Lock.

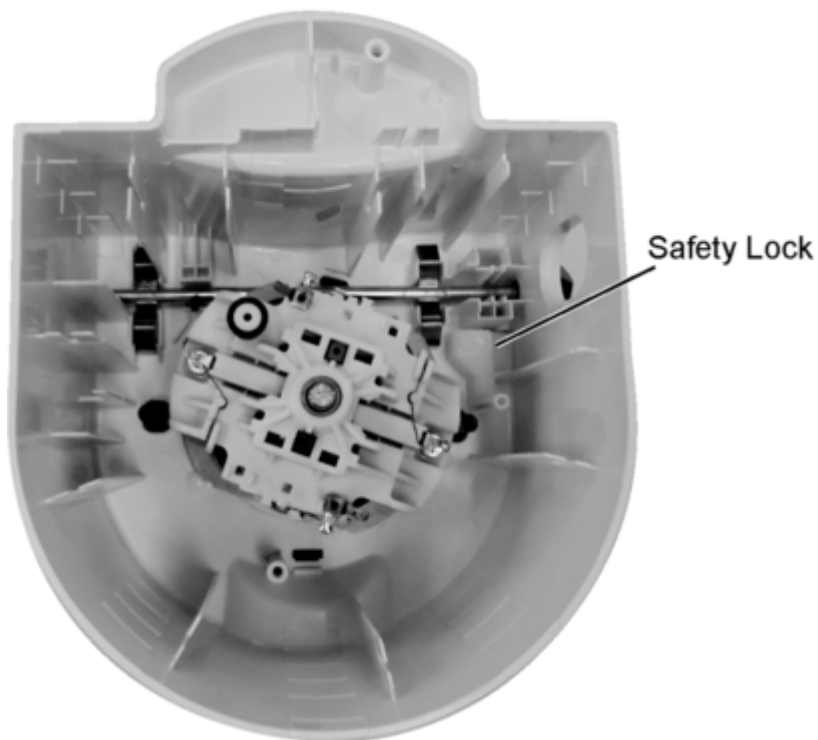

4. Remove the Connector Complete.
 1. Insert a flat screwdriver at the Motor Shaft slot.
 2. Hold the Connector Complete, and turn the screwdriver clockwise.
 3. Remove the Connector Complete with the Adjustment Ring.

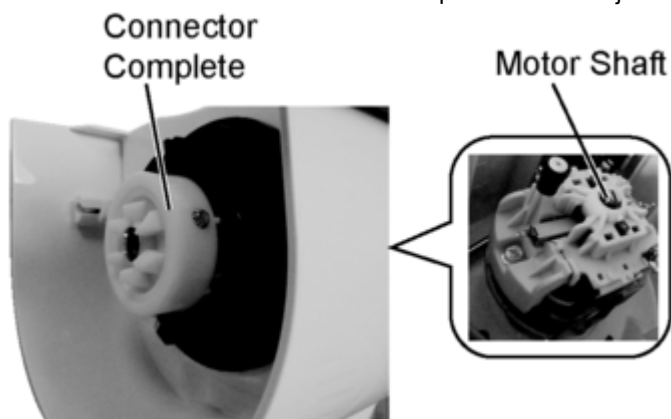

5. Release 3 catches from inside the Motor Housing to remove Juicer Attachment Rib.

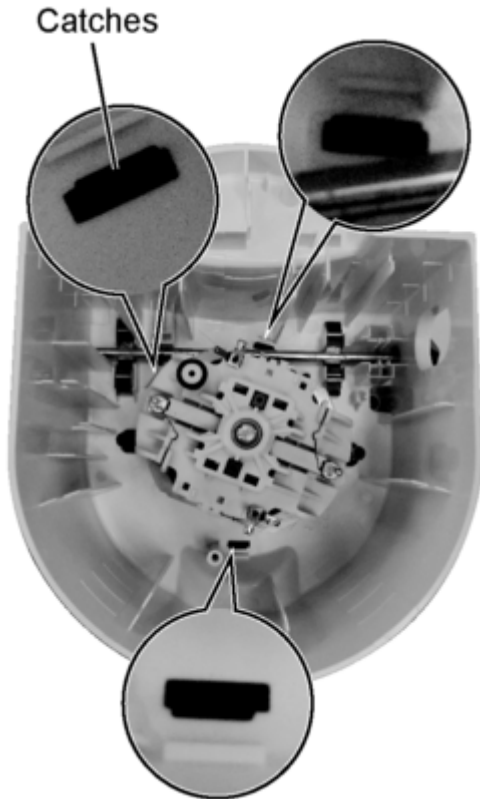

6. Remove the 3 screws holding the Motor Ass'y.

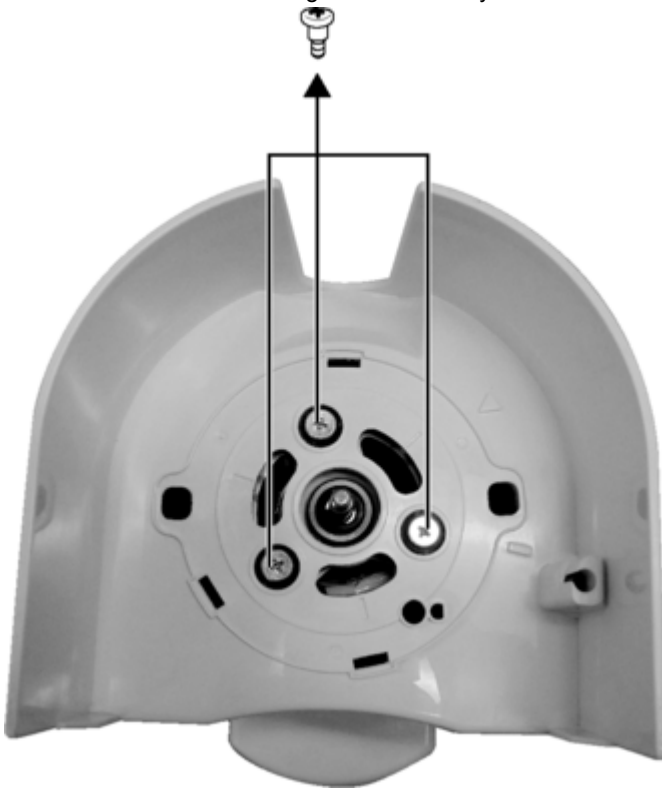

7. Reassembly
To reassemble the Motor Ass'y, reverse the disassembly procedures above.

Model No. : MJ-H300KSD/MJ-H300KSQ/MJ-H300KSL/MJ-H300KSN/MJ-H300KSM/MJ-H300KTJ/MJ-H300KTZ/MJ-H300KTK Exploded View

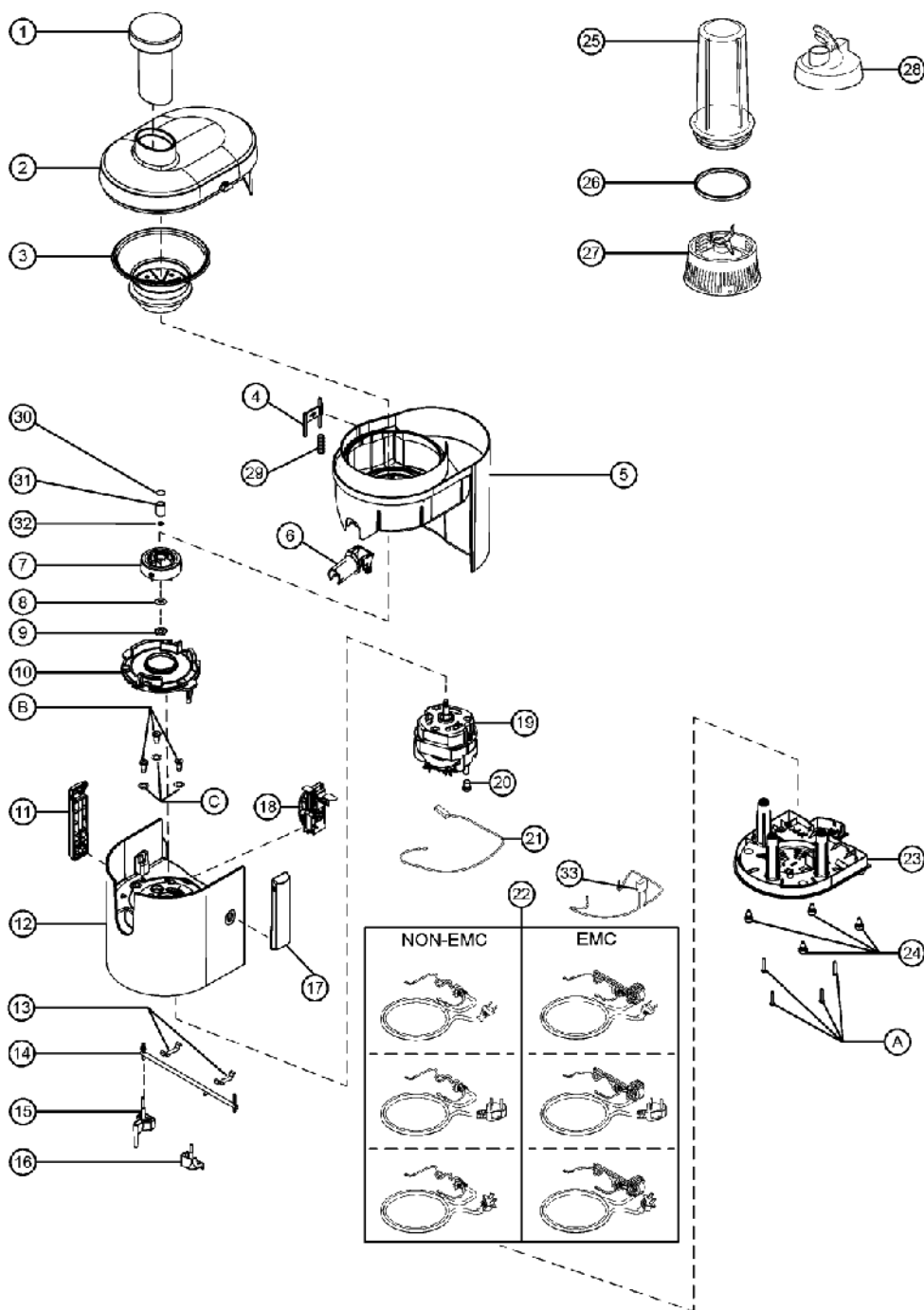



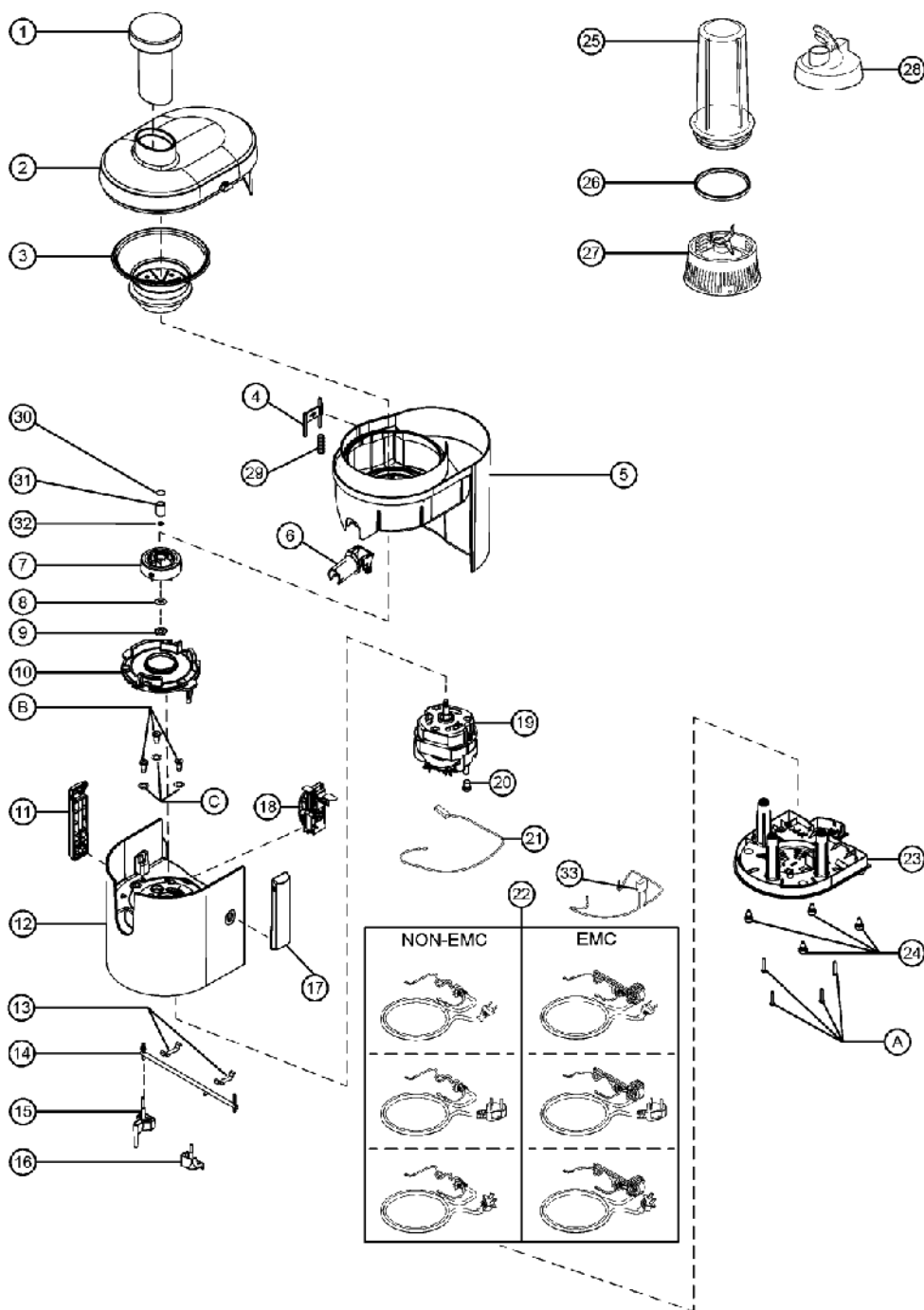



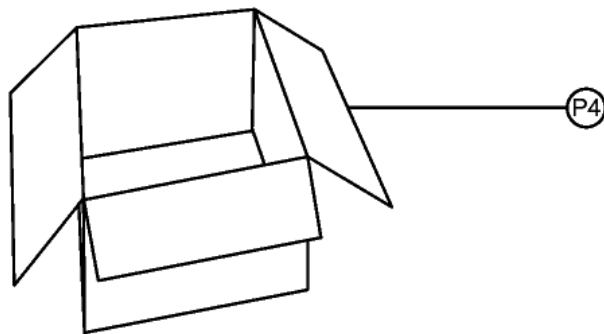
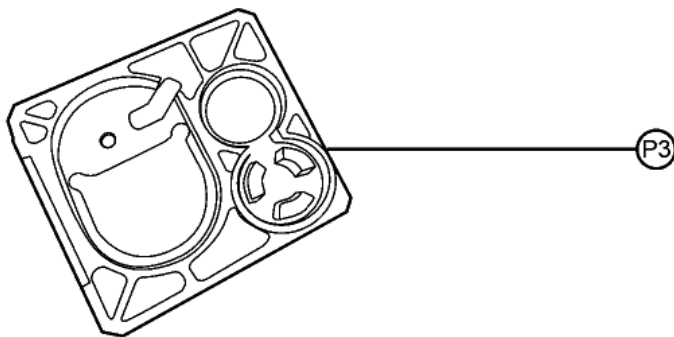
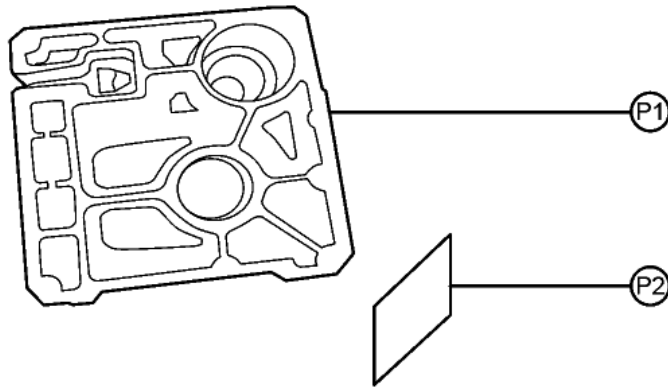





Model No. : MJ-H300KSD/MJ-H300KSQ/MJ-H300KSL/MJ-H300KSN/MJ-H300KSM/MJ-H300KTJ/MJ-H300KTZ/MJ-H300KTK Exploded View



Model No. : MJ-H300KSD/MJ-H300KSQ/MJ-H300KSL/MJ-H300KSN/MJ-H300KSM/MJ-H300KTJ/MJ-H300KTZ/MJ-H300KTK Packing View



Model No. : MJ-H300KSD/MJ-H300KSQ/MJ-H300KSL/MJ-H300KSN/MJ-H300KSM/MJ-H300KTJ/MJ-H300KTZ/MJ-H300KTK Parts List

Change	Safety	Ref. No.	Part No.	Part Name & Description	Q'ty	Remarks
PART LIST						
		1	AJD97M114-K0	PLUNGER UNIT	1	
		2	AJD12-157-H2	CONTAINER LID	1	MY / HK / IN / TH / EG / IQ / JO / PK / ZA / QA / AE / AF / KW / NG / OM / SA / SD
		2	AJD12-155-H2	CONTAINER LID	1	CN
		3	AJA04-155	SPINNER COMPLETE	1	
		4	AJG31-155	CONTAINER SHAFT	1	
		5	AJD90P1551K0	CONTAINER (U)	1	
		6	AJD57-157-K0	SPOUT UNIT	1	
		7	AJ07QA0700	CONNECTOR COMPLETE	1	
		8	AJJ01M114	ADJUSTMENT WASHER A	6	
		9	AJJ02M114	ADJUSTMENT WASHER B	1	
		10	AJB14-155-K0	BLENDER ATTACHMENT RIBS	1	
		11	AJG03-157-K0	CLAMP A	1	
		12	AJA11-157-K0	MOTOR HOUSING	1	
		13	AJG05-151	CLAMP SPRING	2	
		14	AJG97M1141	CLAMP SHAFT UNIT	1	
		15	AJG32-155	JUICER SHAFT	1	
		16	AJG33-155	BLENDER SHAFT	1	
		17	AJG04-157-K0	CLAMP B	1	
		18	AJN96-157-K0	SWITCH ASSEMBLY	1	
		19	AWKH8820-E	MOTOR ASSEMBLY	1	MY / IN / TH
		19	AWKH8820-F	MOTOR ASSEMBLY	1	HK / SA / NG / CN / EG / QA / AE / IQ / JO / PK / ZA / KW / AF / OM / SD
		20	AJ31A44200	BOTTOM RUBBER	1	
		21	AJP97-155	LEAD WIRE A (UNIT)	1	
		22	AJP99M157-K0	POWER CORD UNIT	1	IN / MY (C2)
		22	AJP99T157-K0	POWER CORD UNIT	1	TH (A2)
		22	AJP99H157-K0	POWER CORD UNIT	1	HK / QA / AE / KW / NG / SA / AF / OM / SD (S3)
		22	AJP99P157-K0	POWER CORD UNIT	1	CN (A2)
		22	AJP99W157-K0	POWER CORD UNIT	1	EG / IQ / JO / PK / ZA (C2)
		23	AJB02-155-K0	BOTTOM PLATE	1	
		24	AJ33A53000	FOOT RUBBER	4	
		25	AVE01M247-H2	CUP	1	
		26	AVE40M247	GASKET	1	
		27	AVE86M155K0	MOUNTING RING ASSEMBLY	1	
		28	AVA10M247-K0	COVER ASSEMBLY UNIT	1	
		29	AJG30-155	CONTAINER SPRING	1	
		30	AJF03-123	CONNECTOR INSULATION RUBBER	1	
		31	AJF02M1141	NUT	1	
		32	AJJ03M1141	TOOTH LOCK WASHER	1	
		33	AJQ98P155	CAPACITOR A (U)	1	HK / CN / EG / IQ / JO / PK / ZA / QA / AE / AF / KW / NG / OM / SA / SD
SCREWS						
		A	AJJ12-1511	STAR SHAPE SCREW		
		B	AX56A98100	MOTOR SCREW		
		C	AJB06M142	MOTOR SCREW RUBBER		
PACKING LIST						
		P1	AJZ02M155	TOP CUSHION		
		P2	AJZ50M157	OPERATING INSTRUCTION		MY / TH / IN / HK
		P2	AJZ50P157	OPERATING INSTRUCTION		CN
		P2	AJZ50J157	OPERATING INSTRUCTION		EG / SD / IQ / JO / PK / ZA / QA / AE / AF / KW / NG / OM / SA
		P3	AJZ03M155	BOTTOM CUSHION		

		P4	AJZ01M157	CARTON BOX	MY / TH / JO / PK / ZA / QA / AE / AF / KW / NG / OM / SA / SD / I Q / EG / IN
		P4	AJZ01P157	CARTON BOX	CN

Model No. : MJ-H300KSD/MJ-H300KSQ/MJ-H300KSL/MJ-H300KSN/MJ-H300KSM/MJ-H300KTJ/MJ-H300KTZ/MJ-H300KTK Parts List

Change	Safety	Ref. No.	Part No.	Part Name & Description	Q'ty	Remarks
		P4	AJZ01H157	CARTON BOX		HK