

Service Manual

Electric Steam Iron
NI-U755XR/U555SR/U455SS/U355TS

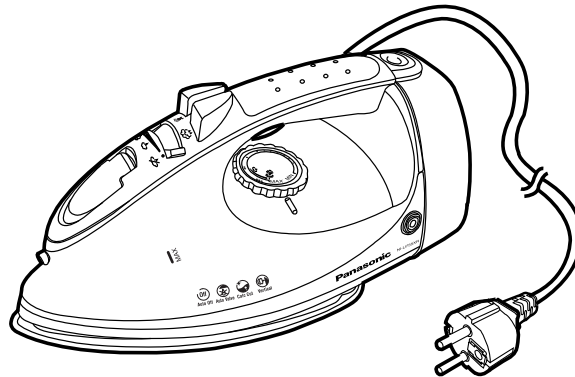

NI-U755XR

⚠ WARNING

This service information is designed for experienced repair technicians only and is not designed for use by the general public. It does not contain warning or cautions to advise non-technical individuals of potential dangers in attempting to service a product. Products powered by electricity should be serviced or repaired only by experienced professional technicians. Any attempt to service or repair the product or products dealt with in this service information by anyone else could result in serious injury or death.

SPECIFICATIONS

| Item \ Model No. | NI-U755XR | NI-U555SR | NI-U455SS | NI-U355TS |
|---------------------------|------------------------------|------------------------------|------------------------------|-----------------------------|
| Rating | 220-240V~ 2000-2400W 9.1-10A | 220-240V~ 2000-2400W 9.1-10A | 220-240V~ 2000-2400W 9.1-10A | 220-240V~ 1800-2150W 8.2-9A |
| | | 230V~ 2200W 9.6A | | 230V~ 2000W 8.7A |
| | | 240V~ 2150W 9.0A | | 240V~ 2150W 9.0A |
| | | 220V~ 2000W 9.1A | 220V~ 2000W 9.1A | 220V~ 1800W 8.2A |
| | | 220V~ 1200W 5.5A | | 220V~ 1200W 5.5A |
| | | | 110V~ 1100W 10A | 110V~ 1100W 10A |
| Weight | 1.8 kg | 1.8 kg | 1.6 kg | 1.5 kg |
| Dimensions(DxWxH) | 301mmX127.3mmX148.6mm | | | |
| Tank capacity | 300cc(10.50zs) | | | |
| Temperature control range | 90°C ~ 200°C | | | |
| Handle assembly color | Green(G) | Blue(H) | Violet(V) | Cyan(A) |

TABLE OF CONTENTS

| | |
|---------------------------|--------|
| COMPONENTS IDENTIFICATION | -----1 |
| PICTORIAL WIRING DIAGRAM | -----2 |
| SCHEMATIC DIAGRAM | -----2 |
| EXPLODED VIEW | -----3 |
| REPLACEMENT PARTS LIST | -----4 |
| DISASSEMBLY INSTRUCTIONS | -----5 |
| DIRECTION FOR REASSEMBLY | -----7 |

| | |
|-------------------------|---------|
| TEMPERATURE TEST METHOD | -----9 |
| STEAM TEST | -----10 |
| AUTO-SHUT-OFF TEST | -----10 |
| TROUBLE SHOOTING GUIDE | -----11 |
| PACKING INSTRUCTIONS | -----12 |
| PACKING PARTS LIST | -----13 |
| FEATURE TABLE | -----13 |

COMPONENTS IDENTIFICATION

NI-U755XR/U555SR

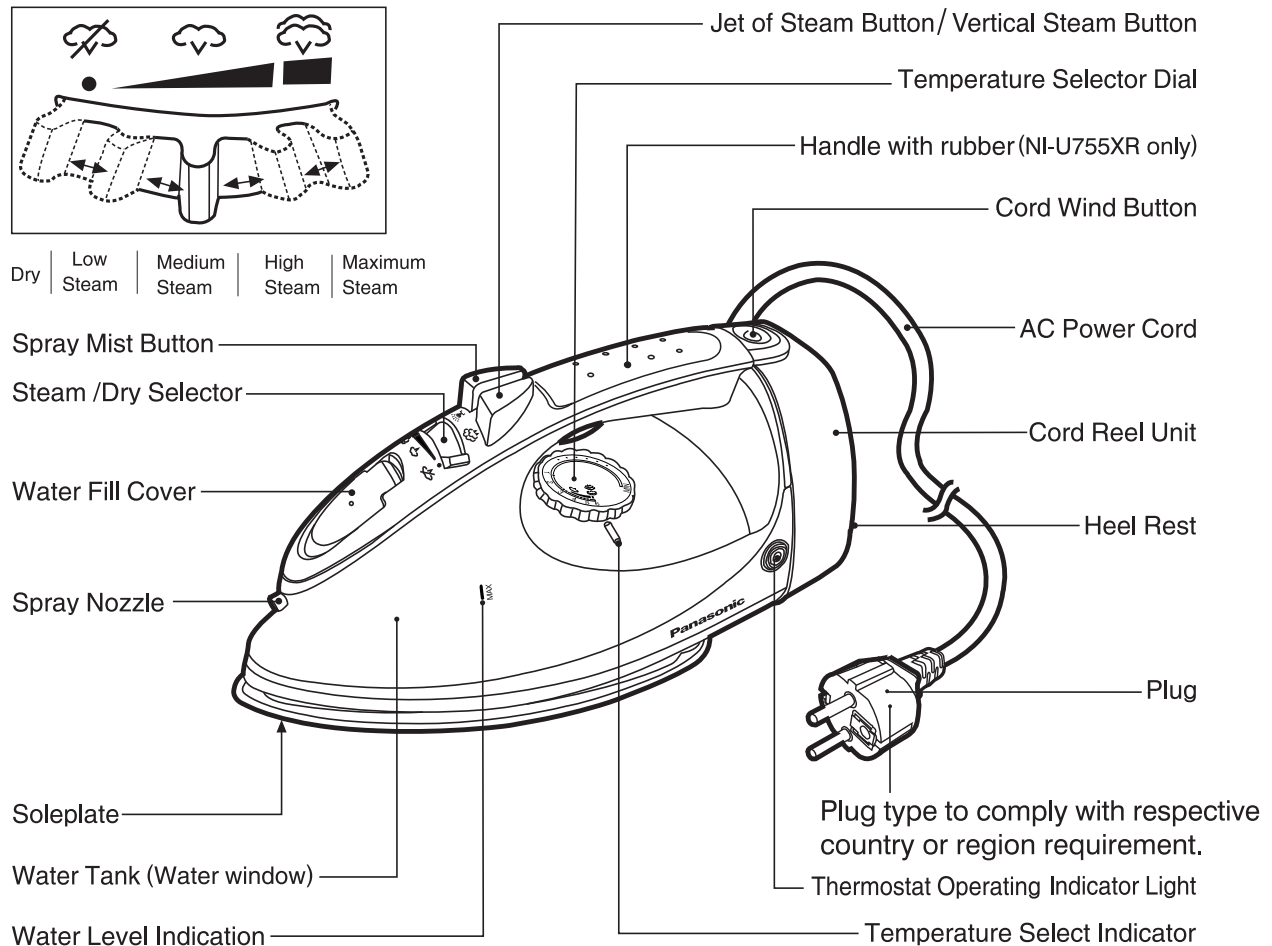

NI-U455SS/U355TS

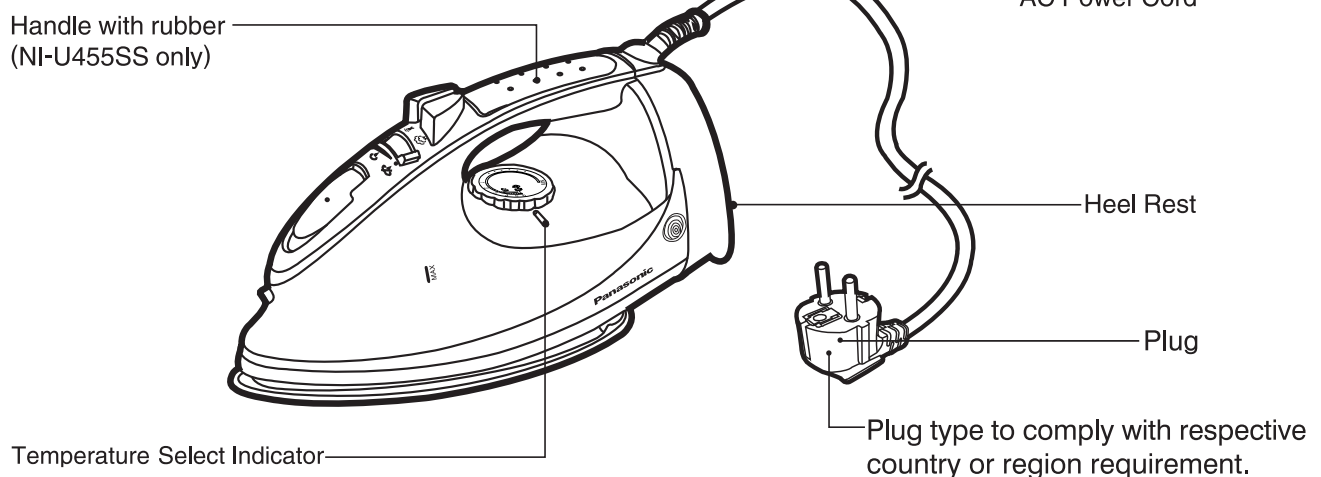

PICTORIAL WIRING DIAGRAM

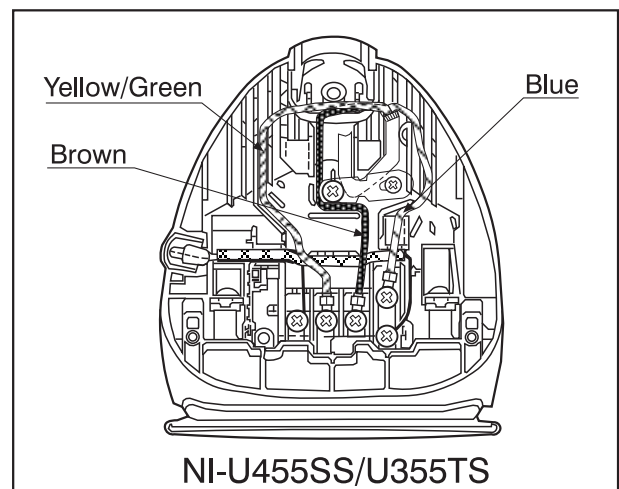
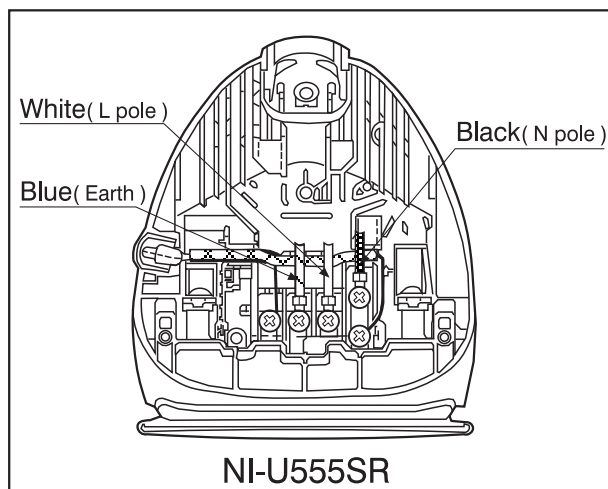
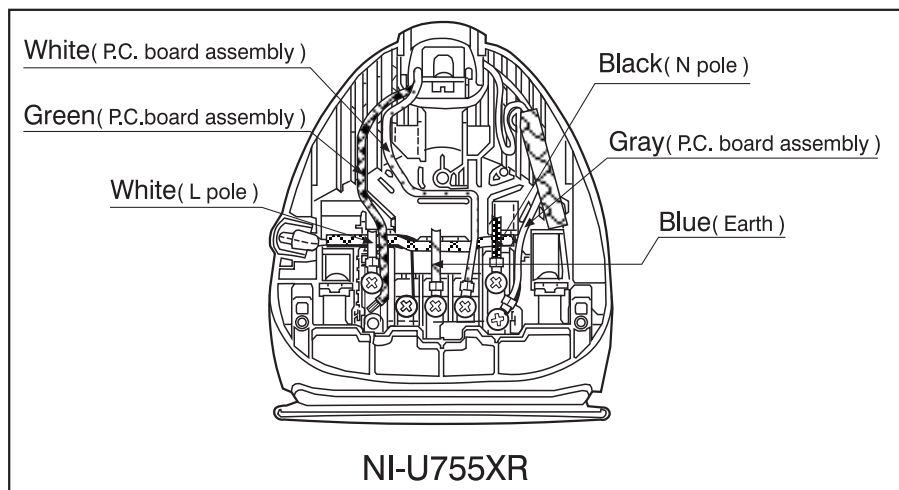

SCHEMATIC DIAGRAM

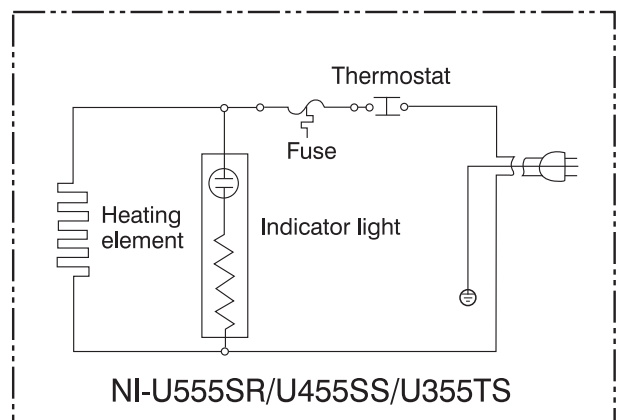
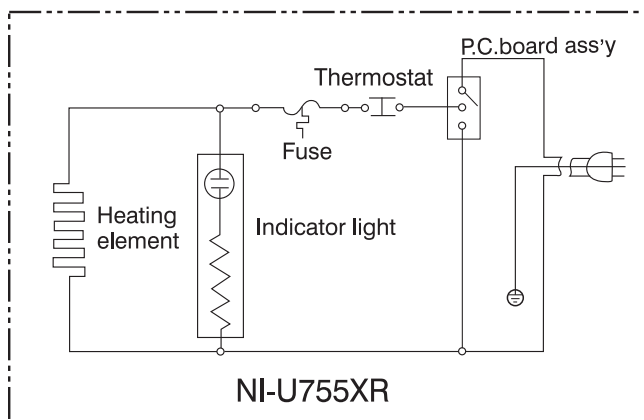

EXPLODED VIEW

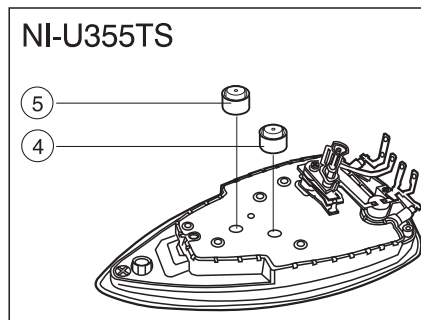
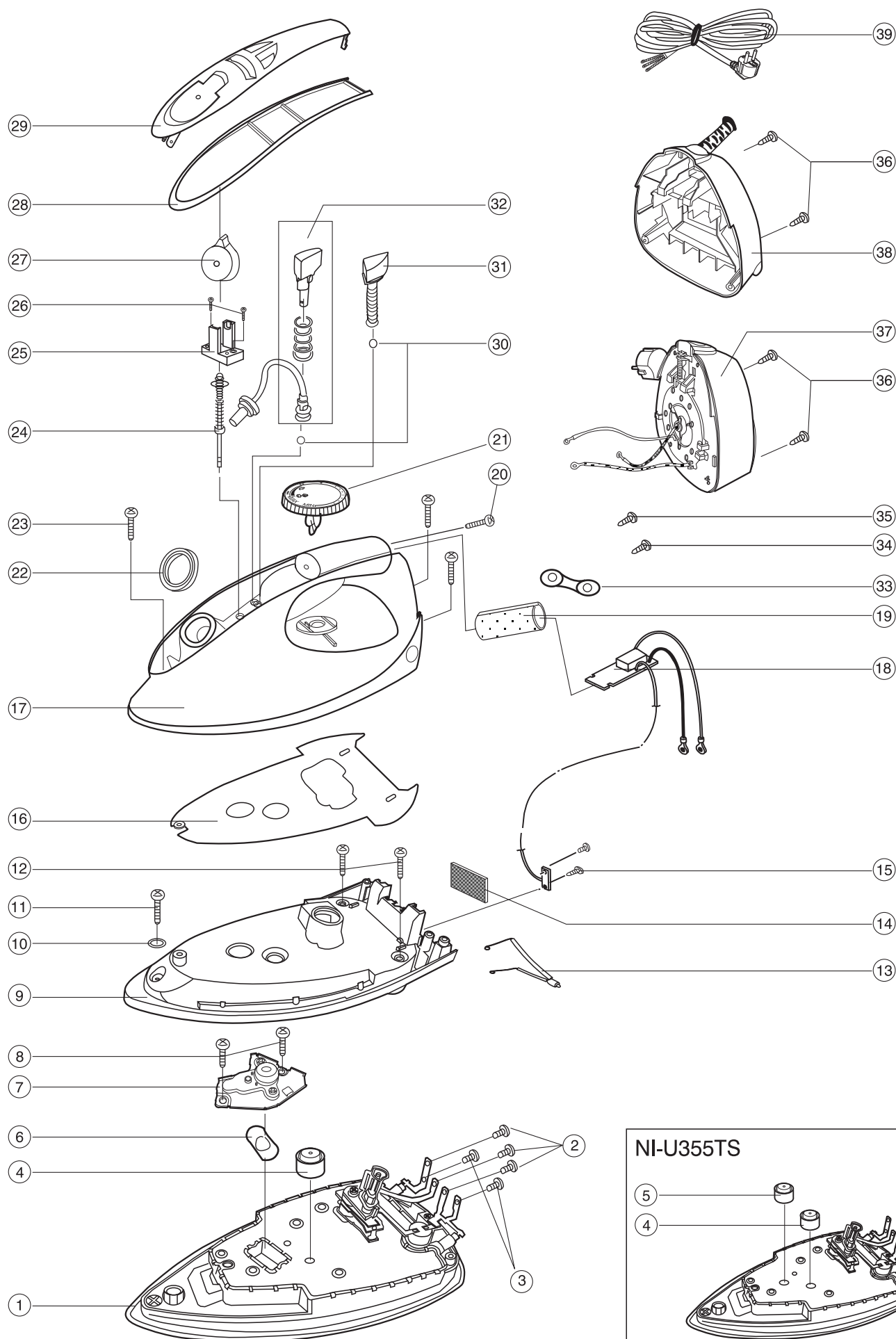

IMPORTANT SAFETY NOTICE

REPLACEMENT PARTS LIST

Components identified by “Ⓢ” mark have special characteristics important for safety. When replacing any of these components, use only manufacture's specified parts. If something abnormal discovered before using, please be quick to contact service agent.

Note: Ru=Russia; UAE=United Arab Emirates; Ir=Iran; Om=Oman; Qa=Qatar; KW=Koweit; SA=Saudi Arabia; Th=Thailand; SG(im)=Singapore(import); S.Af=South Africa; SG(ex)=Singapore(export); HK=Hongkong; TW=Taiwan; Ma=Malaysia

| REF. NO. | PART NAME | PART NO. | Q'TY /SET | REMARKS |
|----------|------------------------------|--------------|-----------|---|
| Ⓢ 1 | Soleplate assembly | ANI1296PM87 | 1 | NI-U755XR Ru |
| | | ANI1296PM88P | 1 | NI-U555SR Ru/UAE/Ir/Om/Qa/Th/SG(im)/HK |
| | | | 1 | NI-U455SS Ru/HK |
| | | ANI1266PN24P | 1 | NI-U555SR SA |
| | | ANI1269PN24P | 1 | NI-U555SR KW/Ma |
| | | ANI1255PN25P | 1 | NI-U455SS TW |
| | | ANI1069PM89S | 1 | NI-U355TS Ru/KW/UAE/Ir/Om/Qa/Th/SG(im)/S.Af/Ma/HK |
| | | ANI1066PN23S | 1 | NI-U355TS SA |
| 2 | Terminal screws (A) | ANI1255PN23S | 1 | NI-U355TS TW |
| | | ANI9009-665 | 4 | NI-U755XR |
| 3 | Terminal screws (B) | ANI9009-665 | 3 | NI-U555SR/U455SS/U355TS |
| | | ANI9009-A43 | 2 | |
| 4 | Packing (C) | ANI1472-K86Z | 1 | |
| 5 | Packing (B) | ANI1471-M60 | 1 | NI-U355TS |
| 6 | Disc bimetal | ANI1820-M87 | 1 | NI-U755XR Ru |
| | | | 1 | NI-U555SR Ru/KW/UAE/Ir/Om/Qa/Th/SG(im)/Ma/HK |
| | | | 1 | NI-U455SS HK |
| | | ANI1820-A04 | 1 | NI-U555SR SA |
| | | | 1 | NI-U455SS TW |
| 7 | Auto-valve assembly | ANI1822-M87 | 1 | NI-U755XR/U555SR/U455SS |
| 8 | Fixed plate screws | ANI9020-022 | 2 | NI-U755XR/U555SR/U455SS |
| 9 | Heat-insulated plate | ANI2340-M87X | 1 | NI-U755XR |
| | | ANI2340-M88X | 1 | NI-U555SR/U455SS/U355TS |
| 10 | Adiabatic gasket | ANI2346-K09 | 1 | |
| 11 | Heat-insulated plate screw A | XTN4+22JV | 1 | |
| 12 | Heat-insulated plate screw B | XTV4+20JV | 2 | |
| Ⓢ 13 | Indicator light assembly | ANI5600-A61 | 1 | TW |
| | | ANI5600-M87 | 1 | Ru/SA/KW/UAE/Ir/Om/Qa/Th/SG(im)/Ma/HK |
| 14 | Bear burning fiber | ANI2351-A01 | 1 | |
| 15 | Terminal plate screw | ANI9022-003 | 1 | NI-U755XR |
| 16 | Heat-insulated cover | ANI2356-M87 | 1 | |
| 17 | Handle assembly | ANI2000-M87H | 1 | NI-U755XR Ru |
| | | ANI2000-N24C | 1 | NI-U555SR SA |
| | | ANI2000-M88C | 1 | NI-U555SR Ru/KW/UAE/Ir/Om/Qa/Th/SG(im)/Ma/TW/HK |
| | | ANI2000-N25J | 1 | NI-U455SS TW |
| | | ANI2000-M96J | 1 | NI-U455SS HK |
| | | ANI2000-N23H | 1 | NI-U355TS SA/TW |
| | | ANI2000-M89H | 1 | NI-U355TS Ru/KW/UAE/Ir/Om/Qa/Th/SG(im)/S.Af/Ma/HK |
| | | | | |
| Ⓢ 18 | P.C. board assembly | ANI5541-M87 | 1 | NI-U755XR |
| | | ANI5327-499 | 1 | NI-U755XR |
| 20 | Handle cover screw | ANI9022-024 | 1 | |
| 21 | Dial thermo | ANI2160-M87J | 1 | Ru |
| | | ANI2186-N24J | 1 | SA/Th/TW |
| | | ANI2160-N24J | 1 | Ru/KW/UAE/Ir/Om/Qa/SG(im)/S.Af/Ma/HK |
| 22 | Water inlet rubber | ANI1633-436 | 1 | |
| 23 | Handle screws | XTW4+16EFN | 3 | |

| REF. NO. | PART NAME | PART NO. | Q'TY /SET | REMARKS |
|----------|------------------------------|--------------|-----------|---|
| 24 | Valve steam assembly | ANI1850-M87 | 1 | NI-U755XR Ru |
| | | | 1 | NI-U555SR Ru/UAE/Ir/Om/Qa/KW/Th/SG(im)/Ma/HK |
| | | | 1 | NI-U455SS Ru/HK |
| | | ANI1850-A61 | 1 | NI-U555SR SA |
| | | | 1 | NI-U455SS TW |
| | | | 1 | NI-U355TS SA/TW |
| | | ANI1850-M89 | 1 | NI-U355TS Ru/UAE/Ir/Om/Qa/KW/Th/SG(im)/S.Af/Ma/HK |
| 25 | Steam/Dry selector supporter | ANI2111-M87 | 2 | |
| 26 | Supporter screws | XTN3+8BVW | 1 | |
| 27 | Steam/Dry selector | ANI2110-M87X | 1 | |
| 28 | Handle cover (B) | ANI2070-M87S | 1 | NI-U755XR |
| | | ANI2070-M88K | 1 | NI-U555SR |
| | | ANI2070-M88X | 1 | NI-U455SS/U355TS |
| | | ANI2060-M872 | 1 | NI-U755XR |
| 29 | Handle cover (A) | ANI2060-M88X | 1 | NI-U555SR/U355TS |
| | | ANI2060-M879 | 1 | NI-U455SS |
| | | ANI1701-344 | 2 | |
| 30 | Balls | ANI1705-M87S | 1 | NI-U755XR |
| 31 | Jet-of-steam button assembly | ANI1705-M88X | 1 | NI-U555SR/U455SS |
| | | ANI1705-M89X | 1 | NI-U355TS |
| | | ANI2140-M87S | 1 | NI-U755XR |
| 32 | Spray nozzle assembly | ANI2140-M88X | 1 | NI-U555SR/U455SS |
| | | ANI2140-M89X | 1 | NI-U355TS |
| | | ANI4663-K53X | 1 | NI-U455SS/U355TS |
| 33 | Fixed board of the cord | ANI9021-022 | 1 | NI-U455SS/U355TS |
| 34 | Fixed board screw A | XTW4+12EFN | 1 | NI-U455SS/U355TS |
| 35 | Fixed board screw B | XTN3+25BFN | 2 | |
| 36 | Rear handle screws | ANI2529-M87J | 1 | NI-U755XR Ru |
| ⑤ 37 | Cord reel unit | ANI2529-M88K | 1 | NI-U555SR Ru |
| | | ANI2529BN24K | 1 | NI-U555SR SA |
| | | ANI2529IN24K | 1 | NI-U555SR KW |
| | | ANI2529QN24K | 1 | NI-U555SR UAE |
| | | ANI2529LN24K | 1 | NI-U555SR Ir/Om/Qa |
| | | ANI2529XN24K | 1 | NI-U555SR Th |
| | | ANI2529ZN24K | 1 | NI-U555SR SG(im) |
| | | ANI2529FN24K | 1 | NI-U555SR Ma |
| | | ANI2529AN24K | 1 | NI-U555SR HK |
| | | ANI2039-M96X | 1 | NI-U455SS Ru |
| | | ANI2039WN25X | 1 | NI-U455SS TW |
| | | ANI2039AN25X | 1 | NI-U455SS HK |
| | | ANI2039-M89X | 1 | NI-U355TS Ru |
| | | ANI2039BN23X | 1 | NI-U355TS SA |
| | | ANI2039IN23X | 1 | NI-U355TS KW |
| | | ANI2039QN23X | 1 | NI-U355TS UAE |
| | | ANI2039LN23X | 1 | NI-U355TS Ir/Om/Qa |
| | | ANI2039XN23X | 1 | NI-U355TS Th |
| | | ANI2039ZN23X | 1 | NI-U355TS SG(im)/S.Af |
| | | ANI2039FN23X | 1 | NI-U355TS Ma |
| 38 | Rear handle cover | ANI2039WN23X | 1 | NI-U355TS TW |
| | | ANI2039AN23X | 1 | NI-U355TS HK |
| | | ANI4511RM89 | 1 | NI-U455SS Ru |
| | | | 1 | NI-U355TS Ru/Ir/Om/Qa |
| | | ANI4510XN23 | 1 | NI-U355TS Th |
| | | ANI4562WN23 | 1 | NI-U455SS TW |
| | | | 1 | NI-U355TS TW |
| | | ANI4572BN23 | 1 | NI-U455SS HK |
| | | | 1 | NI-U355TS SA/KW/UAE/Th/SG(im)/S.Af/Ma/HK |
| | | | 1 | |
| ⑤ 39 | Cord assembly | | | |
| | | | | |
| | | | | |
| | | | | |
| | | | | |

DISASSEMBLY INSTRUCTIONS

1. REMOVAL OF REAR HANDLE COVER OR CORD REEL UNIT

Remove the two Rear handle screws indicated by arrows and:

- Pull the Rear handle cover toward you.
(NI-U455SS/U355TS)
- Pull the Cord reel unit toward you.
(NI-U755XR/U555SR)

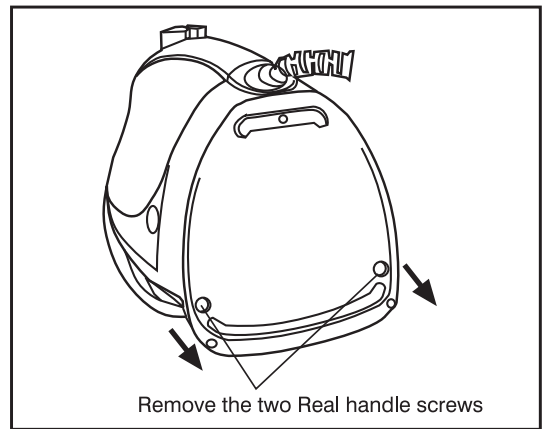

2. REMOVAL OF TERMINAL SCREWS

Remove all the screws holding the Cord, the Indicator light and the complete control circuit.

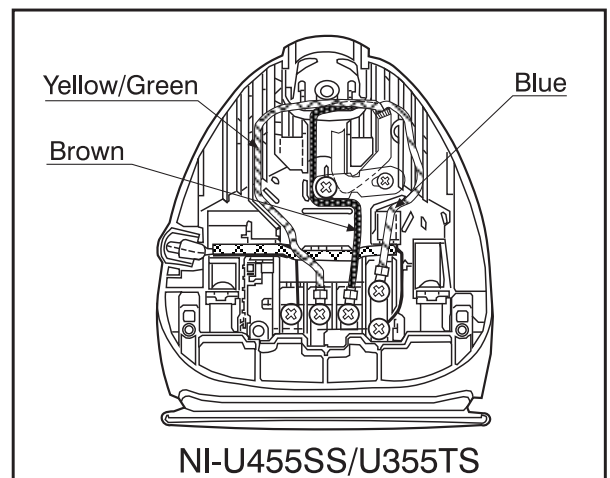
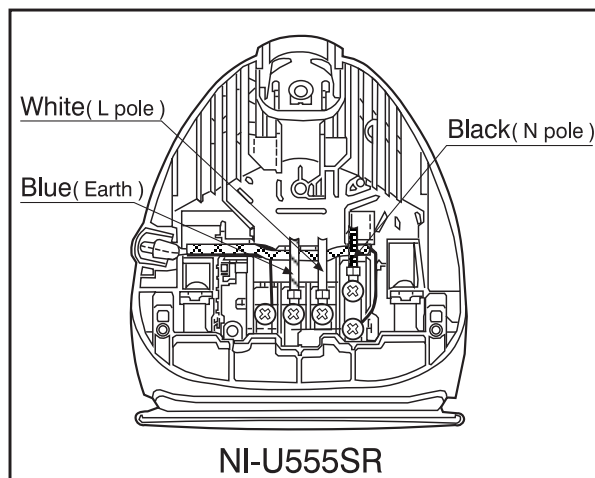
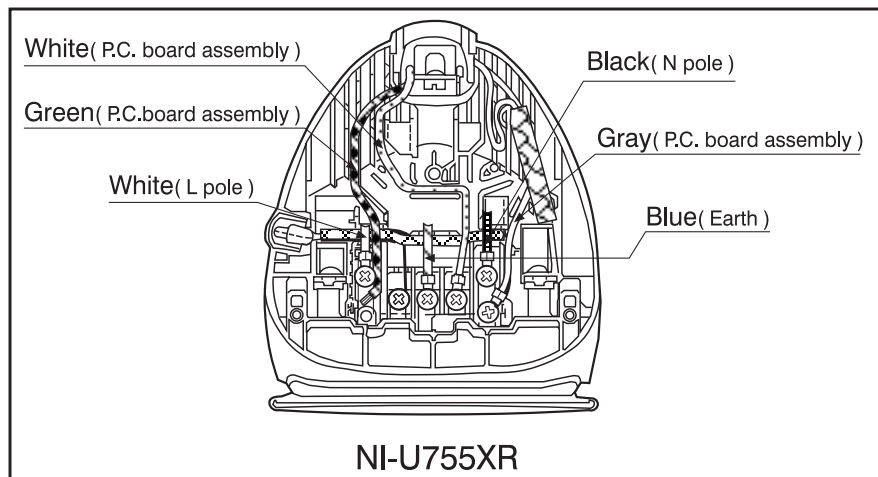

3. REMOVAL OF DIAL THERMO

Turn the Dial thermo to " MAX " or " 6 " position and lift it with a small screwdriver.

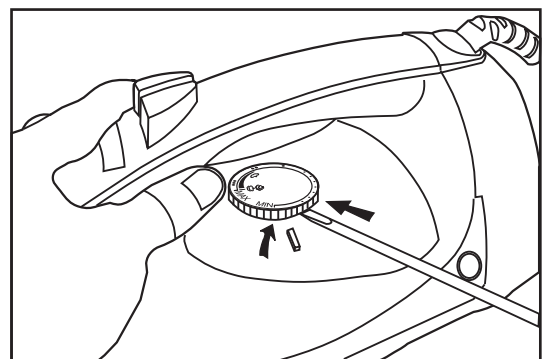

4. REMOVAL OF HANDLE COVER (A) AND HANDLE COVER (B)

- Remove the Terminal screws and then remove the P.C. board assembly. (NI-U755XR only)
- Remove the Handle cover screw and move gently the Steam/Dry selector toward left down direction with left thumb, in order to loose the Handle cover and lift it.
- Lift the Steam/Dry selector, Steam/Dry selector supporter, Valve steam assembly, Spray nozzle assembly, Balls and Water inlet rubber from Handle assembly.

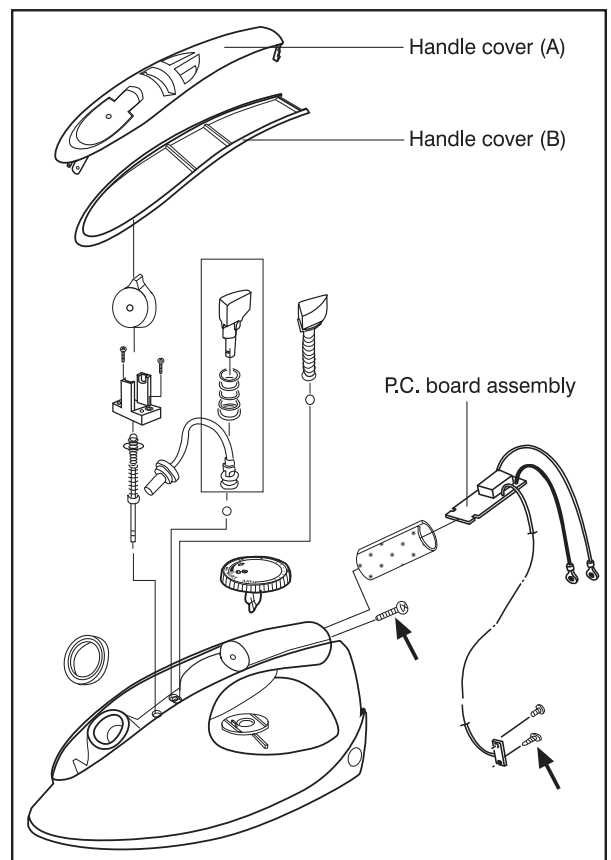

5. REMOVAL OF HANDLE ASSEMBLY

- Firstly, lift the Indicator light assembly from the Heat-insulated plate.
- Secondly, remove the three Handle screws by arrows and then lift the Handle assembly.

6. REMOVAL OF HEAT-INSULATED PLATE

- Remove the three screws indicated by arrows and lift the Heat-insulated plate.
- Lift the Packing (C).
- Lift the Packing (B). (NI-U355TS only)

7. REMOVAL OF AUTO-VALVE ASSEMBLY (NI-U755XR/U555SR/U455SS only)

Remove the Fixed plate screws by arrows and lift the Auto-valve assembly, then remove the Disc bimetal.

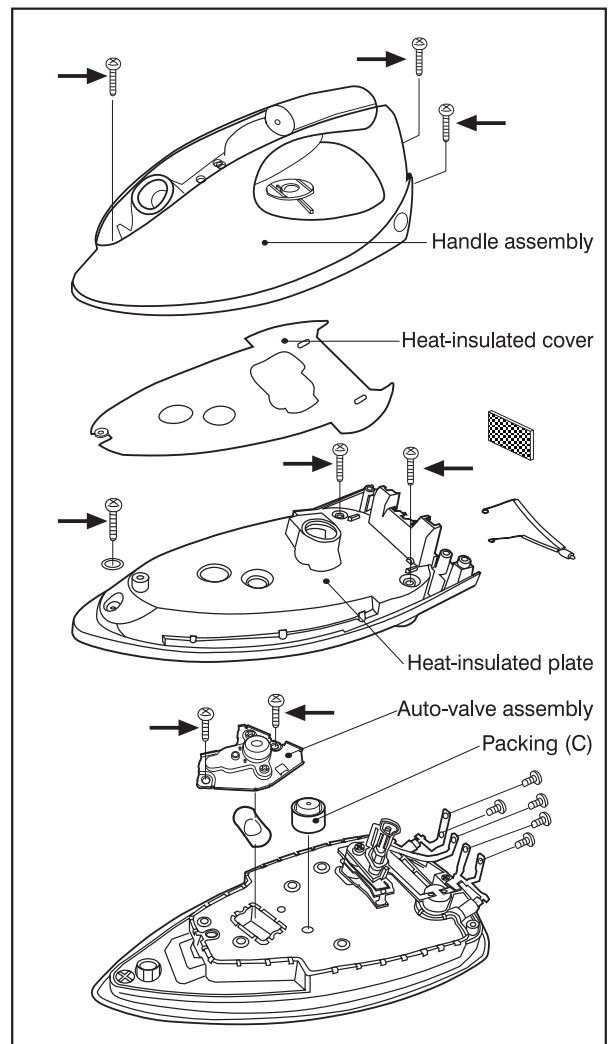

DIRECTIONS FOR REASSEMBLY

(REASSEMBLY IN THE ORDER REVERSES FOR THAT OF DISSEMBLY)

WARNING

1. Please connect the wires exactly according to the circuit diagram when installing, or it may lead to accidents of electrical leakage, smoke, injury etc.
2. During installing, all the screws must be fully fixed to avoid loosening and dropping, which may result in injury and safety accidents because of the increasing current.
3. If new components need to be replaced, you must firstly check them from the REPLACEMENT PARTS LIST. Make sure that they are the proper components before installing.

IMPORTANT REASSEMBLY NOTICE

1. INSTALLATION OF HEAT-INSULATED PLATE

Before installing the Heat-insulated plate, ought to turn the Dial thermo in a clockwise direction to the end of position.

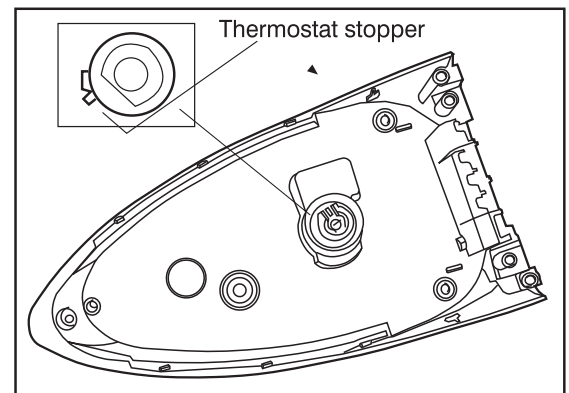

2. INSTALLATION OF DIAL THERMO

Before installing the Dial thermo, ought to get its number " MAX " or " 6 " position aimed at the scale position, then install it into Handle assembly.

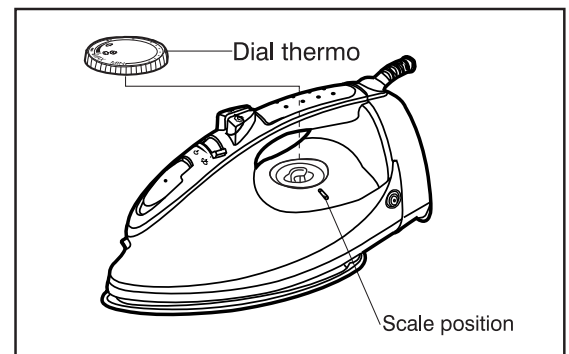

3. CONNECTION OF THE CORD

Properly wire the AC power cord, the Indicator light cord and the complete control circuit cord as shown in the figure.

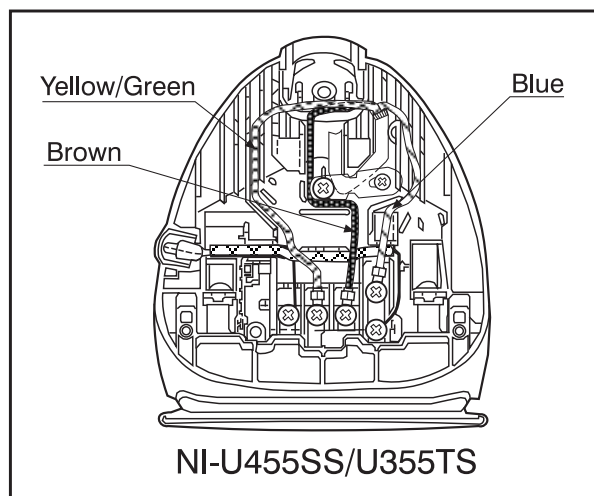
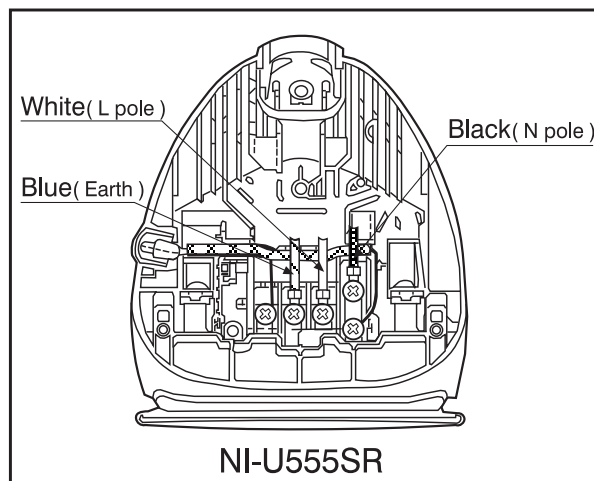
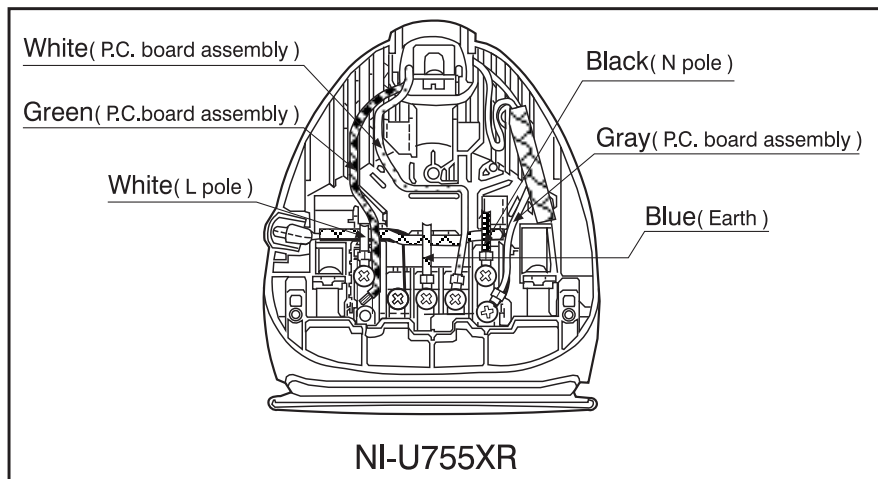

TEMPERATURE TEST METHOD (CONFIRM WITH AN OHMMETER)

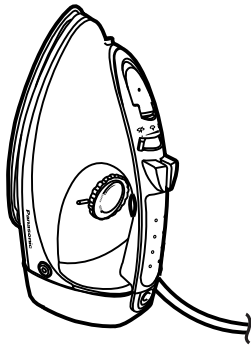
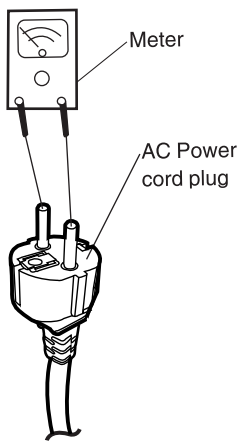
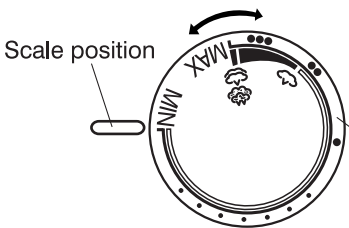
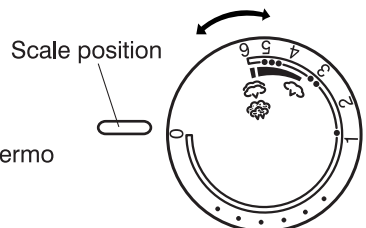
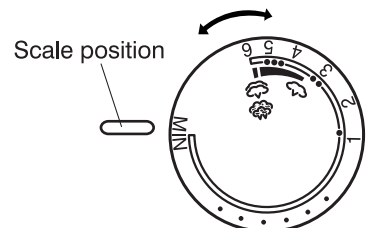
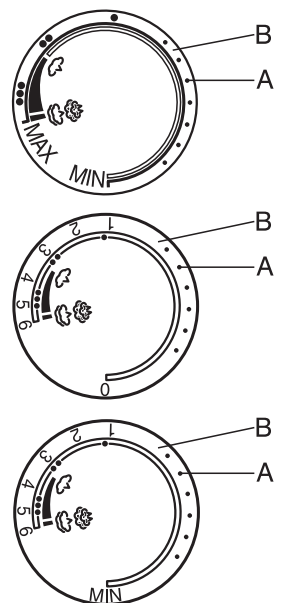
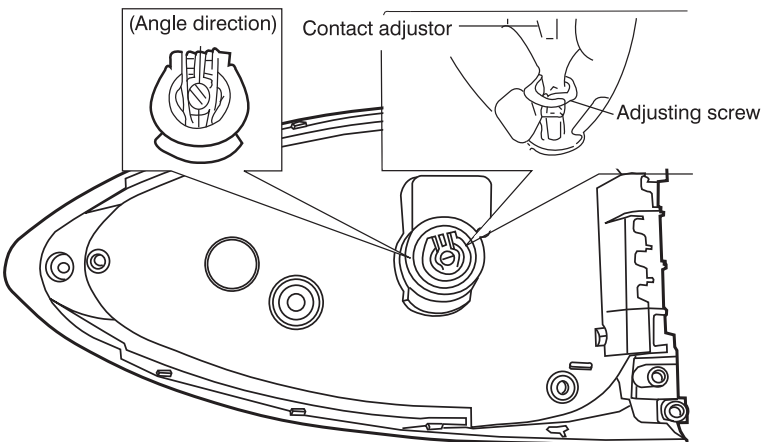
| | |
|--|---|
| <p>Step 1.</p> <ul style="list-style-type: none"> To cool,unplug and allow the iron to room temperature.  | <p>Step 2.</p> <ul style="list-style-type: none"> Attach the ohmmeter leads across both plug prongs.  |
| <p>Step 3.</p> <ul style="list-style-type: none"> Adjust the Dial thermo to the " MIN " or " 0 " position. Meter should indicate open condition. <p><u>Temperature selector</u></p> <p>• — Point to adjust dial</p> <div style="display: flex; justify-content: space-around; align-items: flex-end;"> <div style="text-align: center;">  <p>(A):Russia</p> </div> <div style="text-align: center;">  <p>(B):Saudi Arabia/Thailand/Taiwan</p> </div> <div style="text-align: center;">  <p>(C):The others</p> </div> </div> | |
| <p>Step 4.</p> <ul style="list-style-type: none"> If the meter needle deflects while the Dial thermo is within the range shown by arrows (A) and (B) then iron is working normal.  | <p>Step 5.</p> <ul style="list-style-type: none"> If the Dial thermo causes the meter to deflect before point (A) ,turn the adjusting screw clockwise 1/4 turn then go back to Step3. If the Dial thermo causes the meter to deflect beyond point (B) ,turn the adjusting screw counterclockwise 1/4 turn then proceed Step 3.  <p>NOTE: While adjusting for the proper setting it may be necessary to repeat Step 4 several times.</p> |

STEAM TEST

1. Fill the iron as described in " HOW TO FILL WITH WATER " in the operation instructions.
2. Set the iron vertically and make sure the Dial thermo is set to " MIN " or " 0 ".
Plug the AC cord into the electrical outlet.
3. Set the Dial thermo to the "☺" indication. (red area).
4. Preheat the iron until the Indicator light goes out, usually in about 1 minute.
5. Hold the iron horizontally and move the Steam/Dry selector into the steam position. Now steam ironing can begin.
6. Anytime the iron is set vertically the steaming action will stop.

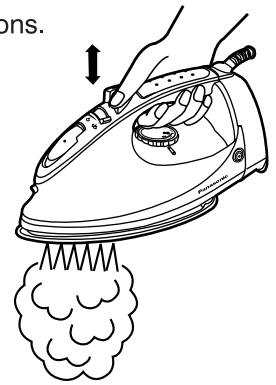

AUTO-SHUT-OFF TEST (NI-U755XR only)

1. When the iron is not moved with its soleplate facing down(A) or on its side(B) for approx.1 minute, the iron will automatically shut off the power to the heater by itself.

(A)

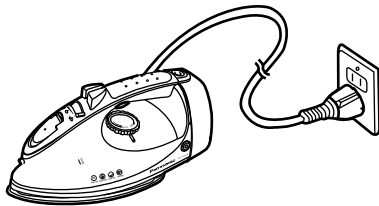

1 minute to "OFF"

(B)

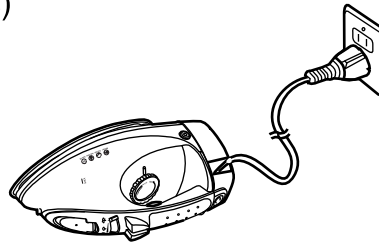

1 minute to "OFF"

2. When the iron is not moved with its Heel Rest(C) for approx.10 minutes, the iron will automatically shut off the power to the heater by itself.

(C)

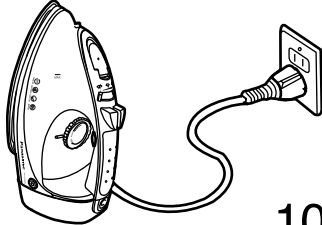

10 minutes to "OFF"

3. To resume ironing and turn the iron back on, simply move the iron in any way.
If the iron has been left in the auto shut off mode for 10 minutes or more, Allow the iron to reheat until the Indicator light goes out,

VOTE: 1. The Auto-shut-off system works regardless of Dial thermo, even at " MIN " position.
2. When you finish ironing, always unplug the iron.

TROUBLE SHOOTING GUIDE

| CONDITION | CHECK POINT | CAUSE | REMEDY |
|--|--|--|--|
| No steam or poor steaming force (Perform STEAM TEST refer to Page 8.) | <p>A. Check if Dial thermo is set at " ☹️ ".(red area on Dial thermo)</p> <p>B. Remove the Handle assembly, fill it with water and set the Steam/Dry selector in steam position while Handle assembly is held horizontally.</p> <p>C. Check temperature control range (TEMPERATURE TEST METHOD).</p> <p>D. Check for clogged steam vents on the Soleplate.</p> | <p>A-1. Too low a temperature may cause poor discharge of steam or water dropping.</p> <p>B-1. If water does not drip constantly from the bottom opening, it may be clogged.</p> <p>C-1. Refer to Item A-1.</p> <p>D-1. Clogged steam vents may cause poor steaming.</p> | <ul style="list-style-type: none"> • Set Dial thermo at " ☺️ " . • Clean opening or replace Handle assembly if necessary. • Reset the adjusting screw or refer to TEMPERATURE TEST METHOD,Page 7. • Clean steam vents. |
| Water leaks from steam vents | <p>E. Refer to item A.</p> <p>F. Refer to item C.</p> | | |
| White powder like particles come out from steam vents while steaming (Perform STEAM TEST refer to Page8.) | <p>G . Check if white particles come out while steaming.</p> | <p>G-1. Improper care for the iron after each use and/or high mineral content water.</p> | <ul style="list-style-type: none"> • Follow the collect instructions for carrying and storing the iron. • If Soleplate is damaged it will have to be replaced. |
| No spray mist | <p>H. Check if the Spray mist button operates correctly.</p> <p>I. Check if there is any clogging of nozzle.</p> | <p>H-1. The Spray mist button is defective.</p> <p>I -1. The Spray nozzle is clogged.</p> | <ul style="list-style-type: none"> • Replace the Spray nozzle assembly. • Clean the nozzle. |
| Jet-of-steam is no put out | <p>J. Check if Jet-of-steam button operates correctly.</p> <p>K. Check if the Balls are put in.</p> <p>L. Temperature setting is too low.</p> | <p>J-1. The Jet-of-steam button is defective.</p> <p>K-1. The Balls are not put in.</p> <p>L-1. Temperature setting is too low.</p> | <ul style="list-style-type: none"> • Replace the Jet-of-steam button assembly. • Put in the Balls. • Adjust the temperature or replace Soleplate. |

PACKING INSTRUCTIONS

(1) NI-U755XR/U555SR:

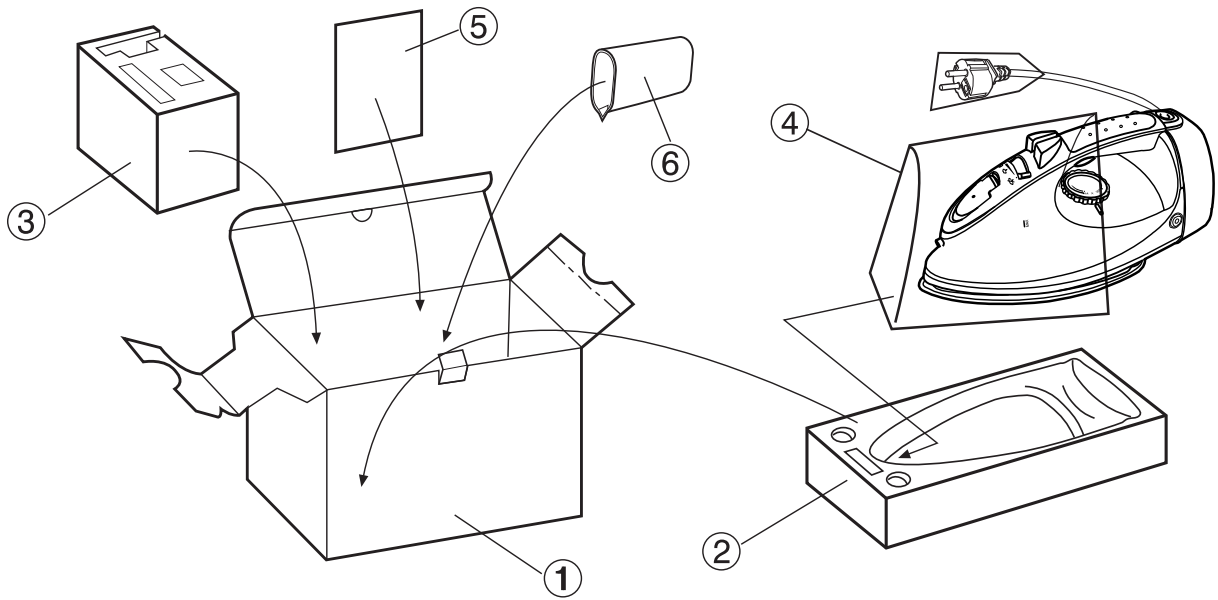

(2) NI-U455SS/U355TS:

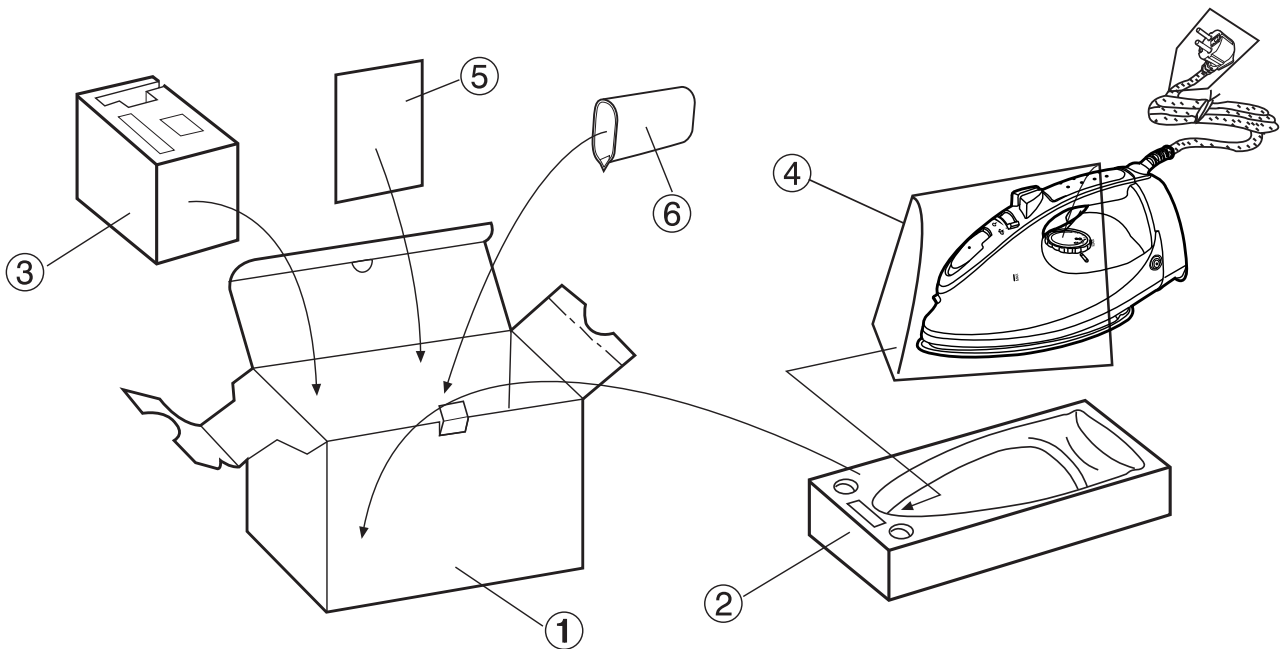

PACKING PARTS LIST

| REF. NO. | PART NAME | PART NO. | Q'TY /SET | REMARKS |
|----------|------------------------|--------------|-----------|-------------------------|
| 1 | Box | ANI8100RM87 | 1 | NI-U755XR Ru |
| | | ANI8100RM88 | 1 | NI-U555SR Ru |
| | | ANI8100BN24C | 1 | NI-U555SR SA |
| | | ANI8100IN24C | 1 | NI-U555SR KW |
| | | ANI8100QN24C | 1 | NI-U555SR UAE |
| | | ANI8100LN24C | 1 | NI-U555SR Ir/Om/Qa |
| | | ANI8100XN24C | 1 | NI-U555SR Th |
| | | ANI8100ZN24C | 1 | NI-U555SR SG(im) |
| | | ANI8100FN24C | 1 | NI-U555SR Ma |
| | | ANI8100AN24C | 1 | NI-U555SR HK |
| | | ANI8100RM96 | 1 | NI-U455SS Ru |
| | | ANI8100WN25J | 1 | NI-U455SS TW |
| | | ANI8100AN25J | 1 | NI-U455SS HK |
| | | ANI8100RM89 | 1 | NI-U355TS Ru |
| | | ANI8100BN23H | 1 | NI-U355TS SA |
| | | ANI8100IN23H | 1 | NI-U355TS KW |
| | | ANI8100QN23H | 1 | NI-U355TS UAE |
| | | ANI8100LN23H | 1 | NI-U355TS Ir/Om/Qa |
| | | ANI8100XN23H | 1 | NI-U355TS Th |
| | | ANI8100ZN23H | 1 | NI-U355TS SG(im)/S.Af |
| | | ANI8100FN23H | 1 | NI-U355TS Ma |
| | | ANI8100WN23H | 1 | NI-U355TS TW |
| | | ANI8100AN23H | 1 | NI-U355TS HK |
| 2 | Packing filler A | ANI8401-M87 | 1 | |
| 3 | Packing filler B | ANI8402-M87 | 1 | |
| 4 | Bag | ANI8800-M87 | 1 | |
| 5 | Operating instructions | ANI8200EM87 | 1 | Ru |
| | | ANI8200IN24 | 1 | SA/KW/UAE/Ir/Om/Qa |
| | | ANI8200AN24 | 1 | SG(im)/S.Af/Ma/TW/HK |
| | | ANI8200NN24 | 1 | Th |
| 6 | Cup | ANI8900-M87 | 1 | NI-U755XR/U555SR/U455SS |

FEATURE TABLE

| Model No. Features | NI-U755XR | NI-U555SR | NI-U455SS | NI-U355TS |
|----------------------------|-----------|-----------|-----------|-----------|
| Spray Mist | Yes | Yes | Yes | Yes |
| Adjust Steam | Yes | Yes | Yes | Yes |
| Jet-of-Steam/Self Cleaning | Yes | Yes | Yes | Yes |
| Vertical Steam | Yes | Yes | Yes | Yes |
| Anti-Calcium System | Yes | Yes | Yes | |
| Auto-Valve System | Yes | Yes | Yes | |
| Cord-Reel | Yes | Yes | | |
| Auto-shut-Off | Yes | | | |