

# PACKING INSTRUCTIONS

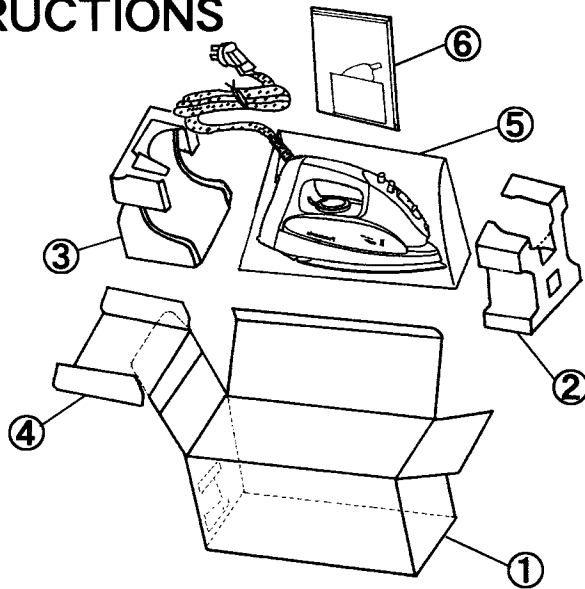

# PACKING PARTS LIST

REF. NO.	DESCRIPTION	PARTS NO.	Q'ty	REMARKS
1	Box	ANI 8193-199A	1	Oman/Qatar
		ANI 8193-M90A	1	UAE
		ANI 8193-464A	1	Kuwait
		ANI 8193-K87B	1	Saudi Arabia
		ANI 8193-452A	1	UAE(Ex.)
2	Packing filler A	ANI 8401-M90	1	
3	Packing filler B	ANI 8402-M90	1	
4	Packing filler C	ANI 8403-M90	1	
5	Front cover	ANI 8800-025	1	
6	Operating instructions	ANI 8218-M93	1	Saudi Arabia
		ANI 8200-M93	1	Oman/Qatar/UAE/Kuwait/UAE(Ex.)

# IN CASE TO STORE

★Change the steam select lever to left (Dry) side, and remove water from the cassette tank completely.

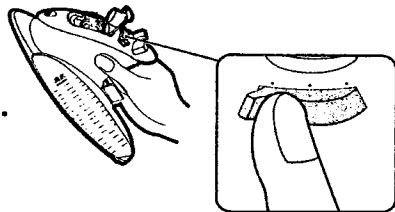

★Then, please set up the electronic iron and store it at safety place.

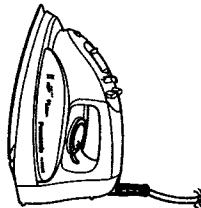

# Service Manual

Electronic Iron

NI-J1810A

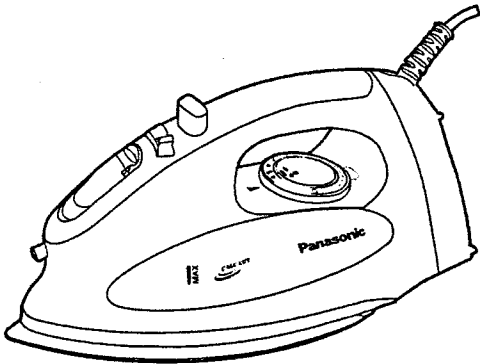

## ⚠ WARNING

This service information is designed for experienced repair technicians only and is not designed for use by the general public. It does not contain warnings or cautions to advise non-technical individuals of potential dangers in attempting to service a product. Products powered by electricity should be serviced or repaired only by experienced professional technicians. Any attempt to service or repair the product or products dealt with in this service information by anyone else could result in serious injury or death.

## IMPORTANT SAFETY NOTICE

There are special components used in this equipment which are important for safety. These parts are marked by ⚠ in the Schematic Diagrams, Circuit Board Diagrams, Exploded Views and Replacement Parts List. It is essential that these critical parts should be replaced with manufacturer's specified parts to prevent shock, fire or other hazards. Do not modify the original design without permission of manufacturer.

## CONTENTS

	Page		Page
1 SPECIFICATIONS .....	1	3 REPLACEMENT PARTS LIST .....	3
2 LOCATION .....	2	4 PACKING INSTRUCTIONS AND IN CASE TO STORE .....	4

**Panasonic®**

# EXPLODED VIEW

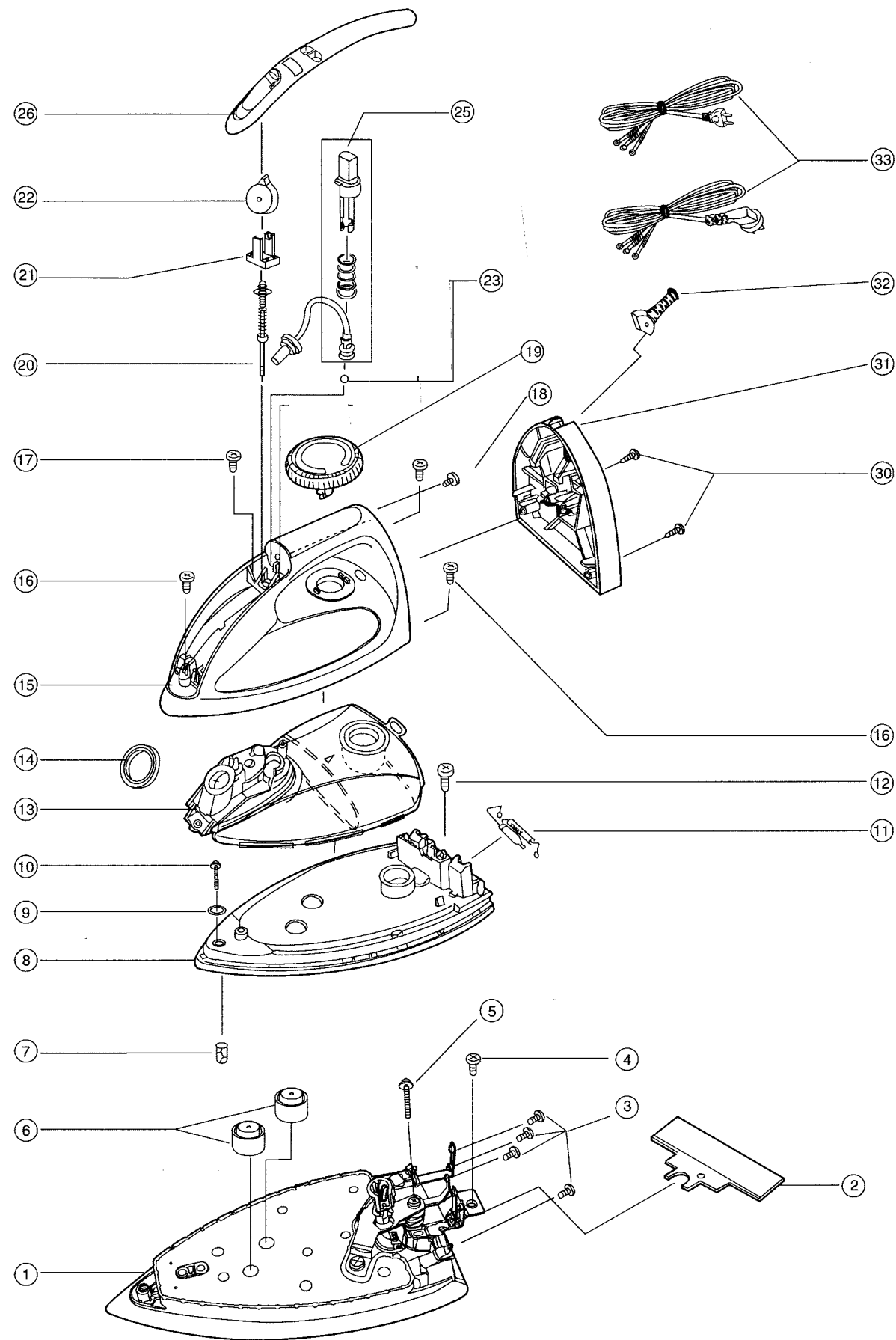

# REPLACEMENT PARTS LIST

REF. NO.	DESCRIPTION	PARTS NO.	Q'ty	REMARKS
1	Soleplate ass'y	ANI 1269KS93A	1	Oman/Qatar
		ANI 1289KS93A	1	Kuwait
		ANI 1266KS93A	1	Saudi Arabia
		ANI 1269PS93A	1	UAE/UAE(Ex.)
2	Rating plate	ANI 6078-M93B	1	Oman/Qatar/UAE/UAE(Ex.)
		ANI 6089-M93B	1	Kuwait
		ANI 6066-M93B	1	Saudi Arabia
3	Terminal screw	ANI 9009-A43B	2	Lamp
		ANI 9009-665	2 or 3	Power cord
4	Rating plate screw	XTN 4+8JV	1	
5	Terminal ass'y screw	ANI 9021-015	1	
6	Packing B	ANI 1471-M60	1	
7	Spacer A	ANI 2350-194	1	
8	Heat insulating plate	ANI 2340-M78K	1	
9	Gasket	ANI 2516-M60	1	
10	Heat insulating plate screw A	XTV 4+20JFN	3	
11	Indicator light ass'y	ANI 5600-M76	1	220~240V
12	Heat insulating plate screw B	ANI 9021-029	1	
13	Water tank	ANI 1510WS93A	1	Saudi Arabia
		ANI 1510KS93A	1	Oman/Qatar/UAE/Kuwait/UAE(Ex.)
14	Water inlet rubber	ANI 1633-436	1	
15	Handle ass'y	ANI 2000PX93A	1	
16	Handle screw A	XTW 4+16EFN	3	
17	Handle screw B	ANI 9022-024	1	
18	Handle cover screw	ANI 9022-024	1	
19	Temperature selector	ANI 2186-M93B	1	
20	Valve steam ass'y	ANI 1850-M60	1	
21	Steam/Dry select holder	ANI 2111-M60	1	
22	Steam/Dry selector	ANI 2110-M12C	1	
23	Balls	ANI 1701-344	1	
25	Spray nozzle ass'y	ANI 1606-M78C	1	
26	Handle cover	ANI 2060-M78A	1	
30	Rear handle screw	XTN 3+25BFN	2	
31	Rear handle cover	ANI 2039KX93A	1	
32	Cord bushing	ANI 4646-848X	1	
33	Cord ass'y	ANI 4452-M93B	1	Saudi Arabia
		ANI 4440-M93B	1	Kuwait/UAE
		ANI 4511-M76B	1	UAE(Ex.)
		ANI 4421-M77B	1	Oman/Qatar