

Service Manual

AC/Rechargeable Hair Clipper for Professional

ER154-E8

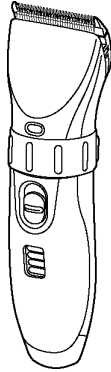

SPECIFICATIONS

Power source	AC/Rechargeable
	AC 230V, 50Hz
Charging time	1 hour
Weight	200g
Supplied accessories	Comb attachment (3mm/4mm, 6mm/9mm, 12mm/15mm)
	Charging stand
	Charging stand tray
	Oil
	Cleaning brush

WARNING

This service information is designed for experienced repair technicians only and is not designed for use by the general public. It does not contain warnings or cautions to advise non-technical individuals of potential dangers in attempting to service a product. Products powered by electricity should be serviced or repaired only by experienced professional technicians. Any attempt to service or repair the product or products dealt with in this service information by anyone else could result in serious injury or death.

CONTENTS

	Page		Page
1 SCHEMATIC DIAGRAM	2	5 TROUBLESHOOTING GUIDE	7
2 WIRING CONNECTION DIAGRAM	2	6 EXPLODED VIEW	8
3 DISASSEMBLY INSTRUCTIONS	3	7 REPLACEMENT PARTS LIST	8
4 ASSEMBLY INSTRUCTIONS	5		

Panasonic

© 2005 Matsushita Electric Works, Ltd. All rights reserved. Unauthorized copying and distribution is a violation of law.

1 SCHEMATIC DIAGRAM

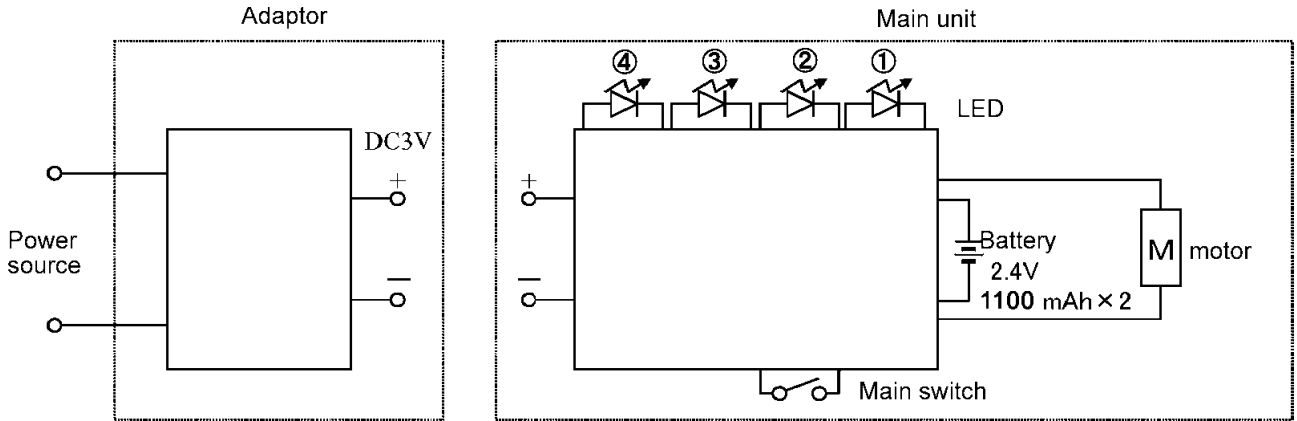

LED	Battery capacity monitor Charge status lamp	Indication		Status
① Green	high	Green	blinking	100 - 71%
② Green	mid			70 - 41%
③ Green	low			less than 40% The unit can be used once or twice more after "low" starts to blink. (Differs depending on the use situation.)
④ Red	charge	Red	lit	charging
		Red	blinking	Charging is completed.

2 WIRING CONNECTION DIAGRAM

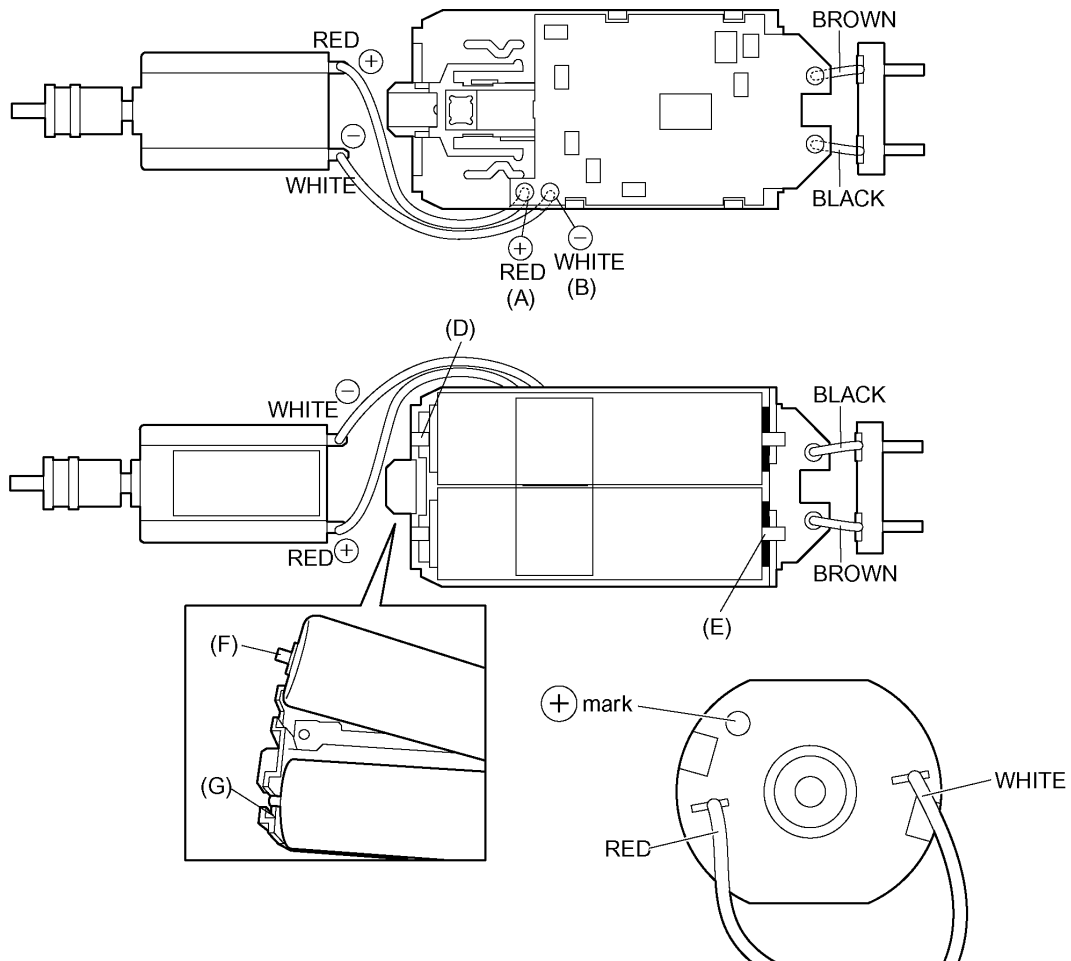

3 DISASSEMBLY INSTRUCTIONS

Follow the procedure below to disassemble the main body.

1. Remove the attachment.

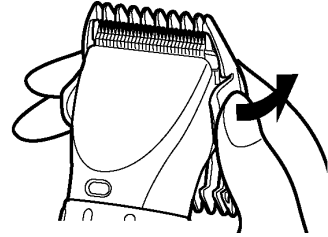

2. First, hold the handle of the hair clipper firmly with the "Panasonic" name facing upward and set the dial to "2.0mm", and push the upper part of the blade away from the housing.

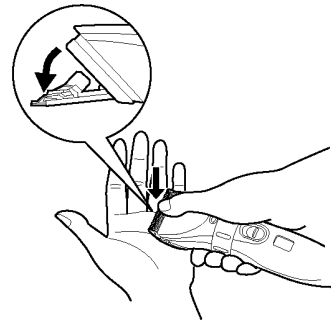

3. Loosen two screws tightening the spring for cutter and take out the spring.

4. Remove the front panel.

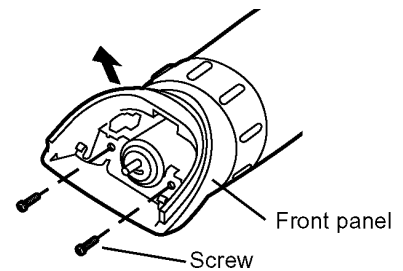

5. With the dial at "2.0mm", slide up the adjusting dial to the blade side slightly pushing the adjusting arm with the slotted-head screwdriver.

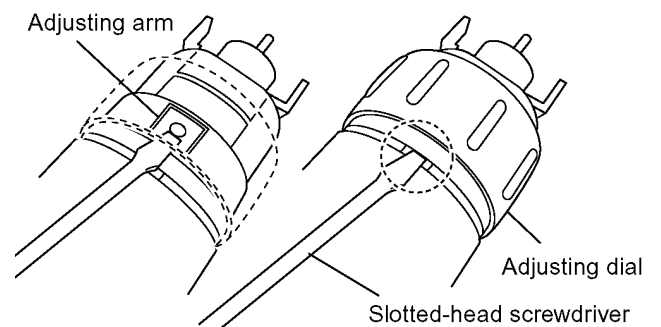

6. Loose a screw and take out the bottom cover.

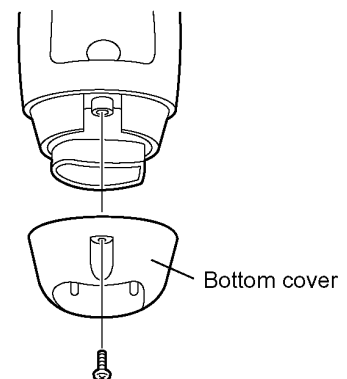

7. Loosen a screw and take out the name plate slightly inserting the slotted-head screwdriver to unhook the side.

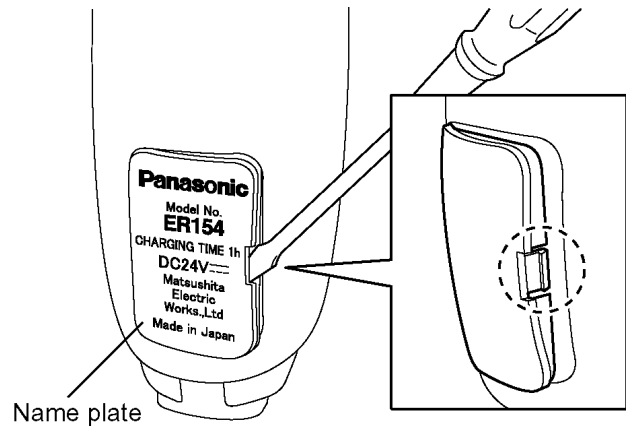

8. Separate housing A and B.

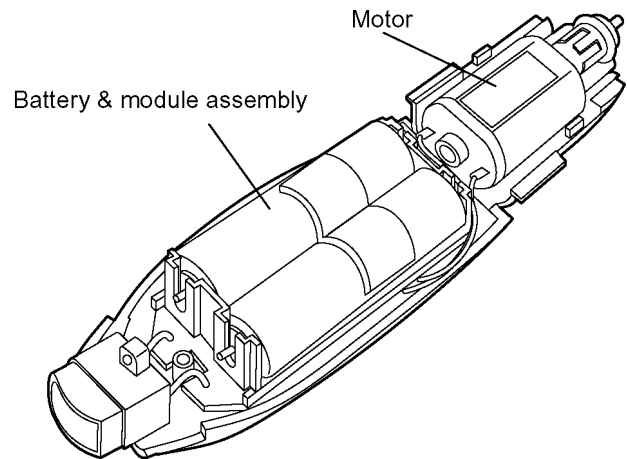

4 ASSEMBLY INSTRUCTIONS

NOTE: Always set the dial to "2.0mm" when removing or attaching the blade; otherwise the blade can not be attached.
Always set the dial to "0.8mm" when removing or attaching the comb attachment.

1. Set the click button and the dial spring to the housing A.

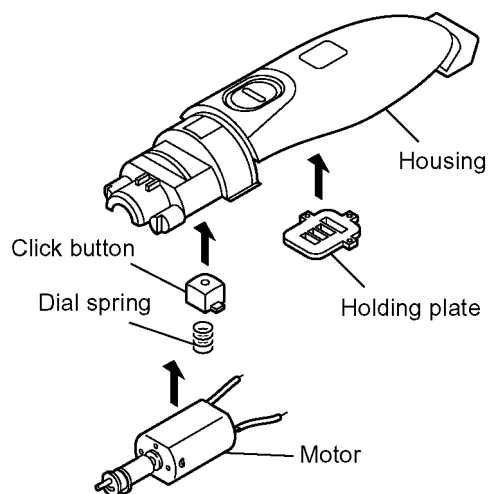

2. Place the holding plate on the housing A firmly.

NOTE: Confirm if housing bosses completely cover the hole of holding plate.

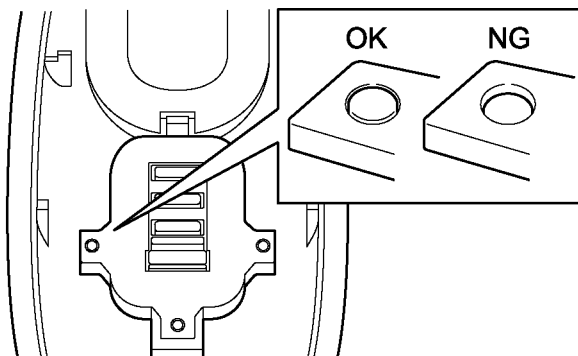

3. Insert the terminal pins into the hole of housing A firmly and set the battery & module assembly into the housing A.

NOTE: Confirm to set the switch handle OFF position. And make sure that the projection of switch handle fixing frame connects to the slit of switch plate.

NOTE: Confirm the smooth movement and operation of switch handle.

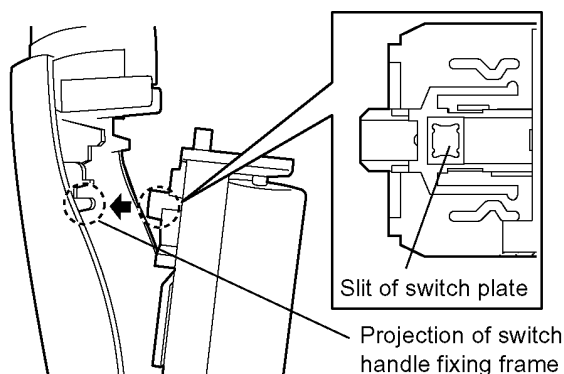
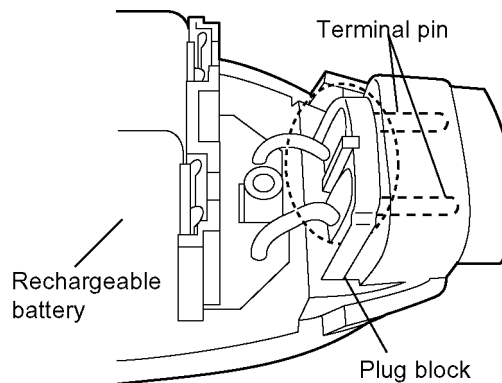

4. Insert the motor facing the sticker on the housing B side.

NOTE: The motor has a own direction. Make sure to set the proper direction when reassembling.

NOTE: Be certain that the lead wires are mounted in the proper position without setting over the housing ribs.

NOTE: Confirm the smooth movement of click button and the motor rotates when switching ON.

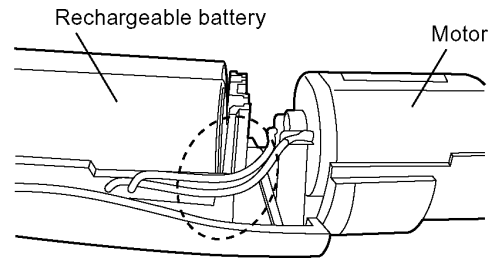

5. Close the housing B on the housing A.

NOTE: Make sure of the position of lead wires to prevent pinching.

NOTE: Confirm that the motor rotates when switching ON.

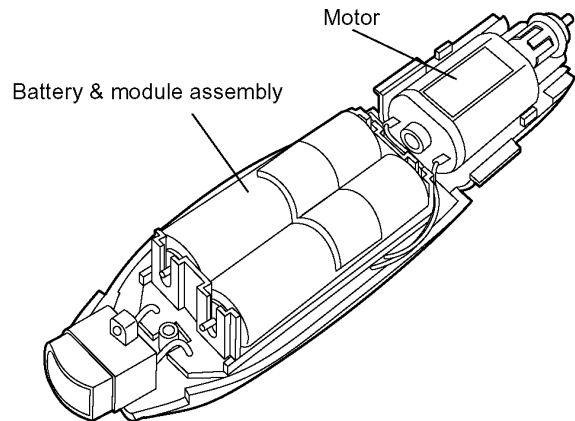

6. Applying GREASE (FLOIL G741) on the dial. Put two dials together and align the slit of adjusting dial with the projection of adjusting arm to assemble the dial.

NOTE: Confirm the smooth movement of adjusting dial.

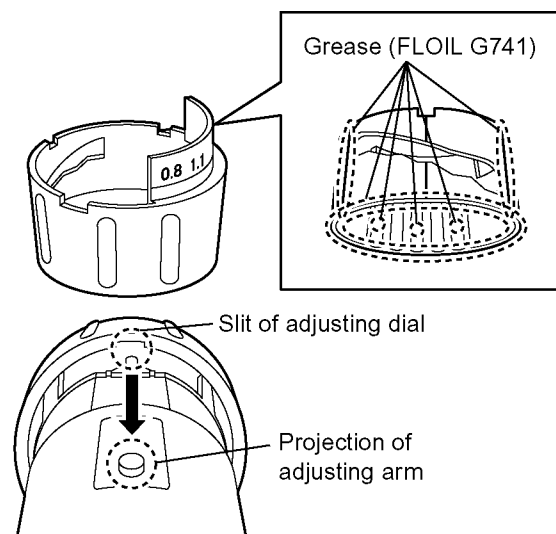

7. Attach the dust-proof rubber.

8. Set the front panel.

9. Attach the spring for cutter tighten with two screws.

10. Attach the bottom cover with a screw.

11. Tighten a screw and set the name plate.

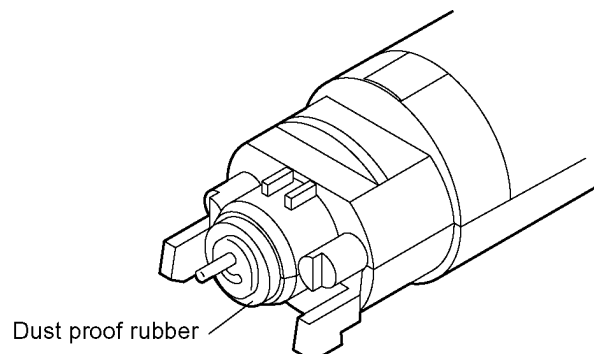

5 TROUBLESHOOTING GUIDE

(Refer to WIRING CONNECTION DIAGRAM)

<TROUBLE>	<CHECK.>	<REMEDY>
Does not operate. Motor does not operate.	<p align="center"><CHECK POWER CORD UNIT.></p> Supply rated voltage to the power cord unit. OK if it is more than DC 3.0V between the terminals of the plug.	NO → Replace the power cord unit.
	↓ OK	
	<p align="center"><CHECK SWITCH.></p> Okay if there is a continuity and no deformation of switch terminal.	NO → Adjust the switch contact plate.
	↓ OK	
	<p align="center"><CHECK MOTOR.></p> The motor should turn when 2.4V DC is applied to terminals.	NO → Replace the motor.
	↓ OK	
	<p align="center"><CHECK MODULE.></p> When switching ON, check the continuity between (A) and (B). Okay if it is more than DC2.4V.	NO → Replace the module.
	↓ OK	
	<p align="center"><CHECK RECHARGEABLE BATTERIES.></p> Okay if the voltage of rechargeable battery is more than approximately 2.4V DC between (D) and (E) terminals. (Replace two rechargeable batteries at the same time, even though one battery is defective due to series connection.)	NO → Replace the rechargeable batteries.
Does not charge. The charge status lamp does not light up.	<p align="center"><CHECK RECHARGEABLE BATTERIES.></p> Okay if the voltage of rechargeable battery is more than approximately 2.4V DC between (D) and (E) terminals. (Replace two rechargeable batteries at the same time, even though one battery is defective due to series connection.)	NO → Replace the rechargeable batteries.
	↓ OK	
	<p align="center"><CHECK CHARGING CURRENT.></p> Unsolder (+) terminal of battery, and connect the power cord unit to AC power supply with switch OFF. Measure the charging current between (F) and (G), and Okay if it is approximately 1200±350mA.	OK → Replace the module.

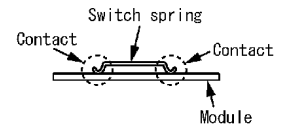

6 EXPLODED VIEW

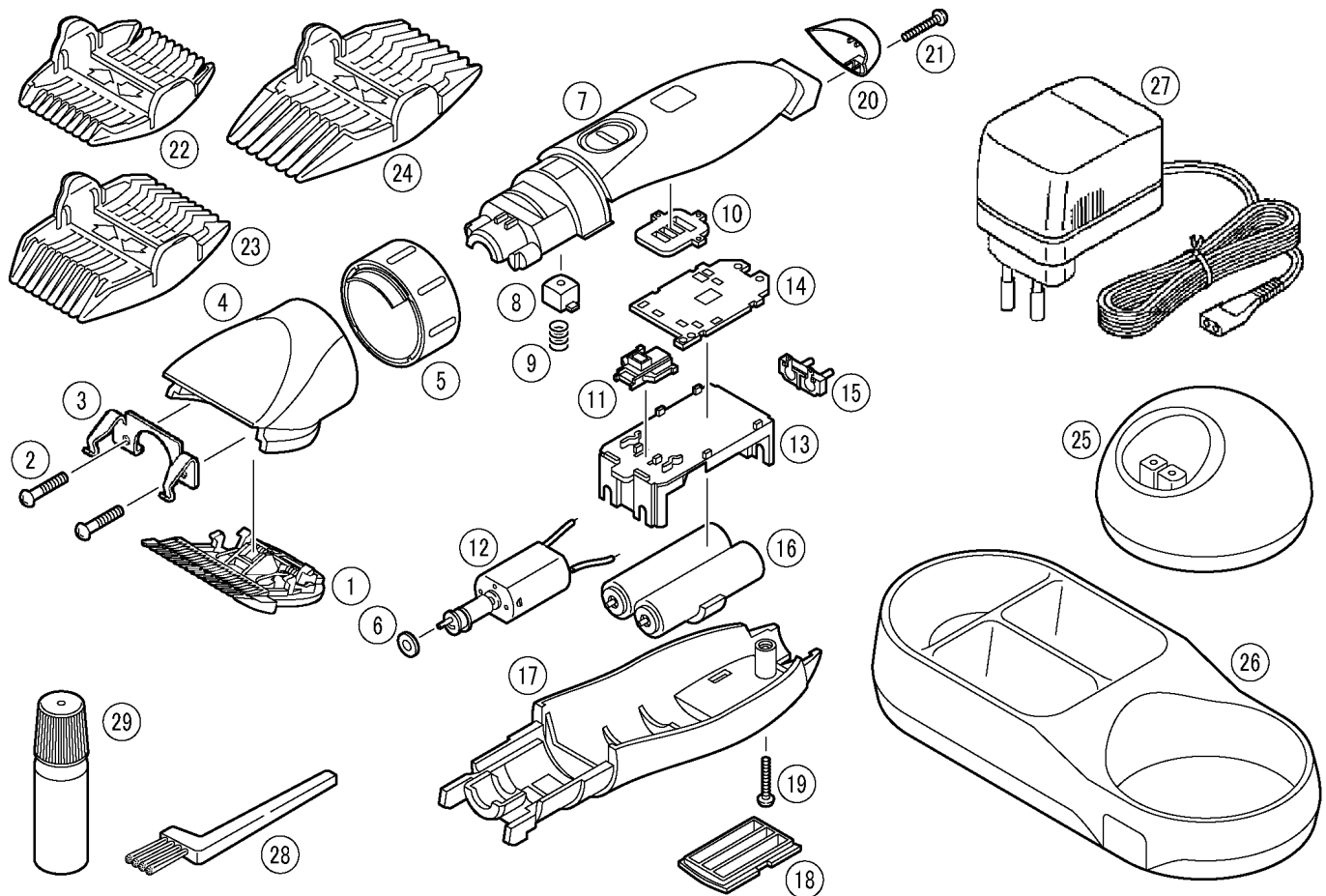

7 REPLACEMENT PARTS LIST

Ref. No.	Part No.	Part Name & Description	Remarks		Per Unit
1	WER9792Y	BLADE BLOCK			1
2	WER151L9207	TAPPING SCREW	*C	K2.6-8	2
3	WER154L0168	SPRING FOR CUTTER			1
4	WER154S3968	FRONT PANEL			1
5	WER154S3288	ADJUSTING DIAL			1
6	WER150L0137	DUST-PROOF RUBBER			1
7	WER154K3058	HOUSING A			1
8	WER154L0458	DIAL CLICK BUTTON			1
9	WER154L0158	DIAL CLICK SPRING			1
10	WER154L3178	HOLDING PLATE			1
11	WER154L3578	SWITCH CONTACT PLATE			1
12	WER154L1008	MOTOR			1
13	WER154L0778	CHASSIS BLOCK			1
14	WER154L2108	MODULE			1
15	WER154K2158	PLUG BLOCK			1
16	WER154L2508	RECHARGEABLE BATTERY	*B	Ni-Mh Type (2PCS/PK)	2
17	WER154K3068	HOUSING B			1
18	WER154K8408	NAME PLATE			1
19	WER160L9207	P-TIGHT SCREW		M2.0-8	1
20	WER154K3178	BOTTOM COVER			1
21	WER160L9107	SCREW		M2-6	1
22	WER154K7398	COMB ATTACHMENT A		3-4MM	1
23	WER154K7408	COMB ATTACHMENT B		6-9MM	1
24	WER154K7418	COMB ATTACHMENT C		12-15MM	1
25	WER154K7188	CHARGING STAND			1
26	WER154K7198	CHARGING STAND TRAY			1
27	WER154K7659	CHARGING ADAPTOR		C-2 PLUG	1
28	WES76806761	CLEANING BRUSH			1
29	WER203X7918	OIL			1
-	WER154K8008	INDIVIDUAL BOX			1
-	WER154K8108	OPERATING INSTRUCTIONS			1