

Service Manual

Compact Multi Straightener

Model No. **EH-HW13**

Asia
Middle East



EH-HW13

⚠ WARNING

This service information is designed for experienced repair technicians only and is not designed for use by the general public. It does not contain warnings or cautions to advise non-technical individuals of potential dangers in attempting to service a product. Products powered by electricity should be serviced or repaired only by experienced professional technicians. Any attempt to service or repair the product or products dealt with in this service information by anyone else could result in serious injury or death.

IMPORTANT SAFETY NOTICE

There are special components used in this equipment which are important for safety. These parts are marked by **⚠** in the Schematic Diagrams, Circuit Board Diagrams, Exploded Views and Replacement Parts List. It is essential that these critical parts should be replaced with manufacturer's specified parts to prevent shock, fire or other hazards. Do not modify the original design without permission of manufacturer.

TABLE OF CONTENTS

	PAGE	PAGE
1 Warning	2	
2 Specifications	2	
3 Troubleshooting Guide	3	
4 Disassembly and Assembly Instructions	4	
5 Wiring Connection Diagram	7	
6 Schematic Diagram	8	
7 Exploded View and Replacement Parts List	9	

Panasonic

© Panasonic Electric Works (Thailand) Co., Ltd.
2011. All rights reserved. Unauthorized copying and
distribution is a violation of law.

1 Warning

Caution:

- Pb free solder has a higher melting point than standard solder; Typically the melting point is 50 - 70°F (30 - 40°C) higher. Please use a soldering iron with temperature control and adjust it to 750 ± 20°F (400 ± 10°C). In case of using high temperature soldering iron, please be careful not to heat too long.
- Pb free solder will tend to splash when heated too high (about 1100°F / 600°C).

2 Specifications

Sales Area		Asia	
Power source		AC100-240V, 50-60Hz	
Power consumption		20 W	
Iron Plate temperature		170 °C	
Body size (mm.)		Without Cap	230×28×32
		With Cap	235 x 35 x 39
Weight	S3 Plug	Without Cap	322 g
		With Cap	347 g
	B2(SF82) Plug	Without Cap	271 g
		With Cap	296 g
	B2(SF822) Plug	Without Cap	260 g
		With Cap	285 g
Cord length		S3 Plug	1.70 m
		B2(SF82) Plug	1.70 m
		B2(SF822) Plug	1.70 m

3 Troubleshooting Guide

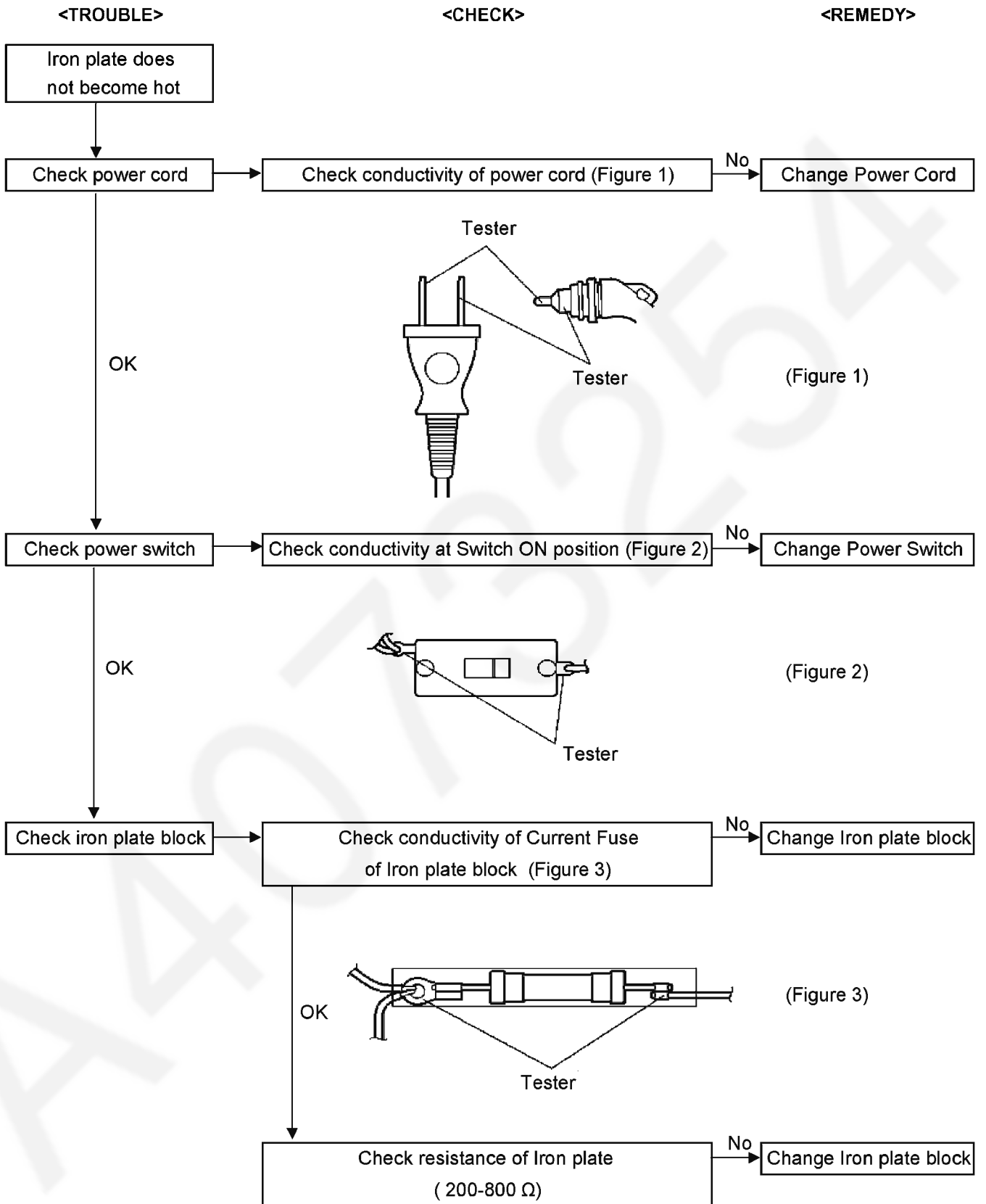

4 Disassembly and Assembly Instructions

4.1. Disassembly Instructions

1. Insert a small flat head screwdriver into the groove of the Shaft Cover as shown in Figure 4.

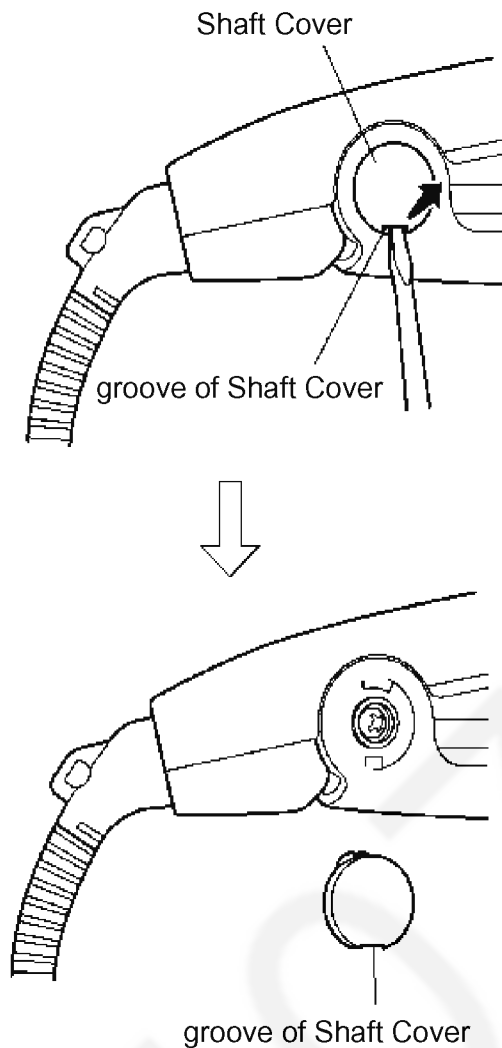

(Figure 4)

2. Remove the Shaft screw and take off the Shaft from Main body as shown in Figure 5.

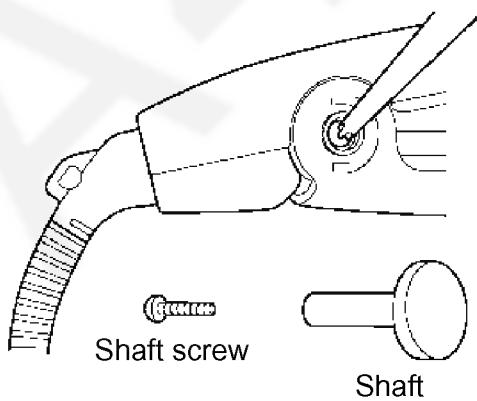

(Figure 5)

3. Remove the spring by pull out the Housing side and Press plate side as shown in Figure 6.

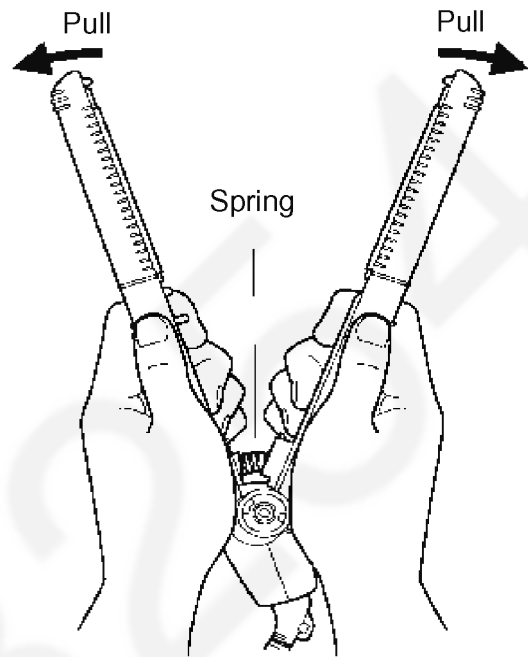

(Figure 6)

4. Using a screwdriver remove the two tapping screws from Press plate cover as shown in Figure 7.

***Be careful not to lose the spring ***

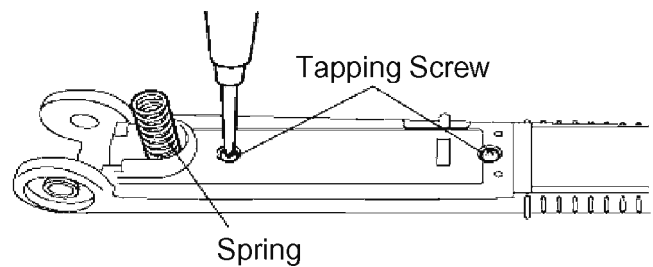

(Figure 7)

5. Take off the Press plate cover as shown in Figure 8.

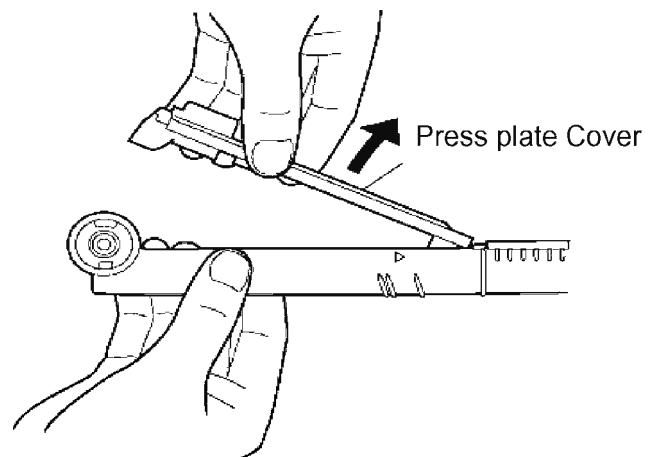

(Figure 8)

6. Remove the Iron Plate ass'y B/K of Press plate side as shown in Figure 9.

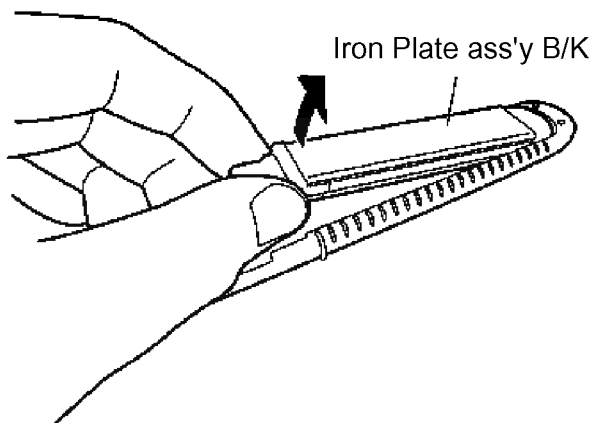

(Figure 9)

7. Using screwdriver remove the 2 tapping screws and 1 torx screw as shown in Figure 10.

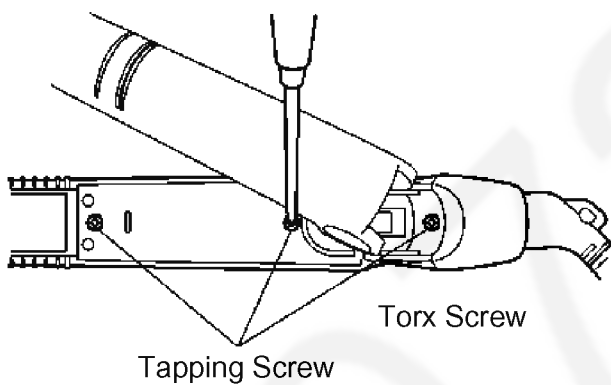

(Figure 10)

8. Take off the Housing B as shown in Figure 11.

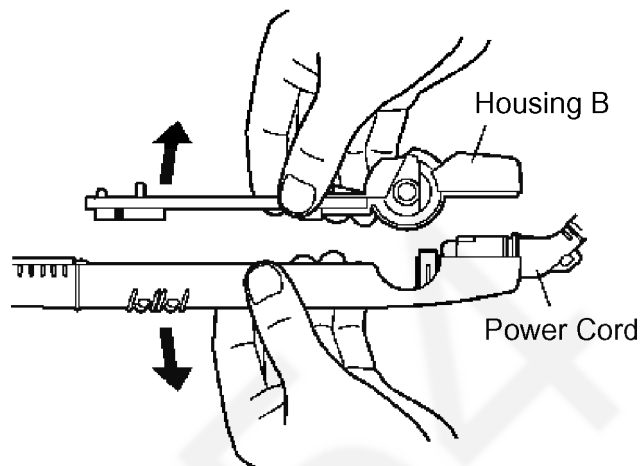

(Figure 11)

9. Remove the Iron Plate ass'y B/K of Housing side as shown in Figure 12.

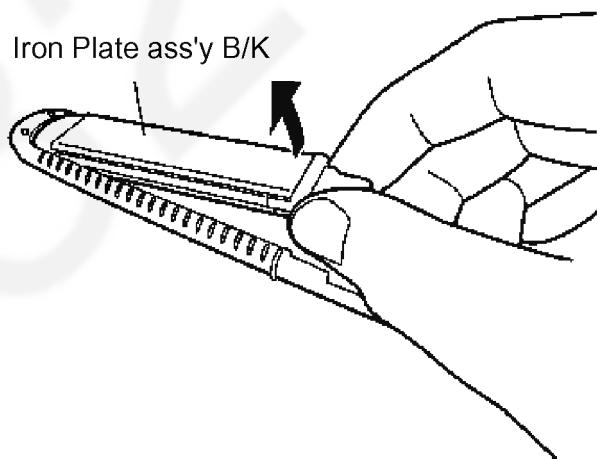

(Figure 12)

4.2. Assembly Instructions

1. Arrange Lead wire into rib of Press plate as shown in Figure 13.

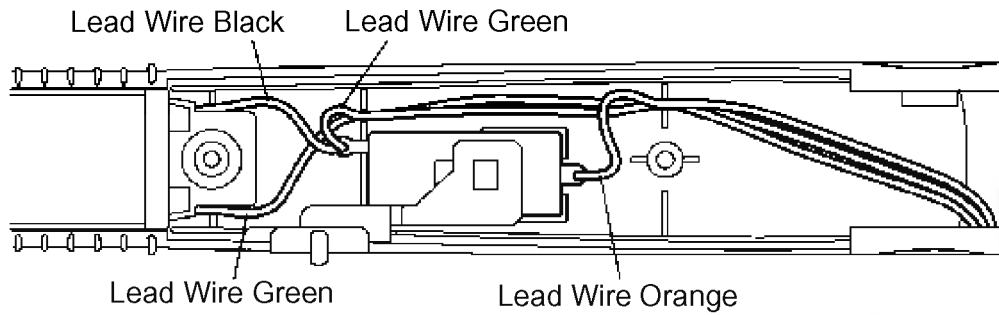

(Figure 13)

- Arrange Lead wire into rib of Housing A as shown in Figure 14.

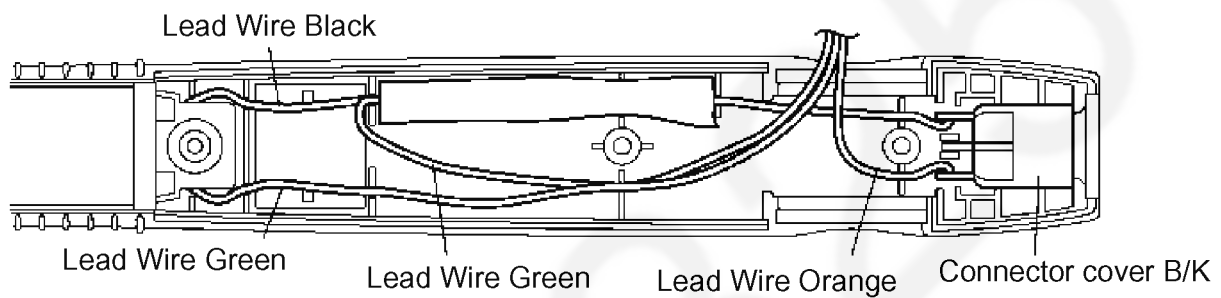

(Figure 14)

2. Put Housing B and Housing A together as shown in Figure 15.

- Ensure that the power cord is attached to the connector cover.
(Apply grease foil at the power cord terminal)

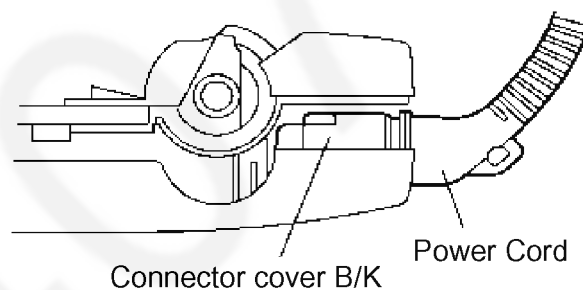

(Figure 15)

3. Fixing Shaft cover follow hook direction as shown in Figure 16.

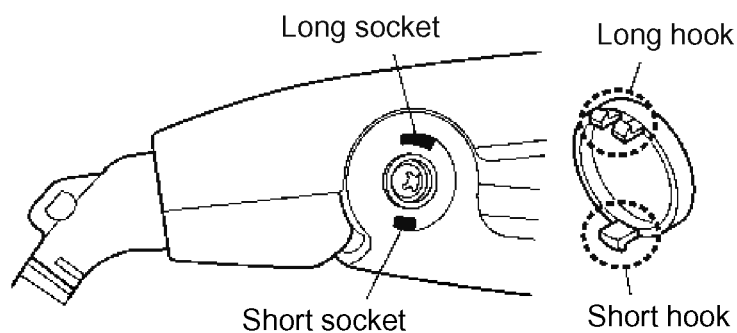

(Figure 16)

5 Wiring Connection Diagram

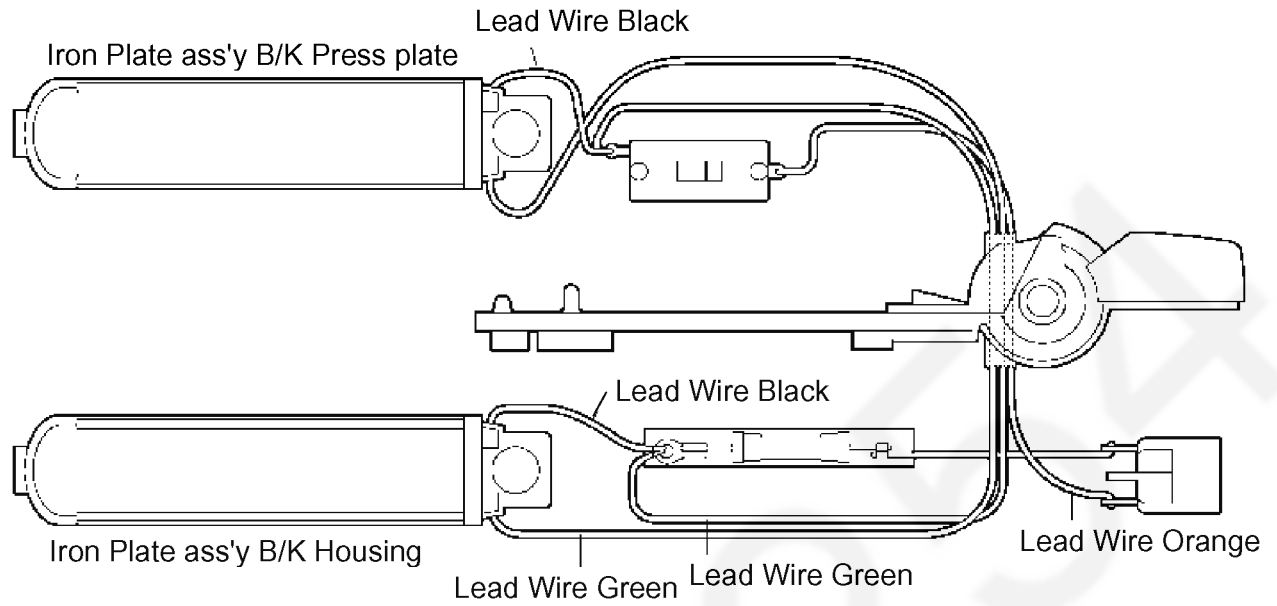

(Figure 17)

6 Schematic Diagram

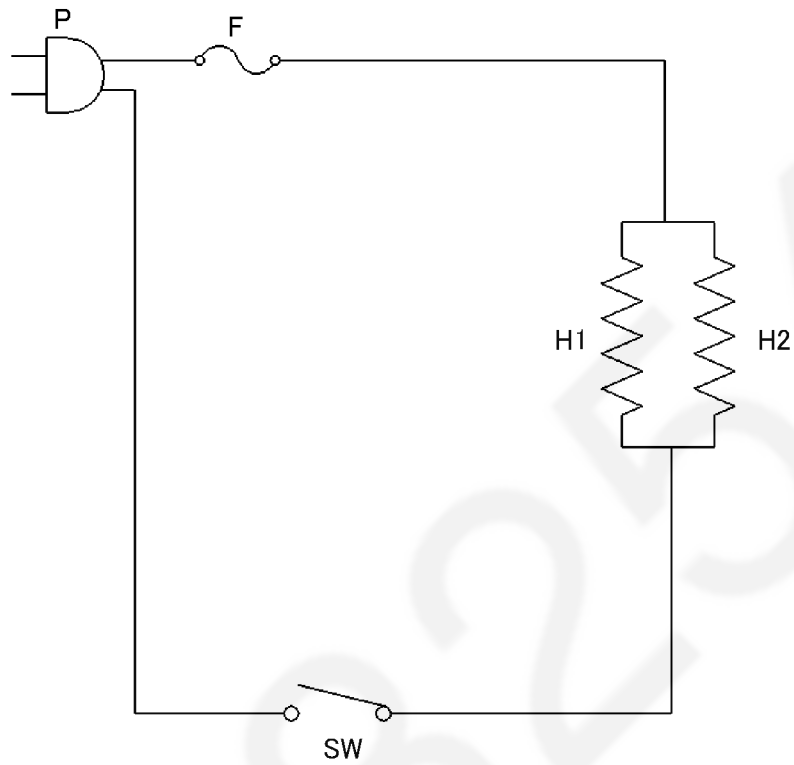

(Figure 18)

F	Current Fuse	250V, 5A	1
H1, H2	PTC Heating Element	200 ~ 800 ohm	1
SW	Main Switch	11A, 125VAC / 5.5A, 250VAC	1
P	Power Cord		

	a	b
C-1	OFF	ON

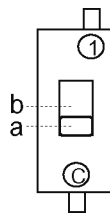

7 Exploded View and Replacement Parts List

Model No. : EH-HW13 Exploded View

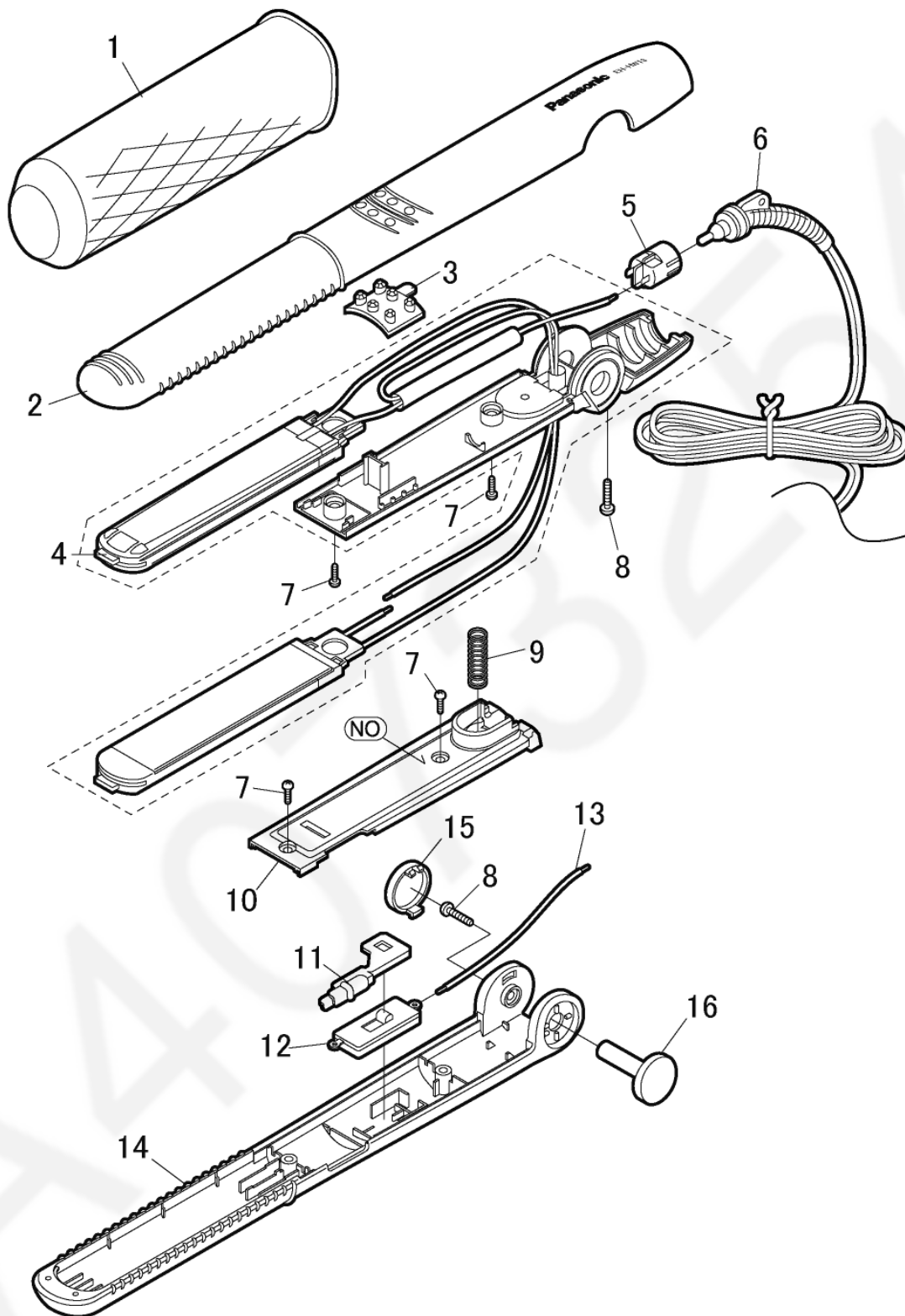

Model No. : EH-HW13 Parts List

Safety	Ref. No.	Part No.	Part Name & Description	Q'ty	Remarks
	1	EHHW13CBW	CAP (BLACK)	1	(FOR BLACK)
	1	EHHW13CWW	CAP (WHITE)	1	(FOR WHITE)
	2	EHHW13HSABW	HOUSING A (BLACK)	1	(FOR BLACK)
	2	EHHW13HSAWW	HOUSING A (WHITE)	1	(FOR WHITE)
	3	EHHW13STDVW	STONE (DARK VIOLET)	1	(FOR BLACK)
	3	EHHW13STVW	STONE (VIOLET)	1	(FOR WHITE)
	4	EHHW13IPABW	IRON PLATE ASSEMBLY (BLACK)	1	(FOR BLACK, OTHERS)
	4	EHHW13IPAB6W	IRON PLATE ASSEMBLY (BLACK)	1	(FOR BLACK, Middle East)
	4	EHHW13IPAWW	IRON PLATE ASSEMBLY (WHITE)	1	(FOR WHITE, OTHERS)
	4	EHHW13IPAW4W	IRON PLATE ASSEMBLY (WHITE)	1	(FOR WHITE, VIETNAM)
	5	EHHW13CTBW	CONNECTOR COVER B/K	1	
	6	EHHW13PCBB2W	POWER CORD (BLACK)	1	(FOR BLACK, B2-PLUG)
	6	EHHW13PCBS3W	POWER CORD (BLACK)	1	(FOR BLACK, S3-PLUG)
	6	EHHW13PCHB2W	POWER CORD (GRAY)	1	(FOR WHITE, B2-PLUG)
	6	EHHW13PCHS3W	POWER CORD (GRAY)	1	(FOR WHITE, S3-PLUG)
	7	EHHW132608BW	TAPPING SCREW 2.6*8 (BLACK)	4	(FOR BLACK)
	7	EHHW132608SW	TAPPING SCREW 2.6*8 (SILVER)	4	(FOR WHITE)
	8	EHHW133010BW	TORX SCREW 3*10 (BLACK)	2	(FOR BLACK)
	8	EHHW133010SW	TORX SCREW 3*10 (SILVER)	2	(FOR WHITE)
	9	EHHW13PSW	PIVOT SPRING	1	
	10	EHHW13PCBW	PRESS PLATE COVER (BLACK)	1	(FOR BLACK)
	10	EHHW13PCWW	PRESS PLATE COVER (WHITE)	1	(FOR WHITE)
	11	EHHW13SPBW	SWITCH PLATE (BLACK)	1	(FOR BLACK)
	11	EHHW13SPWW	SWITCH PLATE (WHITE)	1	(FOR WHITE)
	12	EHHW13MSW	MAIN SWITCH	1	
	13	EHHW13LAW	LEAD WIRE (ORANGE)	1	
	14	EHHW13PPBW	PRESS PLATE (BLACK)	1	(FOR BLACK)
	14	EHHW13PPWW	PRESS PLATE (WHITE)	1	(FOR WHITE)
	15	EHHW13SCBW	SHAFT COVER (BLACK)	1	(FOR BLACK)
	15	EHHW13SCWW	SHAFT COVER (WHITE)	1	(FOR WHITE)
	16	EHHW13SHBW	SHAFT (BLACK)	1	(FOR BLACK)
	16	EHHW13SHWW	SHAFT (WHITE)	1	(FOR WHITE)
	-	EHHW13S03UW	OPERATING INSTRUCTION	1	
	-	EHHW13615KW	INDIVIDUAL PACKAGE	1	(FOR BLACK, India)
	-	EHHW13665KW	INDIVIDUAL PACKAGE	1	(FOR BLACK, Middle East)
	-	EHHW13685KW	INDIVIDUAL PACKAGE	1	(FOR BLACK, Singapore)
	-	EHHW13615WW	INDIVIDUAL PACKAGE	1	(FOR WHITE, India)
	-	EHHW13645WW	INDIVIDUAL PACKAGE	1	(FOR WHITE, Vietnam)
	-	EHHW13655WW	INDIVIDUAL PACKAGE	1	(FOR WHITE, Malaysia)
	-	EHHW13685WW	INDIVIDUAL PACKAGE	1	(FOR WHITE, Singapore)
	-	EHHW13S09W	PULP FILLER	1	
	-	EHHW13S04W	EASY MANUAL	1	