

Service Manual

(Household) Straight & Curl Straightener

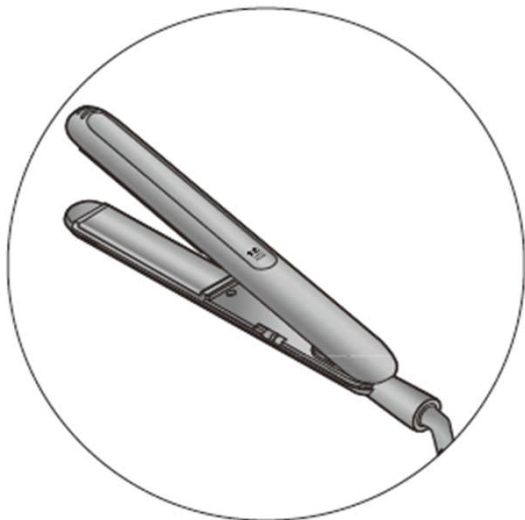

Model No. EH-HV20

Asia

CIS

Middle East

⚠ WARNING

This service information is designed for experienced repair technicians only and is not designed for use by the general public. It does not contain warnings or cautions to advise non-technical individuals of potential dangers in attempting to service a product. Products powered by electricity should be serviced or repaired only by experienced professional technicians. Any attempt to service or repair the product or products dealt with in this service information by anyone else could result in serious injury or death.

IMPORTANT SAFETY NOTICE

There are special components used in this equipment which are important for safety. These parts are marked by ⚠ in the Schematic Diagrams, Circuit Board Diagrams, Exploded Views and Replacement Parts List. It is essential that these critical parts should be replaced with manufacturer's specified parts to prevent shock, fire or other hazards. Do not modify the original design without permission of manufacturer.

TABLE OF CONTENTS

	Page
1 Warning	1
2 Specifications	1
3 Troubleshooting Guide	2
4 Disassembly and Assembly Instructions	4
5 Wiring Connection Diagram.....	9
6 Schematic Diagram	9
7 Exploded View & Replacement Parts List	10



© Panasonic Corporation 2015 Unauthorized copying and distribution is a violation of law.

1. Warning

Caution:

- Pb free solder has a higher melting point than standard solder. Typically the melting point is 50 - 70°F (30 - 40 °C) or higher. Please use soldering iron with temperature control and adjust it to 750 ±20°F (400 ± 10 °C).
In case of using high temperature soldering iron, please be careful not to heat too long.
- Pb free solder will tend to splash when heated too high (about 1100°F / 600 °C).

2. Specifications

Model		EH-HV20	
Sales Area		Asia / CIS / Middle East	
Power source / Power consumption		AC 100-130V ~ 50-60Hz 51W AC 220-240V ~ 50-60Hz 55W	
Iron Plate temperature		180-200-230°C (3 level settings)	
Body size (mm.)		290×33×33	
Weight	S3 Plug(SF629)	415 g	
	B2 Plug(SF82)	365 g	
	B2 Plug (SF822)	355 g	
	A2 Plug (LM-201-9)	355 g	
Cord length	S3(SF629) Plug	2.0 m	
	B2(SF82) Plug	2.0 m	
	B2(SF822) Plug	2.0 m	
	A2(LM-201-9) Plug	2.0 m	

3. TROUBLESHOOTING GUIDE

Refer to WIRING CONNECTION DIAGRAM.

< CHECKING PROCEDURE >

< CHECKING METHOD >

< REMEDY >

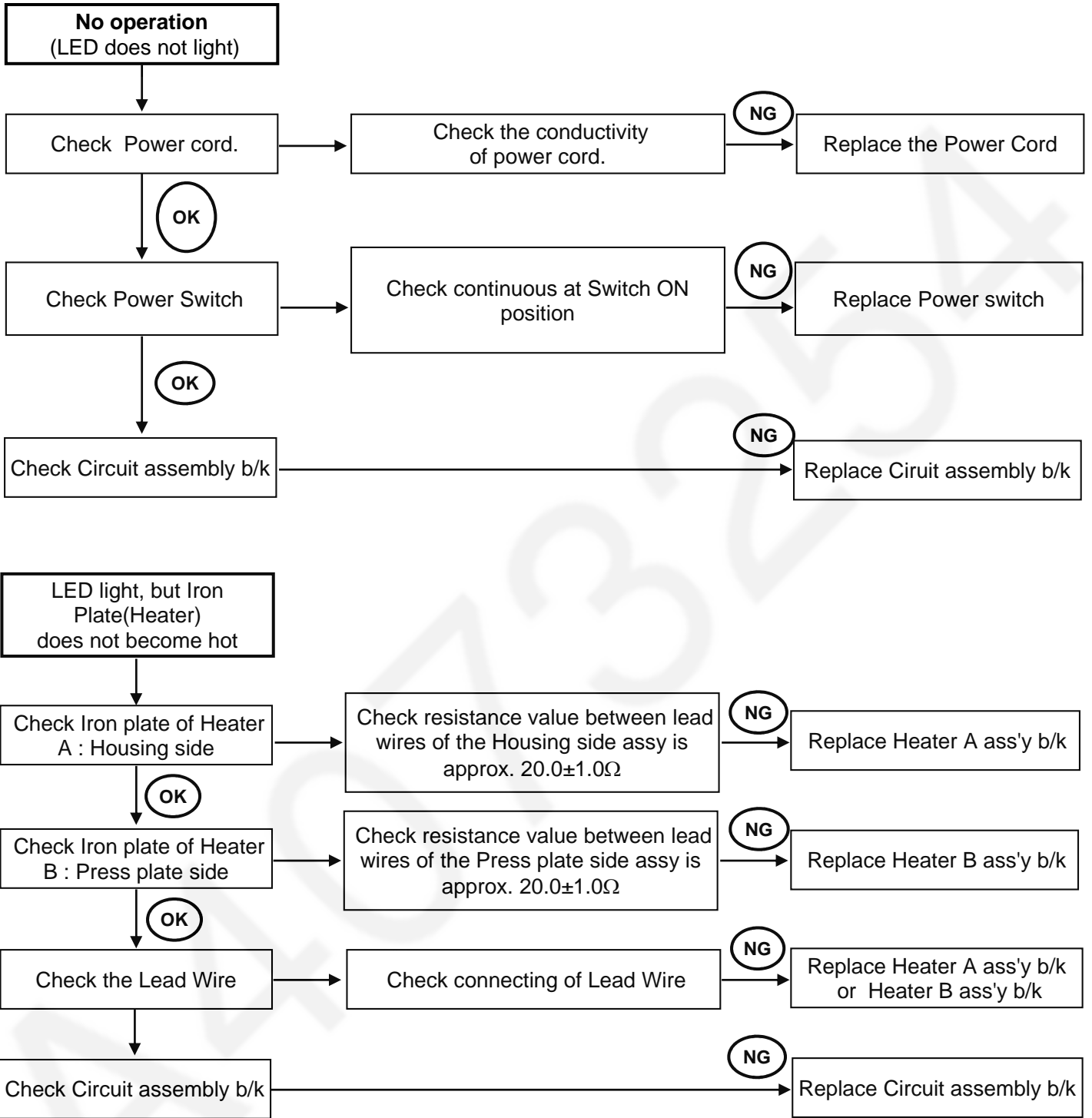

4 Disassembly and Assembly instructions

4.1 Disassembly instruction

(1) Remove Hinge Cover from Main Body by Slotted screw driver (Minus Driver.)

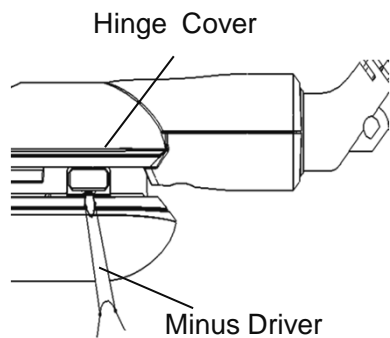

(4) Remove 3 screws for fitting Press Plate side by Phillips screw drivers (Plus Driver).

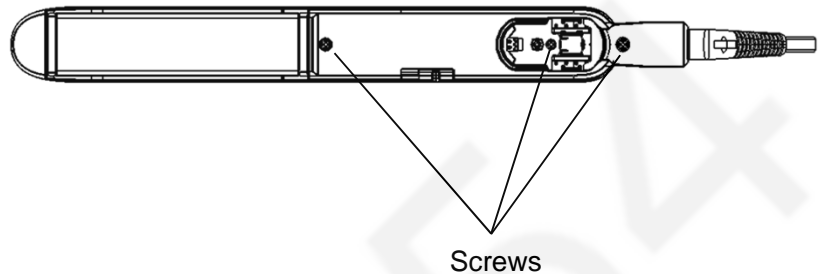

(2) Remove Hinge Pin by hand pressing at Housing side and Press Plate side.

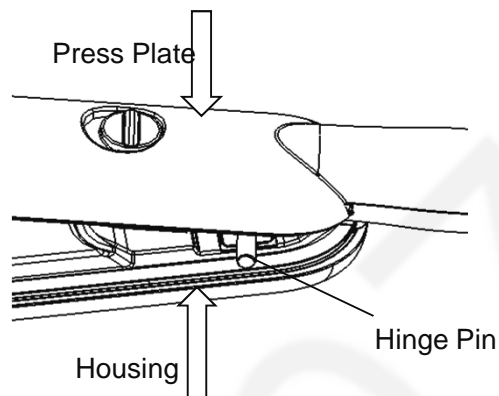

(5) Remove Press Plate Cover from Press Plate in Grip follow as below drawing.

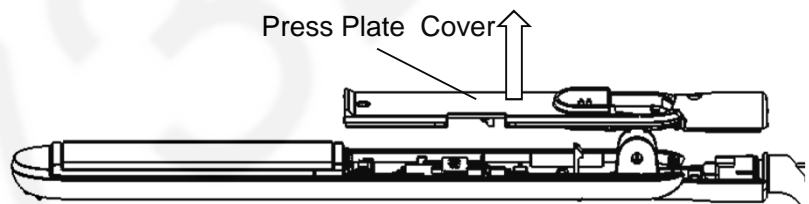

(3) Remove Pivot spring by gripping and pulling it out from the Main body

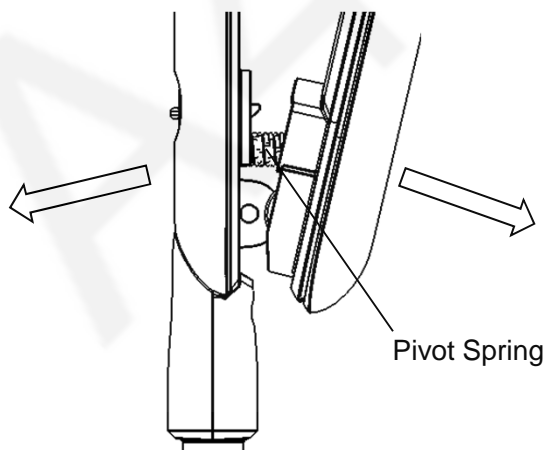

(6) Take off Iron Plate from Press Plate.

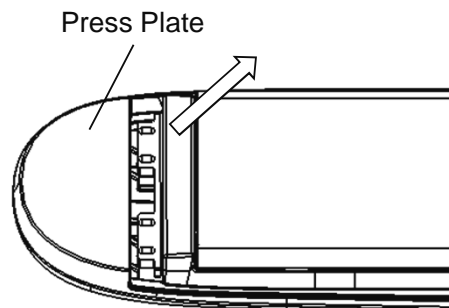

(8) Remove 2 screws for fitting Housing side by Phillips screw drivers (Plus Driver).

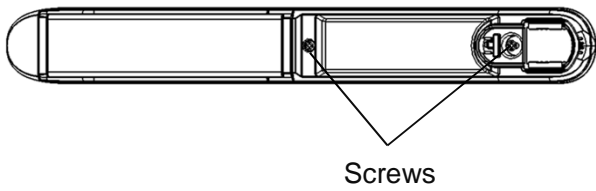

(9) Remove Housing B from Housing A in Grip follow as below drawing.

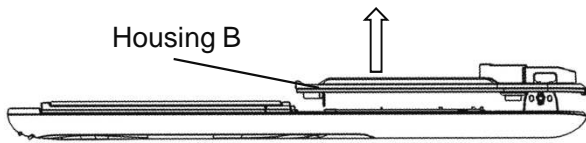

(10) Take off Iron Plate and Circuit assembly block from Housing A

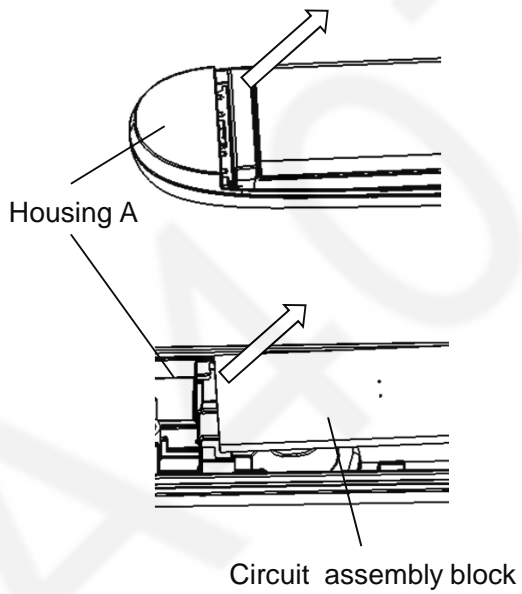

4.2 Assembly Instructions

1. Arrange Lead wire into rib of Press Plate as shown in Figure

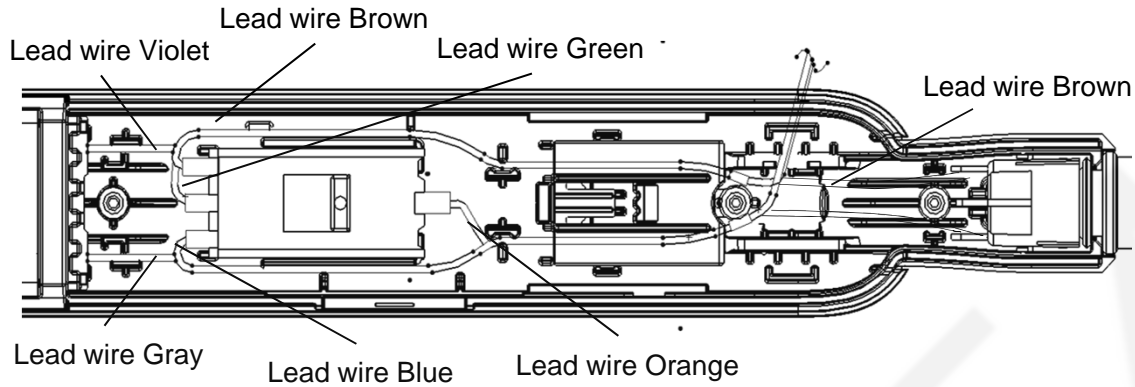

2. Arrange Lead wire into rib of Hosing A as shown in Figure

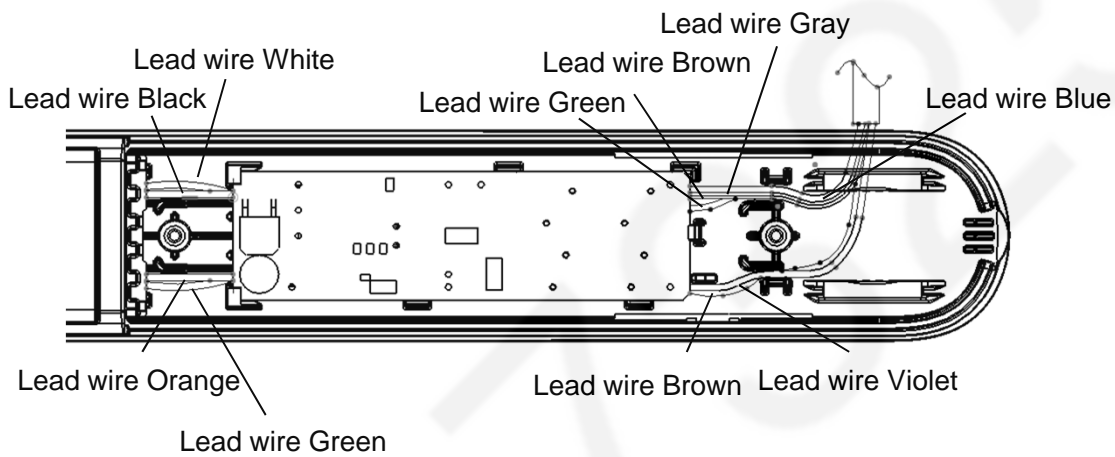

3. Assembly Press Plate Cover together with Press Plate as shown in Figure
 - Ensure that the power cord is attached to the connector cover.
(Apply grease floil at the power cord terminal)

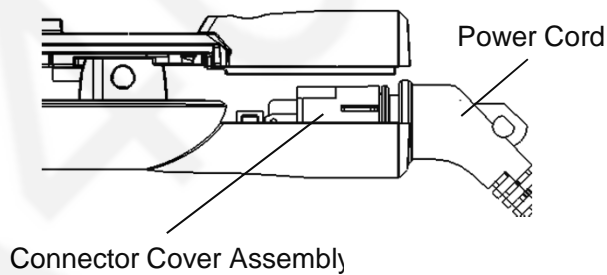

5. WIRING CONNECTION DIAGRAM

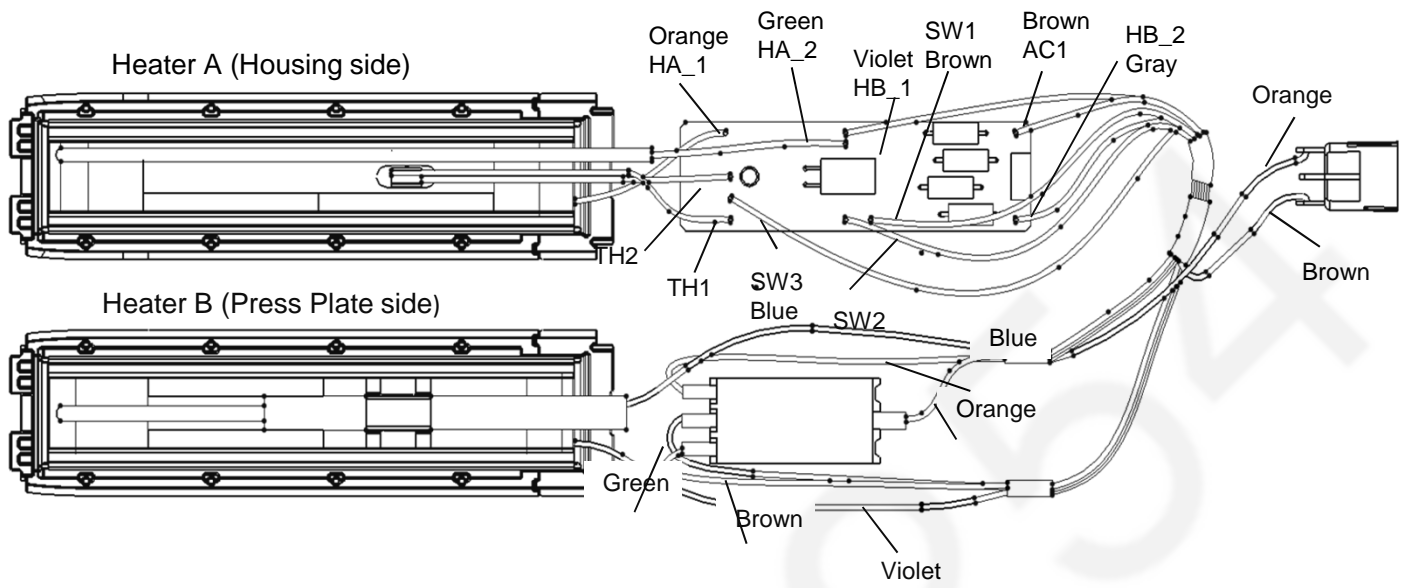

6. SCHEMATIC DIAGRAM

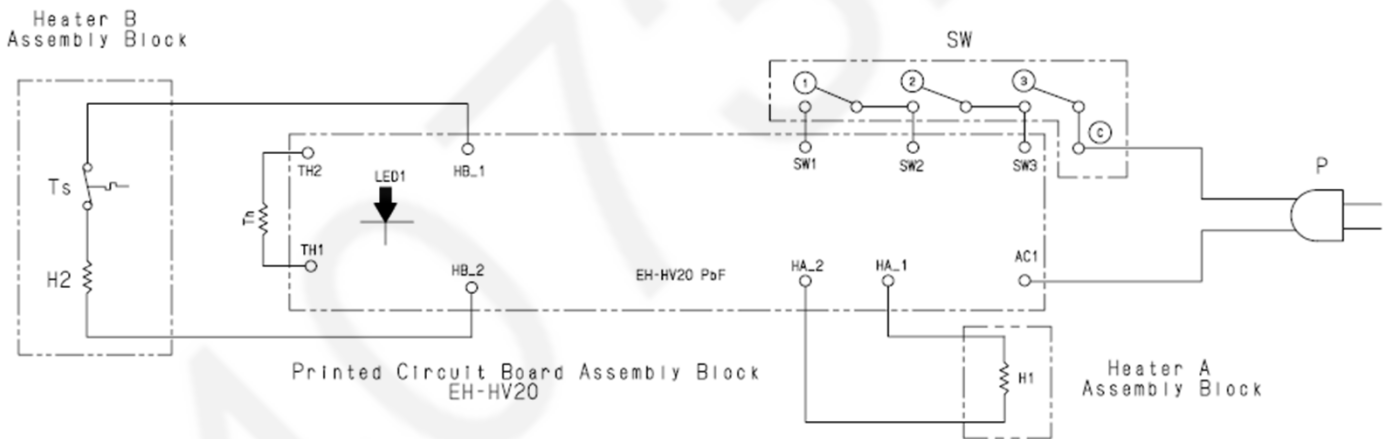

7 EXPLODED VIEW & REPLACEMENT PARTS LIST

7.1 Model No. : EH-HV20 Exploded View

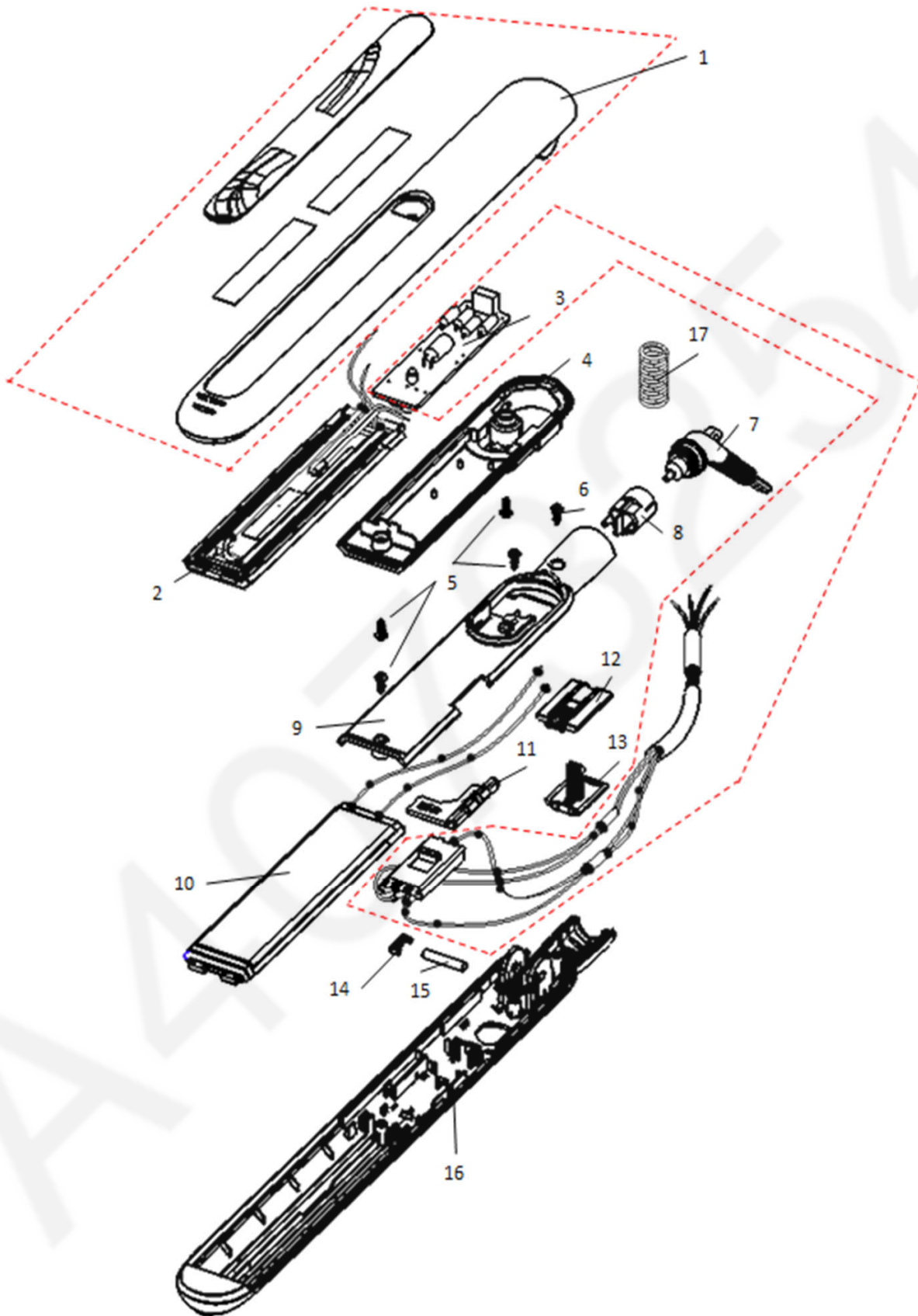

All parts are supplied from PMFTH-AP through PLAP

Model No. : EH-HV20 Parts List

Safety	Ref. No.	Part No.	Parts Name & Descriptions	Q'ty	Remarks
	1	EHHV20HSABW	HOUSING A	1	
	2	EHHV20HABW	HEATER A ASSEMBLY BLOCK	1	(FOR OTHER)
	2	EHHV20HAB8W	HEATER A ASSEMBLY BLOCK	1	(FOR RUSSIA / KAZAKHSTAN / UKRAINE)
	3	EHHV20CCAW	CIRCUIT ASSEMBLY BLOCK	1	
	4	EHHV20HSBBW	HOUSING B	1	(FOR VIETNAM)
	4	EHHV20HSBB4W	HOUSING B	1	(FOR INDONESIA / PHILIPPINES)
	4	EHHV20HSBB6W	HOUSING B	1	(FOR OTHER)
	4	EHHV20HSBB8W	HOUSING B	1	(FOR RUSSIA / KAZAKHSTAN / UKRAINE)
	4	EHHV20HSBB9W	HOUSING B	1	(FOR KUWAIT / QATAR)
	5	EHHV202606BW	TAPPING SCREW 2.6*6	4	
	6	EHHV202606ZW	TORX SCREW 2.6*6	1	
	7	EHHV20PCB2BW	POWER CORD	1	(B2-PLIUG)
	7	EHHV20PCS3BW	POWER CORD	1	(S3-PLIUG)
	8	EHHV20CTBW	CONNECTOR COVER ASSEMBLY	1	
	9	EHHV20PPCBW	PRESS PLATE COVER	1	
	10	EHHV20HBBW	HEATER B ASSEMBLY BLOCK	1	(FOR OTHER)
	10	EHHV20HBB8W	HEATER B ASSEMBLY BLOCK	1	(FOR RUSSIA / KAZAKHSTAN / UKRAINE)
	11	EHHV20MSPBW	MAIN SWITCH PLATE	1	
	12	EHHV20SSCTW	SLIDE SWITCH COVER	1	
	13	EHHV20SSPBW	SLIDE SWITCH	1	
	14	EHHV20HCBW	HINGE COVER	1	
	15	EHHV20HPW	HINGE PIN	1	
	16	EHHV20PP41BW	PRESS PLATE	1	(FOR INDONESIA / PHILIPPINES)
	16	EHHV20PP6BW	PRESS PLATE	1	For Oman/UAE,India,Vietnam,Malaysia,Saudi A.,Qatar/Kuwait,Russia,Ukr,Kaz
	16	EHHV20PP23BW	PRESS PLATE	1	(FOR HONG KONG / SINGAPORE)
	17	EHHV20PSW	PIVOT SPRING	1	
	-	EHHV20S03UW	OPERATING INSTRUCTIONS	1	(FOR OTHER)
	-	EHHV2068503W	OPERATING INSTRUCTIONS	1	(FOR OMAN / UAE / SAUDI A. / QATAR / KUWAIT)
	-	EHHV2086503W	OPERATING INSTRUCTIONS	1	(FOR RUSSIA / KAZAKHSTAN / UKRAINE)
	-	EHHV20S415KW	INDIVIDUAL PACKAGE	1	(FOR BLACK,-K415 : INDONESIA / PHILIPPINES)
	-	EHHV20S605KW	INDIVIDUAL PACKAGE	1	(FOR BLACK,-K605 : HONG KONG)
	-	EHHV20S645KW	INDIVIDUAL PACKAGE	1	(FOR BLACK,-K645 : VIETNAM)
	-	EHHV20S655KW	INDIVIDUAL PACKAGE	1	(FOR BLACK,-K655 : MALAYSIA)
	-	EHHV20S685KW	INDIVIDUAL PACKAGE	1	(FOR BLACK,-K685 : OMAN / UAE / SAUDI A.)
	-	EHHV20S695KW	INDIVIDUAL PACKAGE	1	(FOR BLACK,-K695 : QATAR / KUWAIT)
	-	EHHV20S62KW	INDIVIDUAL PACKAGE	1	(FOR BLACK,-K62B : INDIA)
	-	EHHV20S865KW	INDIVIDUAL PACKAGE	1	(FOR BLACK,-K865 : RUSSIA / KAZAKHSTAN / UKRAINE)

Remarks : *1 Individual Available