

Service Manual

(Household) Straight & Curl Straightener

Model No EH-HV10

Asia

Middle East

Russia



⚠ WARNING

This service information is designed for experienced repair technicians only and is not designed for use by the general public. It does not contain warnings or cautions to advise non-technical individuals of potential dangers in attempting to service a product. Products powered by electricity should be serviced or repaired only by experienced professional technicians. Any attempt to service or repair the product or products dealt with in this service information by anyone else could result in serious injury or death.

IMPORTANT SAFETY NOTICE

There are special components used in this equipment which are important for safety. These parts are marked by ⚠ in the Schematic Diagrams, Circuit Board Diagrams, Exploded Views and Replacement Parts List. It is essential that these critical parts should be replaced with manufacturer's specified parts to prevent shock, fire or other hazards. Do not modify the original design without permission of manufacturer.

TABLE OF CONTENTS

	PAGE
1 Warning -----	2
2 Specifications -----	2
3 Troubleshooting Guide -----	3
4 Disassembly and Assembly Instructions -----	4
5 Wiring Connection Diagram-----	7
6 Schematic Diagram -----	8
7 Exploded View & Replacement Parts List -----	9

1. Warning

Caution:

- Pb free solder has a higher melting point than standard solder. Typically the melting point is 50 - 70°F (30 - 40°C) or higher. Please use soldering iron with temperature control and adjust it to 750 ±20°F (400 ± 10°C). In case of using high temperature soldering iron, please be careful not to heat too long.
- Pb free solder will tend to splash when heated too high (about 1100°F / 600°C).

2. Specifications

Sales Area		Asia	
Power source		AC100-240V, 50-60Hz	
Power consumption		22 W	
Iron Plate temperature		200 °C	
Body size (mm.)		Without Cap	230×28×32
		With Cap	235 x 35 x 39
Weight	S3 Plug (SF629/UK13A3)	Without Cap	300 g
		With Cap	330 g
	B2 Plug (SF82/M3204)	Without Cap	270 g
		With Cap	300 g
	B2 Plug (SF822)	Without Cap	260 g
		With Cap	290 g
Cord length		S3(SF629/UK13A3) Plug	1.7 m
		B2(SF82/M3204) Plug	1.7 m
		B2(SF822) Plug	1.7 m

3. Troubleshooting Guide (Refer to SCHEMATIC DIAGRAM)

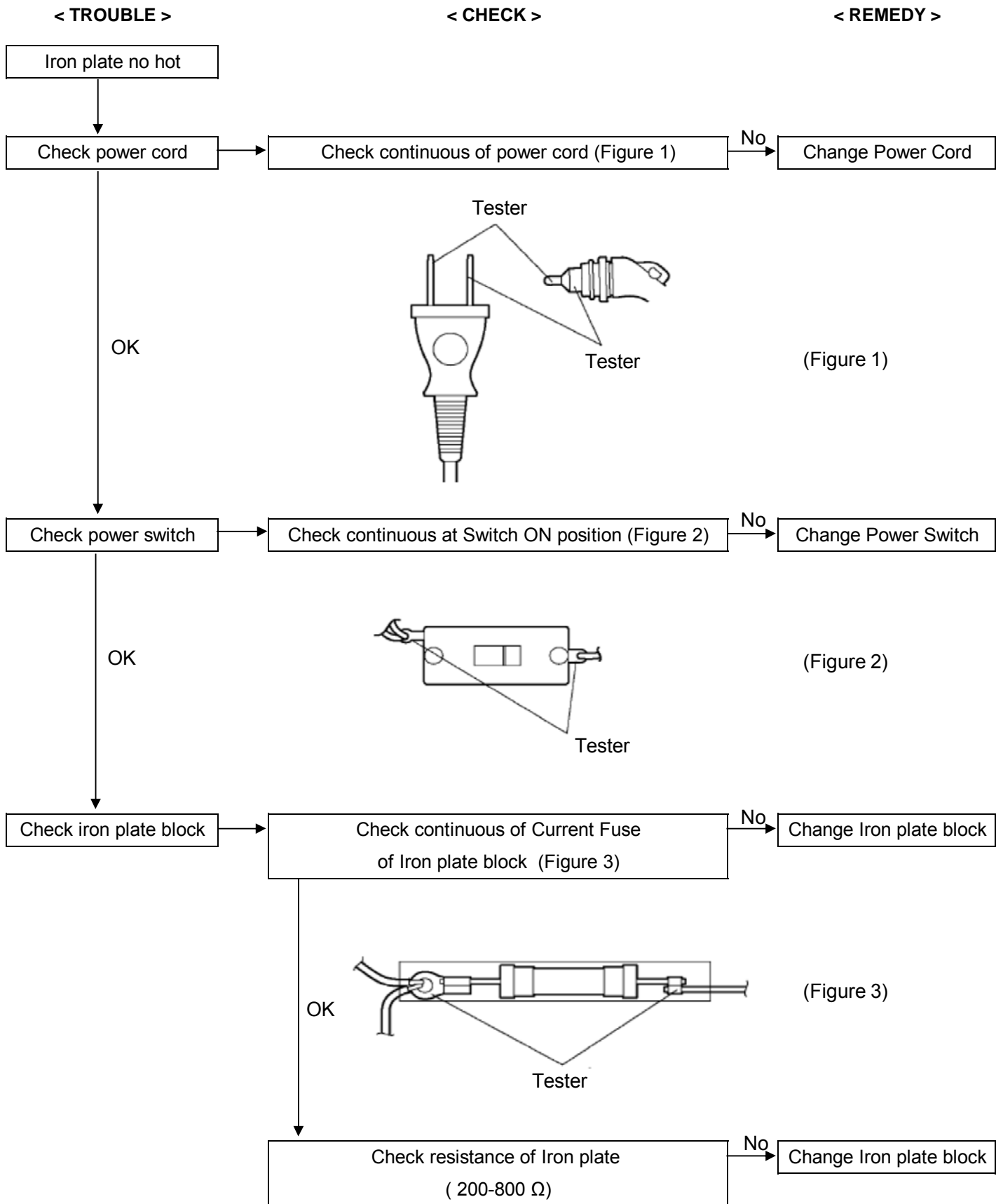

4. Disassembly and Assembly Instructions

4.1 Disassembly Instructions

1. Insert a small flat head screw driver into the groove of the Shaft Cover as shown in Figure 4.

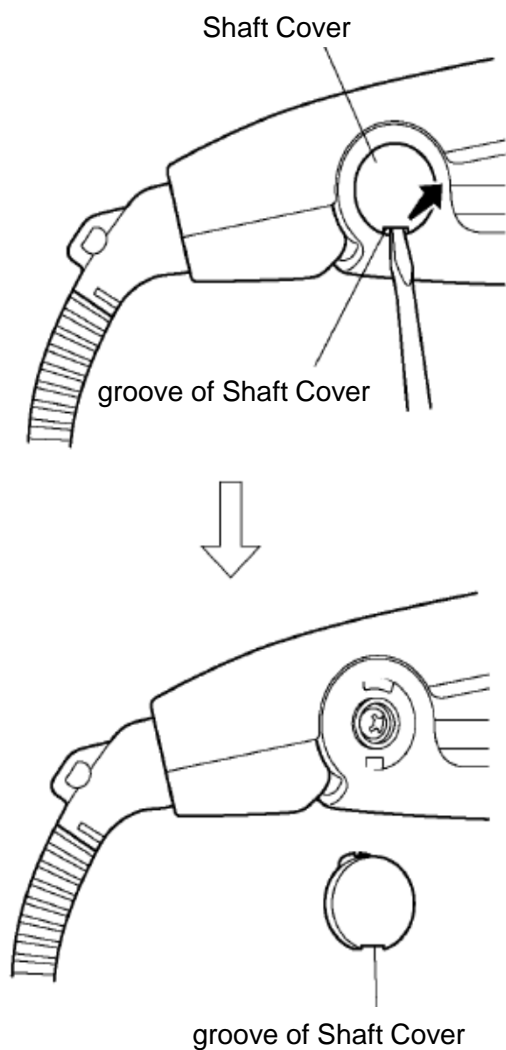

(Figure 4)

2. Remove the Shaft screw and take off the Shaft from Main body as shown in Figure 5.

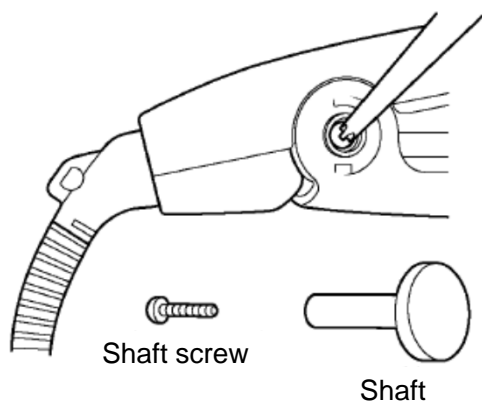

(Figure 5)

3. Remove the spring by pull out the Housing side and Press plate side as shown in Figure 6.

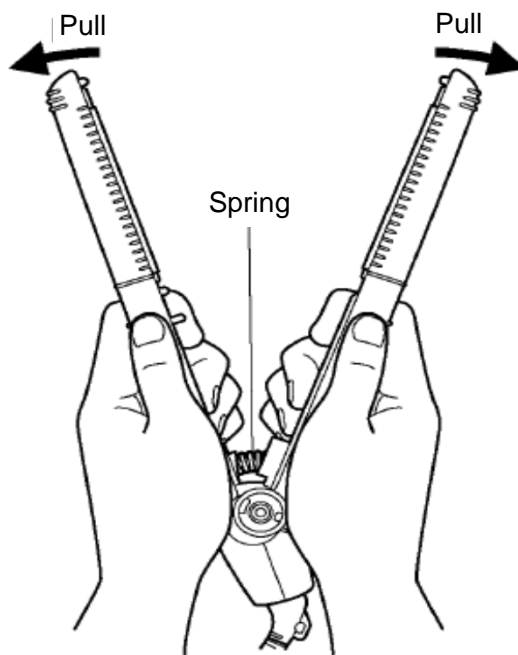

(Figure 6)

4. Using a screw driver remove the two tapping screw from Press plate cover as shown in Figure 7.
※Be careful not to lose the spring ※.

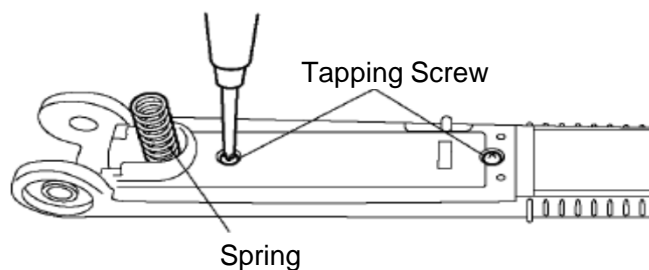

(Figure 7)

5. Take off the Press plate cover as shown in Figure 8.

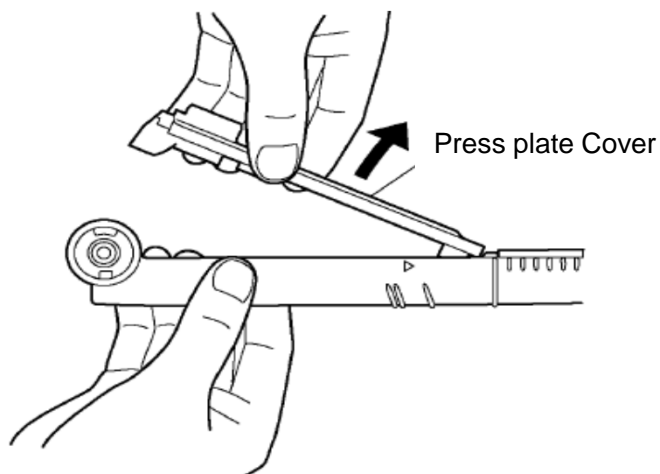

(Figure 8)

6. Remove the Iron Plate ass'y B/K of Press plate side as shown in Figure 9.

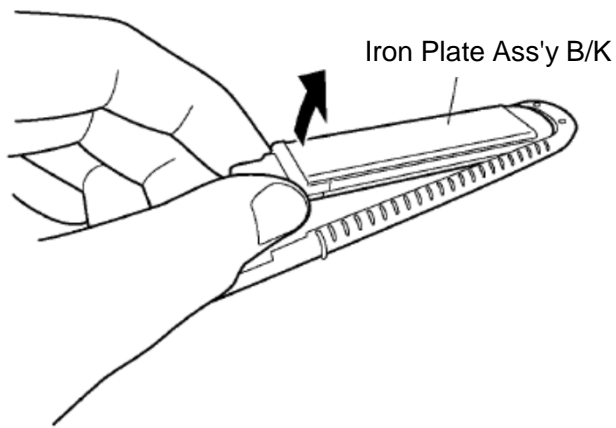

(Figure 9)

8. Take off the Housing B as shown in Figure 11.

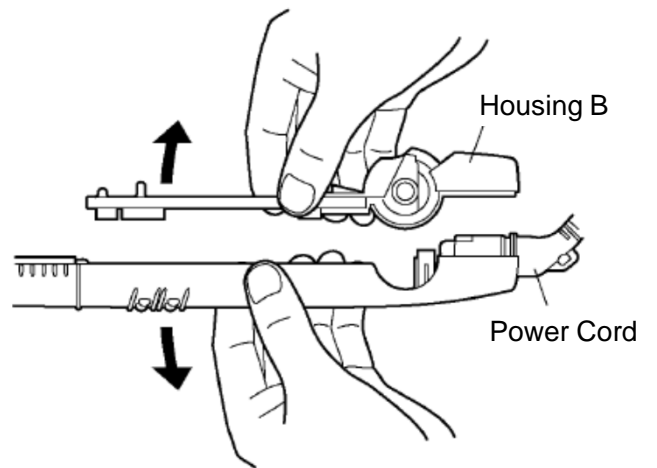

(Figure 11)

7. Using screw driver remove the 2 tapping screw and 1 torx screw as shown in Figure 10.

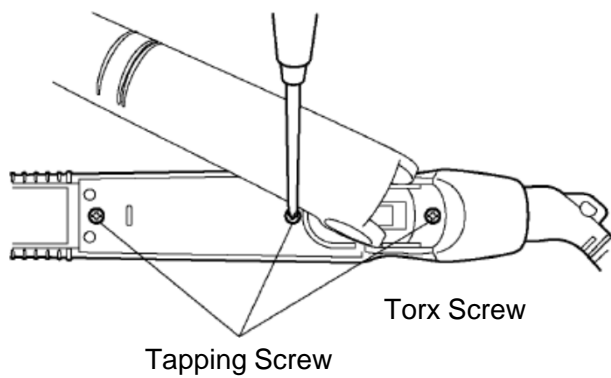

(Figure 10)

9. Remove the Iron Plate ass'y B/K of Housing side as shown in Figure 12.

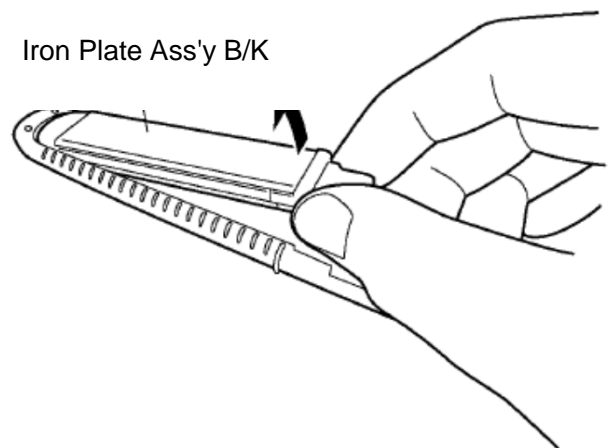

(Figure 12)

4.2 Assembly Instructions

1. Arrange Lead wire into rib of Press plate as shown in Figure 13.

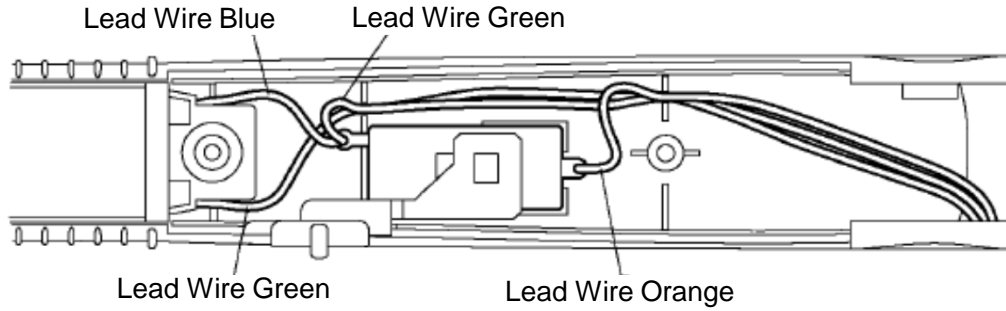

(Figure 13)

· Arrange Lead wire into rib of Housing A as shown in Figure 14.

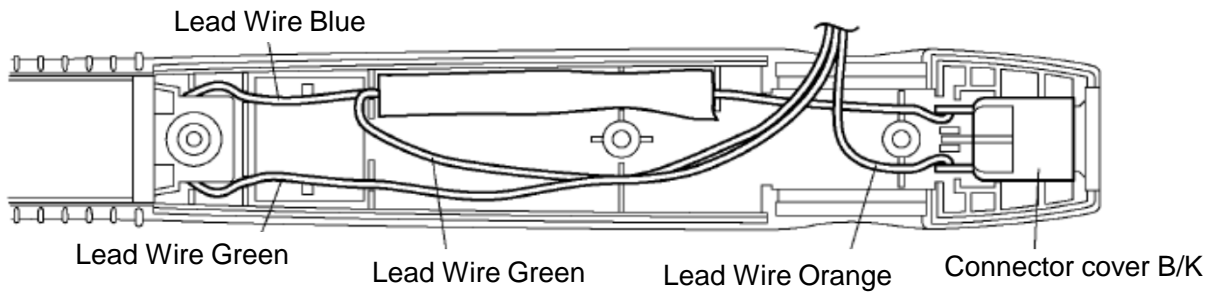

(Figure 14)

2. Assembly Housing B together with Housing A as shown in Figure 15.

· Ensure that the power cord is attached to the connector cover.

(Apply grease foil at the power cord terminal)

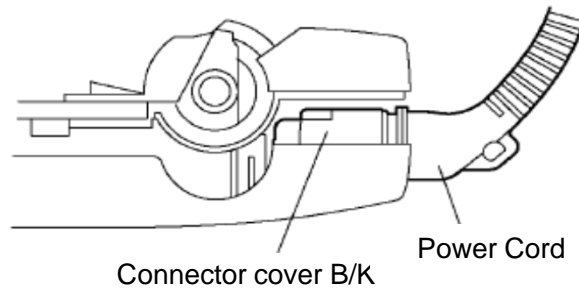

(Figure 15)

3. Fixing Shaft cover follow hook direction as shown in Figure 16.

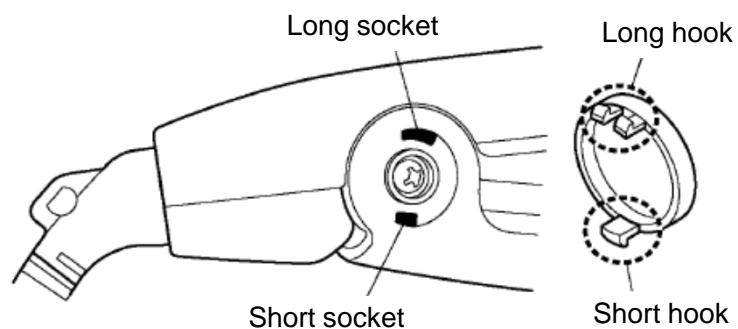

(Figure 16)

5. Wiring Connection Diagram

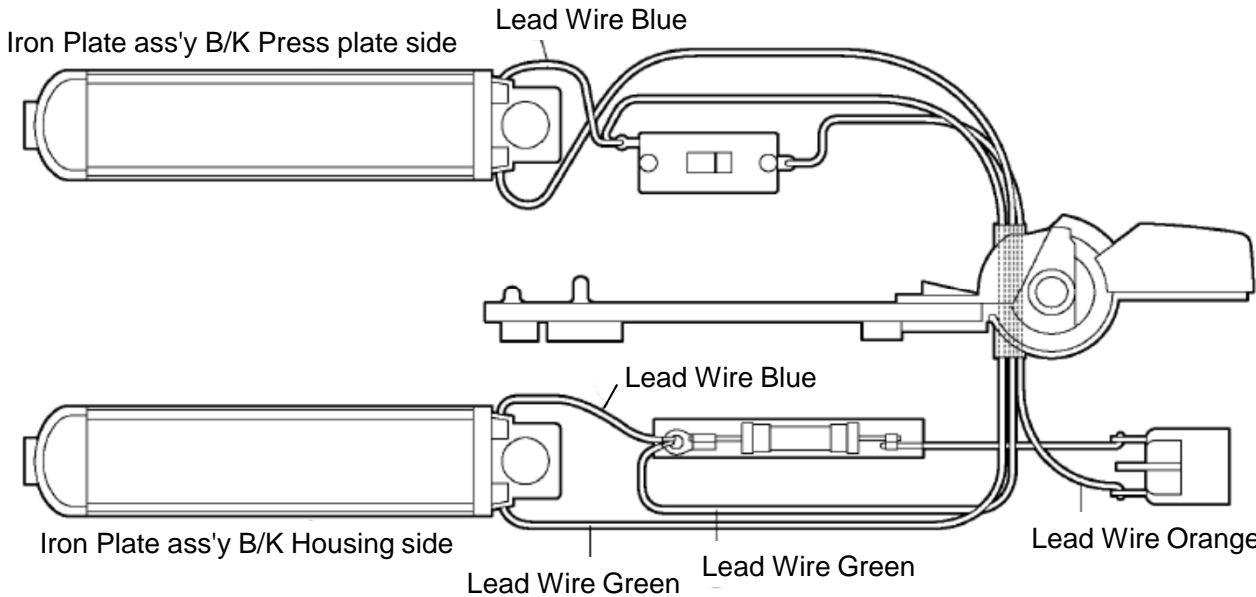

(Figure 17)

6. Schematic Diagram

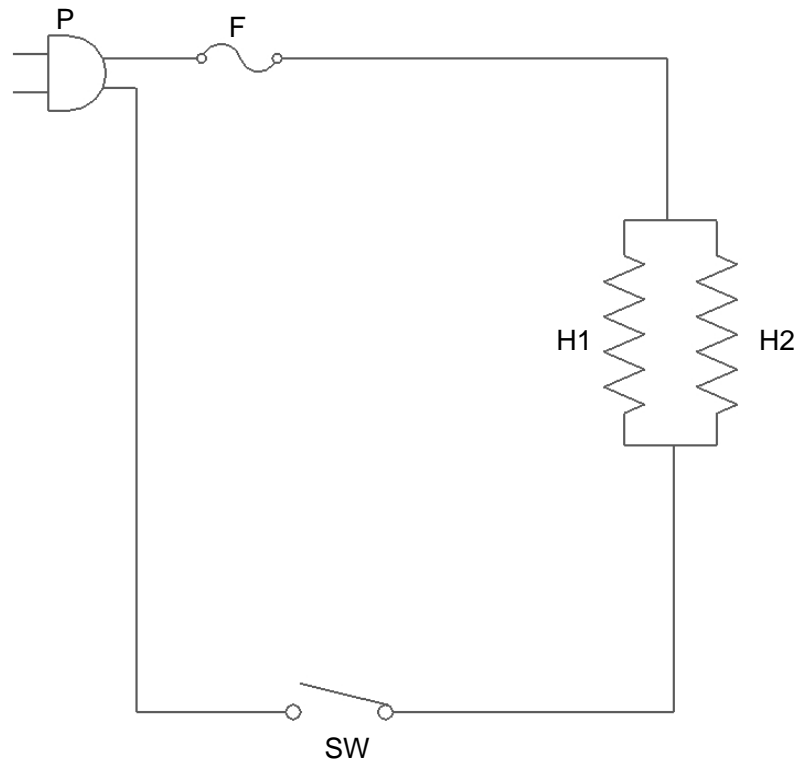

(Figure 18)

F	Current Fuse	250V, 5A	1
H1, H2	PTC Heating Element	200 ~ 800 ohm	1
SW	Main Switch	11A,125VAC / 5.5A,250VAC	1
P	Power Cord		

	a	b
C-1	OFF	ON

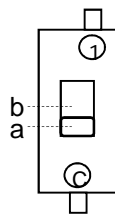

7 EXPLODED VIEW & REPLACEMENT PARTS LIST

7.1 Model No. : EH-HV10 Exploded View

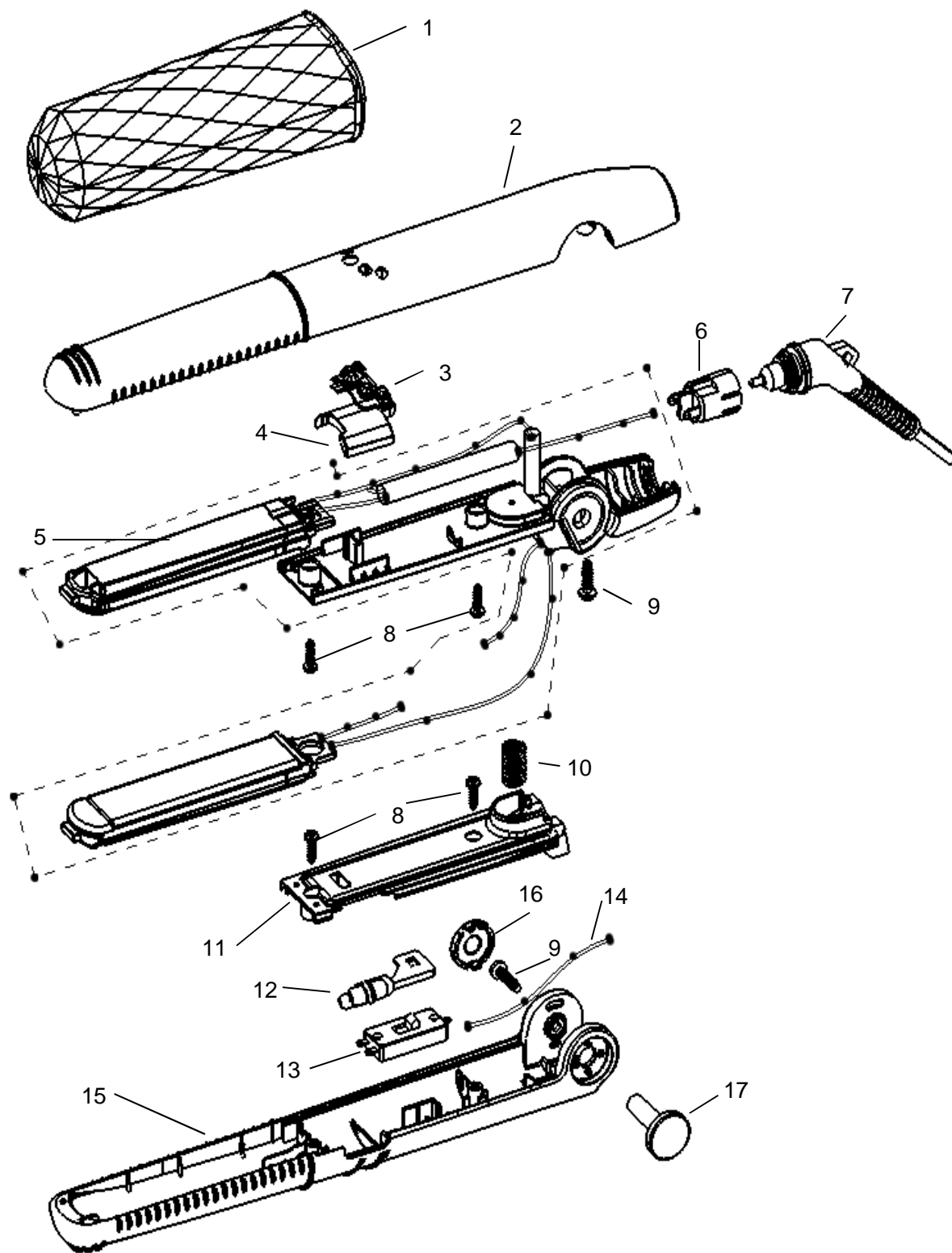

All parts are supplied from PMFTH-AP through PLAP

Model No. : EH-HV10 Parts List

Safety	Ref. No.	Part No.	Parts Name & Descriptions	Q'ty	Remarks
	1	EHHV10CRPW	CAP (ROUGE PINK)	1	(FOR BLACK COLOR)
	1	EHHV10CVPW	CAP (VIVID PINK)	1	(FOR VIVID PINK COLOR)
	1	EHHV10CPW	CAP (METALLIC PINK)	1	(FOR WHITE COLOR)
	2	EHHV10HSABW	HOUSING A (BLACK)	1	
	2	EHHV10HSAPW	HOUSING A (VIVID PINK)	1	
	2	EHHV10HSAWW	HOUSING A (WHITE)	1	
	3	EHHV10STRPW	STONE (ROUGE PINK)	1	(FOR BLACK COLOR)
	3	EHHV10STVPW	STONE (TRANSPARENT PINK)	1	(FOR VIVID PINK AND WHITE COLOR)
	4	EHHV10STPCW	STONE PLATE (CLEAR)	1	
	5	EHHV10IPBW	IRON PLATE (BLACK)	1	(FOR OTHERS)
	5	EHHV10IP41BW	IRON PLATE (BLACK)	1	(FOR INDONESIA,PHILIPPINES,SINGAPORE)
	5	EHHV10IP64BW	IRON PLATE (BLACK)	1	(FOR VIETNAM,INDIA)
	5	EHHV10IP69BW	IRON PLATE (BLACK)	1	(FOR QATAR,KUWAIT)
	5	EHHV10IP86BW	IRON PLATE (BLACK)	1	(FOR RUSSIA,Ukr,Kaz)
	5	EHHV10IPPW	IRON PLATE (VIVID PINK)	1	(FOR OTHERS)
	5	EHHV10IP41PW	IRON PLATE (VIVID PINK)	1	(FOR INDONESIA,PHILIPPINES,SINGAPORE)
	5	EHHV10IP64PW	IRON PLATE (VIVID PINK)	1	(FOR VIETNAM,INDIA)
	5	EHHV10IP69PW	IRON PLATE (VIVID PINK)	1	(FOR QATAR,KUWAIT)
	5	EHHV10IPWW	IRON PLATE (WHITE)	1	(FOR OTHERS)
	5	EHHV10IP41WW	IRON PLATE (WHITE)	1	(FOR INDONESIA,PHILIPPINES,SINGAPORE)
	5	EHHV10IP64WW	IRON PLATE (WHITE)	1	(FOR VIETNAM,INDIA)
	6	EHHV10CTBW	CONNECTOR COVER BLOCK	1	
	7	EHHV10PCB2BW	POWER CORD (BLACK)	1	(B2-PLUG)
	7	EHHV10PCS3BW	POWER CORD (BLACK)	1	(S3-PLUG)
	7	EHHV10PCB2HW	POWER CORD (GRAY)	1	(FOR VIVID PINK AND WHITE COLOR, B2-PLUG)
	7	EHHV10PCS3HW	POWER CORD (GRAY)	1	(FOR VIVID PINK AND WHITE COLOR, S3-PLUG)
	8	EHHV102608BW	TAPPING SCREW 2.6*8 (BLACK)	4	*1
	8	EHHV102608SW	TAPPING SCREW 2.6*8 (SILVER)	4	*1
	9	EHHV103010BW	TORX SCREW 3*10 (BLACK)	2	*1
	9	EHHV103010SW	TORX SCREW 3*10 (SILVER)	2	*1
	10	EHHV10PSW	PIVOT SPRING	1	
	11	EHHV10PPCBW	PRESS PLATE COVER (BLACK)	1	
	11	EHHV10PPCPW	PRESS PLATE COVER (VIVID PINK)	1	
	11	EHHV10PPCWW	PRESS PLATE COVER (WHITE)	1	
	12	EHHV10SPBW	SWITCH PLATE (BLACK)	1	
	12	EHHV10SPPW	SWITCH PLATE (VIVID PINK)	1	
	12	EHHV10SPWW	SWITCH PLATE (WHITE)	1	
	13	EHHV10MSW	MAIN SWITCH	1	
	14	EHHV10LWA2W	LEAD WIRE (ORANGE)	1	
	15	EHHV10PPBW	PRESS PLATE (BLACK)	1	(FOR OTHERS)
	15	EHHV10PP41BW	PRESS PLATE (BLACK)	1	(FOR INDONESIA,PHILIPPINES,SINGAPORE)
	15	EHHV10PP23BW	PRESS PLATE (BLACK)	1	(FOR HONG KONG)

Safety	Ref. No.	Part No.	Parts Name & Descriptions	Q'ty	Remarks
	15	EHHV10PPPW	PRESS PLATE (VIVID PINK)	1	(FOR OTHERS)
	15	EHHV10PP41PW	PRESS PLATE (VIVID PINK)	1	(FOR INDONESIA,PHILIPPINES,SINGAPORE)
	15	EHHV10PP23PW	PRESS PLATE (VIVID PINK)	1	(FOR HONG KONG)
	15	EHHV10PPWW	PRESS PLATE (WHITE)	1	(FOR OTHERS)
	15	EHHV10PP41WW	PRESS PLATE (WHITE)	1	(FOR INDONESIA,PHILIPPINES,SINGAPORE)
	15	EHHV10PP23WW	PRESS PLATE (WHITE)	1	(FOR HONG KONG)
	16	EHHV10SCBW	SHAFT COVER (BLACK)	1	
	16	EHHV10SCPW	SHAFT COVER (VIVID PINK)	1	
	16	EHHV10SCWW	SHAFT COVER (WHITE)	1	
	17	EHHV10SHBW	SHAFT (BLACK)	1	
	17	EHHV10SHPW	SHAFT (VIVID PINK)	1	
	17	EHHV10SHWW	SHAFT (WHITE)	1	
	-	EHHV10S03UW	OPERATING INSTRUCTIONS	1	(FOR OTHERS)
	-	EHHV1061503W	OPERATING INSTRUCTIONS	1	(FOR OMAN,UAE,SAUDI,QATAR,KUWAIT)
	-	EHHV1086503W	OPERATING INSTRUCTIONS	1	(FOR RUSSIA,Ukr,Kaz)
	-	EHHV10S01KW	INDIVIDUAL PACKAGE	1	(FOR BLACK,-K605 : HONG KONG)
	-	EHHV10S615KW	INDIVIDUAL PACKAGE	1	(FOR BLACK,-K615 : OMAN,UAE,SAUDI)
	-	EHHV10S62KW	INDIVIDUAL PACKAGE	1	(FOR BLACK,-K62B : INDIA)
	-	EHHV10S645KW	INDIVIDUAL PACKAGE	1	(FOR BLACK,-K645 : VIETNAM)
	-	EHHV10S655KW	INDIVIDUAL PACKAGE	1	(FOR BLACK,-K655 : MALAYSIA)
	-	EHHV10S695KW	INDIVIDUAL PACKAGE	1	(FOR BLACK,-K695 : QATAR,KUWAIT)
	-	EHHV10S865KW	INDIVIDUAL PACKAGE	1	(FOR BLACK,-K865 : RUSSIA,Ukr,Kaz)
	-	EHHV10S01VPW	INDIVIDUAL PACKAGE	1	(FOR VIVID PINK, VP605 : HONG KONG)
	-	EHHV10S615VPW	INDIVIDUAL PACKAGE	1	(FOR VIVID PINK, VP615 : OMAN,UAE,SAUDI)
	-	EHHV10S62VPW	INDIVIDUAL PACKAGE	1	(FOR VIVID PINK, VP62B : INDIA)
	-	EHHV10S645VPW	INDIVIDUAL PACKAGE	1	(FOR VIVID PINK, VP645 : VIETNAM)
	-	EHHV10S655VPW	INDIVIDUAL PACKAGE	1	(FOR VIVID PINK, VP655 : MALAYSIA)
	-	EHHV10S695VPW	INDIVIDUAL PACKAGE	1	(FOR VIVID PINK, VP695 : QATAR,KUWAIT)
	-	EHHV10S01WW	INDIVIDUAL PACKAGE	1	(FOR WHITE,-W605 : HONG KONG)
	-	EHHV10S62WW	INDIVIDUAL PACKAGE	1	(FOR WHITE,-W62B : INDIA)
	-	EHHV10S645WW	INDIVIDUAL PACKAGE	1	(FOR WHITE,-W645 : VIETNAM)
	-	EHHV10S655WW	INDIVIDUAL PACKAGE	1	(FOR WHITE,-W655 : MALAYSIA)

Remarks : *1 Individual Available