

Service Manual

Wet/Dry Rechargeable Shaver

ES4025-A3

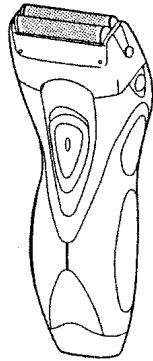

SPECIFICATIONS

Power source	AC100-120 / 220-240V, 50-60Hz
Power consumption	3VA
Motor voltage	1.2V DC
Charging time	8-hours
Shaves per charge	7 times (3minutes shave)
Measurement	(H)14.7 X (W)5.7 X (D)4.5 cm
Weight	160g
Supplied accessories	Soft case Cleaning brush

WARNING

This service information is designed for experienced repair technicians only and is not designed for use by the general public. It does not contain warnings or cautions to advise non-technical individuals of potential dangers in attempting to service a product. Products powered by electricity should be serviced or repaired only by experienced professional technicians. Any attempt to service or repair the product or products dealt with in this service information by anyone else could result in serious injury or death.

CONTENTS

	Page		Page
1 SCHEMATIC DIAGRAM	2	5 TROUBLESHOOTING GUIDE	7
2 WIRING CONNECTION DIAGRAM	2	6 EXPLODED VIEW	8
3 DISASSEMBLY INSTRUCTIONS	3	7 REPLACEMENT PARTS LIST	8
4 CAUTION IN ASSEMBLY	6		

1 SCHEMATIC DIAGRAM

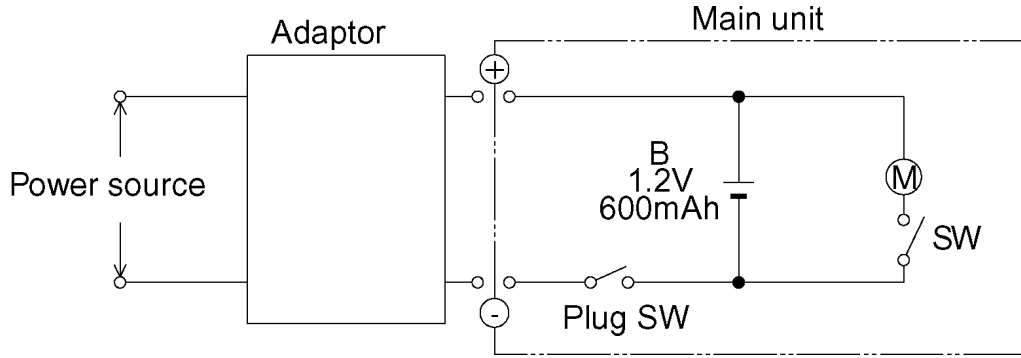

2 WIRING CONNECTION DIAGRAM

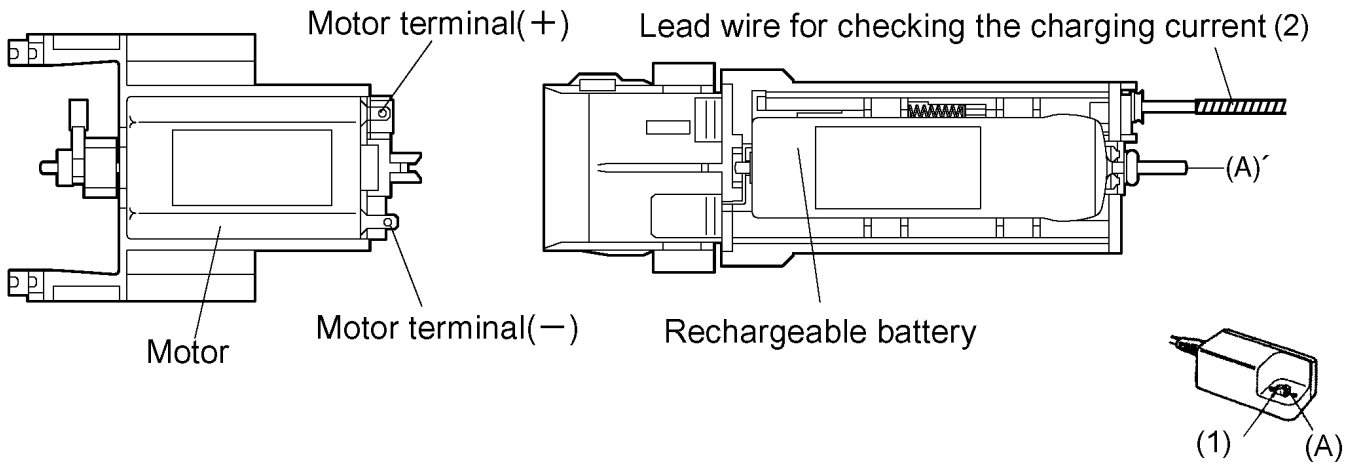

3 DISASSEMBLY INSTRUCTIONS

Follow the procedure below to disassemble the main unit.

1. Remove the cap, the outer foil with foil frame and the inner blade.

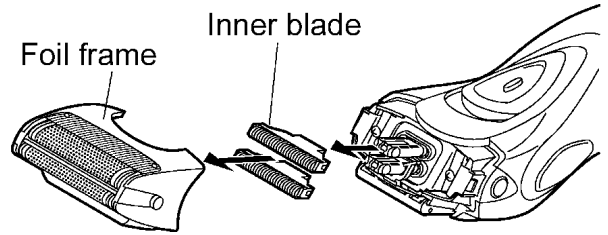

2. To remove the trimmer driving bar, press bar outward.

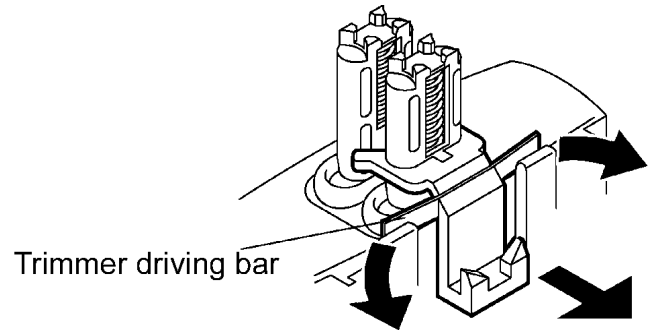

3. Loosen two screws and the retaining plate. Make sure to take two O-rings out.

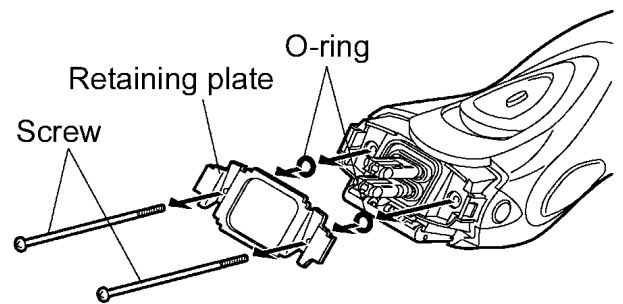

4. Remove the waterproof rubber.

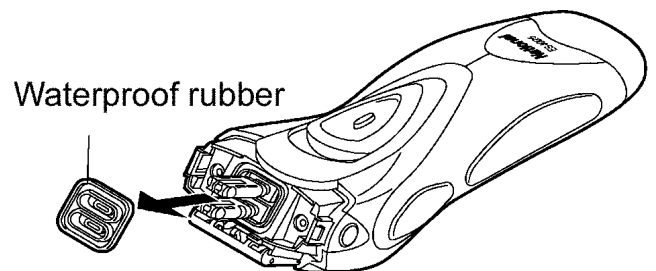

5. Take out the switch block lifting the blade holder slightly up.

NOTE: Make sure not to break the four parts of hooks on the switch handle.

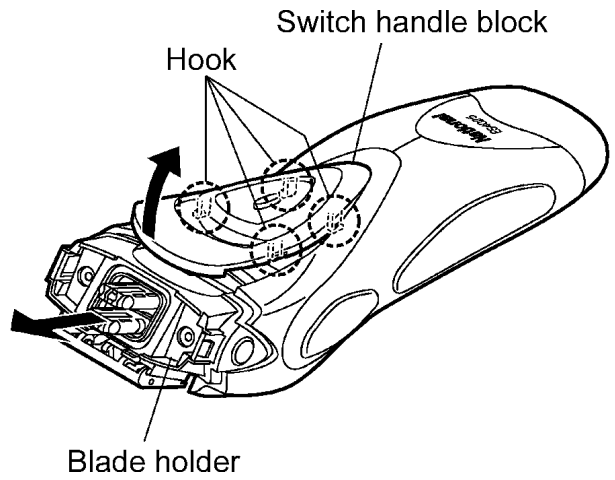

6. Take out the switch cam, o-ring and the blade holder block.

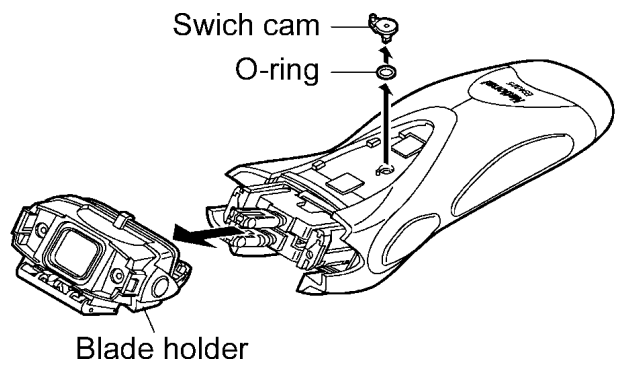

7. Remove the driving head.

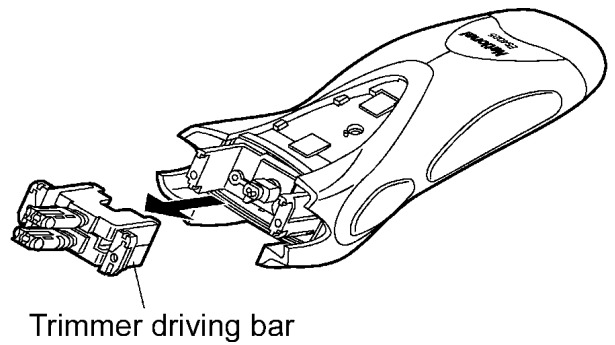

8. Take out the motor holder.

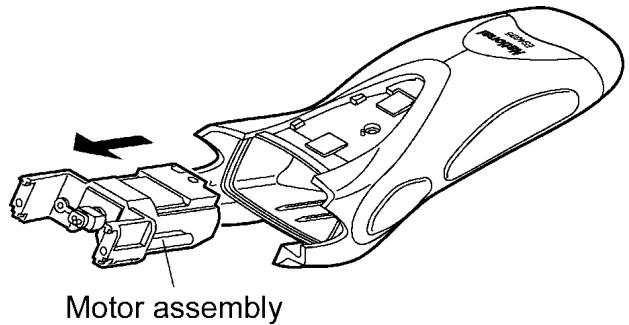

9. Take out the side panels.

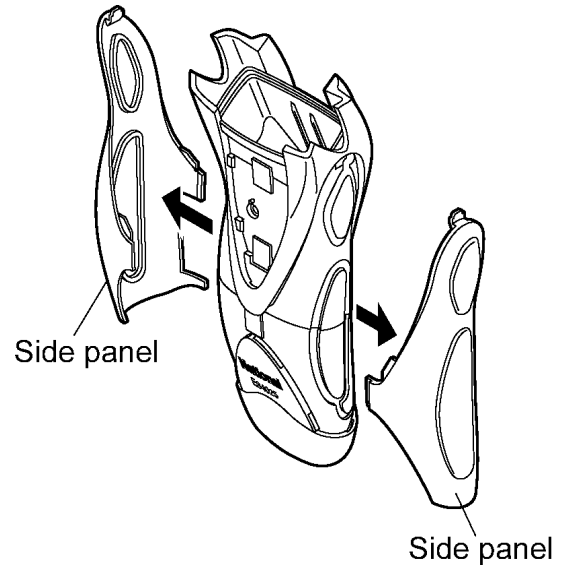

10. Loosen two screws and remove the housing.

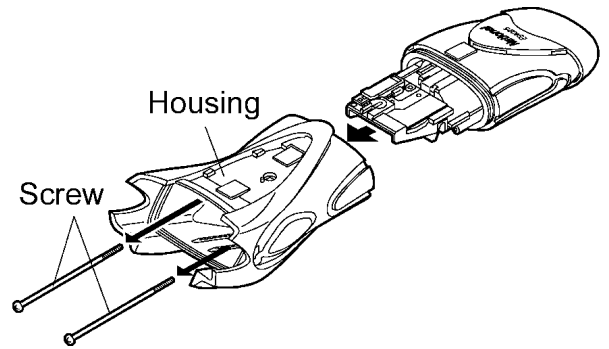

11. Take out the chassis block.

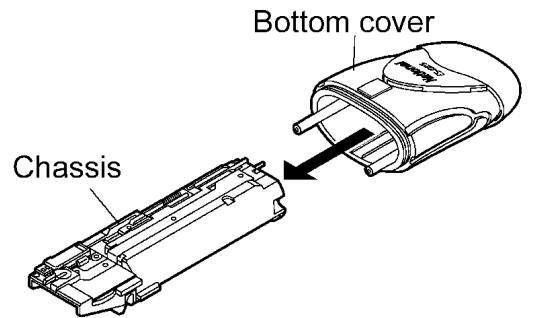

4 CAUTION IN ASSEMBLY

NOTE: When reassembling, replace the new waterproof rubber.

Make sure whether there is NO foreign substance sticking around a part covered with water seal.

4.1. Driving Head

Insert a motor tip pin into the hole of driving head and install driving head in chassis.

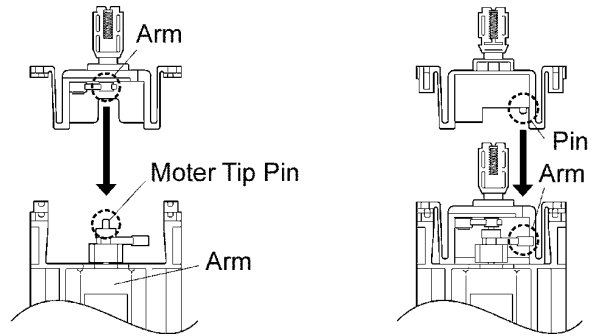

4.2. Waterproof Rubber

The waterproof rubber must be fitted the right way around.

Install as shown in figure by inserting firmly to the set position.

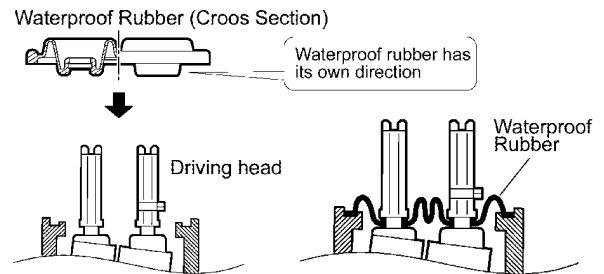

4.3. Battery/Plug lever

Make sure of the position for O-ring and washer.

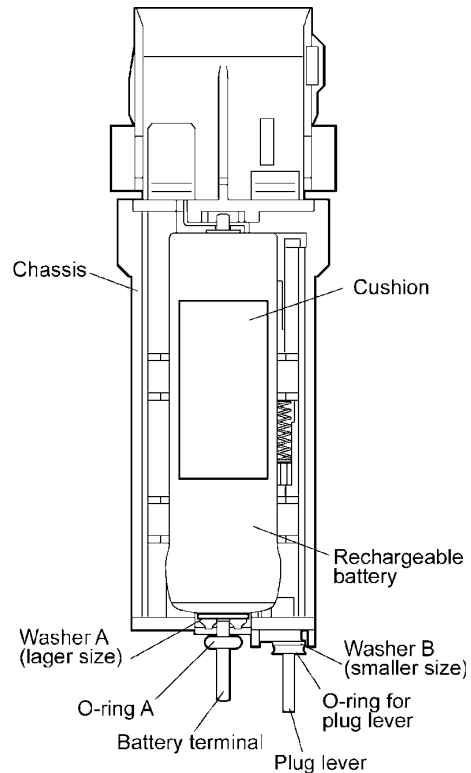

5 TROUBLESHOOTING GUIDE

(Refer to WIRING CONNECTION DIAGRAM)

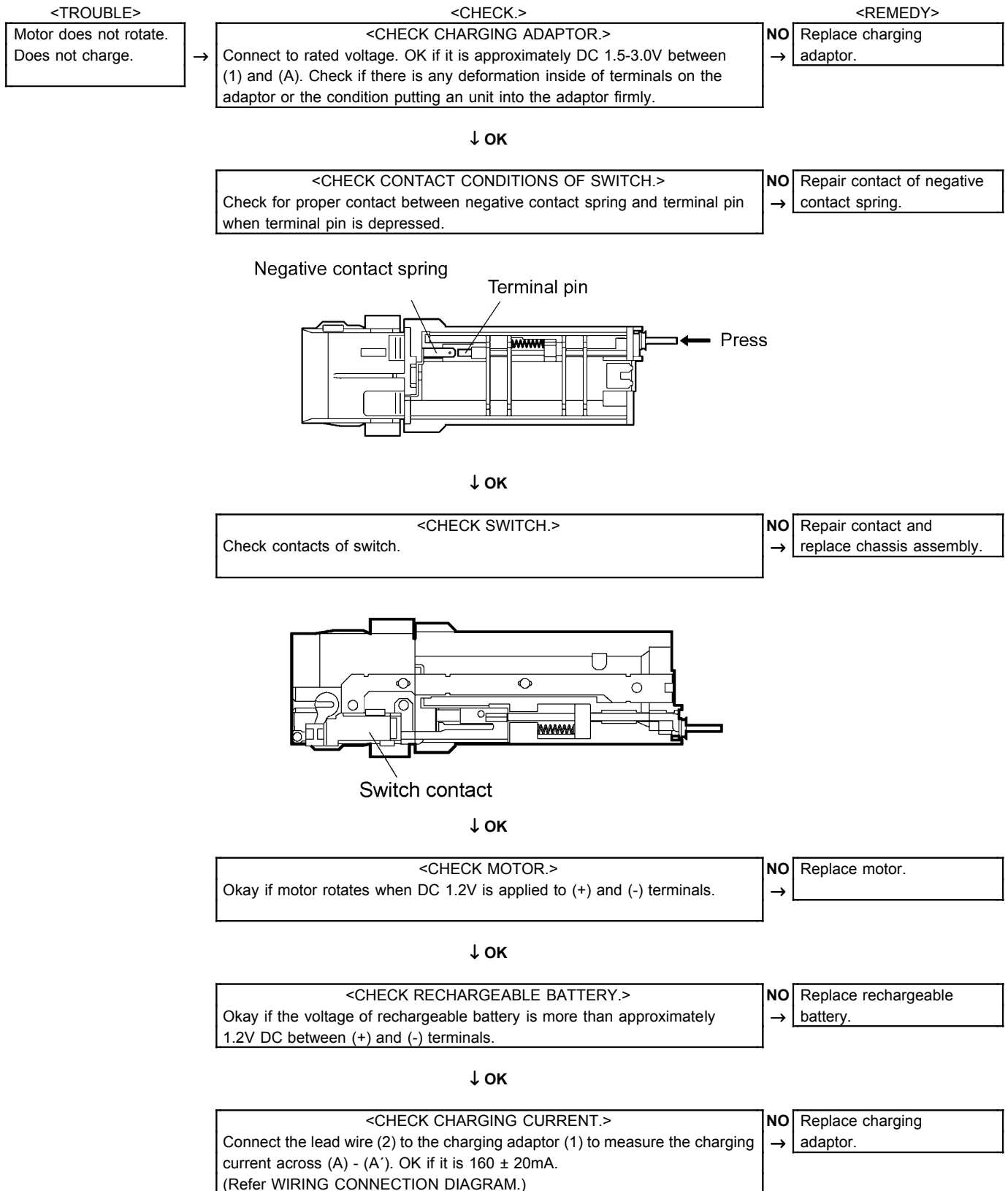

6 EXPLODED VIEW

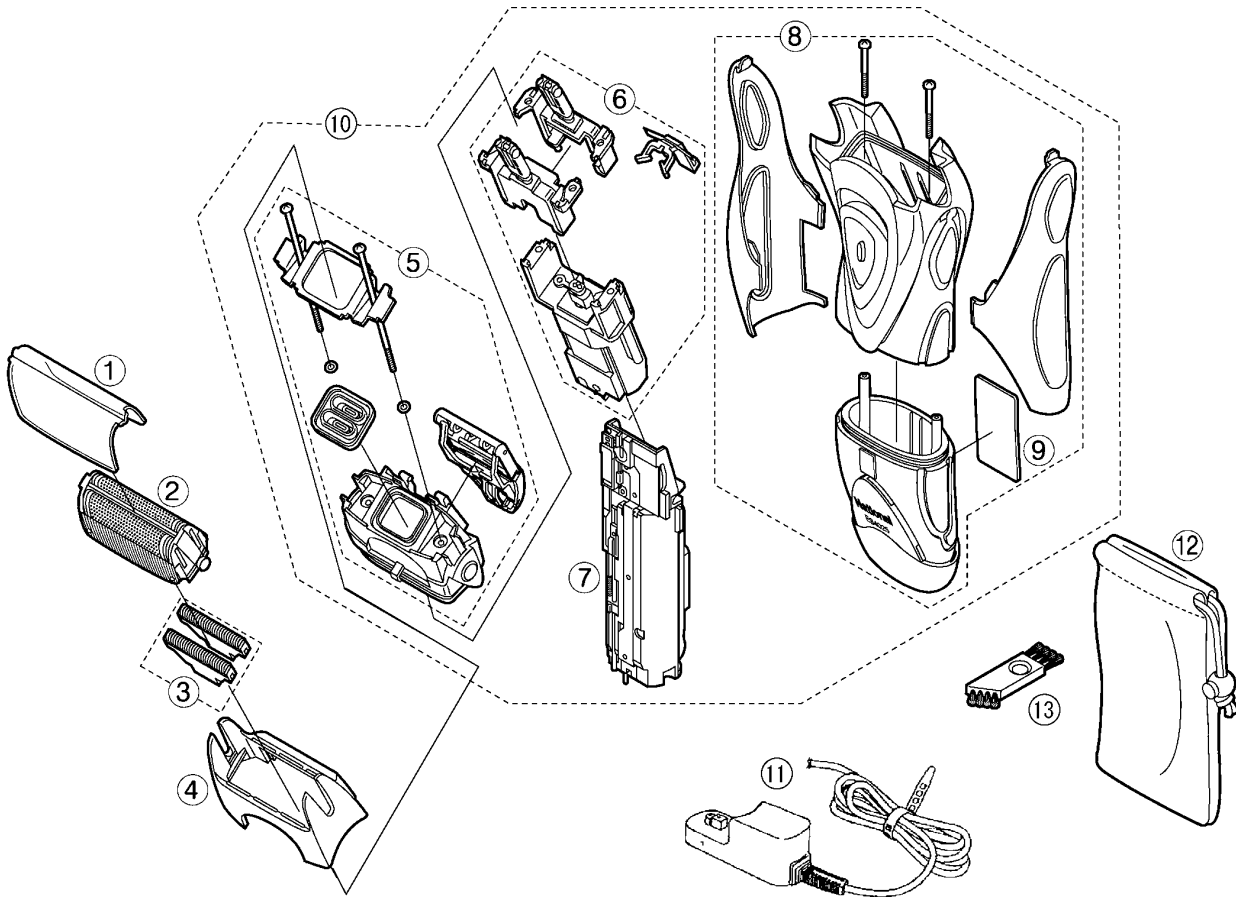

7 REPLACEMENT PARTS LIST

NOTE:

*A=available as an optional accessory

*B=only available as set

*C=available individually

Ref. No.	Part No.	Part Name & Description	Remarks	Per Unit
1	WES4025X7158	PROTECTIVE CAP		(BG) 1
2	WES9837E	OUTER FOIL		1
3	WES9850E	INNER BLADE	*B	2
4	WES4025S0048	FOIL FRAME		(BG) 1
5	WES4025A0008	BLADE HOLDER ASSEMBLY		(BG) 1
6	WES4025L1008	MOTOR ASSEMBLY		(BG) 1
7	WES4025L0779	CHASSIS ASSEMBLY		(BG) 1
8	WES4025S3059	HOUSING		(BG) 1
8	WES4025S3050	HOUSING	only for Hong Kong	(BG) 1
8	WES4025S3051	HOUSING	only for Taiwan	(BG) 1
9	WES4025S3319	NAME PLATE		(BG) 1
9	WES4025S3310	NAME PLATE	only for Hong Kong	(BG) 1
9	WES4025S3311	NAME PLATE	only for Taiwan	(BG) 1
10	WES4025S3039	BODY BLOCK		(BG) 1
10	WES4025S3030	BODY BLOCK	only for Hong Kong	(BG) 1
10	WES4025S3031	BODY BLOCK	only for Taiwan	(BG) 1
11	WES365H7663	CHARGING ADAPTOR	C-2 Plug	(BG) 1
11	WES4025A7662	CHARGING ADAPTOR	A-2 Plug	(BG) 1
11	WES4025A7671	CHARGING ADAPTOR	Korean Plug	(BG) 1
12	WES7025K7007	SOFT CASE		(BG) 1
13	WES861B7057	CLEANING BRUSH		1
-	WES4025S8008	INDIVIDUAL BOX		(BG) 1
-	WES4025S8009	INDIVIDUAL BOX	only for Hong Kong	(BG) 1
-	WES4025S8010	INDIVIDUAL BOX	only for Taiwan	(BG) 1
-	WES4025S8109	OPERATING INSTRUCTIONS		(BG) 1
-	WES4025S8100	OPERATING INSTRUCTIONS	only for Taiwan	(BG) 1