

Service Manual

(Household) Hair Dryer

Model No. EH-NE64

Asia

CIS

Middle East

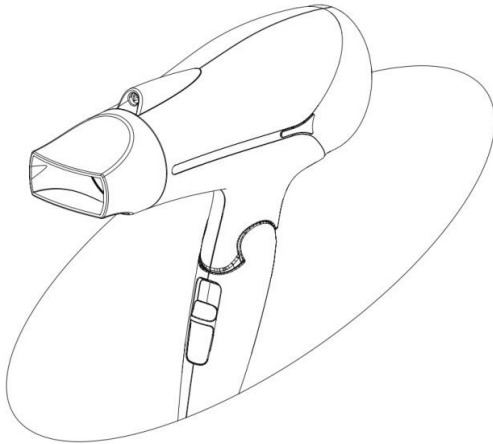

⚠ WARNING

This service information is designed for experienced repair technicians only and is not designed for use by the general public. It does not contain warnings or cautions to advise non-technical individuals of potential dangers in attempting to service a product. Products powered by electricity should be serviced or repaired only by experienced professional technicians. Any attempt to service or repair the product or products dealt with in this service information by anyone else could result in serious injury or death.

IMPORTANT SAFETY NOTICE

There are special components used in this equipment which are important for safety. These parts are marked by ⚠ in the Schematic Diagrams, Circuit Board Diagrams, Exploded Views and Replacement Parts List. It is essential that these critical parts should be replaced with manufacturer's specified parts to prevent shock, fire or other hazards. Do not modify the original design without permission of manufacturer.

TABLE OF CONTENTS

	PAGE
1 Warning	2
2 Specifications	2
3 Troubleshooting Guide	3
4 Disassembly and Assembly Instructions	4
4.1 Disassembly instruction.....	4
4.2 Assembly Instructions.....	5
5 Wiring Connection Diagram.....	6
6 Schematic Diagram	7
7 Exploded View & Replacement Parts List	8
7.1 Exploded View for EH-NE64	8
7.2 Parts List for EH-NE64	9

Panasonic

© Panasonic Corporation 2016 Unauthorized copying and distribution is a violation of law.

1. Warning

Caution:

- Pb free solder has a higher melting point than standard solder; Typically the melting point is 50 - 70°F (30 - 40°C) higher. Please use a soldering iron with temperature control and adjust it to 750 ±20°F (400 ± 10 °C). In case of using high temperature soldering iron, please be careful not to heat too long.

- Pb free solder will tend to splash when heated too high (about 1100°F / 600°C).

2. Specifications

Power source	AC 220-240 V 50-60 Hz
Power consumption	Approx. "3" Turbo 220 V ~ 1700 W 230 V ~ 1850 W 240 V ~ 2000 W
Air volume without nozzle	1.45 m ³ /min
Air flow temperature ("3" Turbo)	90 K (in case of room temperature 30°C)
Dimensions	(W) 80 x (D) 170 x (H) 260 mm
Cord length	L = 1.7 m
Weight	Approx. 380 g (Without cord and Without Nozzle)

Supplied accessory	EH-NE64	Set nozzle
--------------------	---------	------------

3 TROUBLESHOOTING GUIDE

Refer to WIRING CONNECTION DIAGRAM.

< TROUBLE >

< CHECK >

< REMEDY >

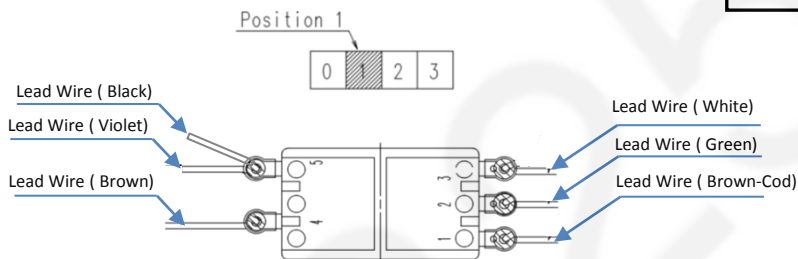
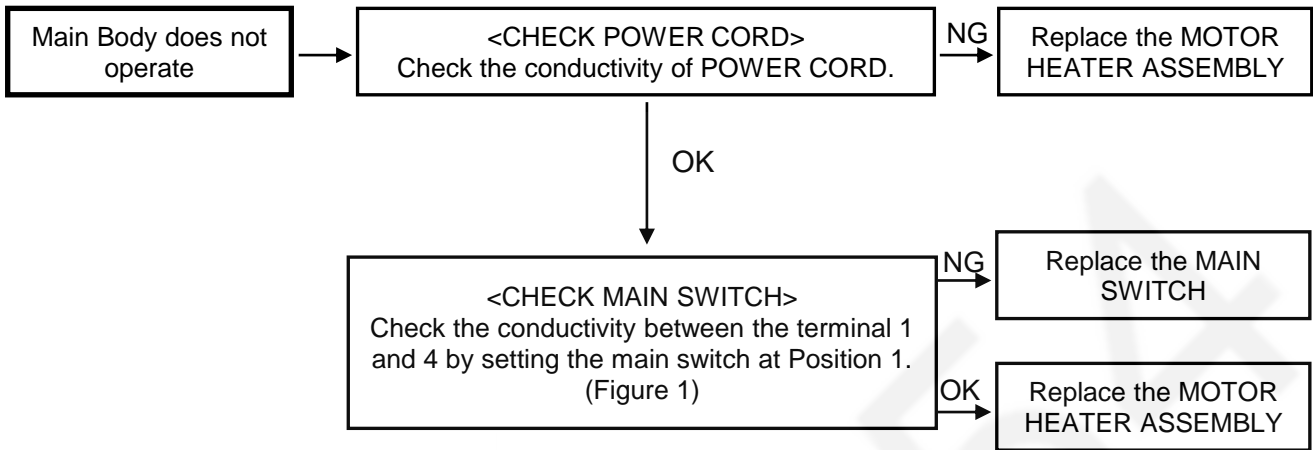

Figure 1

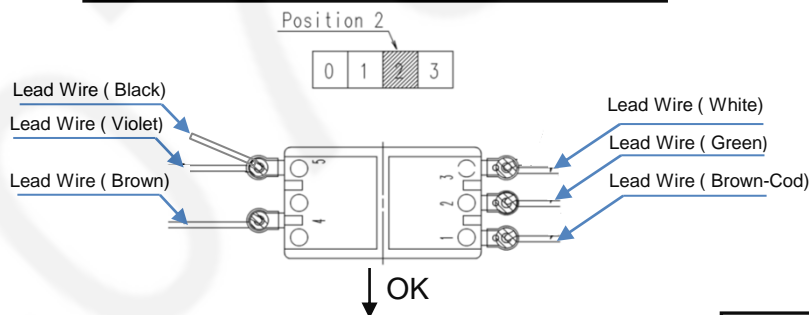
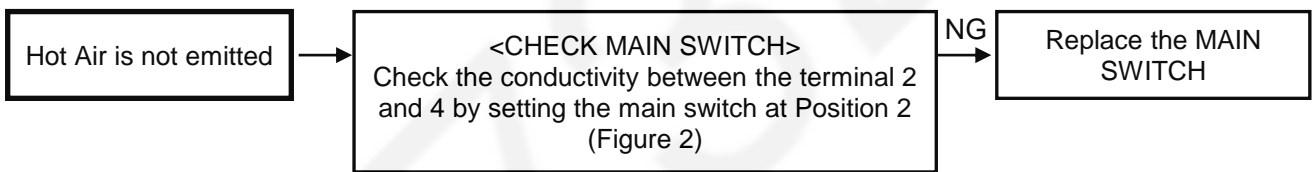

Figure 2

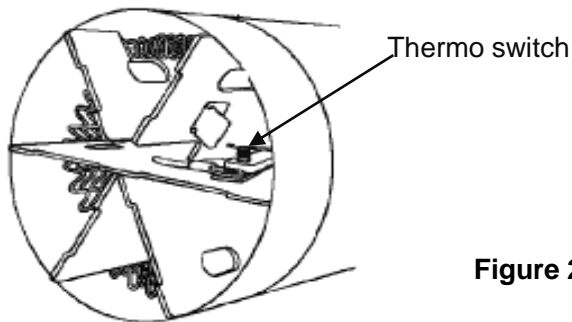
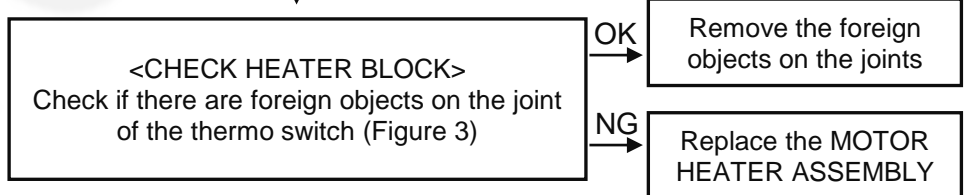
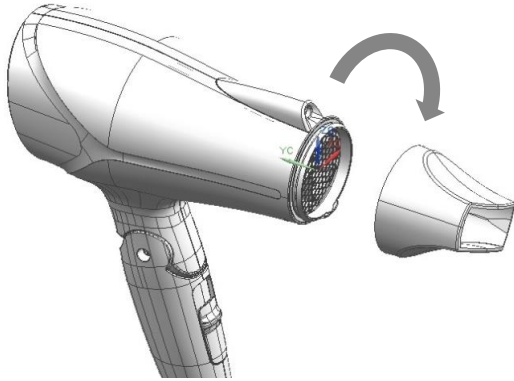

Figure 2

4. Disassembly and Assembly Instructions

4.1. Disassembly Instructions

(1) Take off NOZZLE as same direction as below.



(4). Take off HANDLE AB then take out CLICK RING and SWIVEL RING method as below.

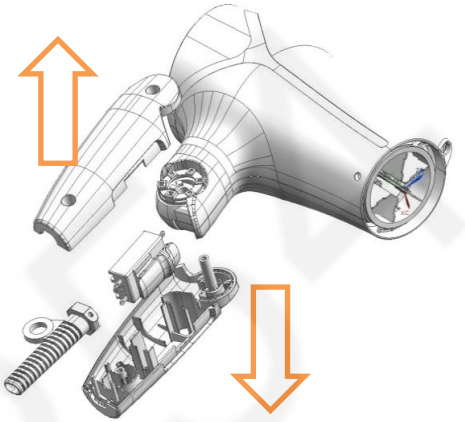

(2). Remove 2 TAPPING SCREWS at HOUSING A by flat-blade screwdriver and 2 TORX SCREWS at HANDLE by Driver.

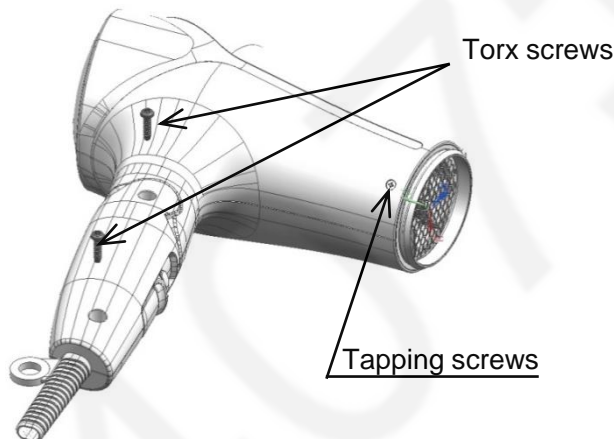

(5). Take off HOUSING A method as below.

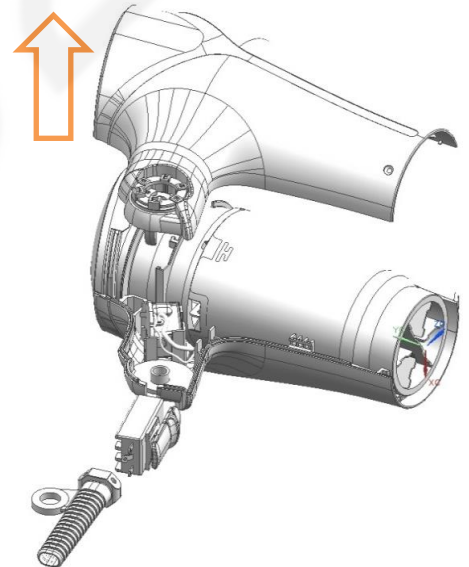

(3) Take off an AIR OUTLET GRILL and an AIR OUTLET RING by rotating method as below.

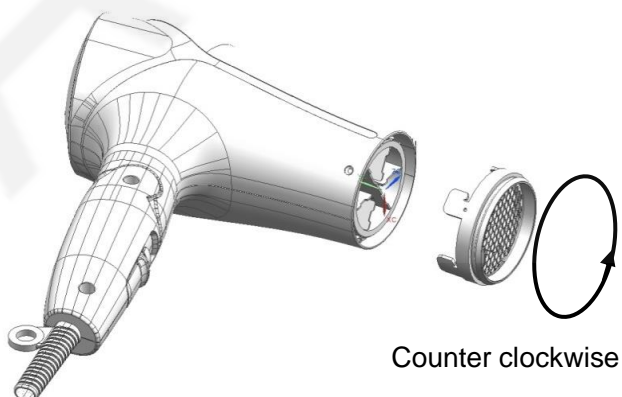

(6). Take off a MOTOR HEATER BLOCK ASS'Y method as below.

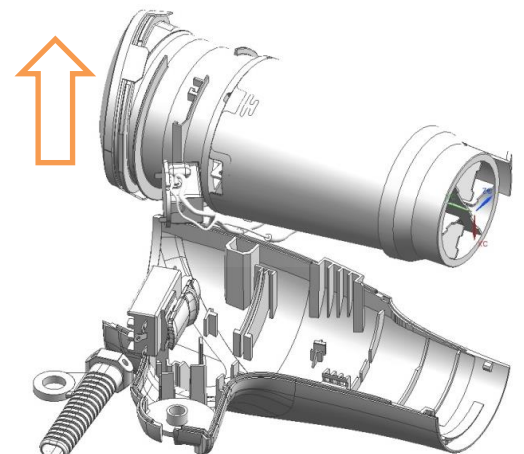

4.2 Assembly Instructions

(1) Install MOTOR HEATER ASSEMBLY into HOUSING A as below drawing.

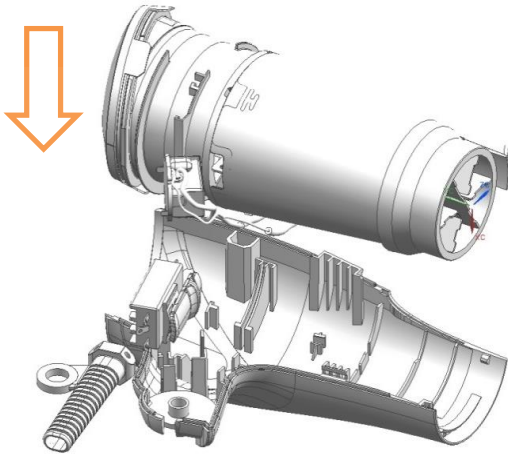

(4) Insert an AIR OUTLET GRILL into an AIR OUTLET RING by fix position as below.

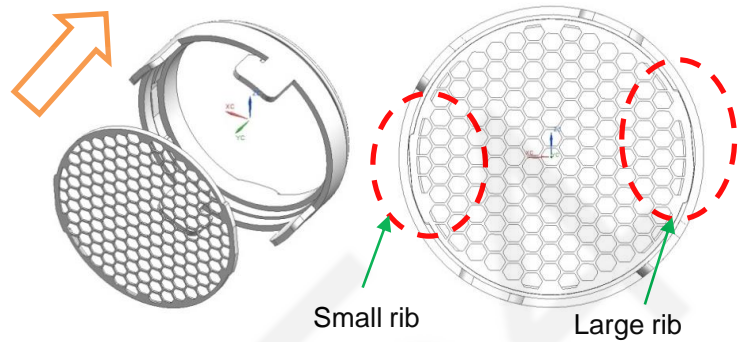

(2) Install HOUSING A method as below.

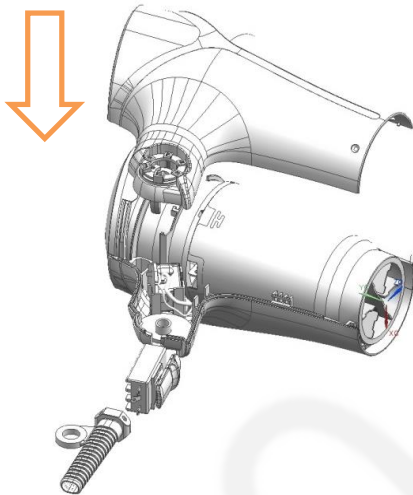

(5) Insert an AIR OUTLET RING into main body by fix position as below.

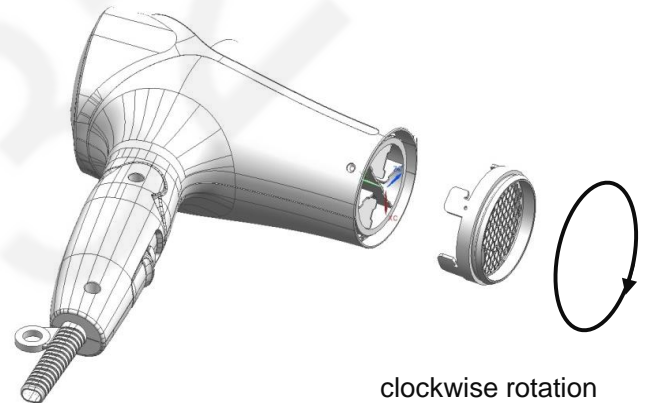

(3) Install SWIVEL RING on HANDLE A and install CLICK RING on HOUSING A then install HANDLE AB on HOUSING AB method as below.

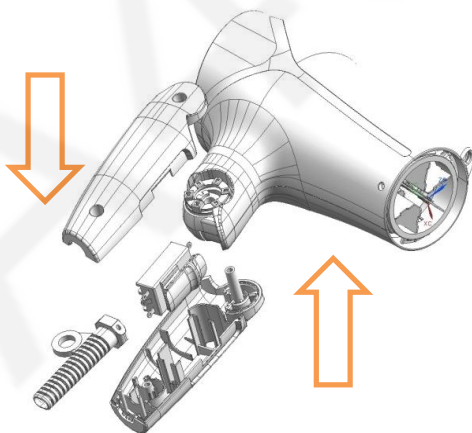

(6) Tightening screw both 2 TORX SCREWS and TAPPING SCREW as below.

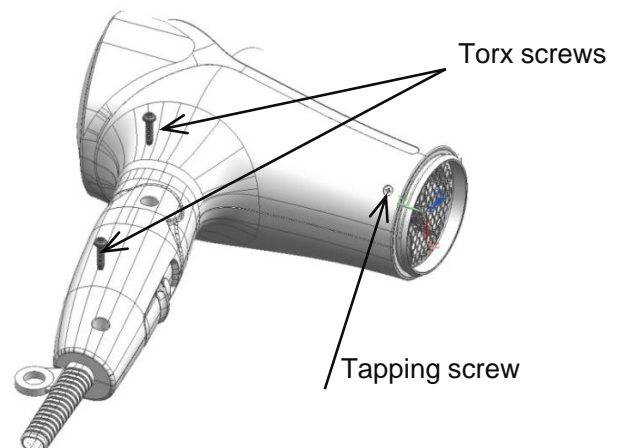

5. Wiring Connection Diagram

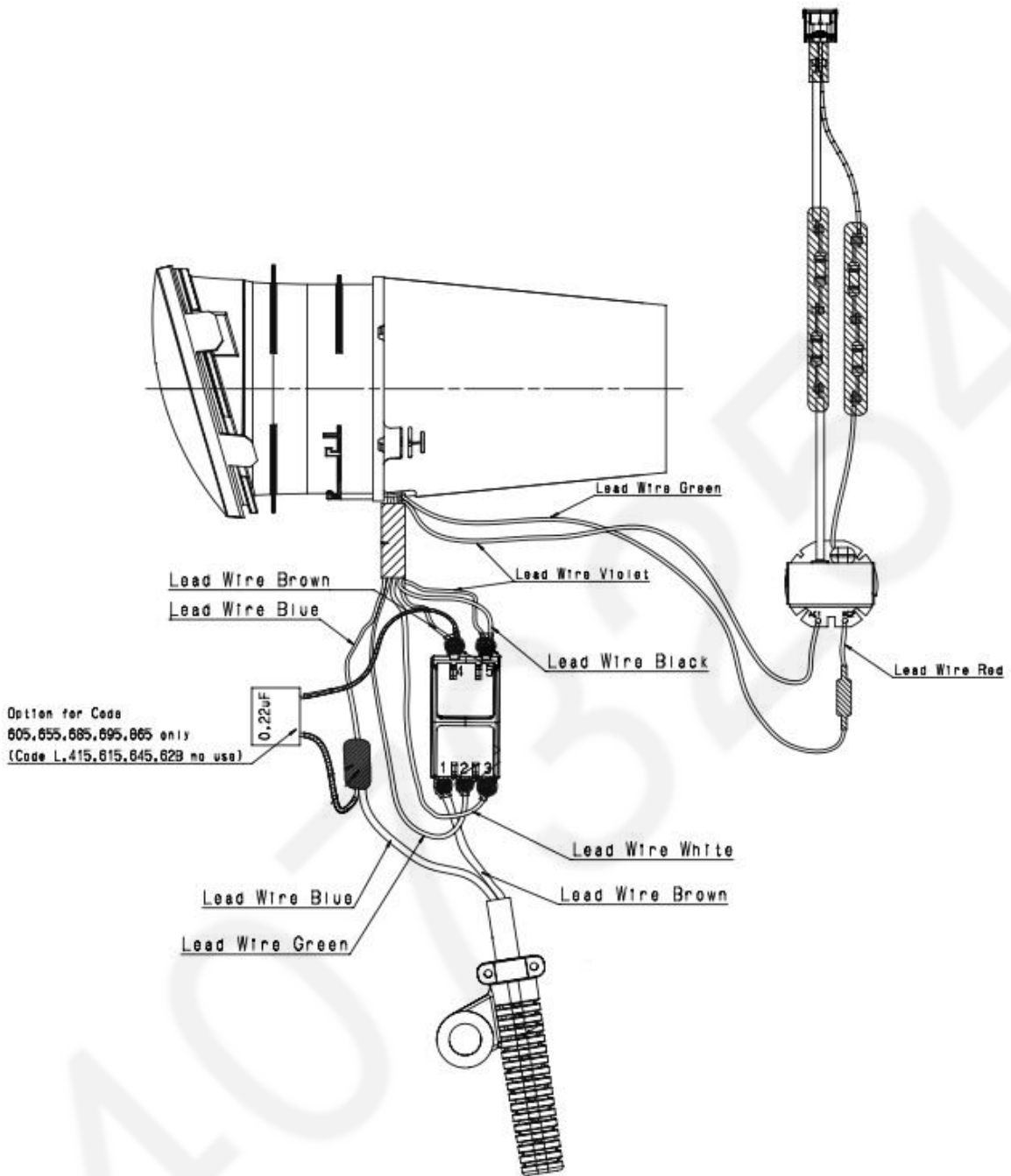

6. Schematic Diagram

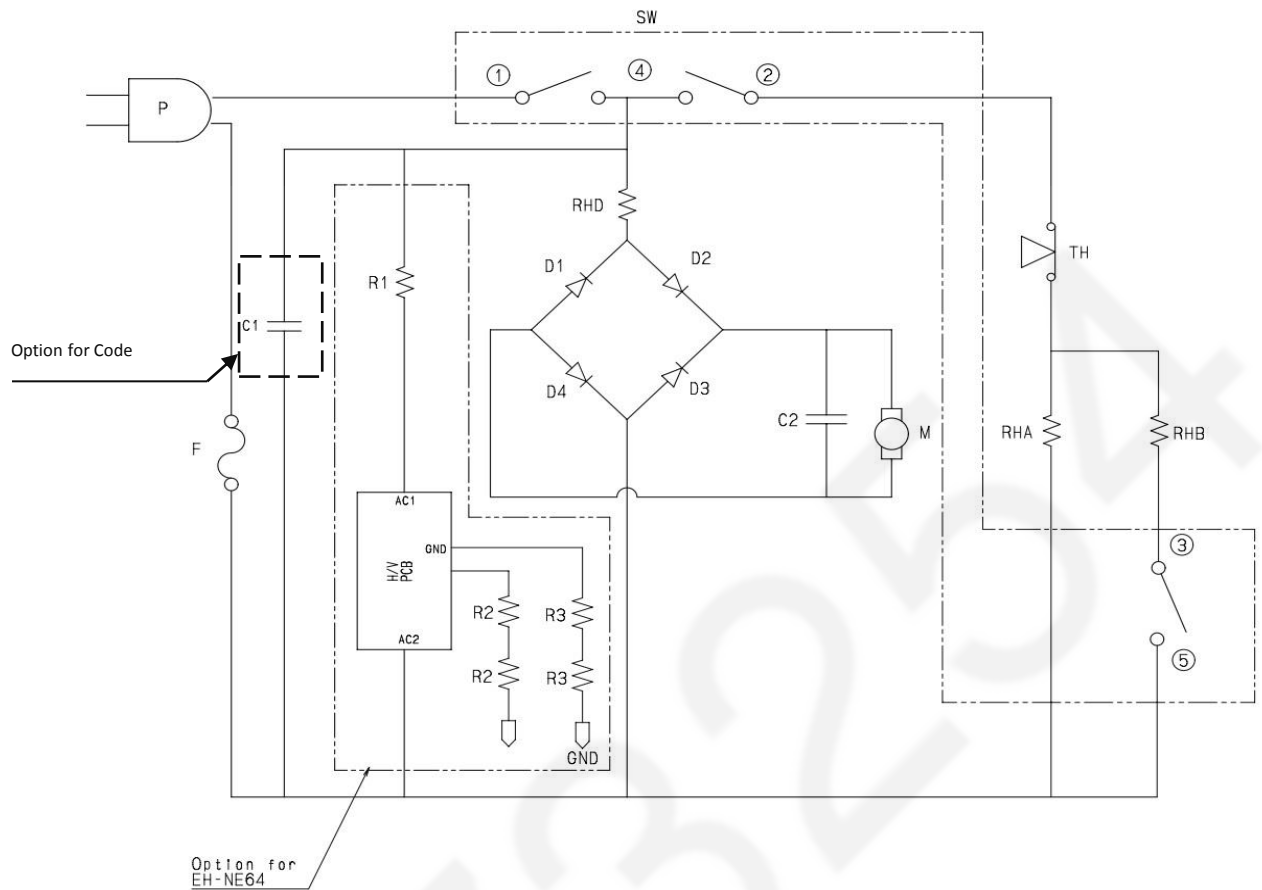

Main Sw.	1-4	2-4	3-5
Off "0"	X	X	X
Cool "1"	O	X	X
Heat Protection "2"	O	O	X
Turbo "3"	O	O	O

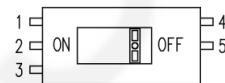

O = ON
X = OFF

Symbol	Part name	Specification	
		Code : 605/655/685/695/865	Code : L/415/615/645/62B
C1	CAPACITOR	0.22 μ F, 275V	NOT USE
C2	CAPACITOR (FOR MOTOR)	0.1 μ F, 50VDC	
D1, D2, D3, D4	DIODE (BRIDGE)	400V, 2A	
F	TEMPERATURE FUSE	133°C, 250V, 15A	
M	MOTOR	RS365SV-1988	
Main Sw.	MAIN SWITCH	AC 250V/15A	
TH	THERMO SWITCH	90 \pm 5 °C	
RHA	HEATER COIL A	77.5 \pm 2.35 Ω	
RHB	HEATER COIL B	77.5 \pm 2.35 Ω	
RHD	HEATER COIL D	115.0 \pm 3.5 Ω	
TH	THERMO SWITCH	90 \pm 5 °C	
R1	RESISTOR (R1)	27.0 k Ω	
R2	RESISTOR (R2)	3.3 M Ω	
R3	RESISTOR (R3)	1.0 M Ω	

7 EXPLODED VIEW & REPLACEMENT PARTS LIST

7.1. Exploded View for : EH-NE64

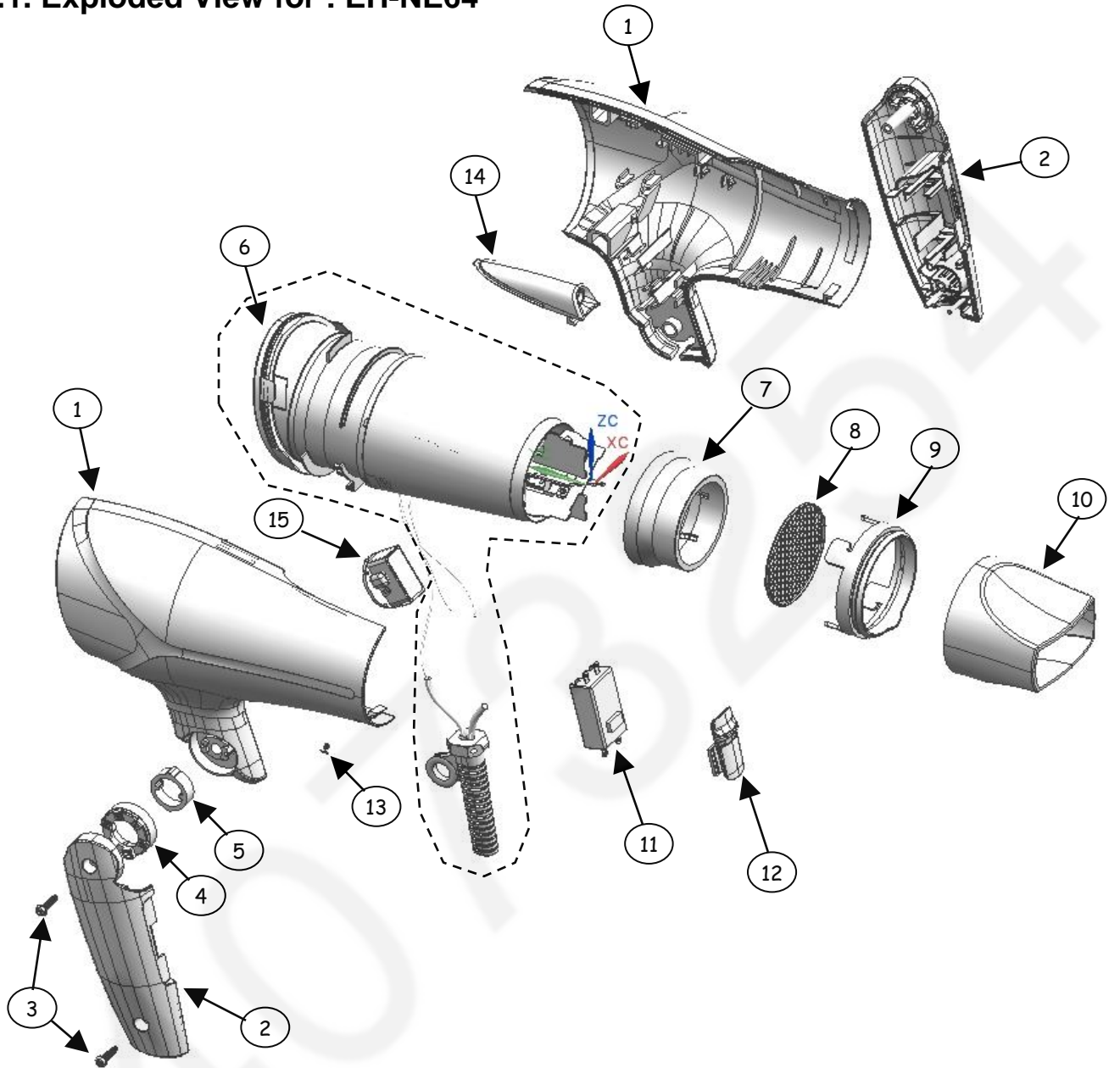

7.2 Parts List for EH-NE64

Safety	Ref. No.	Part No.	Part Name & Description	Q'ty	Remarks
	1	EHNE64HSBW	HOUSING AB (BLACK)	1	FOR OTHER
	1	EHNE64HS41BW	HOUSING AB (BLACK)	1	FOR -K415 : INDONESIA
	1	EHNE64HS64BW	HOUSING AB (BLACK)	1	FOR -K645 : VIETNAM
	1	EHNE64HS68BW	HOUSING AB (BLACK)	1	FOR -K685 : UAE
	1	EHNE64HS69BW	HOUSING AB (BLACK)	1	FOR -K695 : KUWAIT
	1	EHNE64HS86BW	HOUSING AB (BLACK)	1	FOR -K865 : RUSSIA
	2	EHNE64HDBW	HANDLE AB (BLACK)	1	
	3	EHNE64T3012W	TORX SCREW 3.0*12 (BLACK)	2	*1
	4	EHNE64CRTW	CLICK RING (WHITE)	1	
	5	EHNE64SRTW	SWIVEL RING (NATURAL)	1	
	6	EHNE64MHB2W	MOTOR HEATER BLOCK ASSEMBLY	1	PLUG B2, FOR -K415/-K615/-K645 : Include 5 Insulation Tubes
	6	EHNE64MHS3W	MOTOR HEATER BLOCK ASSEMBLY	1	PLUG S3, FOR -K605/-K655/-K685/-K695 : Include 5 Insulation Tubes
	6	EHNE64MH86W	MOTOR HEATER BLOCK ASSEMBLY	1	PLUG B2, FOR -K865 : Include 5 Insulation Tubes
	7	EHNE64AORHW	AIR OUTLET REGULATOR (GRAY)	1	
	8	EHNE64AOGW	AIR OUTLET GRILL (BLACK)	1	
	9	EHNE64AORW	AIR OUTLET RING (CLEAR)	1	
	10	EHNE64SNZBW	SET NOZZLE (BLACK)	1	
	11	EHNE64MSW	MAIN SWITCH	1	Include 5 Insulation Tubes
	12	EHNE64MSPBW	MAIN SWITCH PLATE (BLACK)	1	
	13	EHNE64T2004W	TAPPING SCREW 2.0*4 (BLACK)	1	
	14	EHNE64DCBW	DISCHARGE COVER (BLACK)	1	
	15	EHNE64DCAW	DISCHARGE CIRCUIT ASSEMBLY	1	
	-	EHNE6422S03W	OPERATING INSRUCTIONS	1	FOR -K605 : HONG KONG
	-	EHNE6441S03W	OPERATING INSRUCTIONS	1	FOR -K415/-K645/-K655 : INDONESIA/ VIETNAM/ MALAYSIA
	-	EHNE6468S03W	OPERATING INSRUCTIONS	1	FOR -K615/-K685/-K695 : UAE/ KUWAIT
	-	EHNE6486S03W	OPERATING INSRUCTIONS	1	FOR -K865 : RUSSIA
	-	EHNE64S415KW	INDIVIDUAL PACKAGE ASSEMBLY	1	FOR -K415/-K645 : INDONESIA/ MALAYSIA
	-	EHNE64S615KW	INDIVIDUAL PACKAGE ASSEMBLY	1	FOR -K605/-K615 : HONG KONG/ UAE
	-	EHNE64S655KW	INDIVIDUAL PACKAGE ASSEMBLY	1	FOR -K655 : MALAYSIA
	-	EHNE64S685KW	INDIVIDUAL PACKAGE ASSEMBLY	1	FOR -K685 : UAE
	-	EHNE64S695KW	INDIVIDUAL PACKAGE ASSEMBLY	1	FOR -K695 : KUWAIT
	-	EHNE64S865KW	INDIVIDUAL PACKAGE ASSEMBLY	1	FOR -K865 : RUSSIA

Remarks : *1 Individual Available