

Service Manual

(Household) Hair Dryer

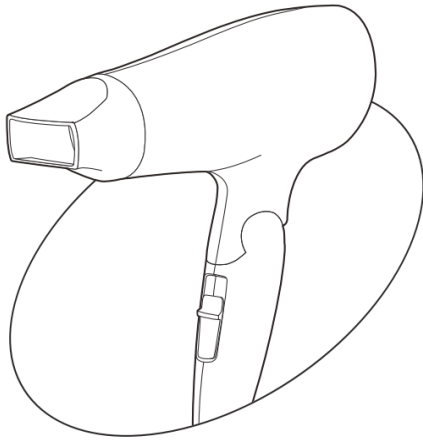

Model No. EH-ND64

**Asia
CIS**

⚠ WARNING

This service information is designed for experienced repair technicians only and is not designed for use by the general public. It does not contain warnings or cautions to advise non-technical individuals of potential dangers in attempting to service a product. Products powered by electricity should be serviced or repaired only by experienced professional technicians. Any attempt to service or repair the product or products dealt with in this service information by anyone else could result in serious injury or death.

IMPORTANT SAFETY NOTICE

There are special components used in this equipment which are important for safety. These parts are marked by ⚠ in the Schematic Diagrams, Circuit Board Diagrams, Exploded Views and Replacement Parts List. It is essential that these critical parts should be replaced with manufacturer's specified parts to prevent shock, fire or other hazards. Do not modify the original design without permission of manufacturer.

TABLE OF CONTENTS

	PAGE		PAGE
1 Warning	2	7 Exploded View & Replacement Parts List --	8
2 Specifications	2	7.1. Exploded View for EH-ND64	8
3 Troubleshooting Guide	3	7.2. Parts List for EH-ND64	9
4 Disassembly and Assembly Instructions -	4		
4.1. Disassembly instruction.....	4		
4.2. Assembly Instructions.....	5		
5 Wiring Connection Diagram.....	6		
6 Schematic Diagram	7		

Panasonic

© Panasonic Corporation 2014 Unauthorized copying and distribution is a violation of law.

1. Warning

Caution:

- Pb free solder has a higher melting point than standard solder; Typically the melting point is 50 - 70°F (30 - 40°C) higher. Please use a soldering iron with temperature control and adjust it to 750 ±20°F (400 ± 10 °C). In case of using high temperature soldering iron, please be careful not to heat too long.
- Pb free solder will tend to splash when heated too high (about 1100°F / 600°C).

2. Specifications

Power source	AC 220-240 V 50-60 Hz
Power consumption	Approx. "3" Turbo 220 V ~ 1700 W 230 V ~ 1850 W 240 V ~ 2000 W
Air volume without nozzle	1.45 m ³ /min
Air flow temperature ("3" Turbo)	90 K (in case of room temperature 30°C)
Dimensions	(W) 77 x (D) 157 x (H) 210 mm
Cord length	L = 1.7 m
Weight	Approx. 350 g (Without cord and Without Nozzle)
Supplied accessory	EH-ND64 Set nozzle

3 TROUBLESHOOTING GUIDE

Refer to WIRING CONNECTION DIAGRAM.

< TROUBLE >

< CHECK >

< REMEDY >

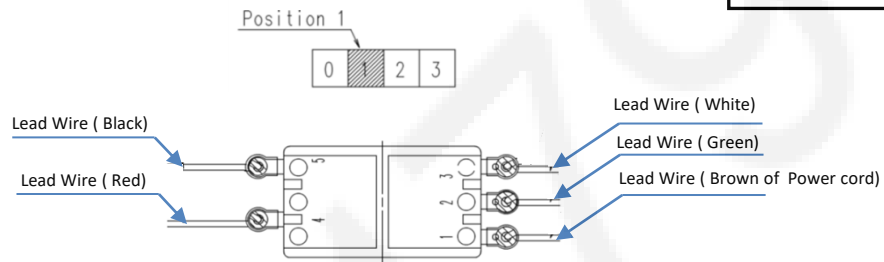
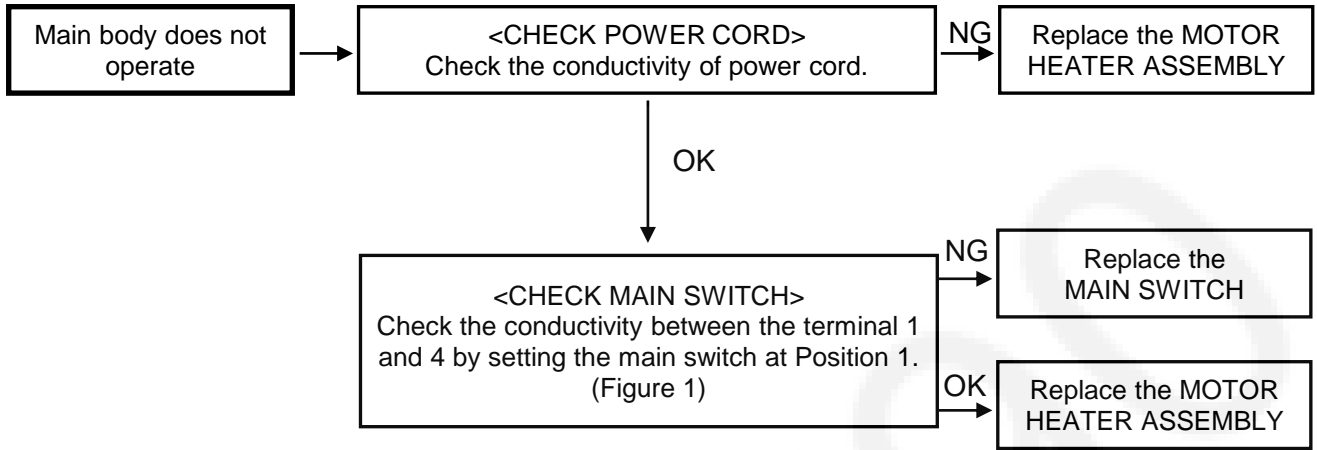

Figure 1

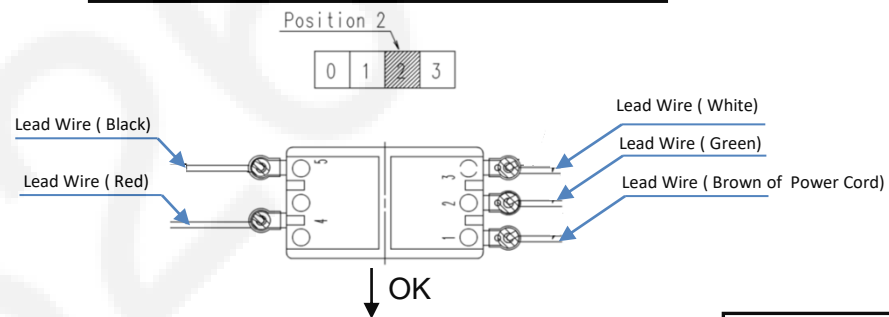
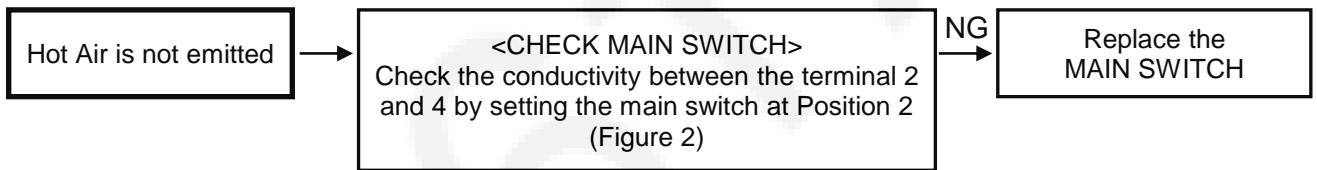

Figure 2

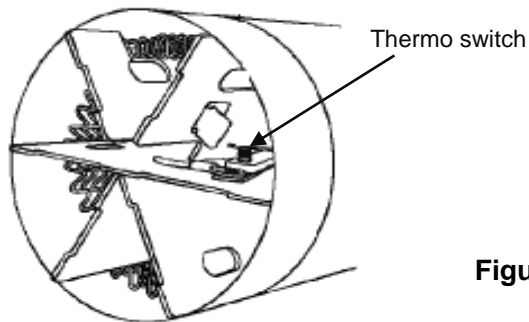
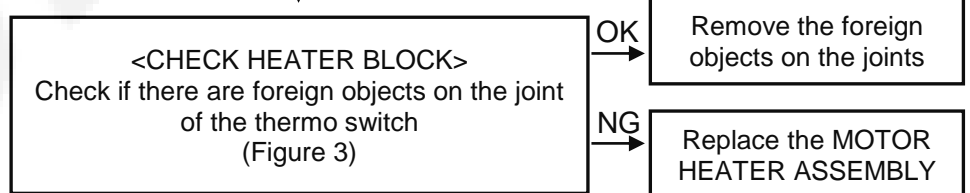
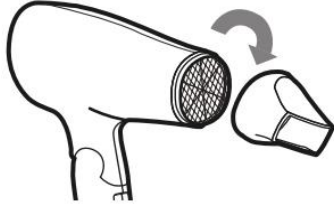

Figure 3

4. Disassembly and Assembly Instructions

4.1. Disassembly Instructions

- (1) Take off **NOZZLE**
as same direction as below.



- (4). Take off **HANDLE AB** then take out **CLICK RING** and **SWIVEL RING**
method as below.

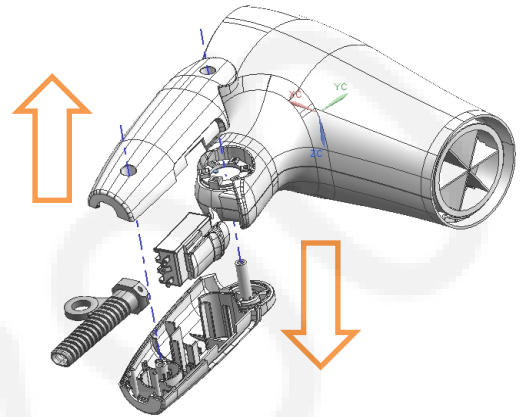

- (2). Remove two **TAPPING SCREWS** at **HOUSING A**
by flat-blade screwdriver and two **TORX SCREWS**
at **HANDLE** by Driver.

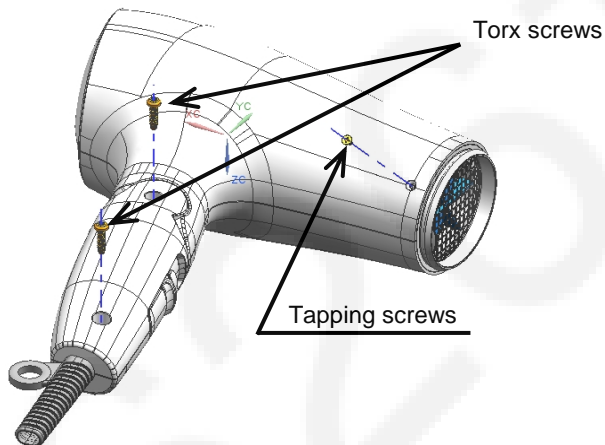

- (5). Take off **HOUSING A** method as below.

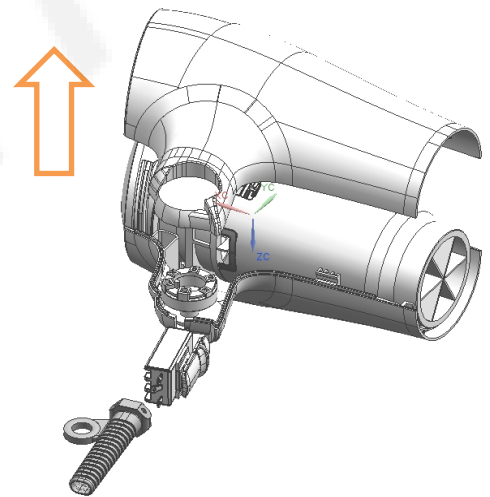

- (3) Take off an **AIR OUTLET GRILL**
and an **AIR OUTLET RING**
by rotating method as below.

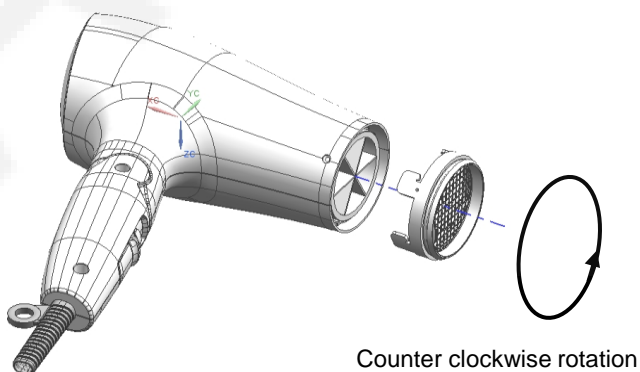

- (6). Take off a **MOTOR HEATER ASSEMBLY**
method as below.

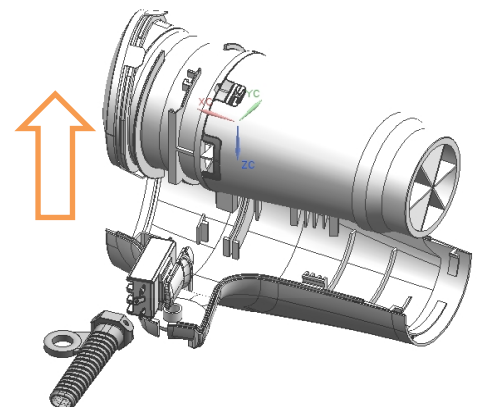

4.2 Assembly Instructions

(1) Install **MOTOR HEATER ASSEMBLY** into **HOUSING A** as below drawing.

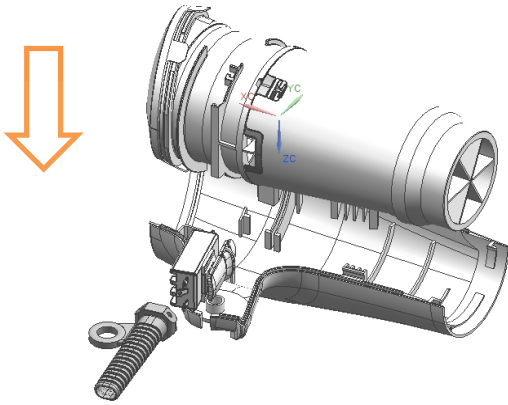

(4) Insert an **AIR OUTLET GRILL** into an **AIR OUTLET RING** by fix position as below.

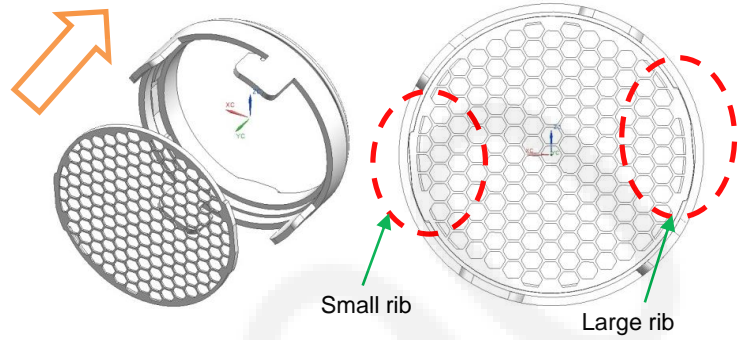

(2) Install **HOUSING A** method as below.

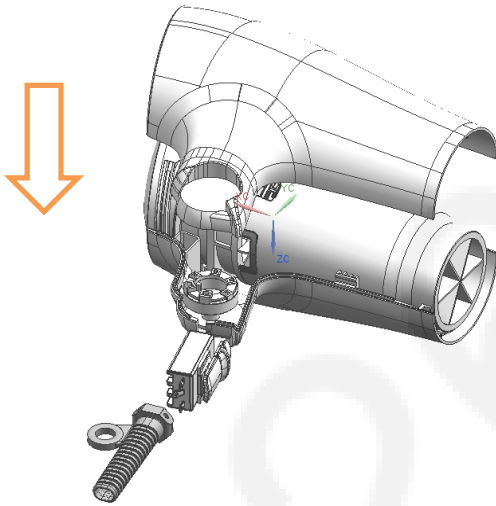

(5) Insert an **AIR OUTLET RING** into main body by fix position as below.

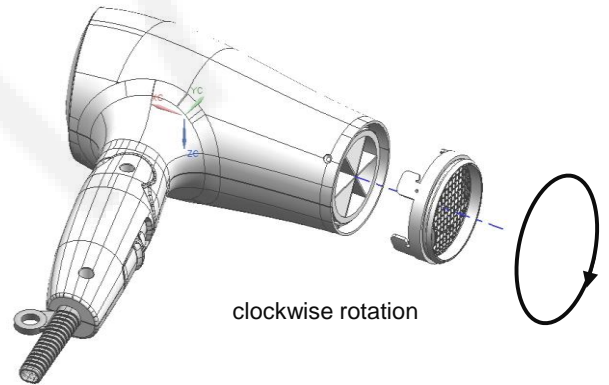

(3) Install **SWIVEL RING** on **HANDLE A** and install **CLICK RING** on **HOUSING A** then install **HANDLE AB** on **HOUSING AB** method as below.

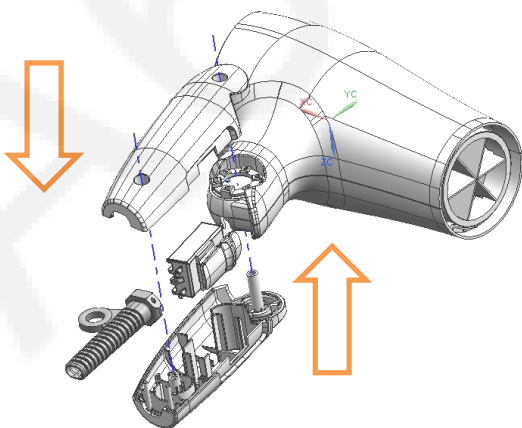

(6) Tightening screw both two **TORX SCREWS** and two **TAPPING SCREWS** as below.

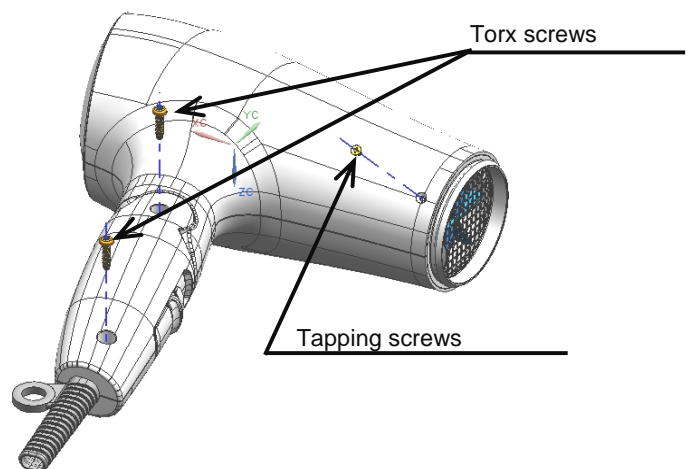

5. Wiring Connection Diagram

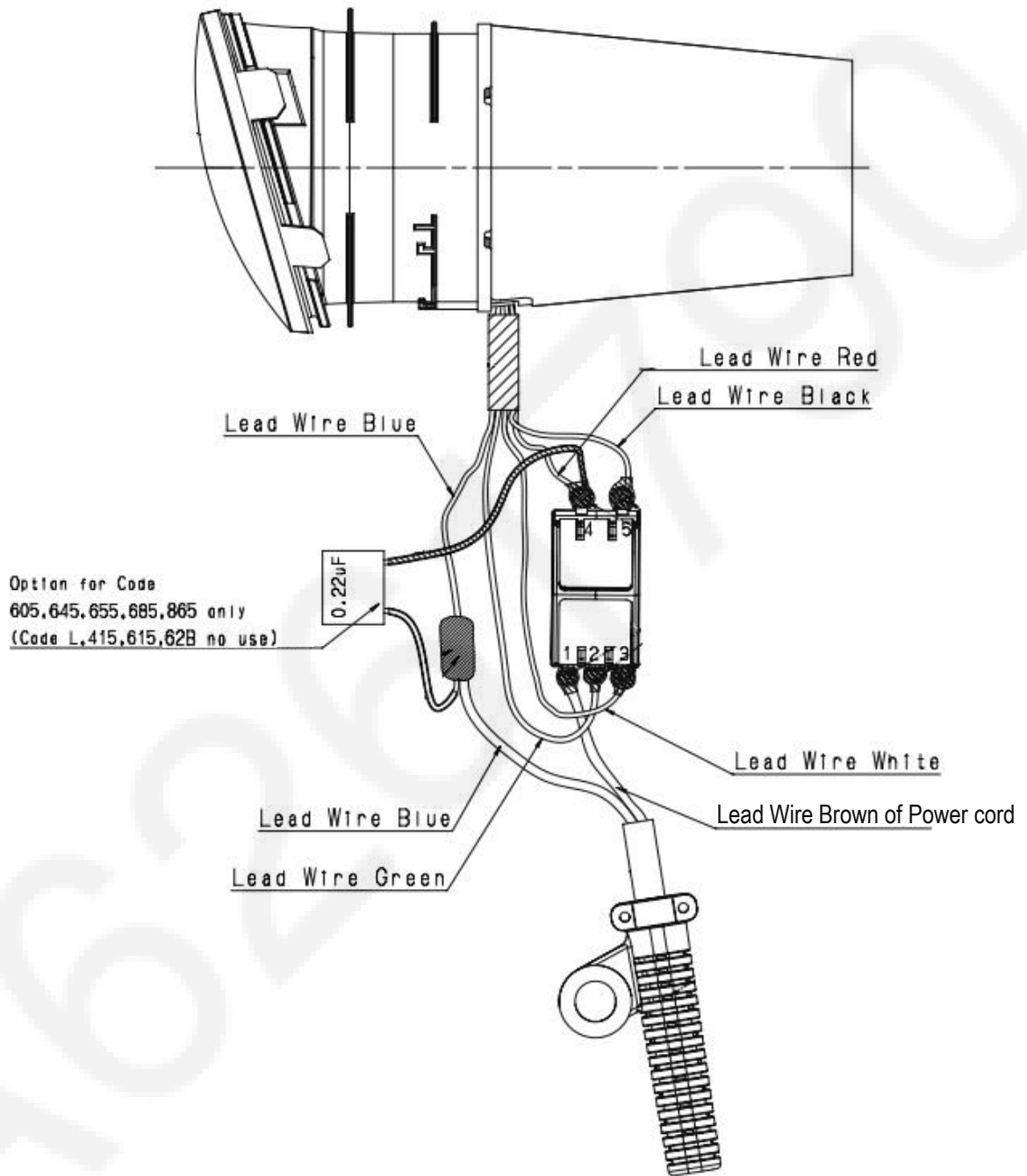

6. Schematic Diagram

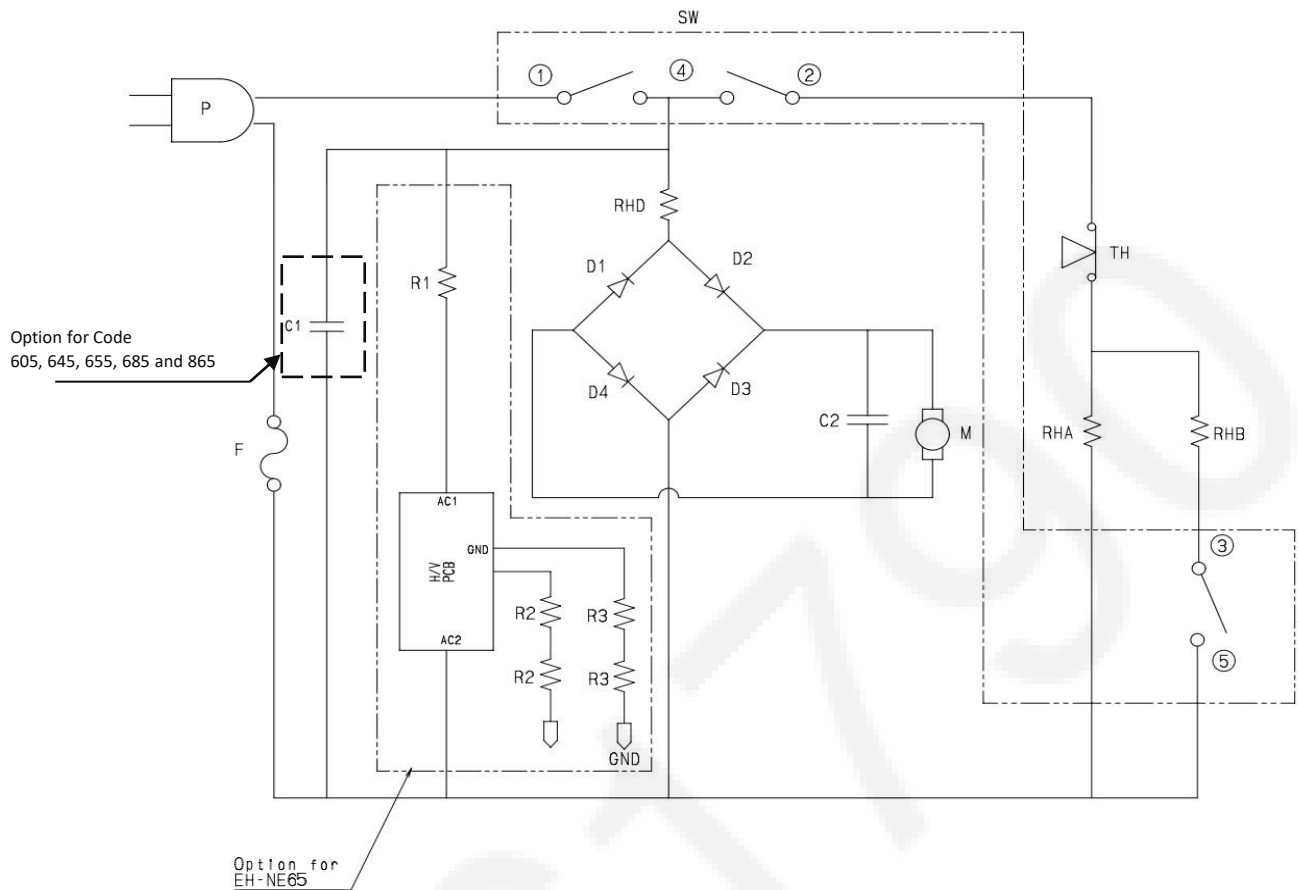

Main Sw.	1-4	2-4	3-5
Off "0"	X	X	X
Cool "1"	O	X	X
Heat Protection "2"	O	O	X
Turbo "3"	O	O	O

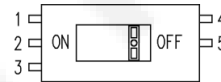

O = ON
X = OFF

Symbol	Part name	Specification	
		Code : 605/645/655/685/865	Code : L/415/615/62B
C1	CAPACITOR	0.22 μ F, 275V	NOT USE
C2	CAPACITOR (FOR MOTOR)	0.1 μ F, 50VDC	
D1, D2, D3, D4	DIODE (BRIDGE)	400V, 2A	
F	TEMPERATURE FUSE	133°C, 250V, 15A	
M	MOTOR	RS365SV-1988	
Main Sw.	MAIN SWITCH	AC 250V/15A	
TH	THERMO SWITCH	90 \pm 5 °C	
RHA	HEATER COIL A	77.5 \pm 2.35 Ω	
RHB	HEATER COIL B	77.5 \pm 2.35 Ω	
RHD	HEATER COIL D	115.0 \pm 3.5 Ω	
TH	THERMO SWITCH	90 \pm 5 °C	
R1	RESISTOR (R1)	27.0 k Ω	
R2	RESISTOR (R2)	3.3 M Ω	
R3	RESISTOR (R3)	1.0 M Ω	

7 EXPLODED VIEW & REPLACEMENT PARTS LIST

7.1. Exploded View for : EH-ND64

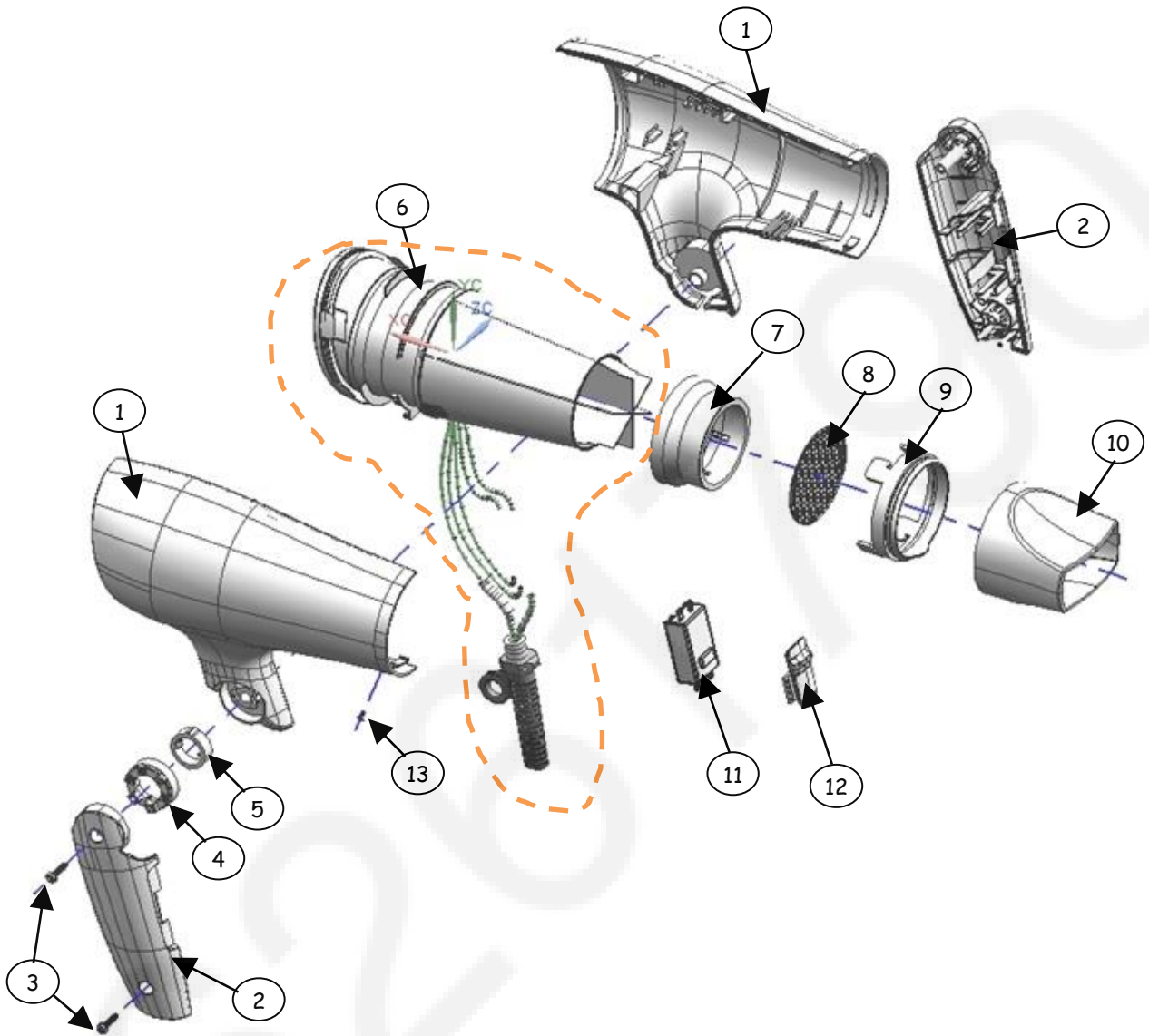

All parts are supplied from PMFTH-AP through PLAP

7.2 Parts List for EH-ND64

Safety	Ref. No.	Part No.	Part Name & Description	Q'ty	Remarks
	1	EHND64HSPW	HOUSING AB ASSEMBLY	1	For -P605/-P615/-P62B/-P655 : HK,SG/AE_(Re-Ex)/IN/MY
	1	EHND64HS41PW	HOUSING AB ASSEMBLY	1	For -P415 : ID
	1	EHND64HS64PW	HOUSING AB ASSEMBLY	1	For -P645 : VN
	1	EHND64HS68PW	HOUSING AB ASSEMBLY	1	For -P685 : AE,KW,QA
	1	EHND64HS86PW	HOUSING AB ASSEMBLY	1	For -P865 : RU
	2	EHND64HDPW	HANDLE AB (ROUGE PINK)	1	
	3	EHND64T3012W	TORX SCREW 3.0*12 (BLACK)	2	*1
	4	EHND64CRTW	CLICK RING (WHITE)	1	
	5	EHND64SRTW	SWIVEL RING (NATURAL)	1	
	6	EHND64MHB2W	MOTOR HEATER ASSEMBLY	1	For -P415/-P615/-P62B : ID/AE_(Re-Ex)/IN
	6	EHND64MHS3W	MOTOR HEATER ASSEMBLY	1	For -P605/-P655/-P685 : HK,SG/MY/AE,KW,QA
	6	EHND64MH86W	MOTOR HEATER ASSEMBLY	1	For -P645/-P865 : VN/RU
	7	EHND64AORHW	AIR OUTLET REGULATOR (GRAY)	1	
	8	EHND64AOGW	AIR OUTLET GRILL (BLACK)	1	
	9	EHND64AORW	AIR OUTLET RING (CLEAR)	1	
	10	EHND64NZPW	NOZZLE (ROUGE PINK)	1	
	11	EHND64MSW	MAIN SWITCH (SET TUBE L=10mm.*5P)	1	
	12	EHND64MSPPW	MAIN SWITCH PLATE (ROUGE PINK)	1	
	13	EHND64T2004W	TAPPING SCREW 2.0*4 (BLACK)	1	
	-	EHND64S03W	OPERATING INSTRUCTIONS	1	For -P415/-P62B/-P645/-P655 : ID/IN/VN/MY
	-	EHND6460503W	OPERATING INSTRUCTIONS WITH CAUTION	1	For -P605 : HK,SG
	-	EHND6461503W	OPERATING INSTRUCTIONS	1	For -P615 : AE (Re-Ex)
	-	EHND6468503W	OPERATING INSTRUCTIONS WITH STICKER	1	For -P685 : AE,KW,QA
	-	EHND6486503W	OPERATING INSTRUCTIONS	1	For -P865 : RU
	--	EHND64S415PW	INDIVIDUAL PACKAGE WITH STICKER	1	For -P415 : ID
	--	EHND64S605PW	INDIVIDUAL PACKAGE WITH STICKER	1	For -P605 : HK,SG
	--	EHND64S615PW	INDIVIDUAL PACKAGE WITH STICKER	1	For -P615 : AE (Re-Ex)
	--	EHND64S62BPW	INDIVIDUAL PACKAGE WITH STICKER	1	For -P62B : IN
	--	EHND64S645PW	INDIVIDUAL PACKAGE WITH STICKER	1	For -P645 : VN
	--	EHND64S655PW	INDIVIDUAL PACKAGE WITH STICKER	1	For -P655 : MY
	--	EHND64S685PW	INDIVIDUAL PACKAGE WITH STICKER	1	For -P685 : AE,KW,QA
	--	EHND64S865PW	INDIVIDUAL PACKAGE WITH STICKER	1	For -P865 : RU
	--	EHND64S09W	FILLER FOR PACKAGE	1	
	---	EHND64S55W	POUCH FOAM	1	

Remarks : *1 Individual Available

All parts are supplied from PMFTH-AP through PLAP