

Service Manual

(Household) Hair Dryer

Model No. EH-ND63

Asia

CIS

Middle East

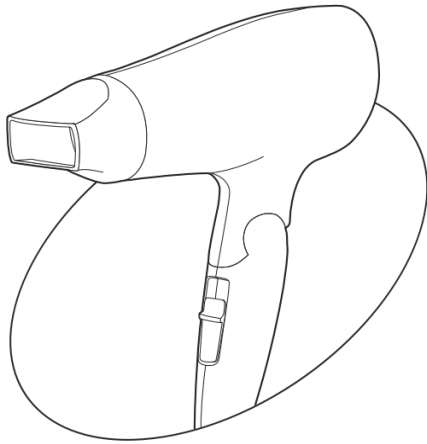

⚠ WARNING

This service information is designed for experienced repair technicians only and is not designed for use by the general public. It does not contain warnings or cautions to advise non-technical individuals of potential dangers in attempting to service a product. Products powered by electricity should be serviced or repaired only by experienced professional technicians. Any attempt to service or repair the product or products dealt with in this service information by anyone else could result in serious injury or death.

IMPORTANT SAFETY NOTICE

There are special components used in this equipment which are important for safety. These parts are marked by ⚠ in the Schematic Diagrams, Circuit Board Diagrams, Exploded Views and Replacement Parts List. It is essential that these critical parts should be replaced with manufacturer's specified parts to prevent shock, fire or other hazards. Do not modify the original design without permission of manufacturer.

TABLE OF CONTENTS

	PAGE
1 Warning	2
2 Specifications	2
3 Troubleshooting Guide	3
4 Disassembly and Assembly Instructions	4
4.1 Disassembly instruction.....	4
4.2 Assembly Instructions.....	5
5 Wiring Connection Diagram.....	6
6 Schematic Diagram	7
7 Exploded View & Replacement Parts List	8
7.1 Exploded View for EH-ND63	8
7.2 Parts List for EH-ND63	9

Panasonic

© Panasonic Corporation 2016 Unauthorized copying and distribution is a violation of law.

1. Warning

Caution:

- Pb free solder has a higher melting point than standard solder; Typically the melting point is 50 - 70°F (30 - 40°C) higher. Please use a soldering iron with temperature control and adjust it to 750 ±20°F (400 ± 10 °C). In case of using high temperature soldering iron, please be careful not to heat too long.

- Pb free solder will tend to splash when heated too high (about 1100°F / 600°C).

2. Specifications

Power source	AC 220-240 V 50-60 Hz
Power consumption	Approx. "3" Turbo 220 V ~ 1700 W 230 V ~ 1850 W 240 V ~ 2000 W
Air volume without nozzle	1.45 m ³ /min
Air flow temperature ("3" Turbo)	90 K (in case of room temperature 30°C)
Dimensions	(W) 80 x (D) 170 x (H) 260 mm
Cord length	L = 1.7 m
Weight	Approx. 350 g (Without cord and Without Nozzle)

Supplied accessory	EH-ND63	Set nozzle
--------------------	---------	------------

3 TROUBLESHOOTING GUIDE

Refer to WIRING CONNECTION DIAGRAM.

< TROUBLE >

< CHECK >

< REMEDY >

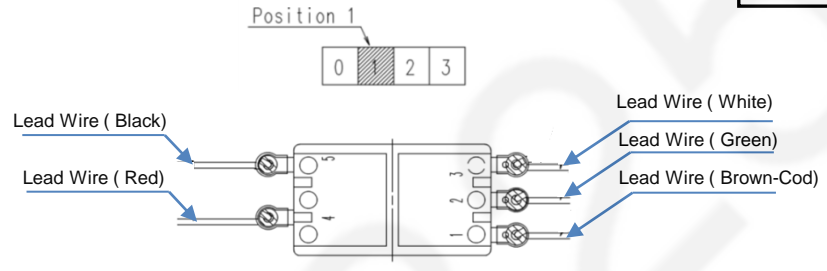
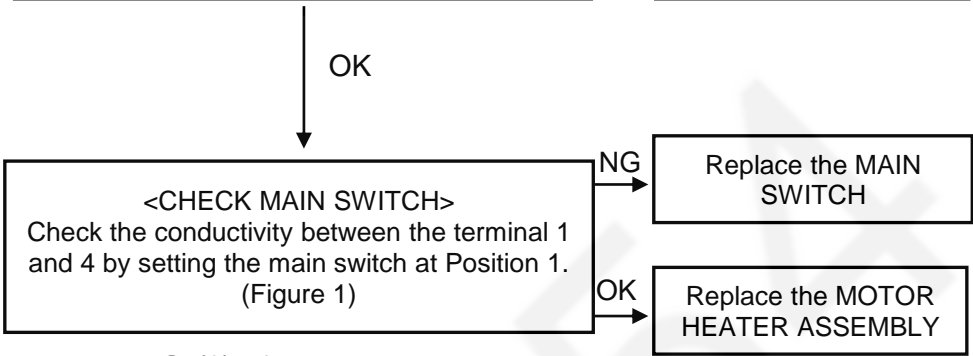

Figure 1

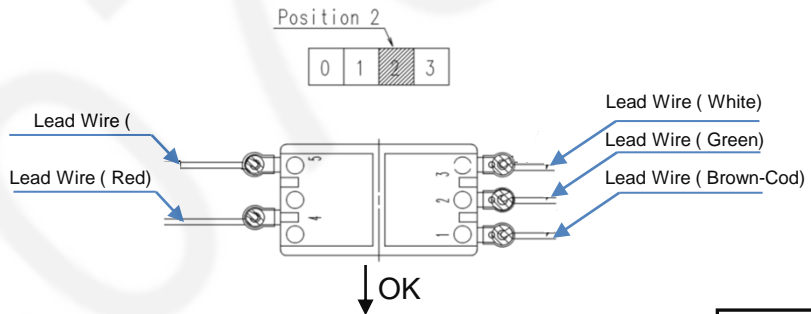
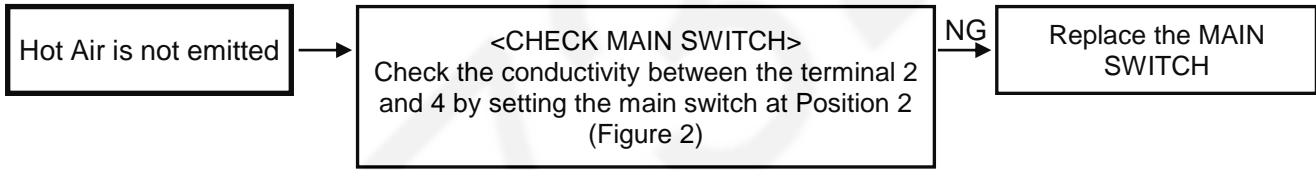

Figure 2

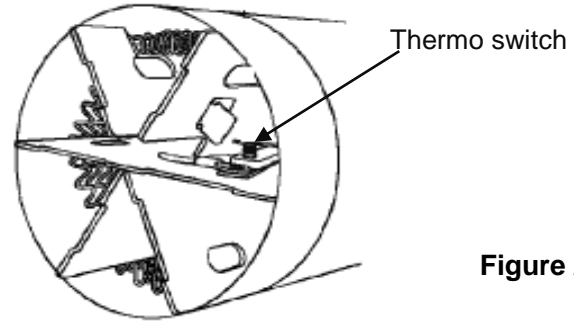
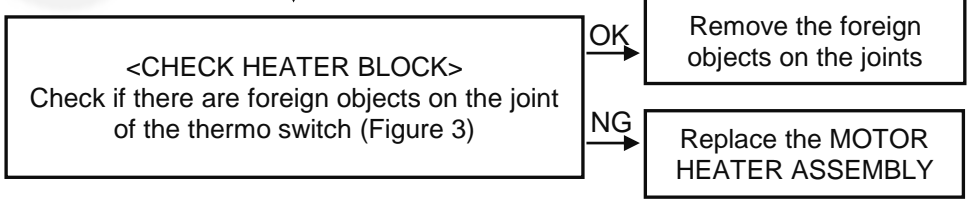
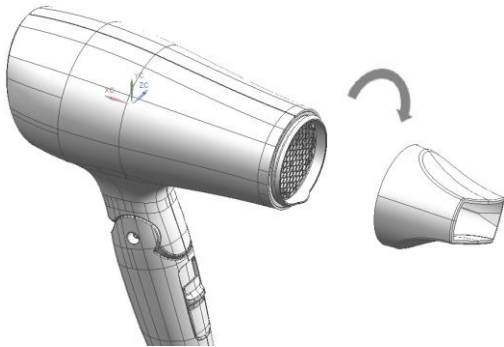

Figure 2

4. Disassembly and Assembly Instructions

4.1. Disassembly Instructions

(1) Take off NOZZLE as same direction as below.



(4). Take off HANDLE AB then take out CLICK RING and SWIVEL RING method as below.

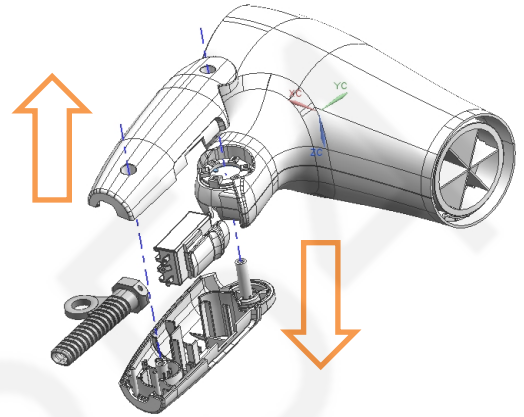

(2). Remove 2 TAPPING SCREWS at HOUSING A by flat-blade screwdriver and 2 TORX SCREWS at HANDLE by Driver.

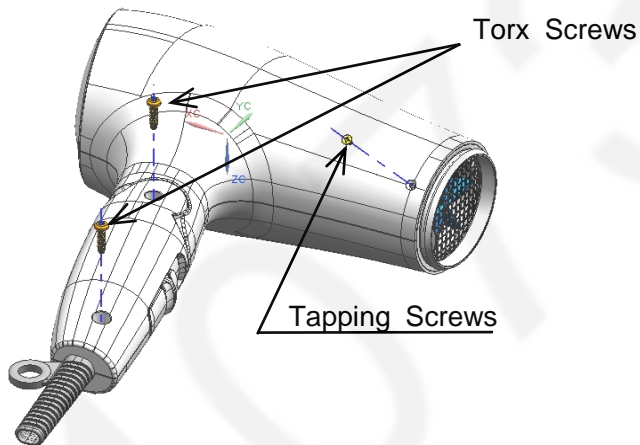

(5). Take off HOUSING A method as below.

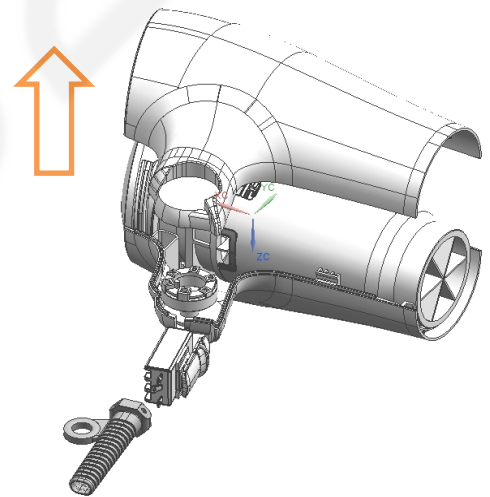

(3) Take off an AIR OUTLET GRILL and an AIR OUTLET RING by rotating method as below.

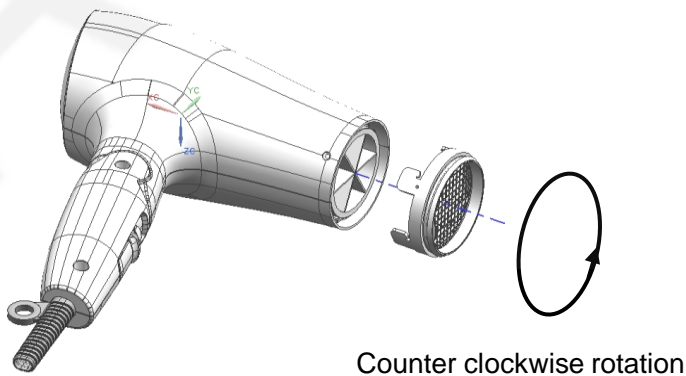

(6). Take off a MOTOR HEATER ASSEMBLY method as below.

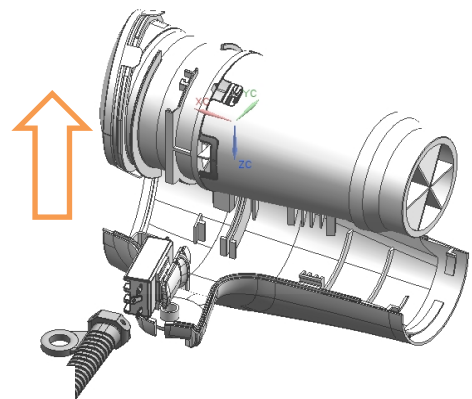

4.2 Assembly Instructions

(1) Install MOTOR HEATER ASSEMBLY into HOUSING A as below drawing.

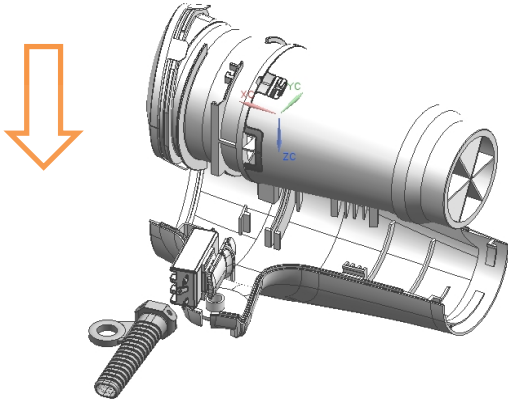

(4) Insert an AIR OUTLET GRILL into an AIR OUTLET RING by fix position as below.

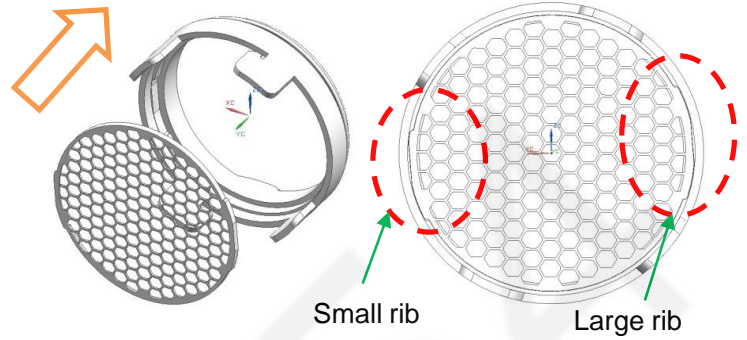

(2) Install HOUSING A method as below.

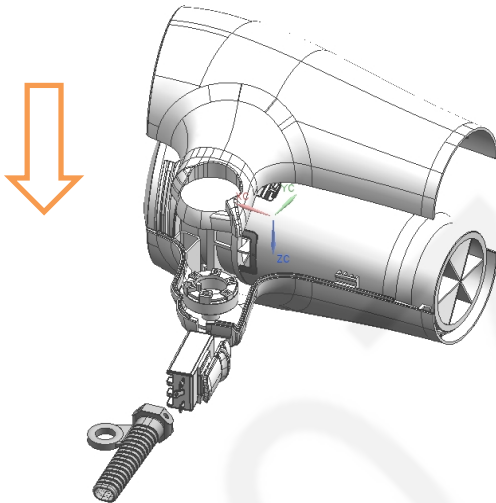

(5) Insert an AIR OUTLET RING into Main Body by fix position as below.

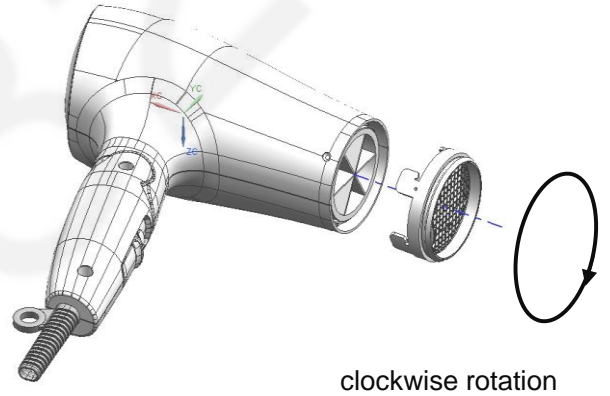

(3) Install SWIVEL RING on HANDLE A and install CLICK RING on HOUSING A then install HANDLE AB on HOUSING AB method as below.

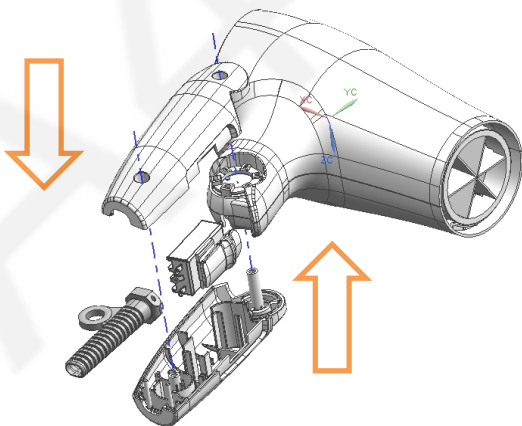

(6) Tightening screw both 2 TORX SCREWS and TAPPING SCREWS as below.

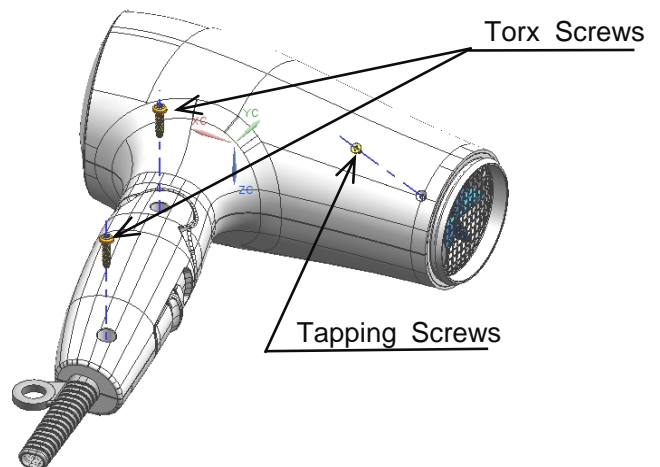

5. Wiring Connection Diagram

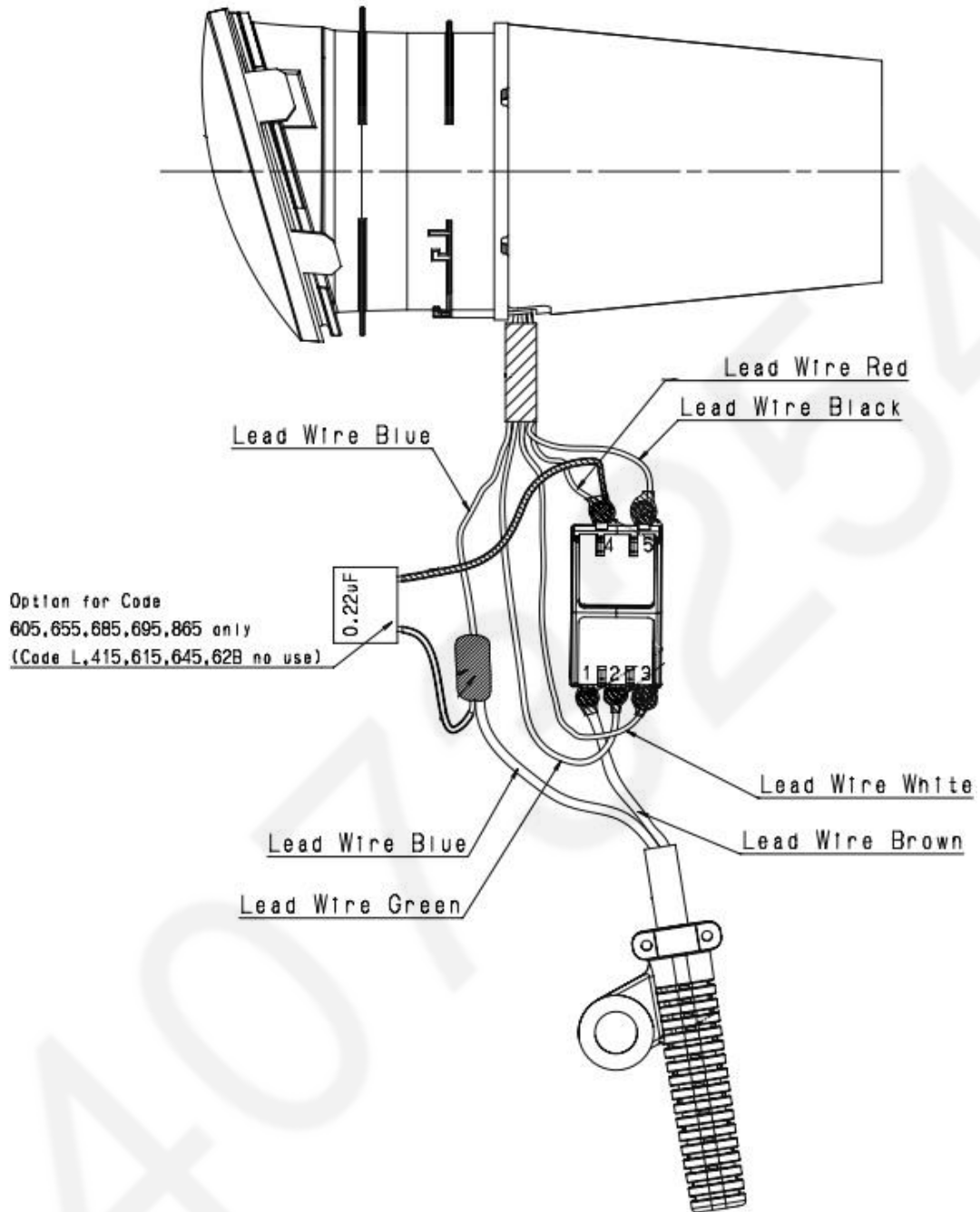

6. Schematic Diagram

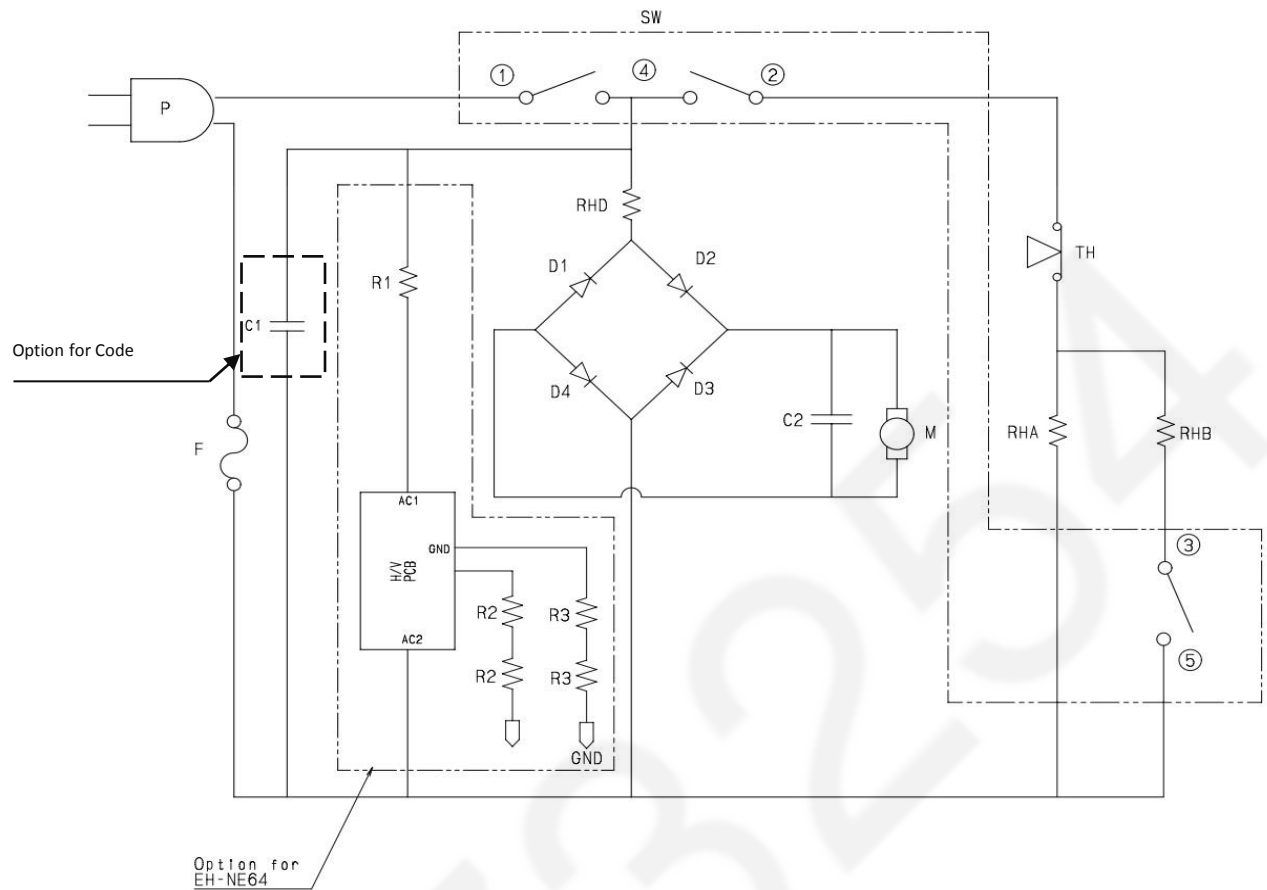

Main Sw.	1-4	2-4	3-5
Off "0"	X	X	X
Cool "1"	O	X	X
Heat Protection "2"	O	O	X
Turbo "3"	O	O	O



O = ON
X = OFF

Symbol	Part name	Specification	
		Code : 605/655/685/695/865	Code : L/415/615/645/62B
C1	CAPACITOR	0.22 μ F, 275V	NOT USE
C2	CAPACITOR (FOR MOTOR)	0.1 μ F, 50VDC	
D1, D2, D3, D4	DIODE (BRIDGE)	400V, 2A	
F	TEMPERATURE FUSE	133°C, 250V, 15A	
M	MOTOR	RS365SV-1988	
Main Sw.	MAIN SWITCH	AC 250V/15A	
TH	THERMO SWITCH	90 \pm 5 °C	
RHA	HEATER COIL A	77.5 \pm 2.35 Ω	
RHB	HEATER COIL B	77.5 \pm 2.35 Ω	
RHD	HEATER COIL D	115.0 \pm 3.5 Ω	
TH	THERMO SWITCH	90 \pm 5 °C	
R1	RESISTOR (R1)	27.0 k Ω	
R2	RESISTOR (R2)	3.3 M Ω	
R3	RESISTOR (R3)	1.0 M Ω	

7 EXPLODED VIEW & REPLACEMENT PARTS LIST

7.1. Exploded View for : EH-ND63

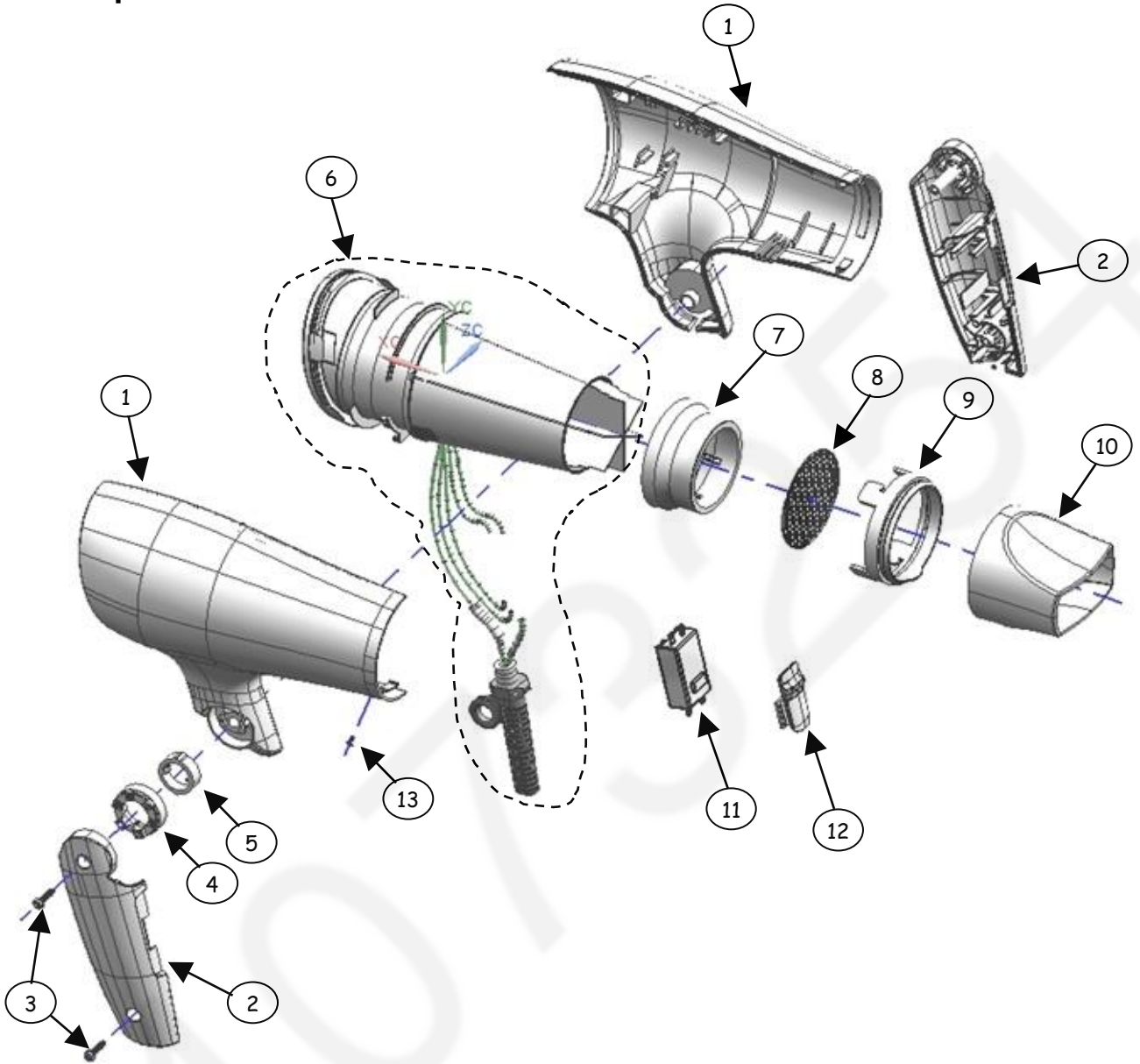

7.2 Parts List for EH-ND63

Safety	Ref. No.	Part No.	Part Name & Description	Q'ty	Remarks
	1	EHND63HSPW	HOUSING AB (ROUGE PINK)	1	FOR OTHER
	1	EHND63HS41PW	HOUSING AB (ROUGE PINK)	1	FOR -P415 : INDONESIA
	1	EHND63HS64PW	HOUSING AB (ROUGE PINK)	1	FOR -P645 : VIETNAM
	1	EHND63HS68PW	HOUSING AB (ROUGE PINK)	1	FOR -P685 : UAE
	1	EHND63HS69PW	HOUSING AB (ROUGE PINK)	1	FOR -P695 : KUWAIT
	1	EHND63HS86PW	HOUSING AB (ROUGE PINK)	1	FOR -P865 : RUSSIA
	2	EHND63HDPW	HANDLE AB (ROUGE PINK)	1	
	3	EHND63T3012W	TORX SCREW 3.0*12 (BLACK)	2	
	4	EHND63CRTW	CLICK RING (WHITE)	1	
	5	EHND63SRTW	SWIVEL RING (NATURAL)	1	
	6	EHND63MHB2W	MOTOR HEATER ASSEMBLY	1	PLUG B2, FOR -P415/-P615/-P62B/-P645 : Include 5 Insulation Tubes
	6	EHND63MHS3W	MOTOR HEATER ASSEMBLY	1	PLUG S3, FOR -P605/-P655/-P685/-P695 : Include 5 Insulation Tubes
	6	EHND63MH86W	MOTOR HEATER ASSEMBLY	1	PLUG B2, FOR -P865 : Include 5 Insulation Tubes
	7	EHND63AORHW	AIR OUTLET REGULATOR (GRAY)	1	
	8	EHND63AOGW	AIR OUTLET GRILL (BLACK)	1	
	9	EHND63AORW	AIR OUTLET RING (CLEAR)	1	
	10	EHND63SNZPW	SET NOZZLE (ROUGE PINK)	1	
	11	EHND63MSW	MAIN SWITCH	1	Include 5 Insulation Tubes
	12	EHND63MSPPW	MAIN SWITCH PLATE (ROUGE PINK)	1	
	13	EHND63T2004W	TAPPING SCREW 2.0*4 (BLACK)	1	
	-	EHND6322S03W	OPERATING INSTRUCTIONS	1	FOR -P605 : KONG KONG
	-	EHND6341S03W	OPERATING INSTRUCTIONS	1	FOR -P415/-P62B/-P645/-P655 : INDONESIA/ INDIA/ VIETNAM/ MALAYSIA
	-	EHND6368S03W	OPERATING INSTRUCTIONS	1	FOR -P615/-P685/-P695 : UAE/ KUWAIT
	-	EHND6386S03W	OPERATING INSTRUCTIONS	1	FOR -P865 : RUSSIA
	-	EHND63S415PW	INDIVIDUAL PACKAGE ASSEMBLY	1	FOR -P415/-P645 : INDONESIA/ VIETNAM
	-	EHND63S615PW	INDIVIDUAL PACKAGE ASSEMBLY	1	FOR -P605/-P615 : HONG KONG/ UAE
	-	EHND63S62PW	INDIVIDUAL PACKAGE ASSEMBLY	1	FOR -P62B : INDIA
	-	EHND63S655PW	INDIVIDUAL PACKAGE ASSEMBLY	1	FOR -P655 : MALAYSIA
	-	EHND63S685PW	INDIVIDUAL PACKAGE ASSEMBLY	1	FOR -P685 : UAE
	-	EHND63S695PW	INDIVIDUAL PACKAGE ASSEMBLY	1	FOR -P695 : KUWAIT
	-	EHND63S865PW	INDIVIDUAL PACKAGE ASSEMBLY	1	FOR -P865 : RUSSIA

Remarks : *1 Individual Available