

Panasonic**Order No.AD1308008AE**

J1

Service Manual

Stereo Headphones

Model No. **RP-DJ1215E****Colour****(S).....Silver Type**

Please file and use this manual together with the service manual for Model No.RP-DJ1200E, Order No.[AD9605128C8](#).

Specification

Type:	Dynamic Closed-type
Driver units:	41 mm (1-5/ 8in.) diameter
Impedance:	32 Ω / 1 kHz
Sensitivity:	106dB / mW
Rated power:	200 mW
Power handling capacity:	1,500 mW(* IEC)
Frequency response:	5 - 30,000Hz
Cord:	Approx. 3m (9.8ft.) long
Plug:	Stereo mini-plug [3.5mm (1/ 8in.) diameter], straight-type, gold-plated
Mass:	Approx. 230g (8.11oz.)(without cord) Approx. 330g (11.64oz.)(net)
Accessories:	Carrying pouch (RFX1415)...1pc. 6.3mm (1/ 4in.) diameter large stereo plug adaptor (gold plated)(RFX1414)...1pc.

* IEC:International Electrotechnical Commission
Specifications are subject to change without notice.

 **WARNING**

This service information is designed for experienced repair technicians only and is not designed for use by the general public. It does not contain warnings or cautions to advise non-technical individuals of potential dangers in attempting to service a product. Products powered by electricity should be serviced or repaired only by experienced professional technicians. Any attempt to service or repair the product or products dealt with in this service information by anyone else could result in serious injury or death.

© Panasonic Corporation 2013 Unauthorized copying and distribution is a violation of law.

1 Service Navigation

1.1 General Description About Lead Free Solder (PbF)

The lead free solder has been used in the mounting process of all electrical components on the printed circuit boards used for this equipment in considering the globally environmental conservation.

The normal solder is the alloy of tin (Sn) and lead (Pb). On the other hand, the lead free solder is the alloy mainly consists of tin (Sn), silver (Ag) and Copper (Cu), and the melting point of the lead free solder is higher approx.30°C (86°F) more than that of the normal solder.

Distinction of P.C.B. Lead Free Solder being used

The letter of "PbF" is printed either foil side or components side on the P.C.B. using the lead free solder.(See right figure)	PbF
--	-----

Service caution for repair work using Lead Free Solder (PbF)

- The lead free solder has to be used when repairing the equipment for which the lead free solder is used. (Definition: The letter of "PbF" is printed on the P.C.B. using the lead free solder.)
- To put lead free solder, it should be well molten and mixed with the original lead free solder.
- Remove the remaining lead free solder on the P.C.B. cleanly for soldering of the new IC.
- Since the melting point of the lead free solder is higher than that of the normal lead solder, it takes the longer time to melt the lead free solder.
- Use the soldering iron (more than 70W) equipped with the temperature control after setting the temperature at 350±30°C (662±86°F).

Recommended Lead Free Solder (Service Parts Route.)

- The following 3 types of lead free solder are available through the service parts route.
RFKZ03D01KS----- (0.3mm 100g Reel)
RFKZ06D01KS----- (0.6mm 100g Reel)
RFKZ10D01KS----- (1.0mm 100g Reel)

Note

* Ingredient: tin (Sn) 96.5%, silver (Ag) 3.0%, Copper (Cu) 0.5%, Cobalt (Co) / Germanium (Ge) 0.1 to 0.3%

1.2 Sold the Lead Wire

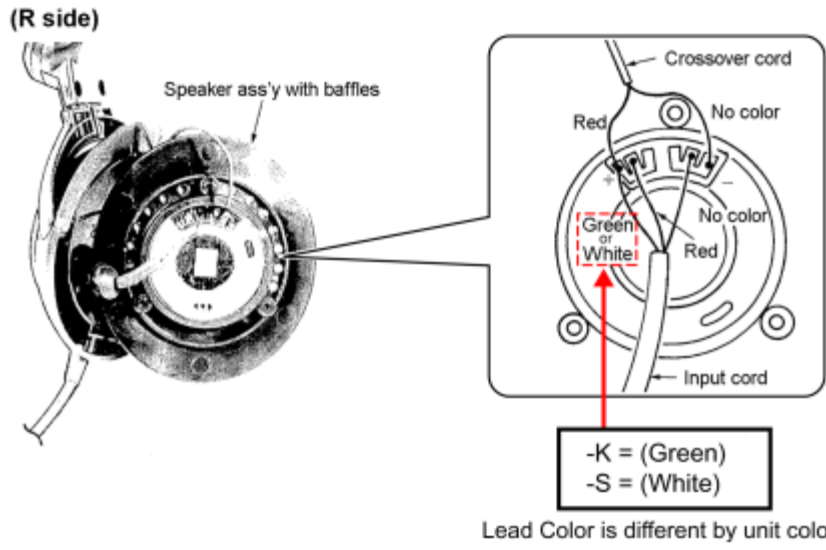

2 Exploded View and Replacement Parts List

2.1 Frame and Casing Section

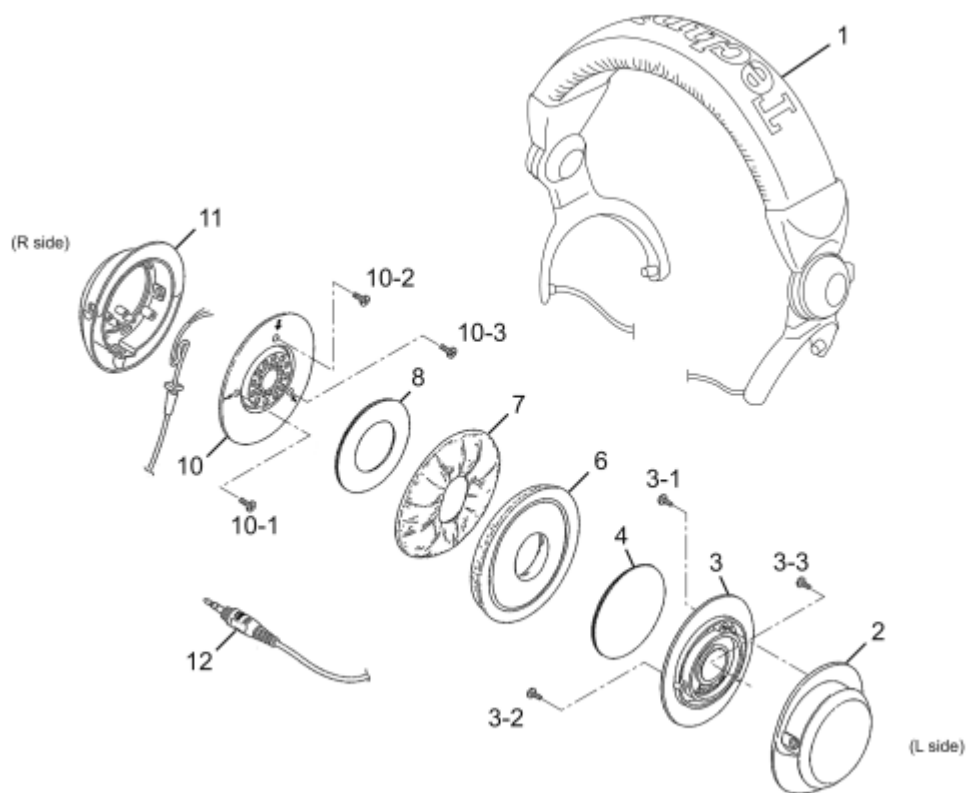

2.2 Packing Parts and Accessories Section

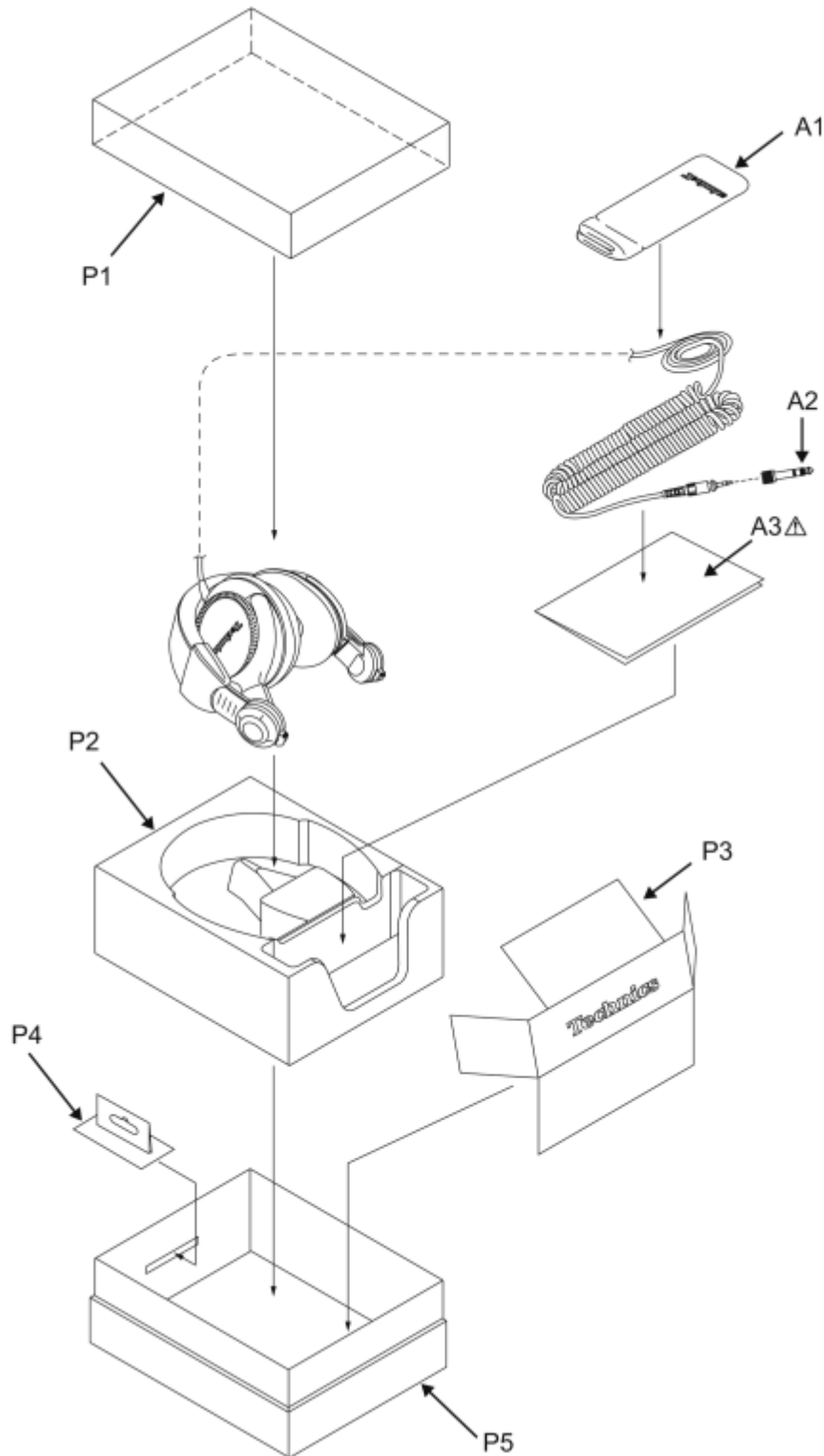

2.3 Replacement Parts List

Note:

- The following parts are supplied by SPG.

Safety	Ref.No.	Part No.	Part Name & Description	Pcs	Remarks
	1	RFX3036	HEAD BAND ASSY	1	
	2	RFX3213	HOUSING(L)	1	
	3	RFX1419	SPEAKER ASSY	1	
	3-1	XTN2+5JFZ	SCREW	1	
	3-2	XTN2+5JFZ	SCREW	1	
	3-3	XTN2+5JFZ	SCREW	1	
	4	RFX0G57	SCREEN SHEET ASSY	1	
	6	RFX1391	EAR PAD	1	
	7	RFX1391	EAR PAD	1	
	8	RFX0G57	SCREEN SHEET ASSY	1	
	10	RFX1419	SPEAKER ASSY	1	
	10-1	XTN2+5JFZ	SCREW	1	
	10-2	XTN2+5JFZ	SCREW	1	
	10-3	XTN2+5JFZ	SCREW	1	
	11	RFX3214	HOUSING(R)	1	
	12	RFX1394	INPUT CORD	1	includes BUSHING
	A1	RFX1415	POUCH	1	
	A2	RFX1414	PLUG ADAPTER	1	
	A3	RFX0E56	O/I	1	
	P1	RFX0G50	FACE SIDE BOX ASSY	1	
	P2	RFX0G52	TRAY	1	
	P3	RFX0G54	PASTE BOARD	1	
	P4	RFX0G53	HOOK	1	
	P5	RFX0G51	BOTTOM SIDE BOX ASSY	1	