

Service Manual

Speaker System

Model No. **SB-MAX770PU**

Product Color : (K)... Black Type

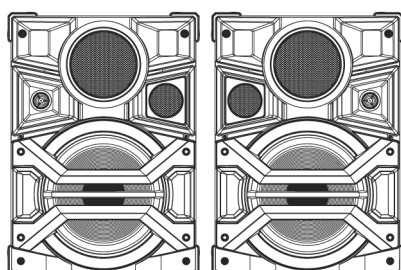

SB-MAX770

SB-MAX770

WARNING

This service information is designed for experienced repair technicians only and is not designed for use by the general public. It does not contain warnings or cautions to advise non-technical individuals of potential dangers in attempting to service a product. Products powered by electricity should be serviced or repaired only by experienced professional technicians. Any attempt to service or repair the product or products dealt with in this service information by anyone else could result in serious injury or death.

IMPORTANT SAFETY NOTICE

There are special components used in this equipment which are important for safety. These parts are marked by  in the Schematic Diagrams, Circuit Board Diagrams, Exploded Views and Replacement Parts List. It is essential that these critical parts should be replaced with manufacturer's specified parts to prevent shock, fire or other hazards. Do not modify the original design without permission of manufacturer.

TABLE OF CONTENTS

	PAGE
1 Specifications	2
2 Disassembly and Assembly Instructions	3
2.1. Disassembly of Upper Front Panel Assembly.....	4
2.2. Disassembly of Tweeter Speaker (SP1)	5
2.3. Disassembly of Full Range Speaker (SP2)	5
2.4. Disassembly of Full Range Speaker (SP3)	6
2.5. Disassembly of Lower Front Panel Assembly.....	6
2.6. Disassembly of Woofer Speaker (SP4)	8
2.7. Disassembly of Lighting Wire P.C.B. Assembly	8
3 Wiring Connection Diagram	10
3.1. Front Speakers	10
4 Exploded View and Replacement Parts List	11
4.1. Cabinet Parts Location	11
4.2. Packaging	12
4.3. Replacement Parts List	13

PAGE

1 Specifications

Front Speakers

Type 4 way, 4 speaker system (Bass reflex)

Speaker(s)

Super Woofer (Low) 38 cm cone type

Super Woofer (Medium Low) 20 cm cone type

Woofer 10 cm cone type

Tweeter 6 cm cone type

Impedance 3 Ω (High), 3 Ω (Medium Low),
5 Ω (Low)

Output sound pressure 91 dB/W (1 m)

Frequency range 25 Hz to 23 kHz (-16 dB)

30 Hz to 20 kHz (-10 dB)

Dimensions (W x H x D)

With Corner Guard 576 mm x 794 mm x 542 mm

Without Corner Guard 576 mm x 786 mm x 542 mm

Mass (Weight) 37.4 kg

Notes:

1. Specifications are subject to change without notice.

Mass and dimensions are approximate.

2. Total harmonic distortion is measured by the digital spectrum analyzer.

2 Disassembly and Assembly Instructions

Caution Note:

- This section describes procedures for checking the operation and replacing the main components.
- For reassembly after operation checks or replacement, reverse the respective procedures.
- Special reassembly procedures are described only when required.
- Before carrying out the disassembly process, please ensure all the safety precautions & procedures are followed.
- During the disassembly and/or assembly process, please handle with care as there may be chassis components with sharp edges.
- During replacement of component parts, please refer to the section of "Replacement Parts List" as described in the service manual.
- Select items from the following indexes when disassembly or replacement are required.

Front Speakers

- Disassembly of Upper Front Panel Assembly
- Disassembly of Tweeter Speaker (SP1)
- Disassembly of Full Range Speaker (SP2)
- Disassembly of Full Range Speaker (SP3)
- Disassembly of Lower Front Panel Assembly
- Disassembly of Woofer Speaker (SP4)
- Disassembly of Lighting Wire P.C.B. Assembly

CAUTION NOTE:

Please use original screw and at correct locations.

Below shown is part no. of different screw types used:

- a** : XTB4+16AFJK
- b** : XTB4+10GFJ
- c** : XTB4+12GFJ
- d** : XTB3+10GFJ

2.1. Disassembly of Upper Front Panel Assembly

Step 1 : Remove 4 screws.

Step 2 : Remove the Corner Guard.

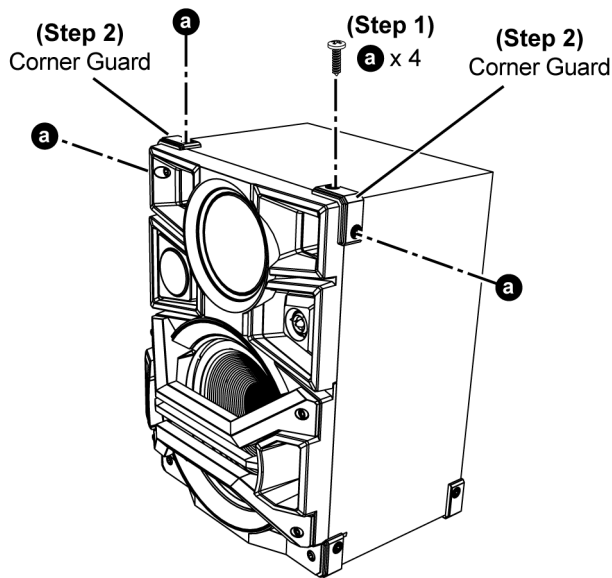

Step 3 : Remove 4 screws.

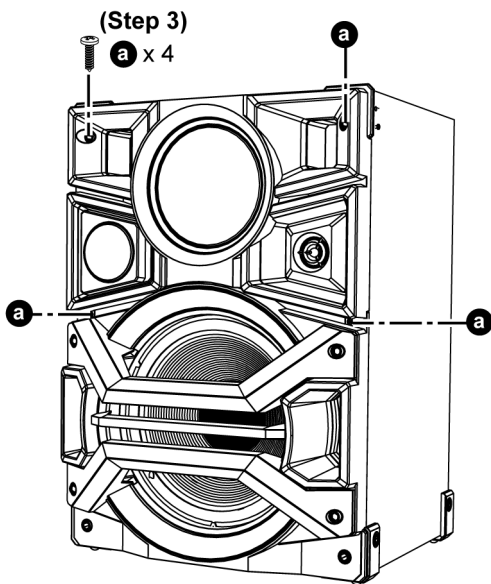

Step 4 : Insert two flathead screwdriver at the sides of the boss and apply light force to push out the Upper Front Panel Assembly by sequence (1-7) shown.

Caution : Do not exert too much force as it may damage the Upper Front Panel Assembly.

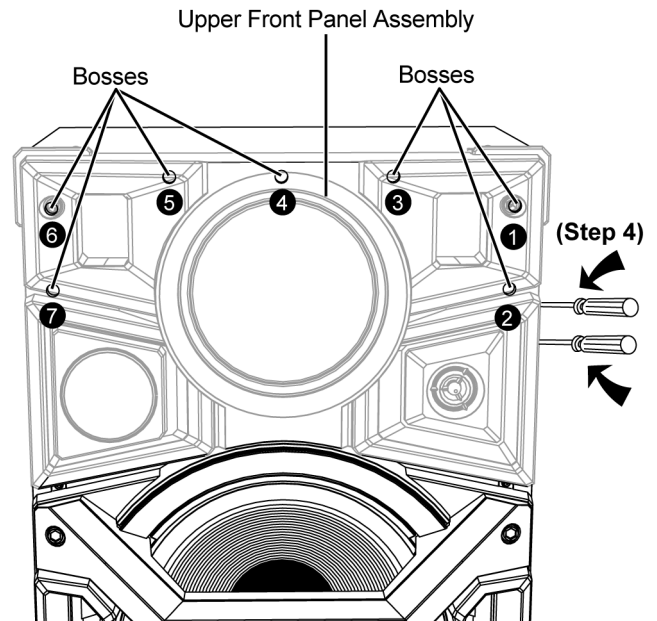

Step 5 : Detach the (+) and (-) speaker wires.

Step 6 : Remove the Upper Front Panel Assembly.

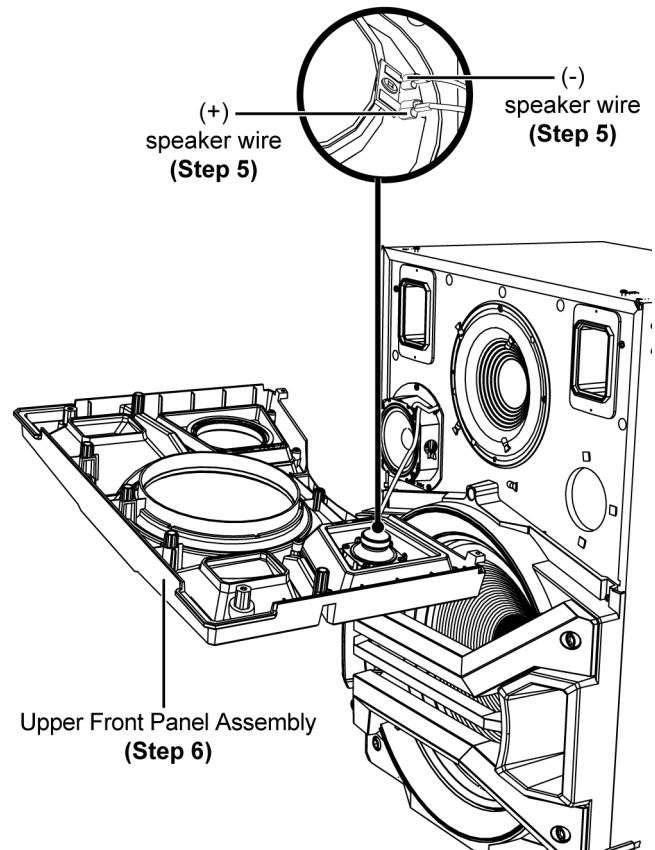

2.2. Disassembly of Tweeter Speaker (SP1)

- Refer to "Disassembly of Upper Front Panel Assembly".

Step 1 : Remove 4 screws.

Step 2 : Remove the Tweeter Speaker (SP1).

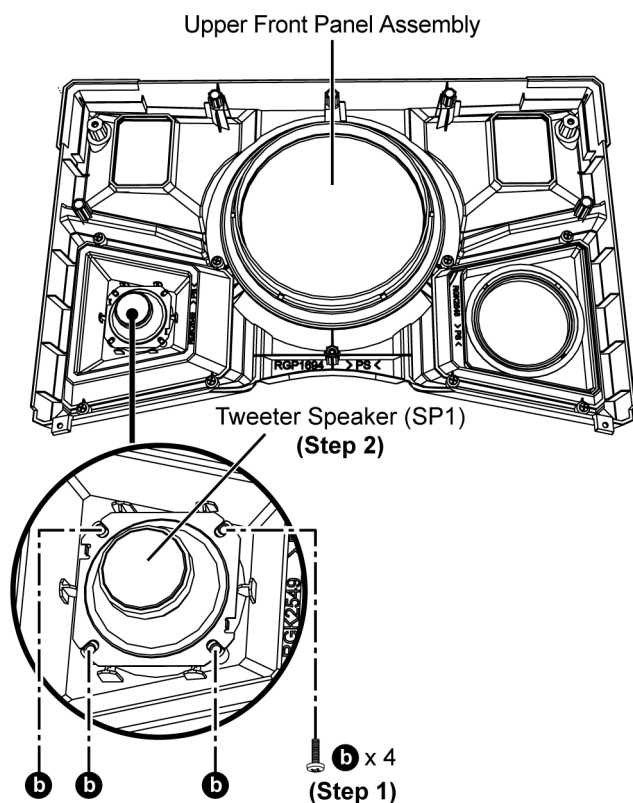

2.3. Disassembly of Full Range Speaker (SP2)

- Refer to "Disassembly of Upper Front Panel Assembly".

Step 1 : Remove 4 screws.

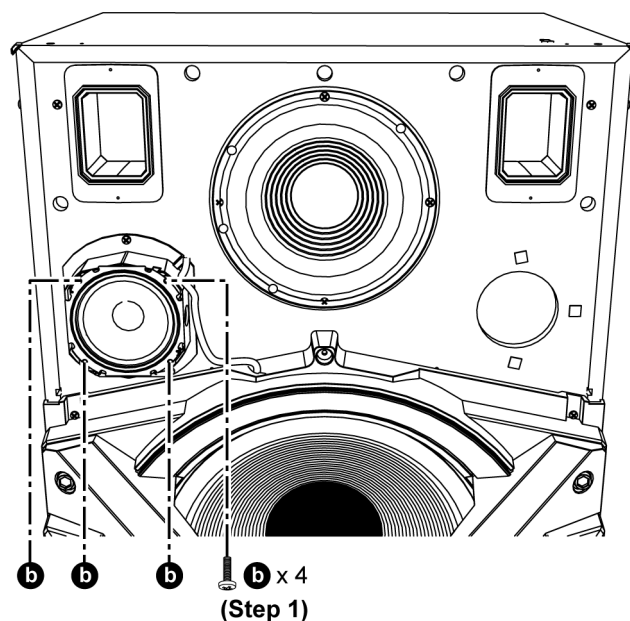

Step 2 : Slightly lift up Full Range Speaker (SP2) as shown.

Step 3 : Detach the (+) and (-) speaker wires.

Step 4 : Remove the Full Range Speaker (SP2).

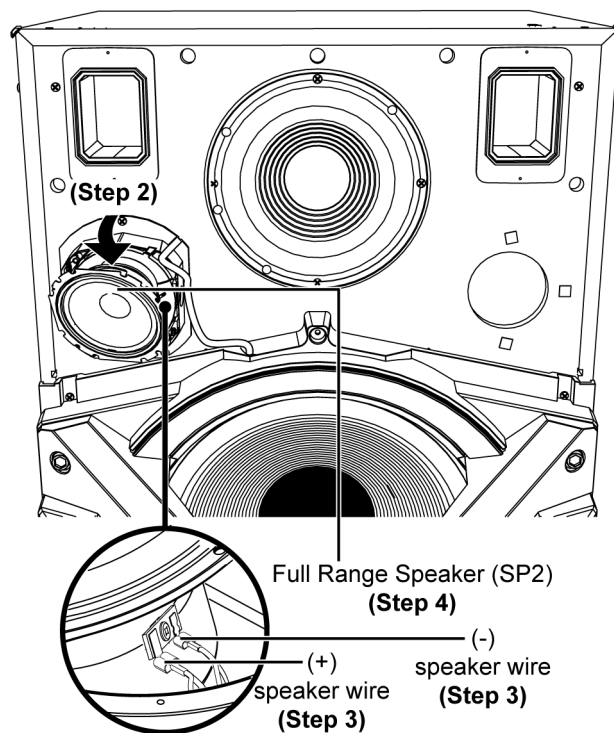

2.4. Disassembly of Full Range Speaker (SP3)

- Refer to “Disassembly of Upper Front Panel Assembly”.

Step 1 : Remove 4 screws.

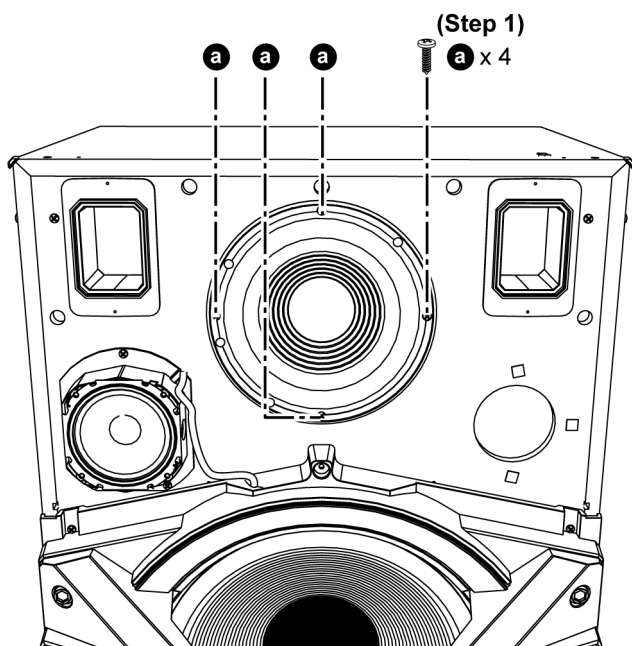

Step 2 : Slightly lift up Full Range Speaker (SP3) as shown.

Step 3 : Detach the (+) and (-) speaker wires.

Step 4 : Remove the Full Range Speaker (SP3).

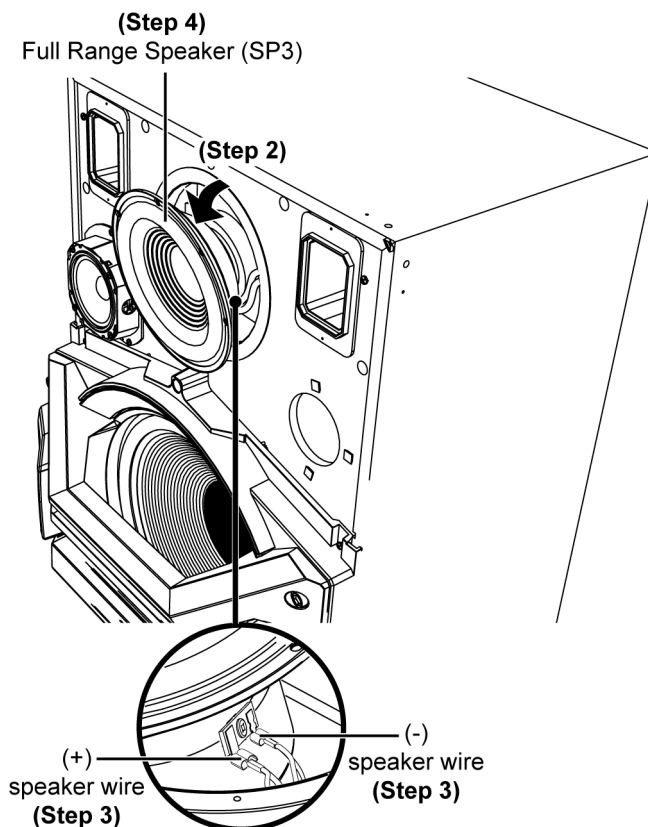

2.5. Disassembly of Lower Front Panel Assembly

- Refer to “Disassembly of Upper Front Panel Assembly”.

Step 1 : Remove 4 screws.

Step 2 : Remove the Corner Guard.

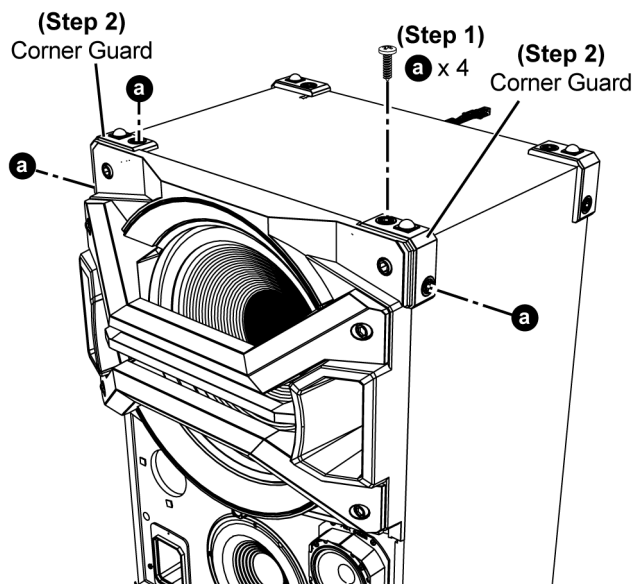

Step 3 : Remove 2 screws.

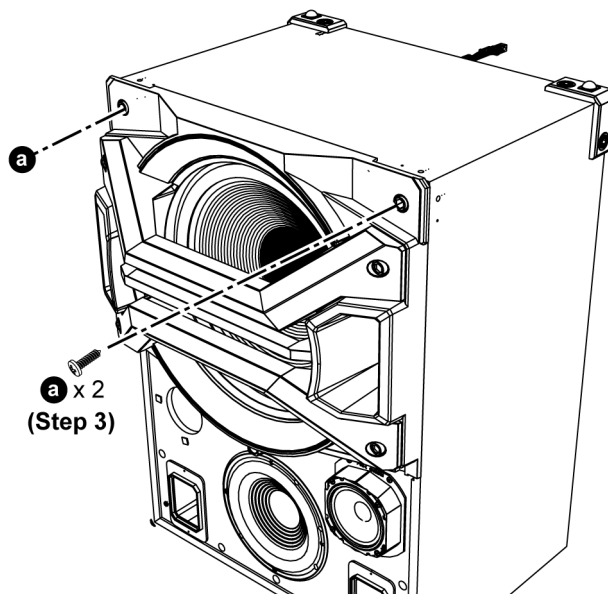

Step 4 : Insert two flathead screwdriver at the sides of the boss and apply light force to push out the Lower Front Panel Assembly by sequence (1-9) shown.

Caution : Do not exert too much force as it may damage the Upper Front Panel Assembly.

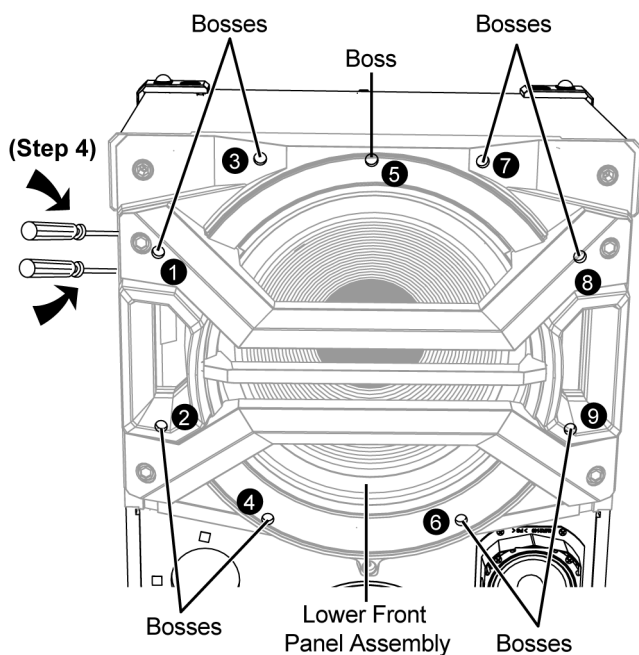

Step 6 : Detach the 4P Wire Socket.

Step 7 : Remove the Lower Front Panel Assembly.

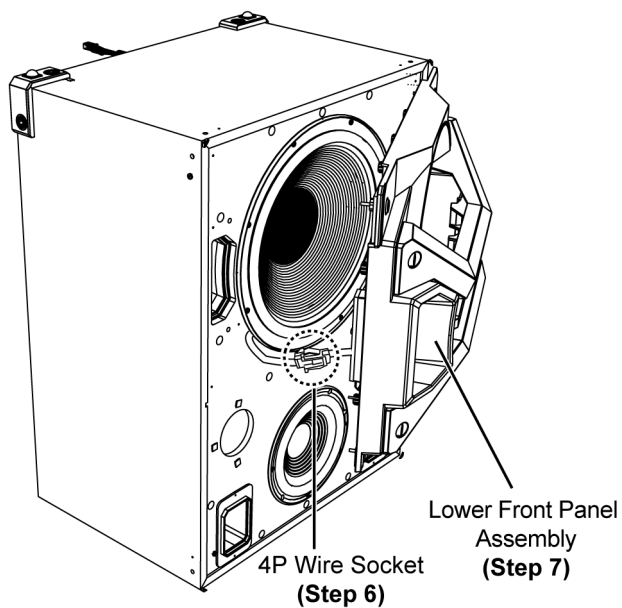

Step 5 : Lift up the Himelon.

Caution : Replace the Himelon if they are torn during disassembling.

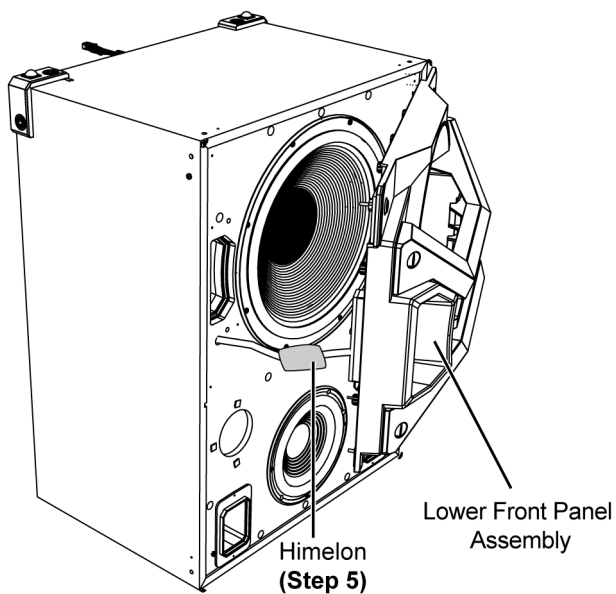

2.6. Disassembly of Woofer Speaker (SP4)

- Refer to “Disassembly of Upper Front Panel Assembly”.
- Refer to “Disassembly of Lower Front Panel Assembly”.

Step 1 : Remove 8 screws.

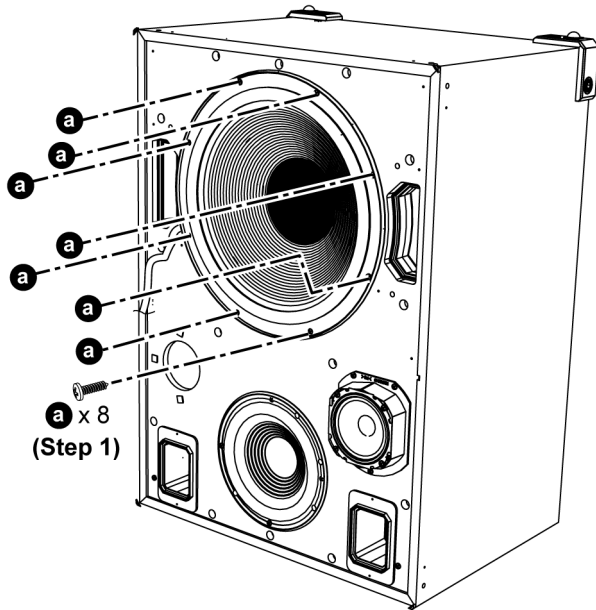

Step 2 : Slightly lift up Woofer Speaker (SP4) as shown.

Step 3 : Detach the (+) and (-) speaker wires.

Step 4 : Remove the Woofer Speaker (SP4).

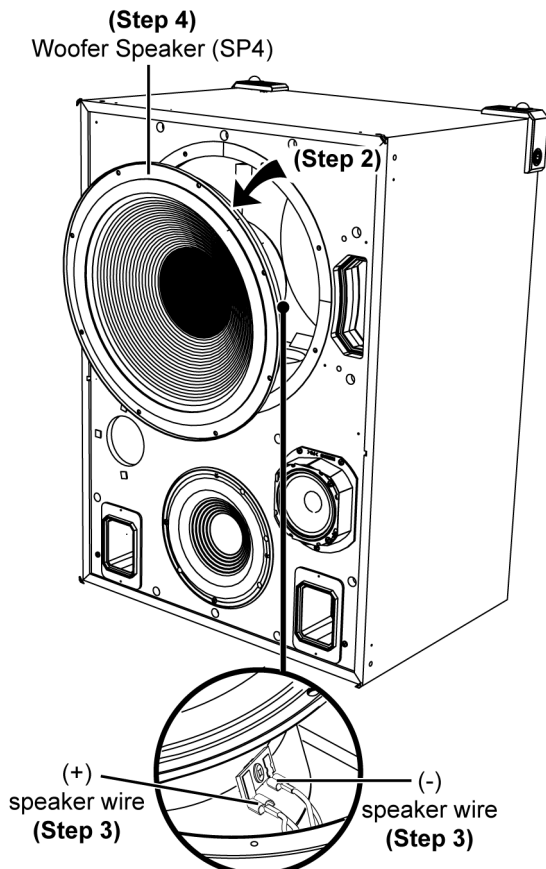

2.7. Disassembly of Lighting Wire P.C.B. Assembly

- Refer to “Disassembly of Upper Front Panel Assembly”.
- Refer to “Disassembly of Lower Front Panel Assembly”.

Step 1 : Release the 4P wire from the hole of Lower Front Panel Assembly.

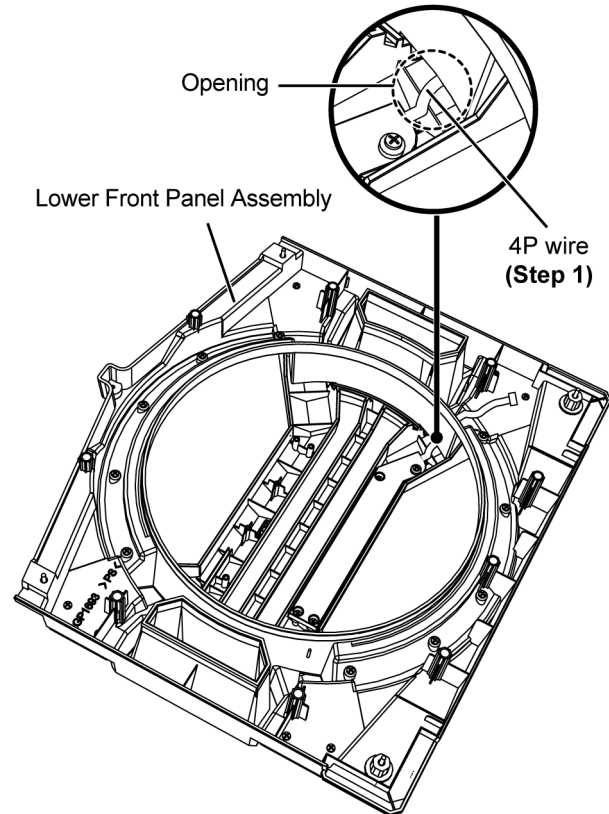

Step 2 : Remove 4 screws.

Step 3 : Remove the Lighting Pieces.

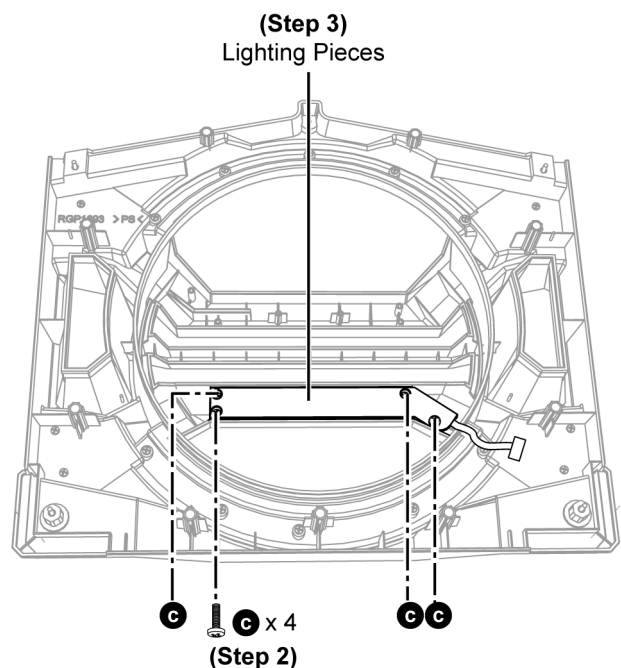

Step 4 : Release the 4P wire from the slots.

Caution : During assembling, ensure that the 4P wire is properly inserted into the slot.

Step 5 : Remove 2 screws.

Step 6 : Remove the Lighting Wire P.C.B. Assembly.

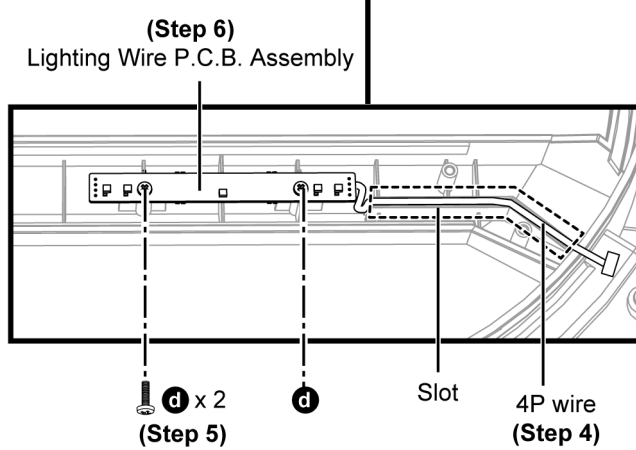
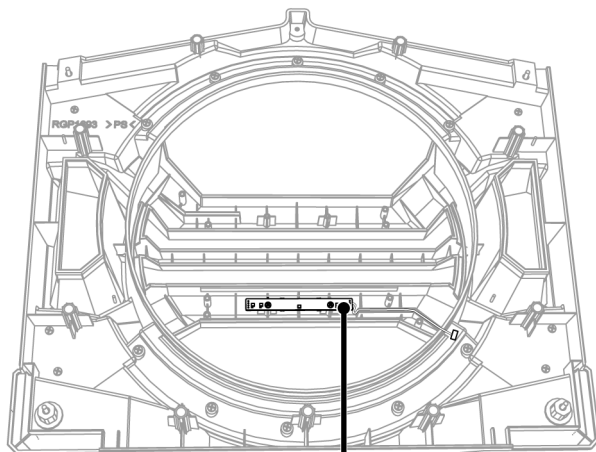

3 Wiring Connection Diagram

3.1. Front Speakers

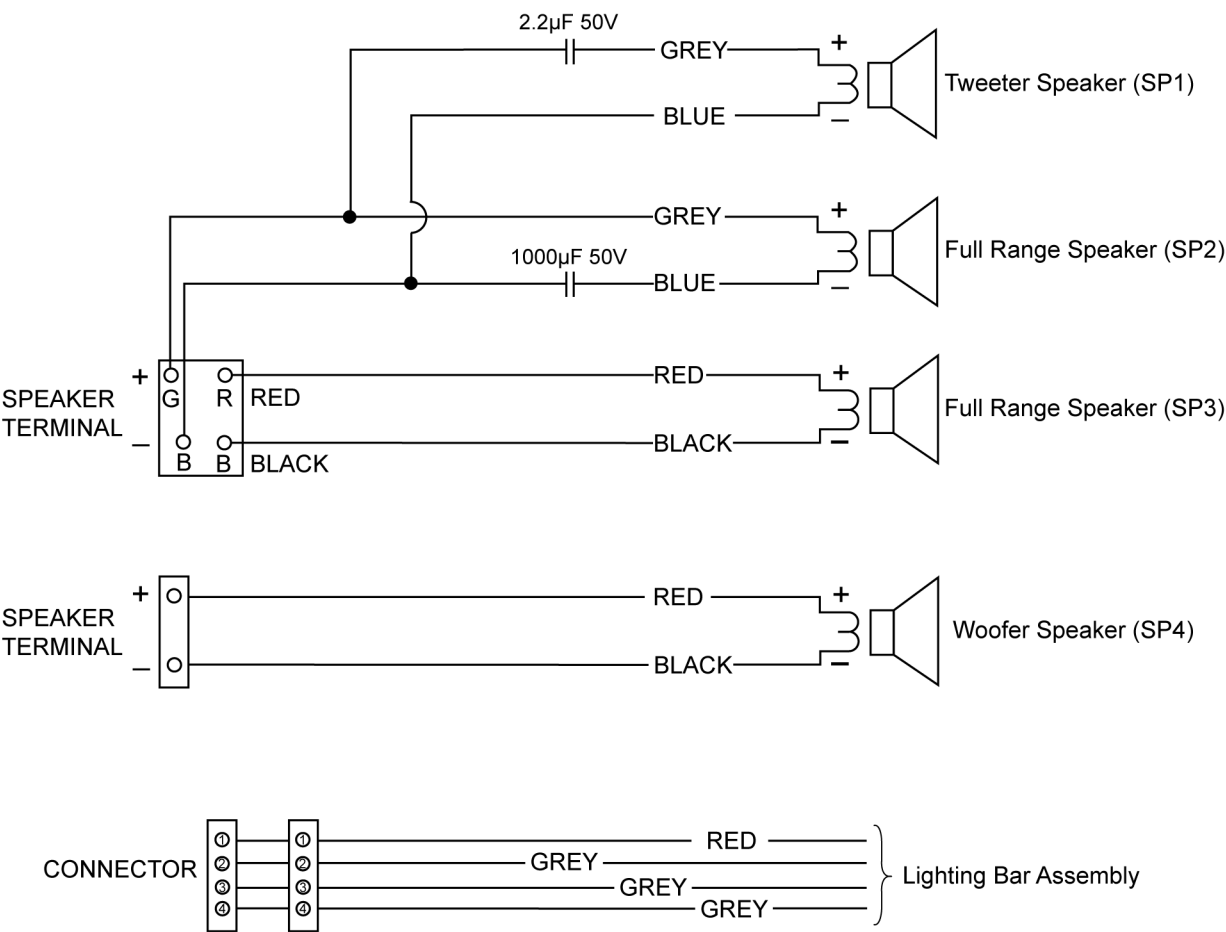

4 Exploded View and Replacement Parts List

4.1. Cabinet Parts Location

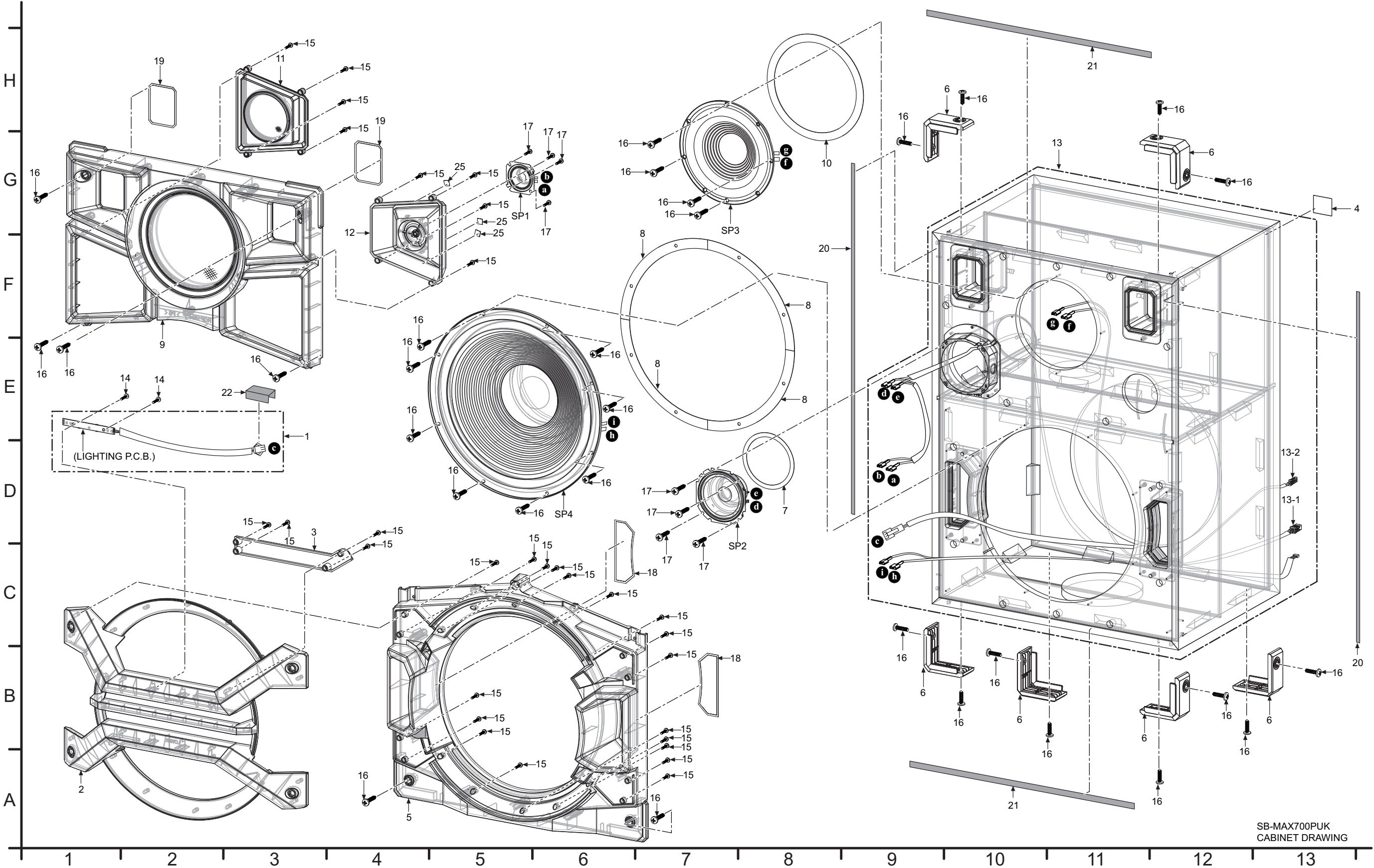

4.2. Packaging

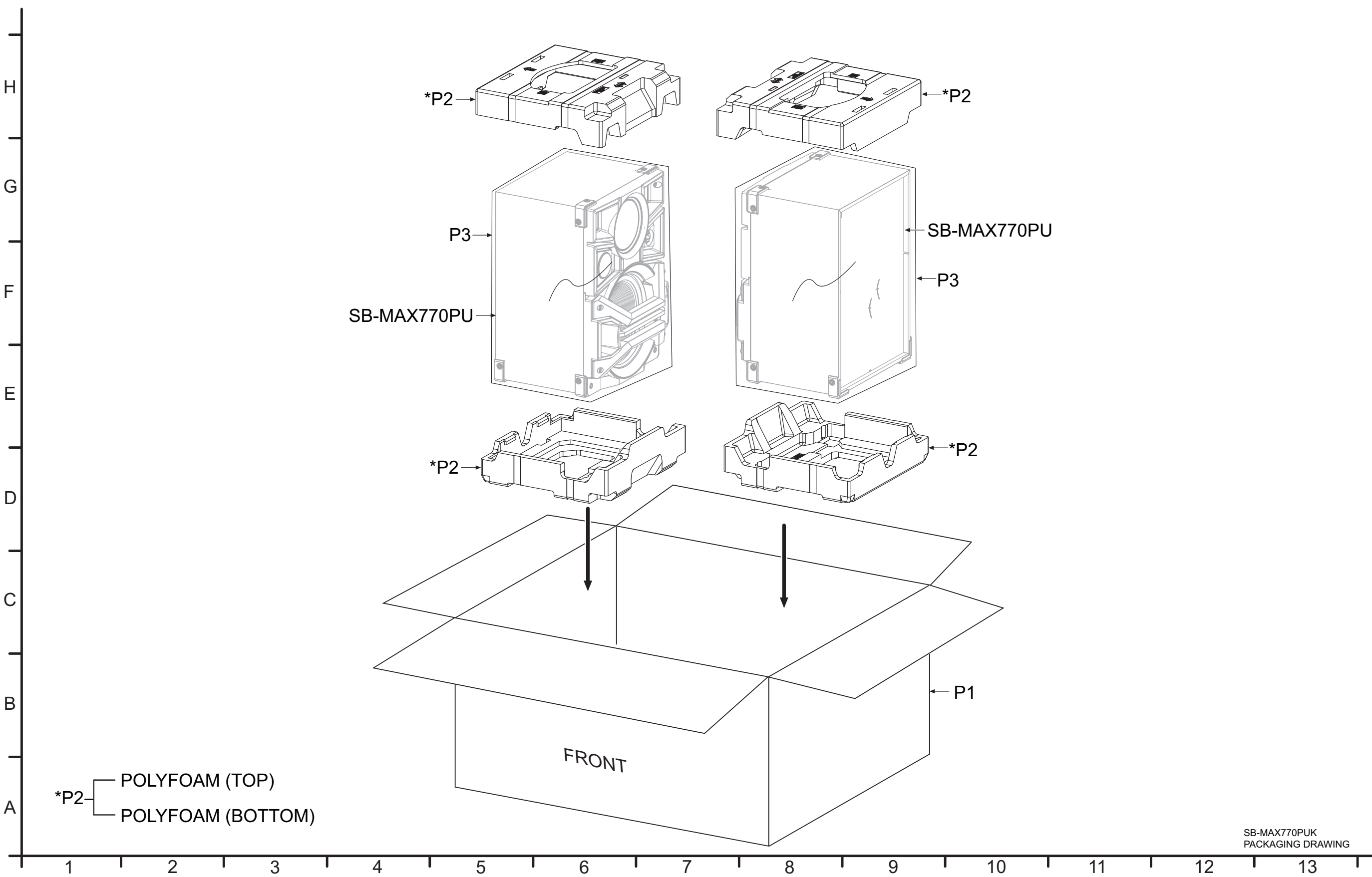

SB-MAX770PUK
PACKAGING DRAWING

4.3. Replacement Parts List

Important Safety Notice

Components identified by  mark have special characteristics important for safety. When replacing any of these components, use only manufacturer's specified parts.

RTL (Retention Time Limited)

Note: The marking (RTL) indicates that the Retention Time is Limited for this item.

After the discontinuation of this assembly in production, the item will continue to be available for a specific period of time. The retention period of availability is dependant on the type of assembly, and in accordance with the laws governing part and product retention. After the end of this period, the assembly will no longer be available.

Note:

- When replacing any of these components, be sure to use only manufacturer's specified parts shown in the replacement part list.
- The parenthesized indications on the Remarks column specify the destination & product color (Refer to the cover page for the information).
- Parts without these indications shall be used for all areas.
- All parts mentioned are supplied by PAVCJM unless indicated likewise.

4.3.1. Front Speakers

Safety	Ref. No.	Part No.	Part Name & Description	Qty	Remarks
			CABINET & CHAS-SIS		
	1	REE1926	LIGHTING WIRE PCB ASS'Y	1	
	2	RGK2547-S	FRONT ORNAMENT	1	
	3	RGL0801-Q	LIGHTING PIECE	1	
	4	RGN3419-K	SPEC LABEL L	1	
	4	RGN3419A-K	SPEC LABEL R	1	
	5	RGP1693-K	LOWER FRONT PANEL	1	
	6	RGQ0812-K	CORNER GUARD	6	
	7	RMQ0819	EVA PACKING	1	
	8	RMQ2123	EVA PACKING	4	
	9	RYP1970-K	UPPER FRONT PANEL ASS'Y L	1	
	9	RYP1971-K	UPPER FRONT PANEL ASS'Y R	1	
	10	RMQX0285-K	EVA PACKING	1	
	11	RYQ1353-K	NET FRAME ASSY (WOOFER)	1	
	12	RYQ1354-K	TWEETER HOLDER ASS'Y	1	
	13	RYQ1355-K	WOODEN BOX ASSY (L)	1	
	13-1	K1MY04A00006	4P SPK CONNECTOR HOUSING (WHITE) L	1	
	13-2	RHGX1002W	2P SPK CONNECTOR HOUSING (WHITE) L	1	
	13	RYQ1356-K	WOODEN BOX ASSY (R)	1	
	13-1	K1MY04A00007	4P SPK CONNECTOR HOUSING (RED) R	1	
	13-2	RHGX1002R	2P SPK CONNECTOR HOUSING (RED) R	1	
	14	XTB3+10GFJ	SCREW	2	
	15	XTB4+12GFJ	SCREW	30	
	16	XTB4+16AFJK	SCREW	30	

Safety	Ref. No.	Part No.	Part Name & Description	Qty	Remarks
	17	XTB4+10GFJ	SCREW	8	
	18	RMF0600J	HIMELON	2	
	19	RMF0600C	HIMELON	2	
	20	RMF0600	HIMELON	2	
	21	RMF0600A	HIMELON	2	
	22	RMQ2070	HIMELON	1	
	25	RKA0072-KJ	LEG RUBBER	3	
			SPEAKERS		
	SP1	EAS6PH134A	TWEETER	1	
	SP2	L0AA10A00040	WOOFER	1	
	SP3	L0AA20A00032	WOOFER	1	
	SP4	L0AA38A00010	WOOFER	1	

4.3.2. Packing Materials

Safety	Ref. No.	Part No.	Part Name & Description	Qty	Remarks
			PACKING MATERIALS		
	P1	RPG0K09	PACKING CASE	1	
	P2	RPN2637	POLYFOAM	2	
	P3	RPF0643	MIRAMAT BAG	2	

IPSG1402