

Service Manual

Speaker System



Model No. **SB-MAW370PU**
SB-MAY370PU
SB-MAX370PU
SB-MAW370GS
SB-MAY370GS
SB-MAX370GS
SB-MAW170PH
SB-MAX170PH

Product Color : (K)... Black Type

Subject : Disassembly and Assembly Instructions/ Exploded View / Replacement Parts List (Change)

Please file and use this supplement manual together with the service manual for
Model No. SB-MAX170PHK Order No. PSG1403015CE
Model No. SB-MAX370PUK Order No. PSG1402008CE
Model No. SB-MAX370GSK Order No. PSG1404010AE

⚠ WARNING
This service information is designed for experienced repair technicians only and is not designed for use by the general public. It does not contain warnings or cautions to advise non-technical individuals of potential dangers in attempting to service a product. Products powered by electricity should be serviced or repaired only by experienced professional technicians. Any attempt to service or repair the product or products dealt with in this service information by anyone else could result in serious injury or death.

TABLE OF CONTENTS

	PAGE		PAGE
1 Notes -----	2	4.1. Mechanical Replacement Parts List-----	7
2 Disassembly and Assembly Instructions -----	2		
2.1. Disassembly of Woofer Speaker-----	2		
3 Exploded View-----	3		
3.1. Subwoofer Speaker (SB-MAW170PHK) Cabinet Parts Location-----	3		
3.2. Subwoofer Speaker (SB-MAW370PUK, SB- MAW370GSK) Cabinet Parts Location -----	4		
3.3. Subwoofer Speaker (SB-MAY370PUK, SB- MAY370GSK) Cabinet Parts Location -----	5		
4 Replacement Parts List-----	7		

1 Notes

Background:

- For improvement of quality and performance.

This supplement includes revised contents to the original service manual for below sections:-

1. Disassembly and Assembly Instructions
2. Exploded View.
3. Mechanical Replacement Parts List.

2 Disassembly and Assembly Instructions

2.1. Disassembly of Woofer Speaker

Step 1 : Remove 4 screws.

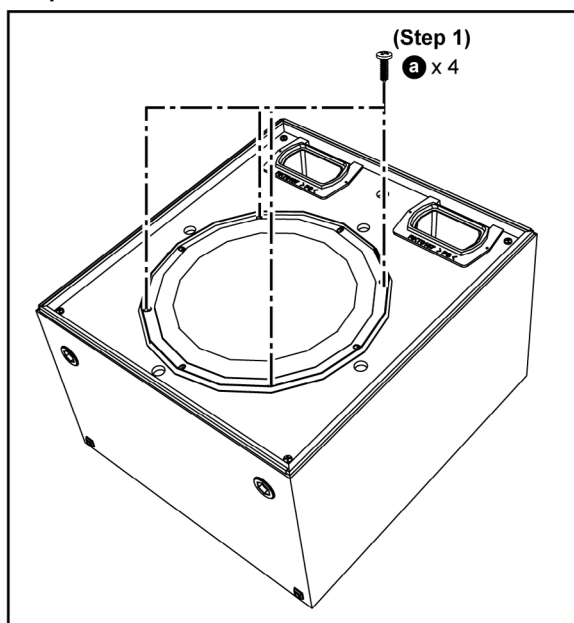

Step 1 : Remove 8 screws.

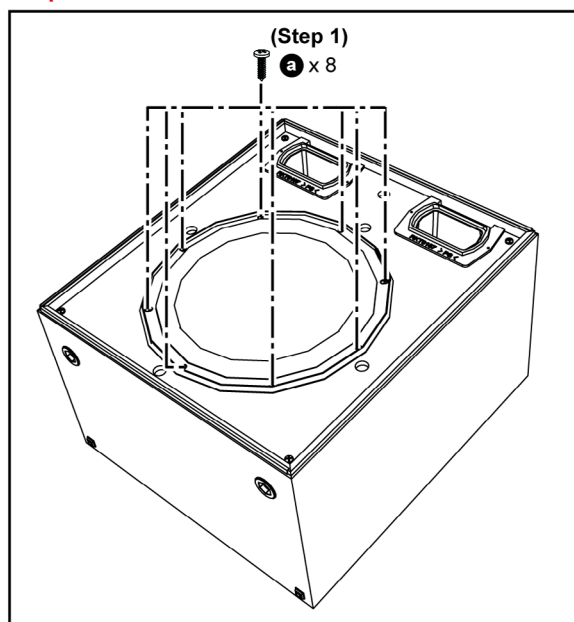

3 Exploded View

3.1. Subwoofer Speaker (SB-MAW170PHK) Cabinet Parts Location

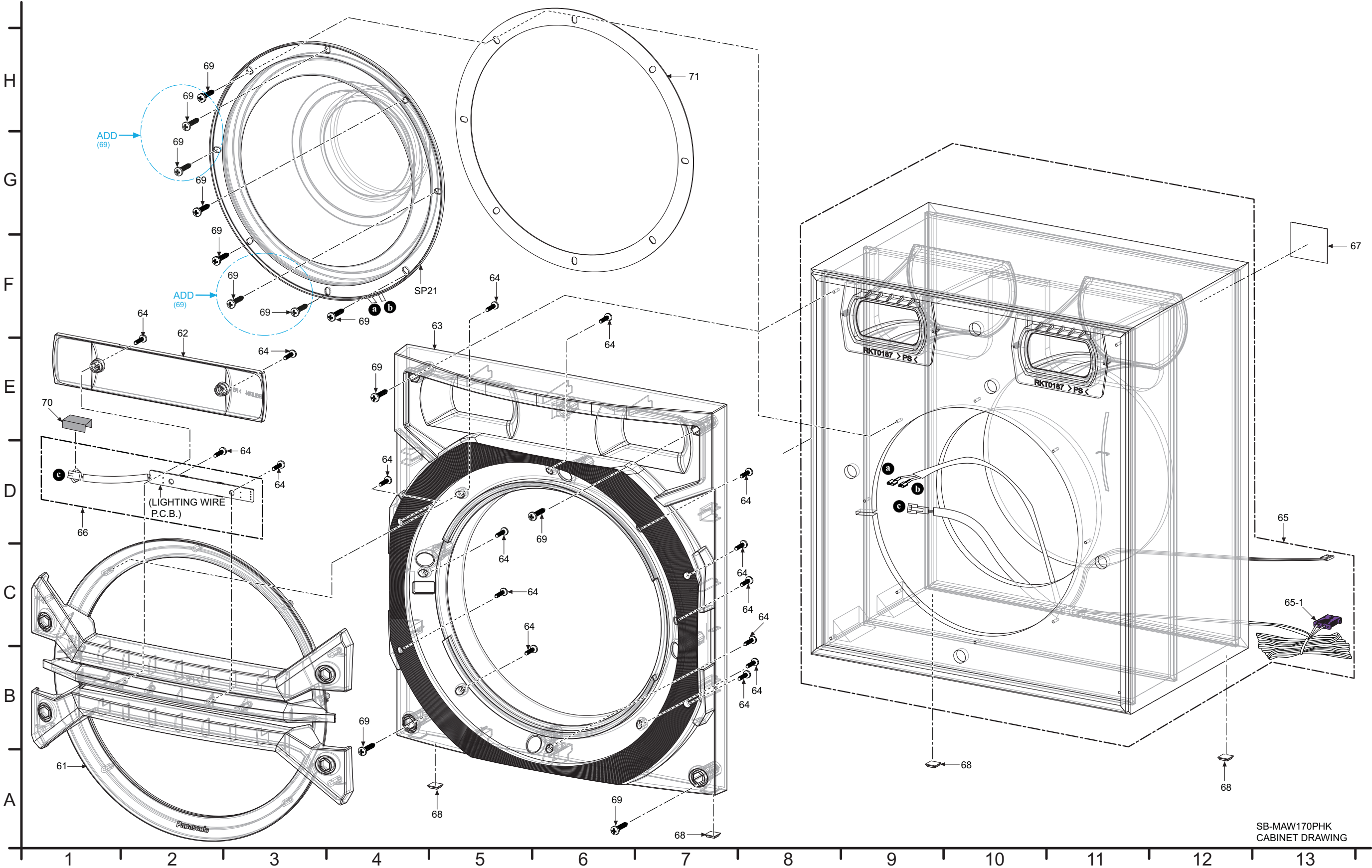

3.2. Subwoofer Speaker (SB-MAW370PUK, SB-MAW370GSK) Cabinet Parts Location

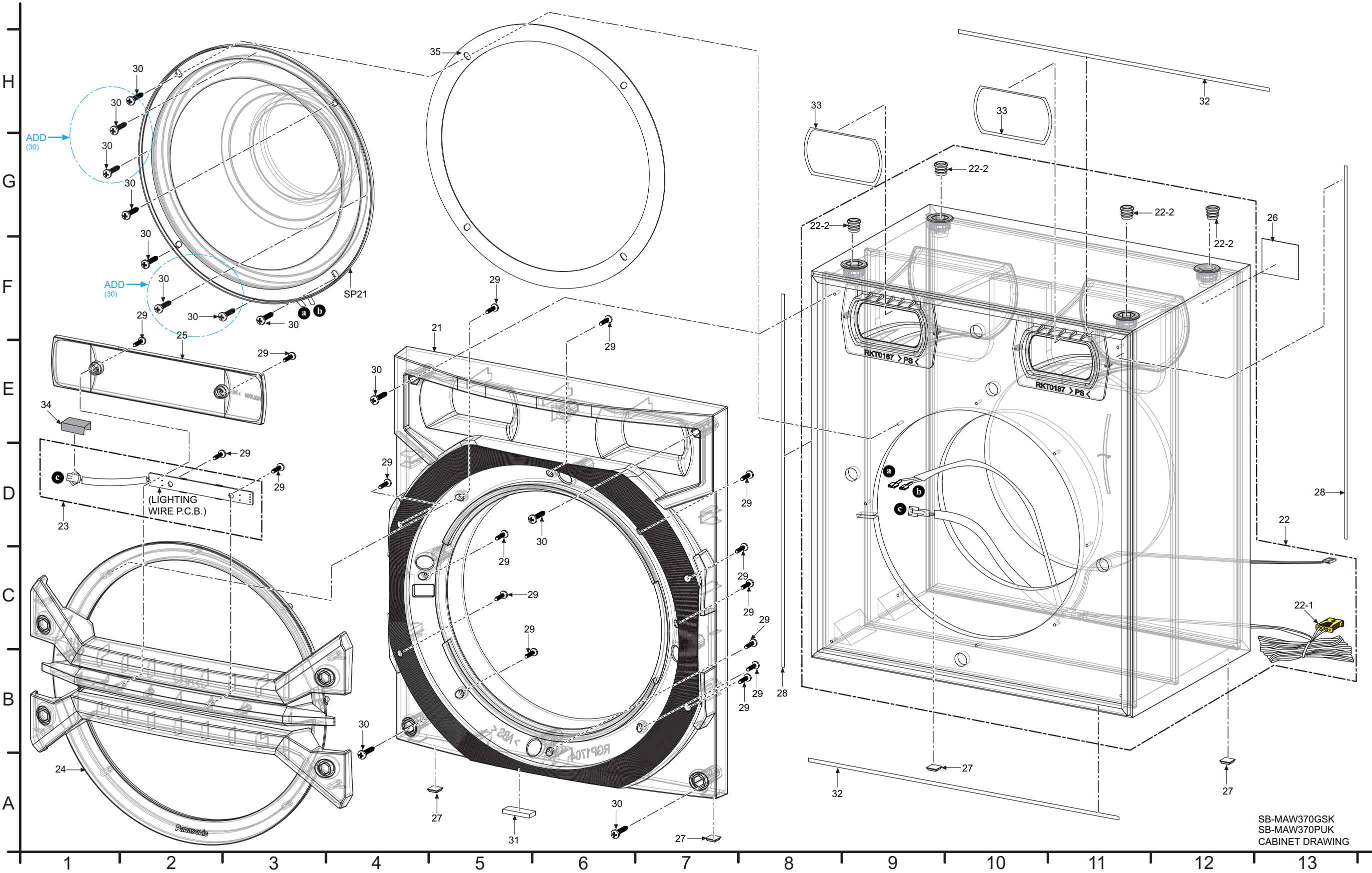

SB-MAW370GSK
SB-MAW370PUK
CABINET DRAWING

3.3. Subwoofer Speaker (SB-MAY370PUK, SB-MAY370GSK) Cabinet Parts Location

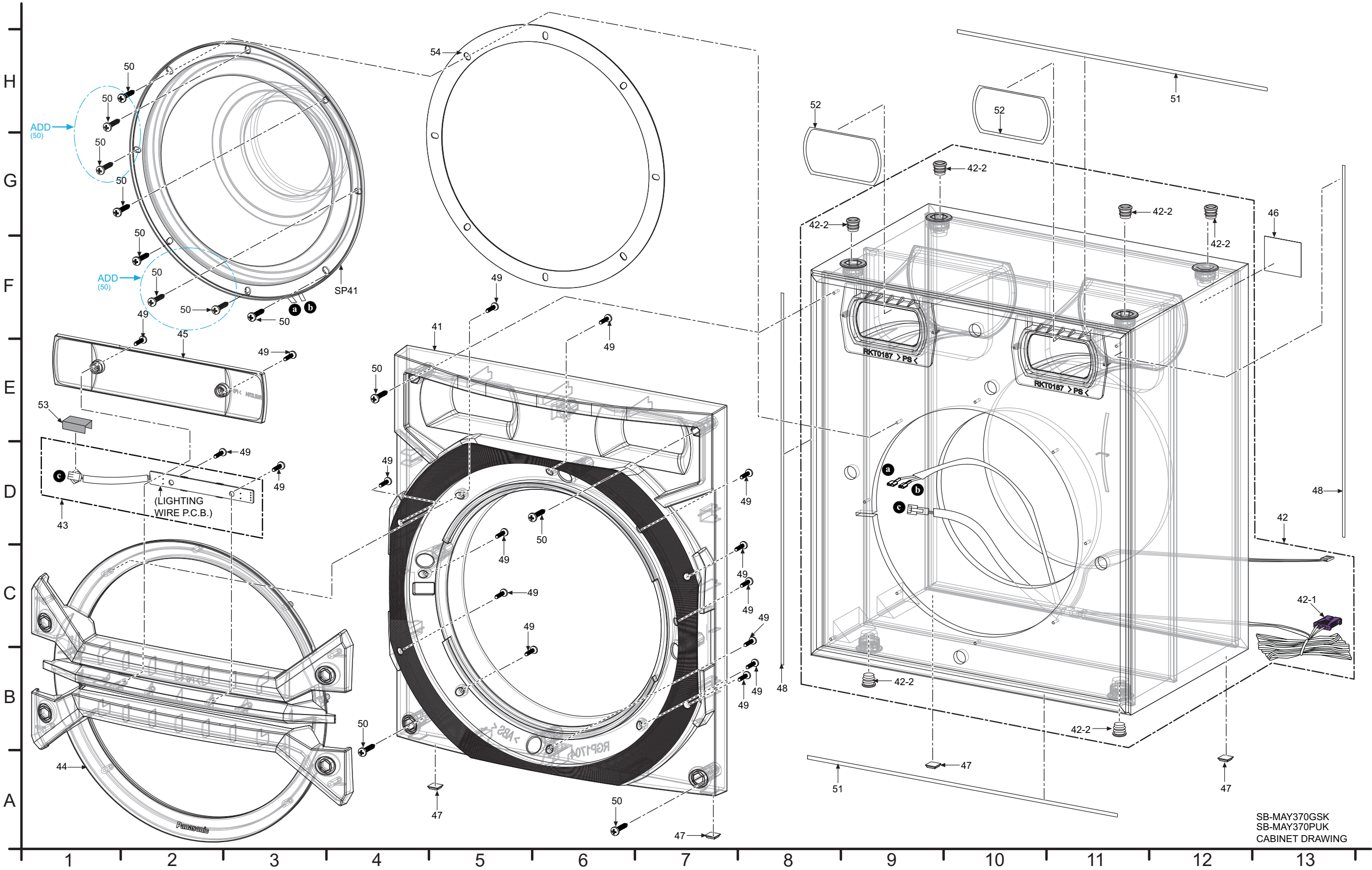

SB-MAY370GSK
SB-MAY370PUK
CABINET DRAWING

4 Replacement Parts List

Reason for Change

*The circled item indicates the reason. If no marking, see the Notes in the bottom column.

<input type="checkbox"/>	1. Improve performance
<input type="checkbox"/>	2. Change of material or dimension
<input type="checkbox"/>	3. To meet approved specification
<input type="checkbox"/>	4. Standardization
<input type="checkbox"/>	5. Addition
<input type="checkbox"/>	6. Deletion
<input type="checkbox"/>	7. Correction
<input type="radio"/>	8. Other

Interchangeability Code

**The circled item indicates the interchangeability. If no marking, see the Notes in the bottom column.

Parts	Set Production	
A Original New		Original or new parts may be used in early or late production set. Use original parts until exhausted, then stock new parts.
B Original New		Original parts may be used in early production sets only. New parts may be used in early or late production sets. Use original parts where possible, then stock new parts.
<input type="radio"/> C Original New		New parts only may be used in early or late production sets. Stock new parts.
D Original New		Original parts may be used in early production sets only. New parts may be used in late production sets only. Stock both original and new parts.
E Other		

Please revise the original parts list in the Service Manual to conform to the change(s) shown herein.

If new part numbers are shown, be sure to use them when ordering parts.

Please file and use this manual together with the original service manual.

4.1. Mechanical Replacement Parts List

4.1.1. Subwoofer Speaker (SB-MAW170PHK)

Ref. No.	Part No.	Notes	New Part Name & Descriptions	Before QTY	After QTY	Remarks
69	XTB4+16AFJK	8/C	SCREW	8	12	CHANGE

ECO No. MS2140479 (For Factory Reference only).

4.1.2. Subwoofer Speakers (SB-MAW370PUK, SB-MAY370PUK)

Ref. No.	Part No.	Notes	New Part Name & Descriptions	Before QTY	After QTY	Remarks
30	XTB4+16AFJK	8/C	SCREW	8	12	(SB-MAW370PUK) CHANGE
50	XTB4+16AFJK	8/C	SCREW	8	12	(SB-MAY370PUK) CHANGE

ECO No. MS2140479 (For Factory Reference only).

4.1.3. Subwoofer Speakers (SB-MAW370GSK, SB-MAY370GSK)

Ref. No.	Part No.	Notes	New Part Name & Descriptions	Before QTY	After QTY	Remarks
30	XTB4+16AFJK	8/C	SCREW	8	12	(SB-MAW370GSK) CHANGE
50	XTB4+16AFJK	8/C	SCREW	8	12	(SB-MAY370GSK) CHANGE

ECO No. MS2140479 (For Factory Reference only).

IPSG1407