

Service Manual

Speaker System

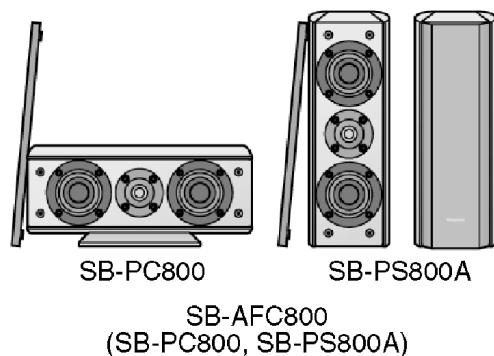

SB-AFC800E

Colour

(M)... Wood Grain Type

Please file and use this service manual together with the service manual for Model No. [SB-PS800AE-M, Order No. MD0410493C2].

Specification

SB-PC800

Type	2 way, 3 speaker system (Bass-reflex type)	Dimensions (W x H x D) (with stand)	60 Hz - 45 kHz (-10 dB) 380 x MAX 174.5 x MAX 230.5 mm
Speaker (s)		(without stand)	380 x 146 x 205 mm
Woofer	8 cm cone type x 2	Mass	4.8 kg
Tweeter	2.5 cm semi-dome type x 1	Notes :	
Impedance	6Ω	1. Specifications are subject to change without notice.	
Input power (IEC)	200 W (MAX), 100 W (RATED)	2. Mass and dimensions are approximate.	
Sound pressure level	81 dB/W (1.0 m)	SB-AFC800E-M consists of : SB-PS800AE-M (x2) and SB-PC800E-M (x1)	
Crossover frequency	2.5 kHz		
Frequency range	55 Hz - 50 kHz (-16 dB)		

⚠ WARNING

This service information is designed for experienced repair technicians only and is not designed for use by the general public. It does not contain warnings or cautions to advise non-technical individuals of potential dangers in attempting to service a product. Products powered by electricity should be serviced or repaired only by experienced professional technicians. Any attempt to service or repair the product or products dealt with in this service information by anyone else could result in serious injury or death.

CONTENTS

	Page		Page
1 Disassembly Process (SB-PC800)	3	3.1. SB-PC800	6
1.1. Disassembly of Woofer Speakers	3	4 Cabinet Parts Location	7
1.2. Disassembly of Tweeter Speaker	3	4.1. SB-PC800E	7
1.3. Disassembly of Network	4	5 Replacement Parts List	8
2 Connection of the Speaker Cables	5	6 Packaging	9
3 Connection of the Wiring Diagram	6	6.1. SB-AFC800E	9

Panasonic

© 2004 Matsushita Electric Industrial Co., Ltd. All rights reserved. Unauthorized copying and distribution is a violation of law.

1 Disassembly Process (SB-PC800)

1.1. Disassembly of Woofer Speakers

· Disassembly of Woofer Speaker (1)

Step 1: Remove the net frame assembly out from the cabinet as shown by the arrow.

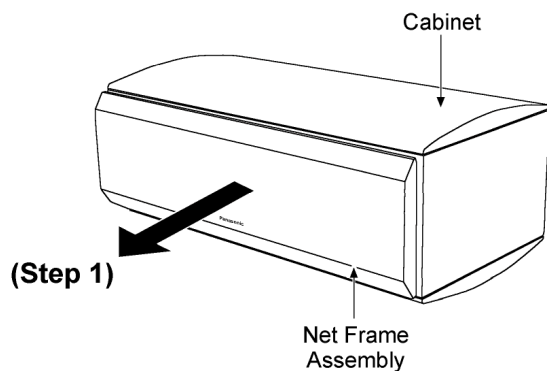

Step 2: Remove 4 screws using an allen key.

Step 3: Remove the woofer ornament.

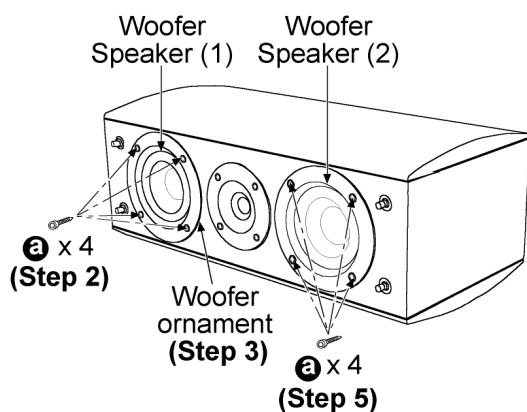

Step 4: Detach the indicated (+) and (-) wires from the woofer.

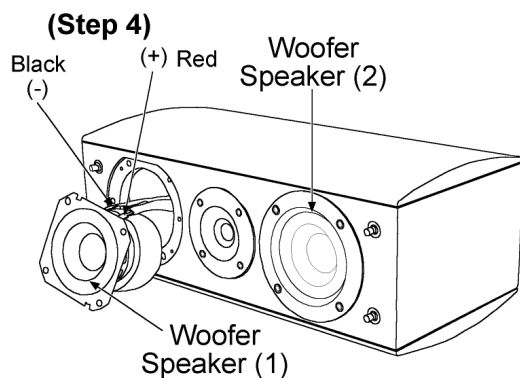

· Disassembly of Woofer Speaker (2)

Step 5: Follow step (2) to step (4) of item 1.1.

1.2. Disassembly of Tweeter Speaker

Follow step (1) of item 1.1

Step 1: Remove 4 screws using an allen key.

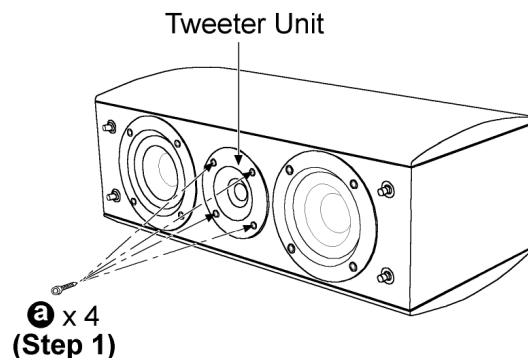

Step 2: Detach the indicated (+) and (-) wires from the tweeter.

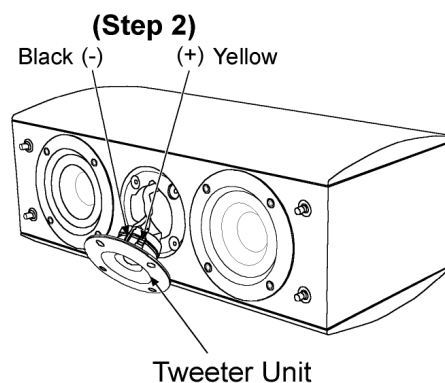

Step 3: Remove 2 screws as shown.

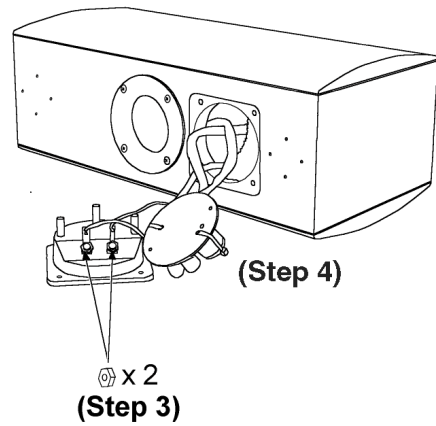
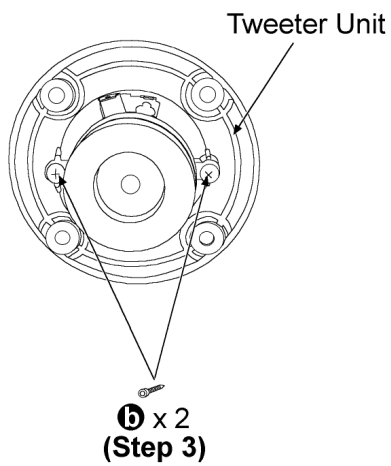

1.3. Disassembly of Network

Step 1: Remove 4 screws as shown.

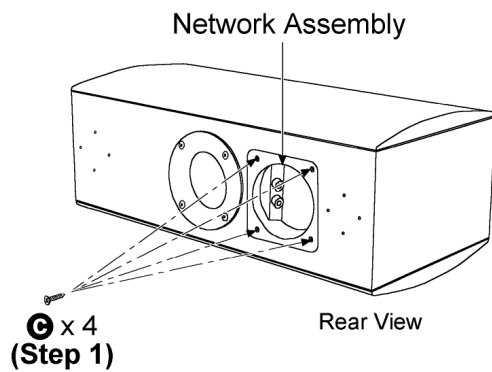

Step 2: Remove 3 screws as shown.

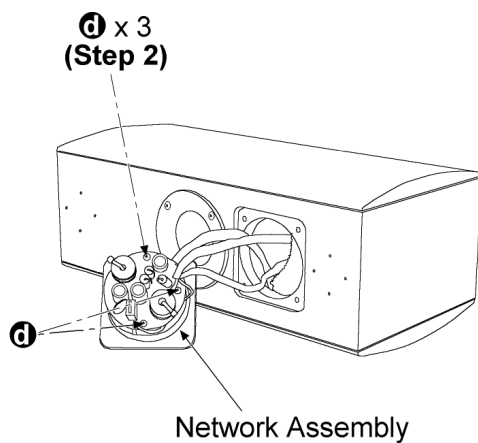

Step 3: Release the indicated nuts.

Step 4: Remove the network assembly.

2 Connection of the Speaker Cables

- Be sure to connect speaker cables before connecting the AC power supply cord.
 - The load impedance of any speaker used with this unit must be 6Ω.
 - Be sure to connect the cable from the right speaker to the right terminal and the cable from the left speaker to the left terminal.
1. Strip off the outer covering, and twist the center conductor. Make sure the bare ends of the wires are not unravelled. (If they are, twist them tight again.)
 2. Insert the wire to the rear panel of the unit and close the lever.

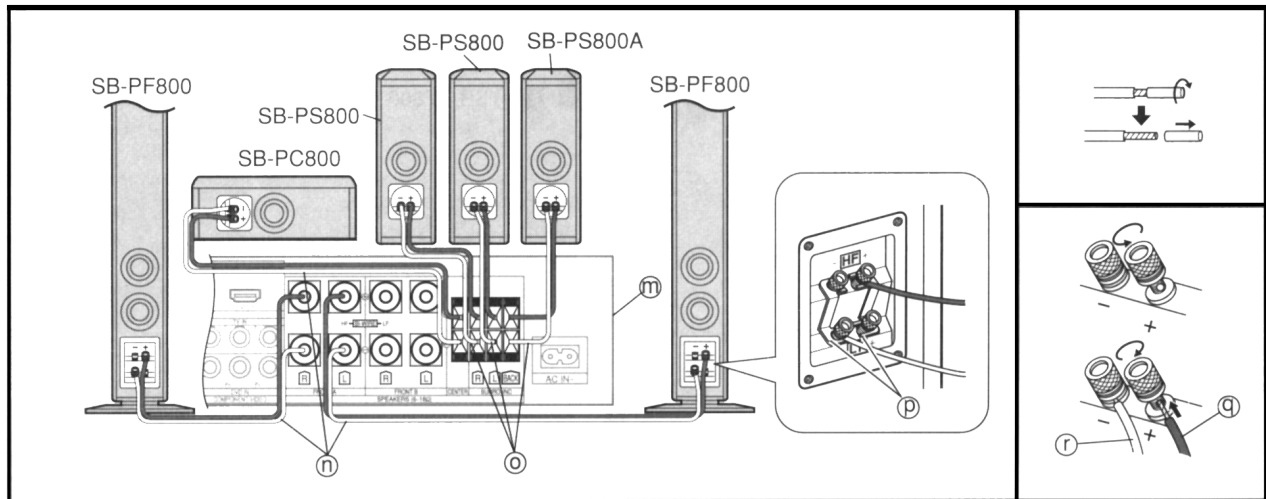

Notes :

- To prevent damage to circuitry, never short-circuit positive (+) and negative (-) speaker wires.
- Be sure to connect only positive (red) wires to positive (+) terminals and negative (black) wires to negative (-) terminals.

3 Connection of the Wiring Diagram

3.1. SB-PC800

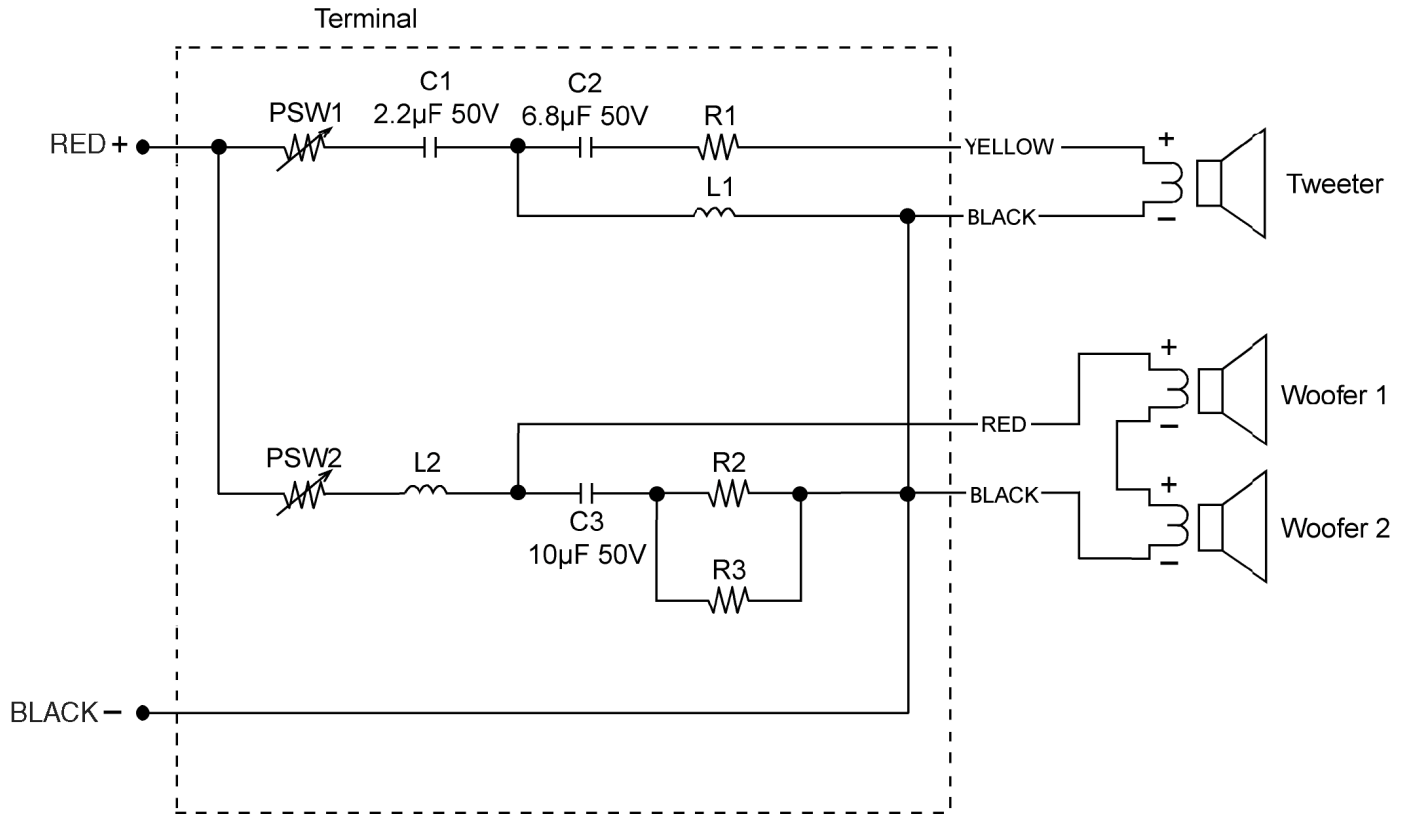

4 Cabinet Parts Location

4.1. SB-PC800E

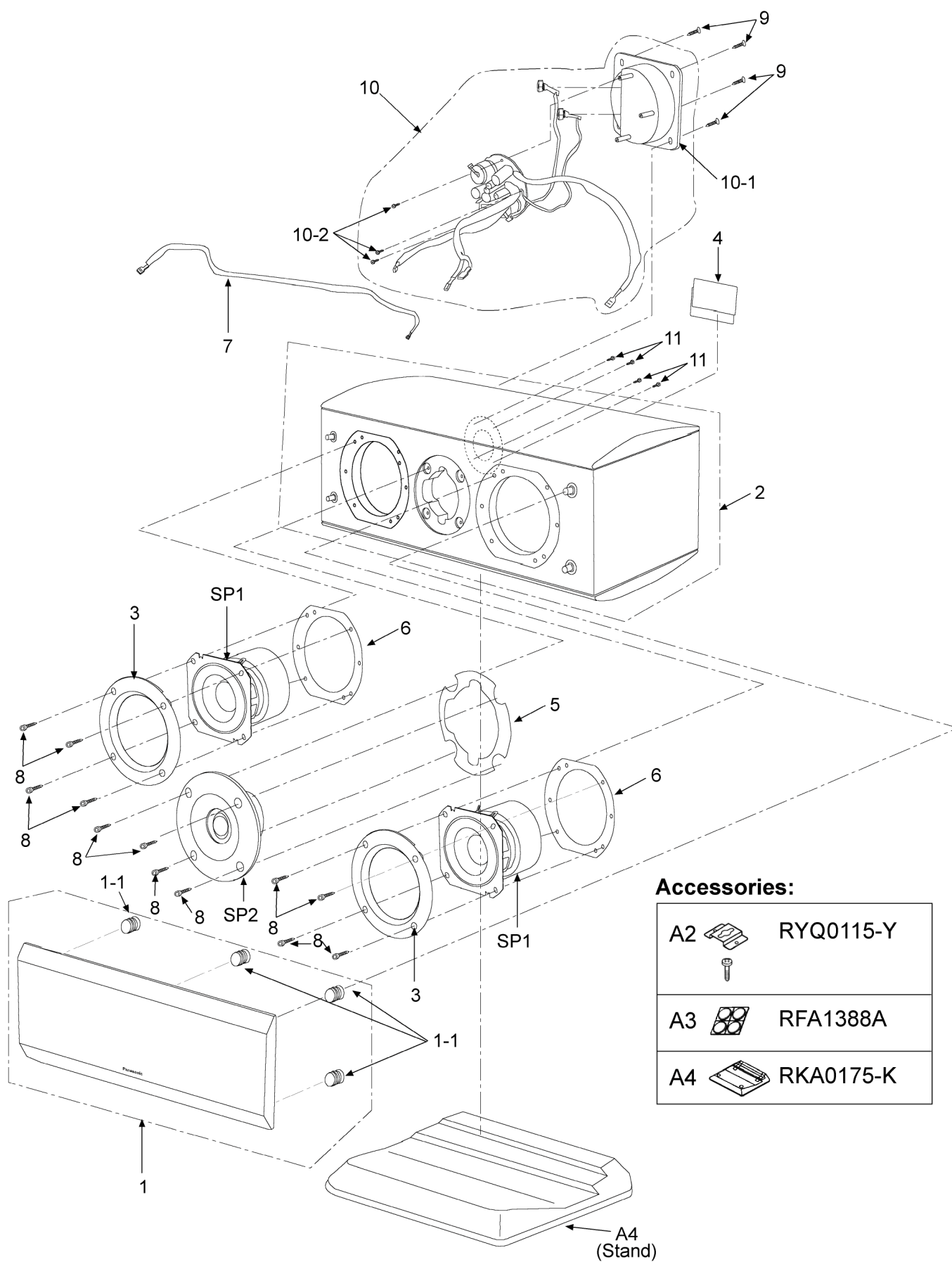

5 Replacement Parts List

Notes :

- Important safety notice :

When replacing any of these components, be sure to use only manufacturer's specified parts shown in the parts list.

- [M] indicates in the Remarks columns indicates parts supplied by **PAVCSG**.

Ref. No.	Part No.	Part Name & Description	Remarks
		CABINET AND CHASSIS	
1	RYB0326	NET FRAME ASS'Y	[M]
1-1	RMG0513-K	NET HOLDER	[M]
2	RFKKBPS800-M	SPK CABINET ASS'Y	[M]
3	RGK1495-K	WOOFER ORNAMENT	[M]
4	RGN2748-K	SPEC SHEET	[M]
5	RMQ0832B	TWEETER SHEET	[M]
6	RMQ0832A	WOOFER SHEET	[M]
7	REZ1681	WIRE ASS'Y	[M]
8	RHD40011-K	SCREW	[M]
9	XMS31+D20FZ	SCREW (TERMINAL)	[M]
10	REP3861A	NETWORK ASS'Y	[M]
10-1	RJH4206A	TERMINAL W/EVA	[M]
10-2	XTB3+10JFJ	SCREW (PWB)	[M]
11	XTN3+20AFZ	SCREW (PORT)	[M]
		SWITCHES	
PSW1	RRSSPK070	SW POLY	[M]
PSW2	SSBSRXE185	SW POLY	[M]
		COILS & TRANSFORMERS	

Ref. No.	Part No.	Part Name & Description	Remarks
L1	SLCSA471KE	CHOKE COIL	[M]
L2	SLCSA821KE	CHOKE COIL	[M]
		PACKING MATERIALS	
P1	RPQ7381	CARTON BOX (SB-AFC800)	[M]
P2	RPN1757	POLYFOAM	[M]
P3	RPH0254	PROTECTION CLOTH	[M]
		ACCESSORIES	
A1	RQT7806-E	O/I BOOK	[M]
A2	RYQ0115-Y	METAL SET	[M]
A3	RFAL388A	LEG SET	[M]
A4	RKA0175-K	STAND ASS'Y	[M]
		RESISTORS	
R1	ERX5SJ5R6P	5.6 5W	[M]
R2	ERX5SJ6R8P	6.8 5W	[M]
R3	ERX5SJ6R8P	6.8 5W	[M]
		CAPACITORS	
C1	ECEA1HAY2R2	2.2uf 50V	[M]
C2	ECA1HAY6R8S	6.8uf 50V	[M]
C3	ECA1HAY100S	10uf 50V	[M]
		SPEAKER	
SP1	EAS8PL174A	WOOFER	[M]
SP2	EAS16KH03A	TWEETER	[M]

6 Packaging

6.1. SB-AFC800E

